

GENERAL GRADING NOTES:

1. THIS IS DESIGN GRADING. ALL GRADES ABOVE THE NORMAL POOL ELEVATION SHALL BE CONTOURED SMOOTHLY WITH GENTLE ROUNDING/SHAPING OF ALL AFFECTED LAND SURFACES. ABRUPT TRANSITIONS AT THE TOP OF SLOPES WHERE PROPOSED GRADES MEET EXISTING ARE NOT ACCEPTABLE. SURVEY STAKES ARE FOR GENERAL GRADING PURPOSES ONLY. NOT ALL SLOPES ARE CONSTANT AND THEREFORE THE GRADING PLANS SHALL BE REFERRED TO FOR FINAL GRADE SHAPING. BERMS SHALL BE GRADED/SHAPED WITH A TRACK DOZER, NOT A BLADE. THE GRADING SHALL BE APPROVED BY MKEC'S LANDSCAPE ARCHITECT PRIOR TO THE ADDITION OF THE TOPSOIL LAYER.

2. MANY EXISTING NATURAL AREAS (TREES AND PASTURE) ARE TO BE PRESERVED AND SHALL BE OFF LIMITS TO CONSTRUCTION ACTIVITY. TEMPORARY CONSTRUCTION FENCE SHALL BE ERECTED AS INDICATED BEFORE ANY TYPE OF CONSTRUCTION IS INITIATED. REFER TO SHEET 18. NO EQUIPMENT OR WORK OF ANY KIND SHALL ENTER/DISTURB THESE AREAS.

3. A 6" LAYER OF TOPSOIL SHALL BE STRIPPED IN ALL AREAS OF CUT AND FILL AND REPLACED AT A 6" THICKNESS ON PROPOSED GRADING AREAS. THE TOPSOIL THICKNESS MAY BE INCREASED TO 12" ON BERMS ONCE IT IS DETERMINED EXCESS TOPSOIL IS AVAILABLE. NOTE: THE FINISHED GRADE INDICATES THE SURFACE ELEVATION AFTER THE LAYER OF TOPSOIL HAS BEEN PLACED.

4. WHERE OFFSITE TOPSOIL IS NEEDED, IT SHALL BE FERTILE NATURAL TOPSOIL, TYPICAL OF THE LOCALITY, OBTAINED FROM WELL DRAINED AREAS. STOCKPILED TOPSOIL MAY BE USED. IT SHALL BE WITHOUT ADMIXTURE OF SUBSOIL OR SLAG AND SHALL BE FREE OF STONES, LUMPS, STICKS, PLANTS OR THEIR ROOTS, TOXIC SUBSTANCES OR OTHER EXTRANEOUS MATTER THAT MAY BE HARMFUL TO PLANT GROWTH OR WOULD INTERFERE WITH FUTURE MAINTENANCE. TOPSOIL pH RANGE SHALL BE 5.5 TO 7.0. TOPSOIL SHALL BE APPROVED BY MKEC'S LANDSCAPE ARCHITECT PRIOR TO PLACEMENT.

5. HAUL ROUTES TO BE APPROVED BY OWNER'S REPRESENTATIVE.

6. EROSION CONTROL IS TO MEET ALL FEDERAL, STATE, COUNTY & LOCAL CODE STANDARDS.

7. ALL AREAS DISTURBED (BERMS, HAUL ROADS) SHALL BE SEEDED AND FERTILIZED AS FOLLOWS:
ANNUAL RYE @ 200 LBS./ACRE

THIS AREA SHALL BE FINE GRADED AND SURFACE SHALL BE FREE FROM STICKS, SMALL STONES, AND OTHER EXTRANEOUS MATERIALS.

8. CONTRACTOR SHALL PROVIDE EROSION PROTECTION THROUGHOUT PROJECT CONSTRUCTION. THE PLAN PROVIDED HERE IS FOR FINAL PROTECTION, VARIOUS PHASES OF THIS PLAN SHALL BE IMPLEMENTED OR MODIFIED TO CONTROL EROSION. MODIFICATIONS OF THE PLAN SHALL BE APPROVED BY THE OWNERS REPRESENTATIVE.

9. SEEDING AREAS SHALL BE PREPARED FOR PLANTING WITH COMMON AGRICULTURAL TECHNIQUES. APPROVE WITH OWNER'S REPRESENTATIVE BEFORE PLANTING.

10. ALL SEED SHALL BE DISTRIBUTED WITH AN ACCEPTABLE DRILL INTENDED FOR SUCH OPERATIONS, OR OTHER EQUIPMENT APPROVED BY THE OWNER'S REPRESENTATIVE. SEEDING DEPTH SHALL BE 1/4".

11. ALL SEEDED AREAS SHALL BE IMMEDIATELY MULCHED W/PRAIRIE HAY AT 2 TONS/ACRE. ANCHOR MULCH BY CRIMPING INTO TOPSOIL WITH SUITABLE MECHANICAL EQUIPMENT.

EARTHWORK TABULATIONS:

BERM GRADING

BERM A = 800 CY OF FILL
0 CY OF CUT
BERM B = 5,200 CY OF FILL
100 CY OF CUT
BERM C = 2,500 CY OF FILL
100 CY OF CUT

GENERAL TREE PROTECTION NOTES:

1. TREES ARE AN IMPORTANT ASSET TO THE DEVELOPER. EVERY EFFORT SHOULD BE MADE TO PRESERVE EACH AND EVERY TREE (UNLESS NOTED FOR REMOVAL) AS DIRECTED IN THESE PLANS & NOTES.

2. BEFORE ANY TYPE OF CONSTRUCTION BEGINS WITHIN THE PROJECT IMPROVEMENT AREA THE CONTRACTOR SHALL INSTALL PROTECTION FENCE AROUND ALL TREE MASSES & INDIVIDUAL TREES THAT ARE NOT NOTED FOR REMOVAL.

3. EQUIPMENT AND CONSTRUCTION MATERIALS SHALL REMAIN OUT OF AND AWAY FROM TREE DRIFTLINES SO AS TO NOT COMPACT THE ROOT ZONE OR DAMAGE THE TREE. CHEMICAL SPILL DAMAGE SHALL BE PREVENTED BY FILLING GAS TANKS, CLEANING TOOLS & REPAIRING EQUIPMENT WELL OUTSIDE TREE PROTECTED ROOT ZONES. MIXING TRUCKS SHALL BE RINSED OUT IN A DESIGNATED AREA. WHERE IT OCCURS THAT A CONSTRUCTION ROUTE OR A PROPOSED IMPROVEMENT OCCURS WITHIN A TREE'S (PRZ) IT MAY BE NECESSARY DEPENDENT UPON THE TYPE OF CONSTRUCTION AND EQUIPMENT USED, TO INSTALL A ROOT PROTECTION BRIDGE OR APPROVED EQUIVALENT, THIS MAY BE DETERMINED IN THE FIELD AT THE DIRECTION OF THE LANDSCAPE ARCHITECT (REFER TO DETAIL THIS SHEET).

4. ANY TREE THAT MUST HAVE BRANCHES REMOVED SHALL BE TRIMMED WITH SHARP INSTRUMENT/TOOL THAT IS INTENDED FOR SUCH OPERATIONS. CONSULT LANDSCAPE ARCHITECT PRIOR TO TRIMMING. KNOCKING BRANCHES OFF WITH A BACKHOE OR OTHER SIMILAR MACHINE IS NOT ACCEPTABLE! REFER TO TREE TRIMMING DETAIL ON THIS SHEET FOR TRIMMING PROCEDURE.

5. IT MAY BE NECESSARY IN CERTAIN AREAS THAT THE CONTRACTOR USE SMALLER MACHINERY IN ORDER TO COMPLETE WORK NEARER TO TREES & ALONG POND EDGES WHERE GRADING OCCURS NEAR TREES OR BELOW DRIFTLINES.

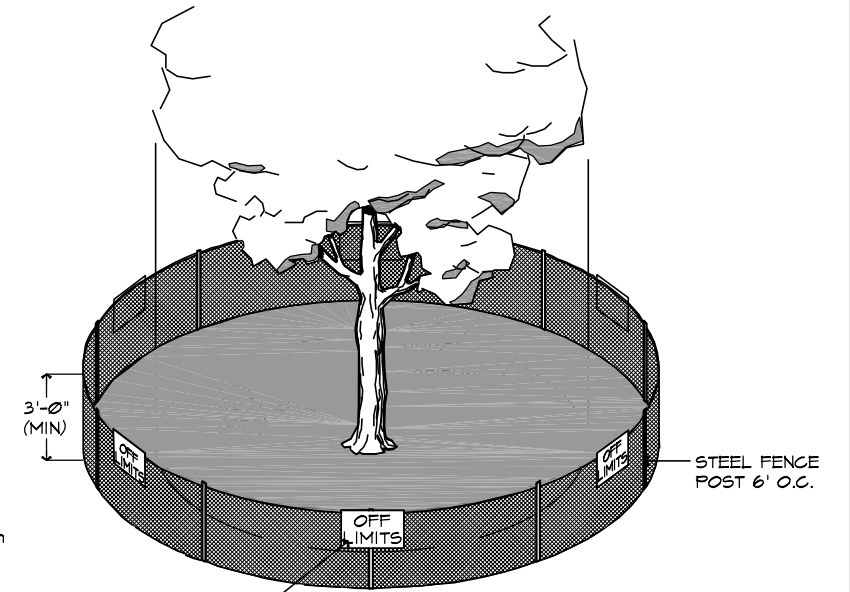
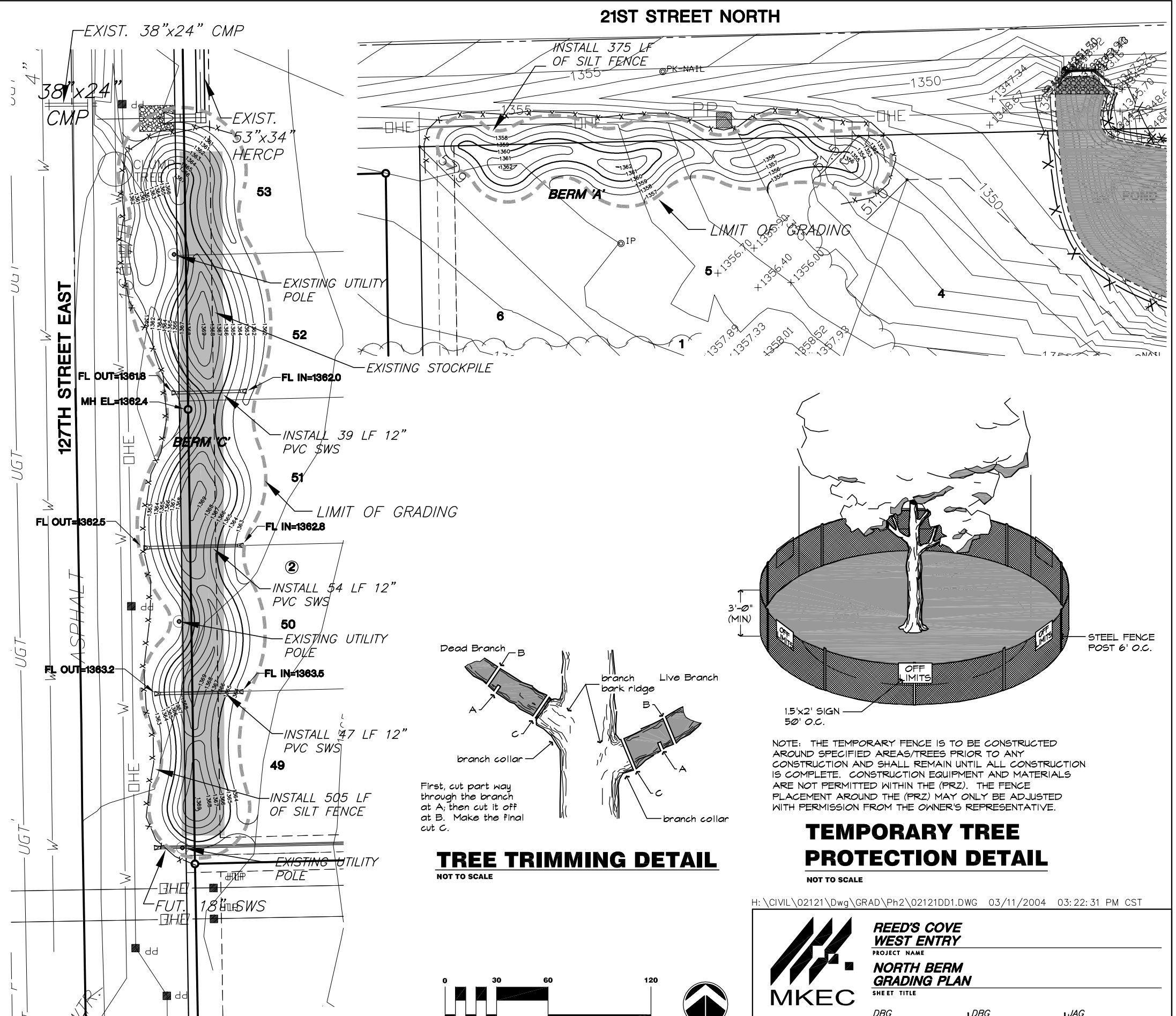

NOTE: THE TEMPORARY FENCE IS TO BE CONSTRUCTED AROUND SPECIFIED AREAS/TREES PRIOR TO ANY CONSTRUCTION AND SHALL REMAIN UNTIL ALL CONSTRUCTION IS COMPLETE. CONSTRUCTION EQUIPMENT AND MATERIALS ARE NOT PERMITTED WITHIN THE (PRZ). THE FENCE PLACEMENT AROUND THE (PRZ) MAY ONLY BE ADJUSTED WITH PERMISSION FROM THE OWNER'S REPRESENTATIVE.

TEMPORARY TREE PROTECTION DETAIL

NOT TO SCALE

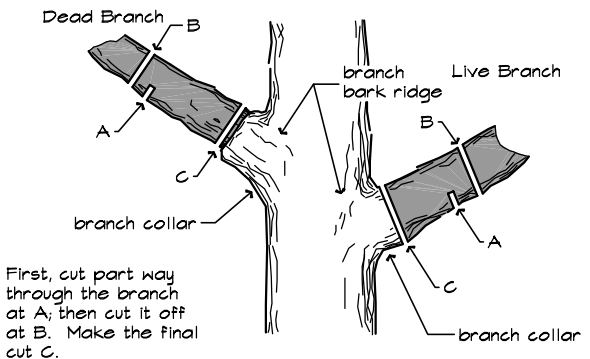

TREE TRIMMING DETAIL

NOT TO SCALE

H:\CIVIL\02121\Dwg\GRAD\Ph2\02121DD1.DWG 03/11/2004 03:22:31 PM CST

	REED'S COVE WEST ENTRY PROJECT NAME		
	NORTH BERM GRADING PLAN SHEET TITLE		
	DBG DESIGN BY:	DBG DRAWN BY:	JAG CHECKED BY:
	APRIL 14, 2004 DATE	02121 JOB NO.	2 / 8 SHEET/OF
411 N. WEBB ROAD WICHITA, KS. 67206 316 - 684 - 9600			