

FHWA REGION NO.	STATE	PROJECT NO.	FISCAL YEAR	SHEET NO.	TOTAL SHEETS
7	KANSAS	87 TE-0353-01	2014	35	84

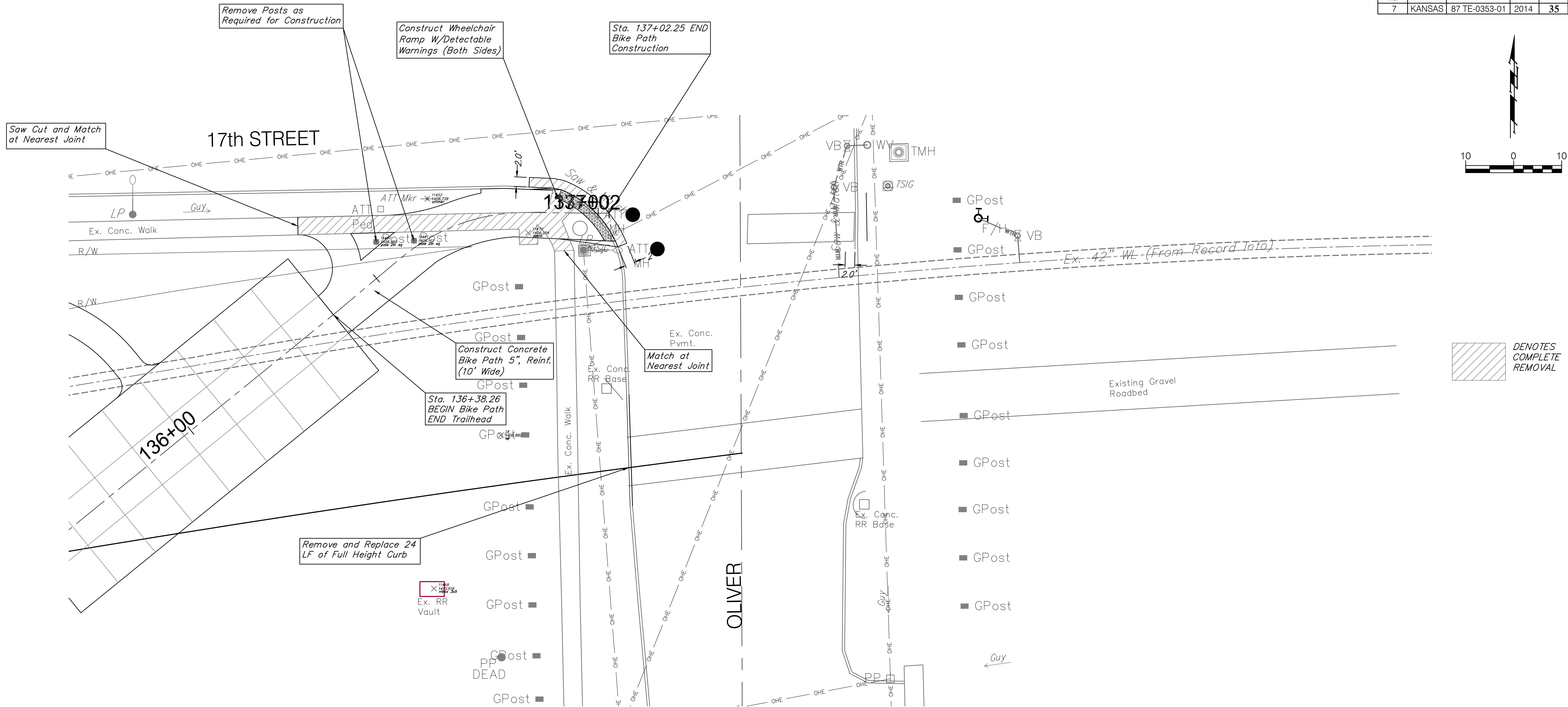

Saw Cut and Match at Nearest Joint

17th STREET

Construct Wheelchair Ramp W/Detectable Warnings (Both Sides)

Sta. 137+02.25 END Bike Path Construction

136+00

Sta. 136+38.26 BEGIN Bike Path END Trailhead

Construct Concrete Bike Path 5", Reinf. (10' Wide)

Match at Nearest Joint

Remove and Replace 24 LF of Full Height Curb

Ex. RR Vault

Ex. 42" WL (From Record Info)

Existing Gravel Roadbed

DENOTES COMPLETE REMOVAL

OLIVER

Guy

Drawing File: E:\Projects\Redbud Bike Path Project 11-07-E650\CIVIL 3D\Redbud base.dwg
 Design: KEK
 Drawn: JDM
 Approved: JFB
 Scale: NOTED

Project No. 11-07-E650
 CAPITAL IMPROVEMENT PROJECT
REDBUD BIKE PATH
OLIVER STREET PAVING
 STA 137+00 - STA 137+61

Baughman Company, P.A.
 315 Ellis St. Wichita, KS 67211 P 316-262-7271 F 316-262-0149
 ENGINEERING | SURVEYING | PLANNING | LANDSCAPE ARCHITECTURE

AUGUST, 2014
 SHEET **35**
 OF **84**