

Saw Cut and Match at Nearest Joint

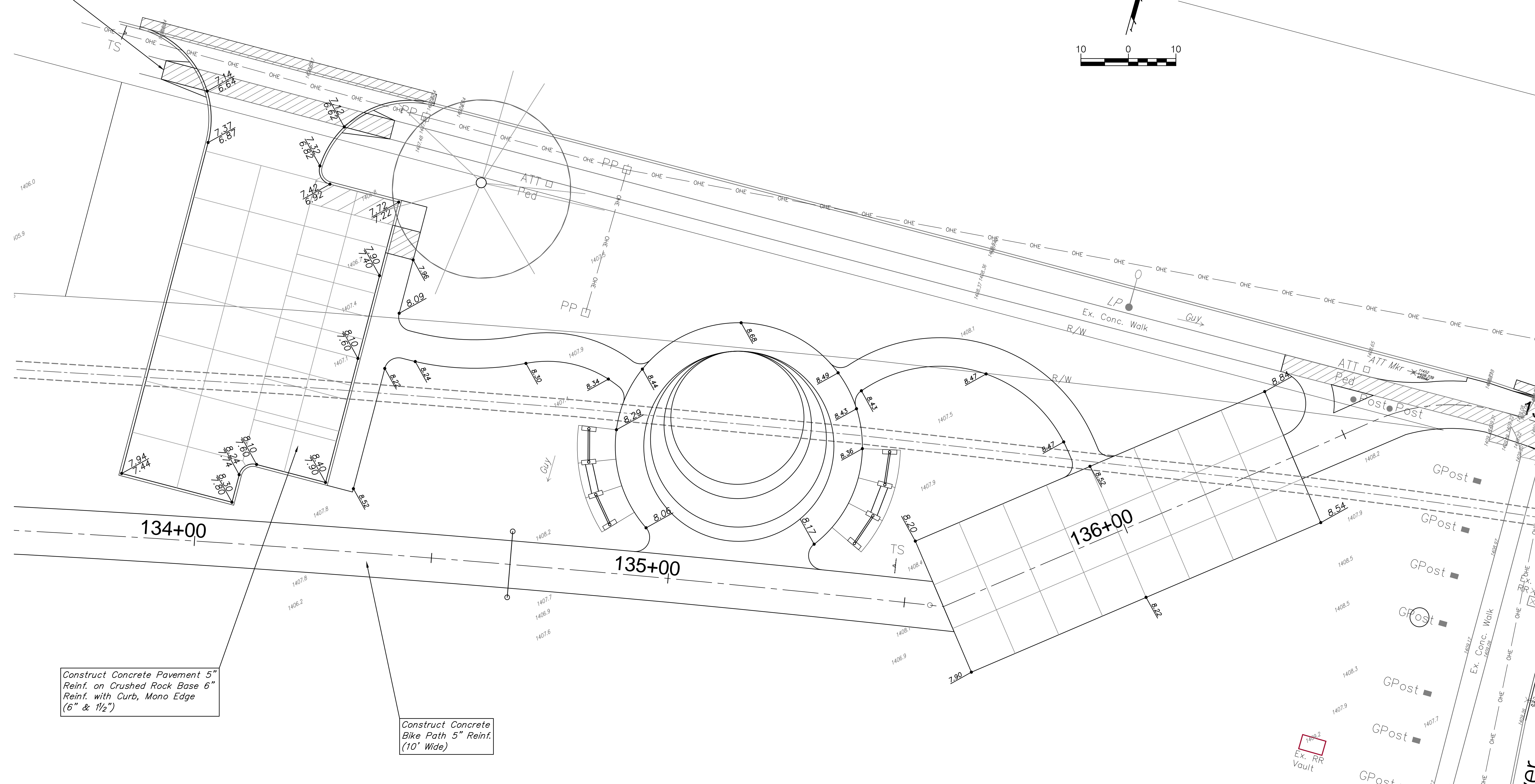
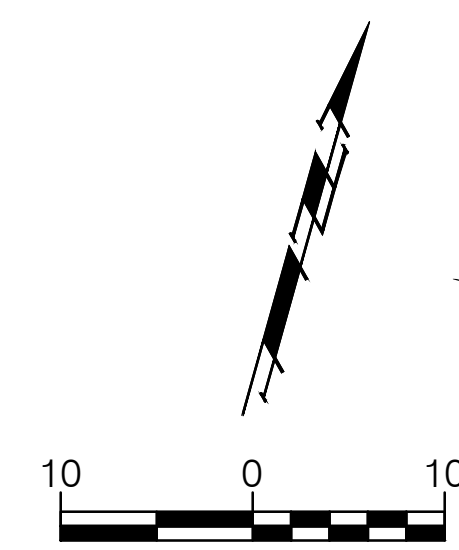

Construct Concrete Pavement 5" Reinf. on Crushed Rock Base 6" Reinf. with Curb, Mono Edge (6" & 1 1/2")

Construct Concrete Bike Path 5" Reinf. (10' Wide)

Drawing File: E:\Projects\Redbud Bike Path Project 11-07-E650\CIVIL 3D\Redbud base.dwg
 Design: ENGINEER
 Drawn: STAFF
 Approved: ENGINEER
 Scale: NOTED

Project No. 11-07-E650
 CAPITAL IMPROVEMENT PROJECT
REDBUD BIKE PATH
 17TH STREET TRAIL HEAD
 STA 134+00-STA 136+50

Baughman Company, P.A.
 315 Ellis St. Wichita, KS 67211 P 316-262-7271 F 316-262-0149
 ENGINEERING | SURVEYING | PLANNING | LANDSCAPE ARCHITECTURE

AUGUST, 2014
 SHEET
45
 OF
84

Oliver