

Existing 15" CMP w/end sections not field located. Contractor shall verify size and location. Contractor shall salvage existing pipe & end sections and move 19.5' ft. to the north as shown. Grade ditches to match flow line of pipe. Use some FL elevations when setting pipe. FL 15'(W)=143.41 FL 15'(E)=143.15

Construct 5" A.C. Pavement (3" Bit. Base) w/ 5" Reinforced Crushed Rock Subgrade.

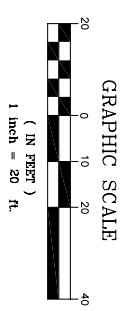
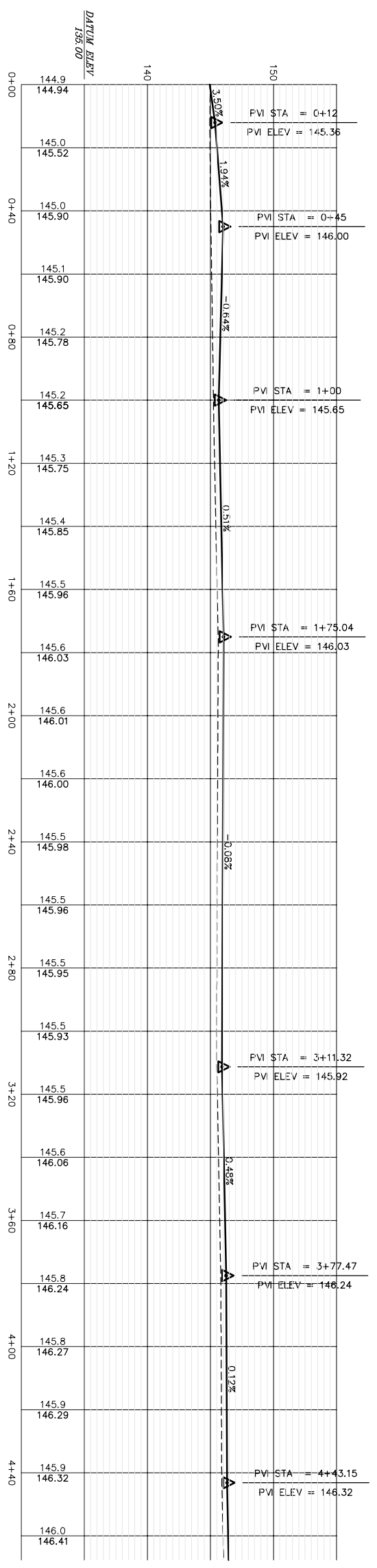

UTILITIES SHOWN REPRESENT THE BEST INFORMATION AVAILABLE FOR DESIGN. ADDITIONAL UTILITIES MAY BE PRESENT ON THIS PROJECT. THE CONTRACTOR SHALL BE RESPONSIBLE FOR DETERMINING THE EXACT LOCATION, DEPTH AND SIZE OF ALL UNDERGROUND UTILITIES PRIOR TO CONSTRUCTION. THE CONTRACTOR SHALL BE LIABLE FOR ANY DAMAGE CAUSED BY THE FAILURE TO DO SO.

UTILITY LEGEND	
	Catv Box
	Flag Pole
	Water Well
	Sprinkler Head
	SWS Manhole
	Water Meter
	Sign
	Water Valve
	Fire Hydrant
	Gas Meter
	Misc. Post
	Gas Valve
	Fire Hydrant
	Telephone Riser
	Guy Anchor
	Power Pole
	Section Corner
	Light Pole
	Set 5/8x24 Rebar
	Mailbox
	Existing Fence
	Deciduous Tree or Shrub
	Coniferous Tree
	Property Line
	Underground Telephone
	Underground Electric
	Overhead Electric
	Water Line
	Sanitary Sewer
	Gas Line
	Cable TV or Fiber Optic

SURVEY DISCLAIMER:
 TOPOGRAPHIC SURVEY USED IN PREPARING PLANS WAS PROVIDED BY CARBER SURVEYS SERVICE (620) 868-7072 423 WEST FIRST AVE. HUTCHINSON, KS. ENGINEER DOES NOT GUARANTEE SURVEY ELEVATIONS FOR ACCURACY. CONTRACTOR SHALL VERIFY ELEVATIONS AND NOTIFY ENGINEER OF ANY DISCREPANCIES.

STREET PAVING PLAN FOR
ATHENIAN AVENUE
 WICHITA, SEDGWICK CO., KANSAS
 CED PROJ. NO.: 20020917

CERTIFIED ENGINEERING DESIGN, P.A.
 810 WEST DOUGLAS, SUITE C
 WICHITA, KANSAS 67203
 PH. (316) 262-8808 FAX. (316) 262-1669

DESIGNED: HOF
 DRAWN: OKW
 DATE: 12/02
 SCALE: 1"=20'
 SHEET: 10
 CHECKED: HOF
 CED FILE: 53-d&h-end-Base TOTAL 74