

WOODLAND LAKES ESTATES  
THIRD ADDITION

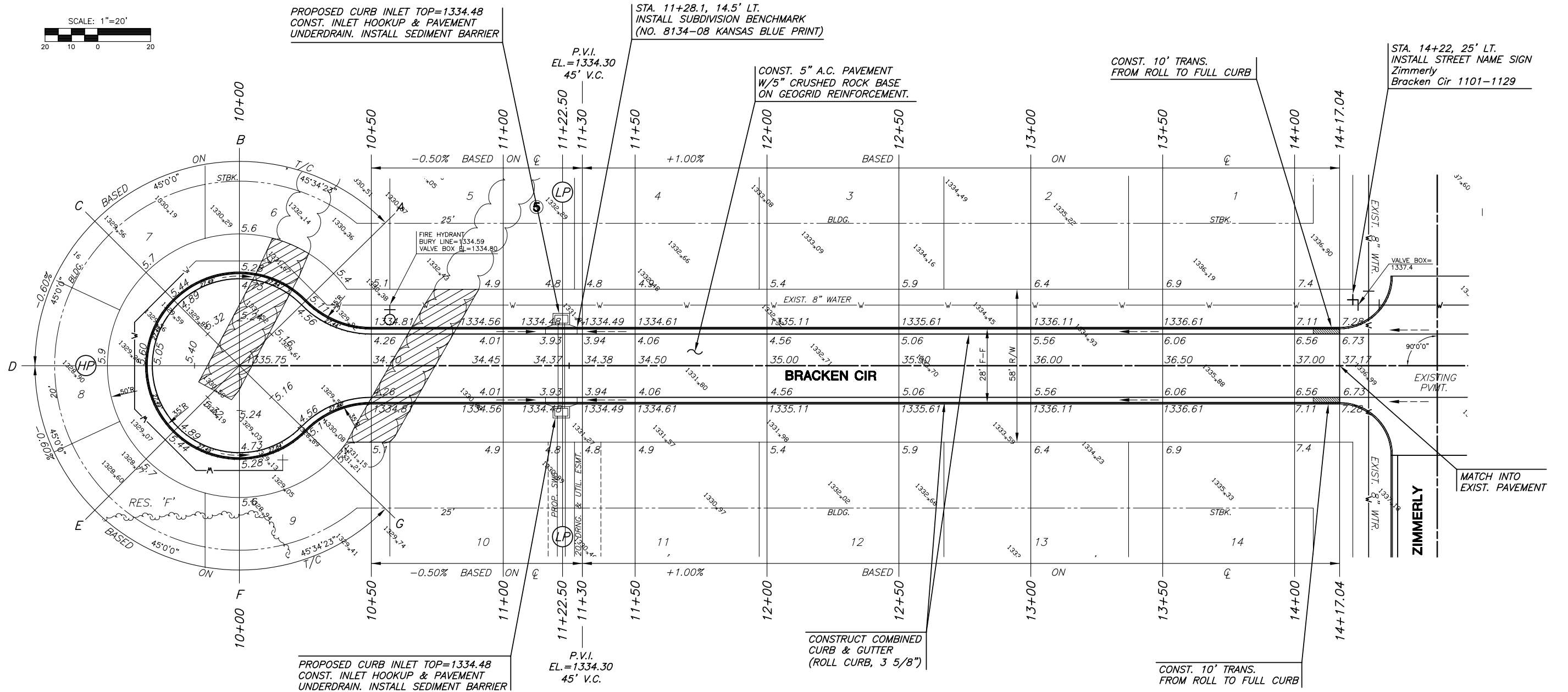
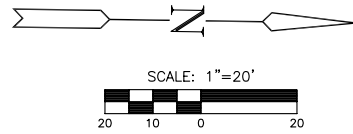

WOODLAND LAKES ESTATES  
THIRD ADDITION

= TREE REMOVAL

SUBDIVISION BENCH MARKS				
NO.	STREET AND STATION	FROM CL	DESCRIPTION	ELEVATIONS
1	BRACKEN CIR, STA. 11+28.1	14.5' LT.	N. END OF INLET ON THE W. SIDE OF BRACKEN CIR.	
2	ZIMMERLY CT, STA. 11+81.5	14.5' LT.	TOP OF CURB AT END OF RETURN, ZIMMERLY CT.	

NOTE: CONTRACTOR SHALL INSTALL SUBDIVISION BENCH MARKS ("FLAT SURVEY MARKERS NO. 8134-08 3" TOP DIAMETER" PROVIDED BY KANSAS BLUE PRINT CO., INC.) COSTS TO BE CONSIDERED SUBSIDIARY TO CONSTRUCTION OF COMBINED CURB AND GUTTER.

- NOTES:
- TOP OF CURB ELEVATIONS SHOWN ARE FOR FULL CURB.
  - CONTRACTOR SHALL REMOVE ALL TREES WITHIN ROAD R/W.

**LEGEND**

- + STREET SIGN & SIGN LOCATION (SEE SIGN ASSEMBLY TABLE FOR TYPE & STATION OF SIGN)



**WOODLAND LAKES THIRD ADDITION  
BRACKEN PHASE**  
PROJECT NAME

**PAVING PLANS - BRACKEN CIR.**  
SHEET TITLE

SRS DESIGN BY.	SRS DRAWN BY.	GLA CHECKED BY.
MARCH 2004 DATE	02172E1 JOB NO.	6 / 25 SHEET/OF