

BENCHMARK:

CITY DISC - SW COR. RIDGE RD. & 29TH ST. NO.,
80.8' S. & 63.7' W. OF C. BOTH.
ELEV. = 139.15 CITY DATUM (1326.55 M.S.L.)

CITY DISC - SW HUB GUARD ON R.C.B.C.,
1/2 MI. N. OF 29TH ST. NO. & RIDGE RD.
ELEV. = 144.22 CITY DATUM (1331.62 M.S.L.)

RIDGE PORT 3RD ADDITION

RIDGE PORT ADDITION

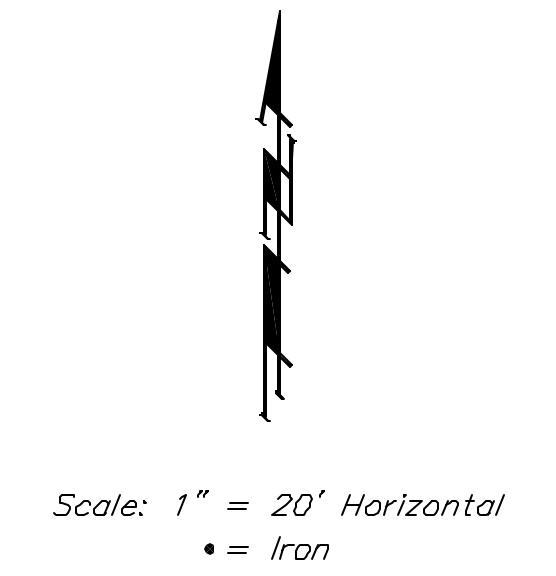
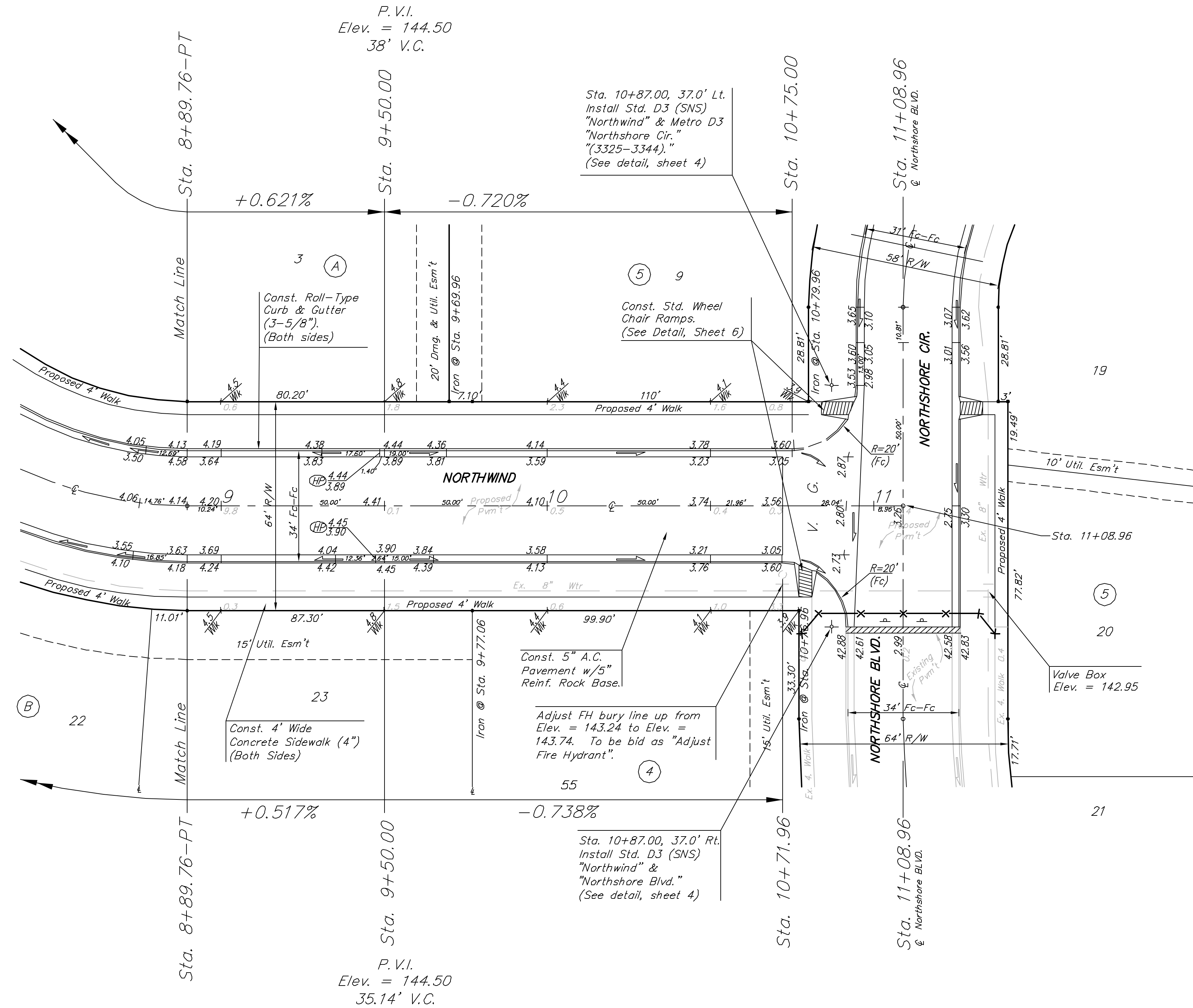

RIDGE PORT 3RD ADDITION

RIDGE PORT ADDITION

Roll-type curb & gutter to be constructed on the pavement on this sheet. Top of curb elevations are given for full-height curb.

NORTHWIND			
STA. 8+89.76 TO STA. 10+71.96			
BAUGHMAN COMPANY P.A.			
ENGINEERING, SURVEYING, & PLANNING			
316-262-7271 • 315 ELLIS • WICHITA, KANSAS 67211			
PROJECT NUMBER		SHEET	
472-83772		9	
DESIGN	DRAWN	APPROVED	DATE
NBW	GNY		5/28/03
		SCALE	NOTED
			34