

BENCHMARK:

CITY DISC - SW COR. RIDGE RD. & 29TH ST. NO.,
 90.8' S. & 63.7' W. OF C BOTH.
 ELEV. = 139.15 CITY DATUM (1326.55 M.S.L.)

CITY DISC - SW HUB GUARD ON R.G.B.C.,
 1/2 MI. N. OF 29TH ST. NO. & RIDGE RD.
 ELEV. = 144.22 CITY DATUM (1331.62 M.S.L.)

RIDGE PORT 3RD ADDITION

Scale: 1" = 20' Horizontal
 • = Iron

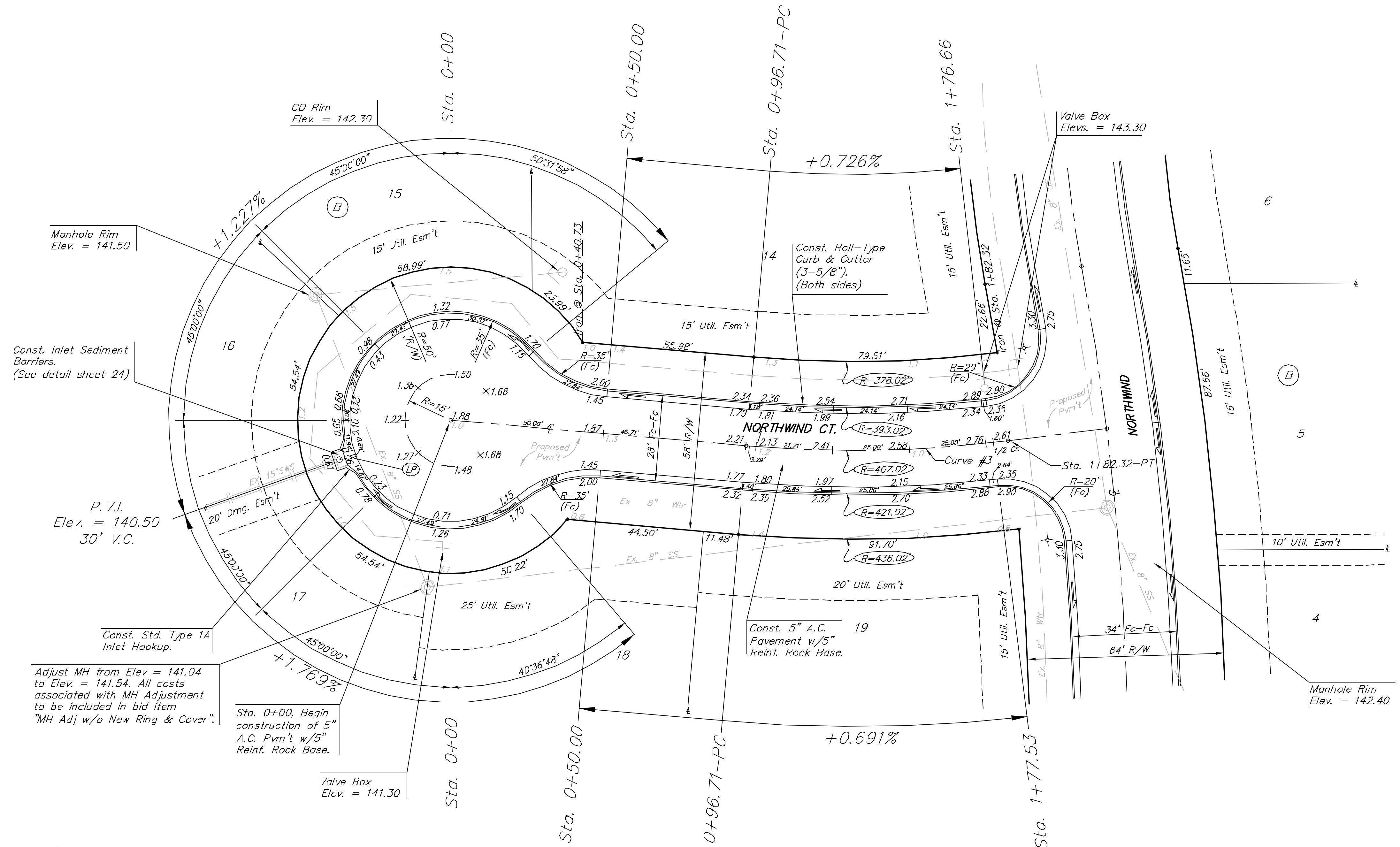

Const. Inlet Sediment Barriers. (See detail sheet 24)

P.V.I. Elev. = 140.50
 30' V.C.

Const. Std. Type 1A Inlet Hookup.

Adjust MH from Elev = 141.04 to Elev = 141.54. All costs associated with MH Adjustment to be included in bid item "MH Adj w/o New Ring & Cover".

Sta. 0+00, Begin construction of 5" A.C. Pvm't w/5" Reinf. Rock Base.

Valve Box Elev. = 141.30

Curve #3
 Curve Data Based on Centerline
 Rad. = 407.02' Delta = 12° 03' 02" Tangent = 42.96'
 Arc = 85.61' L.C. = 85.45' Def/Ft. = 4.22283 Min.

Station	Arc	FACE CHORD LENGTHS		Defl.	T. Defl.
		8' Lt.	8' Rt.		
0+96.71	-	-	-	0°00'00"	0°00'00"
1+00.00	3.29'	3.11'	3.47'	0°13'53"	0°13'53"
1+25.00	28.00'	23.65'	26.35'	1°45'35"	1°59'28"
1+50.00	25.00'	23.64'	26.34'	1°45'34"	3°45'02"
1+75.00	25.00'	23.64'	26.34'	1°45'34"	5°30'36"
1+76.66	1.66'	1.57'	1.75'	0°07'01"	5°37'37"
1+77.53	0.87'	0.82'	0.92'	0°03'40"	5°41'17"
1+82.32	4.79'	0.50'	0.56'	0°20'14"	6°01'31"

Roll-type curb & gutter to be constructed on the pavement on this sheet.
 Top of curb elevations are given for full-height curb.

RIDGE PORT 3RD ADDITION

NORTHWIND CT.
 STA. 0+00 TO STA. 1+76.66

BAUGHMAN COMPANY P.A.
 ENGINEERING, SURVEYING, & PLANNING
 316-262-7271 • 315 ELLIS • WICHITA, KANSAS 67211

PROJECT NUMBER: 472-89772

DESIGN: NBW | DRAWN: CNX | APPROVED: [Signature] | DATE: 5/28/03 | SCALE: NOTED

SHEET 10 OF 34