

BENCHMARK:

CITY DISC - SW COR. RIDGE RD. & 29TH ST. NO.,
80.8' S. & 63.7' W. OF C. BOTH.
ELEV. = 139.15 CITY DATUM (1326.55 M.S.L.)

CITY DISC - SW HUB GUARD ON R.C.B.C.,
1/2 MI. N. OF 29TH ST. NO. & RIDGE RD.
ELEV. = 144.22 CITY DATUM (1331.62 M.S.L.)

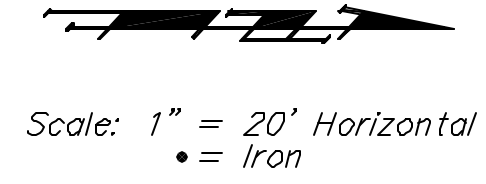

RIDGE PORT ADDITION

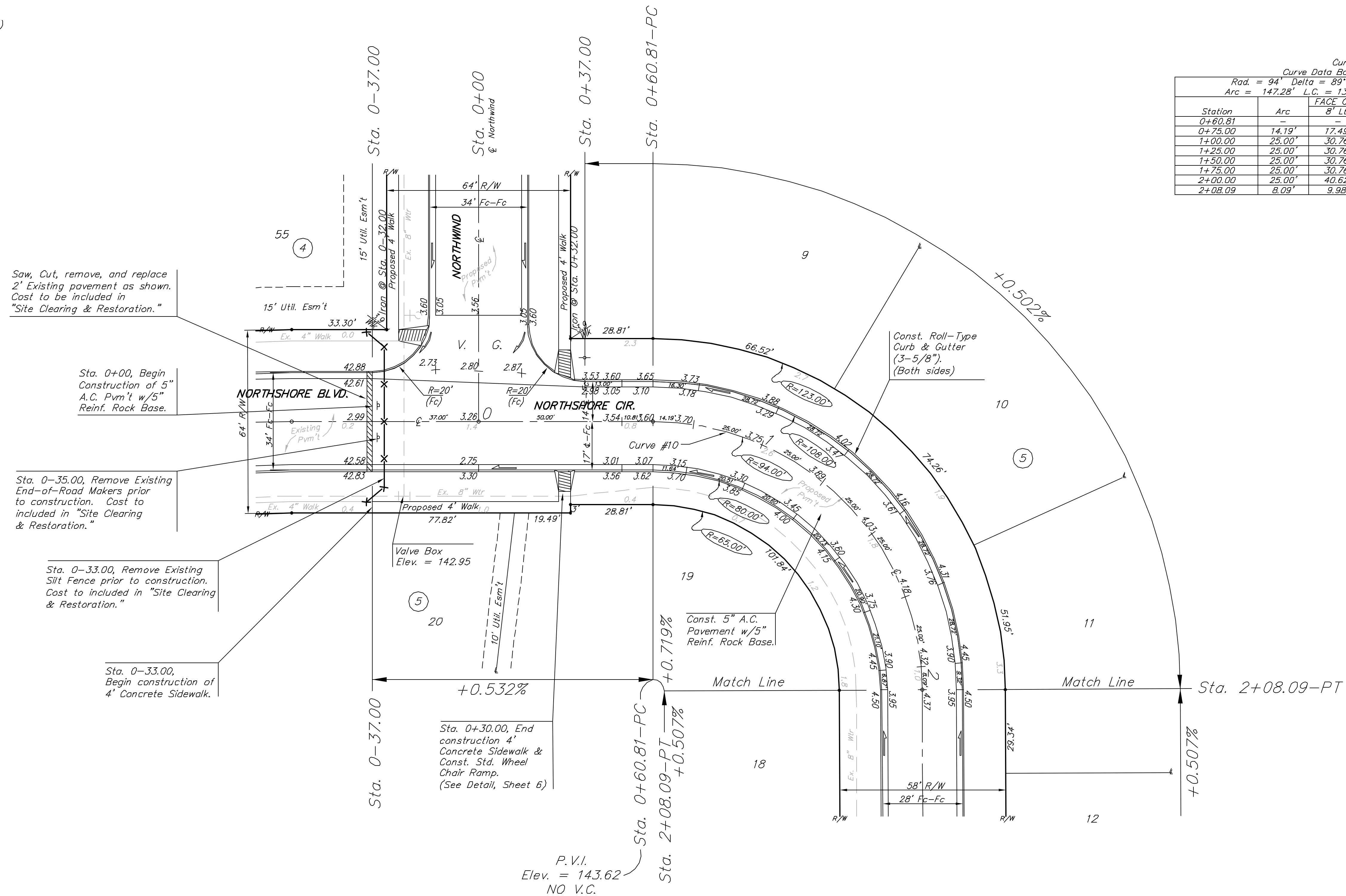

Curve #10
Curve Data Based on Centerline
Rad. = 94' Delta = 89° 46' 23" Tangent = 93.63'
Arc = 147.28' L.C. = 132.67' Def./Pt. = 18.28620 Min.

Station	Arc	FACE CHORD LENGTHS		Defl.	T. Defl.
		B' Lt.	B' Rt.		
0+60.81	-	-	-	0'00"00"	0'00"00"
0+75.00	14.19'	17.49'	10.86'	4'19"29"	4'19"29"
1+00.00	25.00'	30.76'	19.09'	7'37"09"	11'56"38"
1+25.00	25.00'	30.76'	19.09'	7'37"09"	19'33"47"
1+50.00	25.00'	30.76'	19.09'	7'37"09"	27'10"56"
1+75.00	25.00'	30.76'	19.09'	7'37"09"	34'48"06"
2+00.00	25.00'	40.62'	25.22'	7'37"09"	42'25"15"
2+08.09	8.09'	9.98'	6.19'	2'27"56"	44'53"11"

Saw, Cut, remove, and replace 2' Existing pavement as shown. Cast to be included in "Site Clearing & Restoration."

Sta. 0+00, Begin Construction of 5" A.C. Pvm't w/5" Reinf. Rock Base.

Sta. 0-35.00, Remove Existing End-of-Road Markers prior to construction. Cast to be included in "Site Clearing & Restoration."

Sta. 0-33.00, Remove Existing Silt Fence prior to construction. Cast to be included in "Site Clearing & Restoration."

Sta. 0-33.00, Begin construction of 4' Concrete Sidewalk.

RIDGE PORT ADDITION

Roll-type curb & gutter to be constructed on the pavement on this sheet. Top of curb elevations are given for full-height curb.

NORTHSHORE CIR.
STA. 0-37.00 TO STA. 2+08.09

BAUGHMAN COMPANY P.A.
ENGINEERING, SURVEYING, & PLANNING
316-262-7271 • 315 ELLIS • WICHITA, KANSAS 67211

PROJECT NUMBER 472-89772	SHEET 12
DESIGN NBW	DRAWN GNX
APPROVED	DATE 5/28/03
SCALE NOTED	OF 34