

STREET IMPROVEMENTS

TO SERVE

EVERGREEN 4TH

83782

PARKDALE - FROM THE S.L. OF LOT 1, BLOCK 1, TO THE N.L. OF LOT 26, BLOCK 1
 BRISTLECONE - FROM THE W.L. OF LOT 1, BLOCK 2, TO THE N.L. OF LOT 7, BLOCK 2
 BRISTLECONE CIR. - FROM THE E.L. OF LOT 1, BLOCK 1, TO AND INCLUDING THE CUL-DE-SAC
 LANTANA - FROM THE W.L. OF LOT 14, BLOCK 2, TO THE S.L. OF LOT 8, BLOCK 2
 LANTANA CIR. - FROM THE E.L. OF LOT 14, BLOCK 1, WEST TO AND INCLUDING THE CUL-DE-SAC
 SIDEWALK - ON THE E. SIDE OF PARKDALE, THE S. SIDE OF BRISTLECONE AND THE N. SIDE OF LANTANA

OCA NO. 765836

CITY OF WICHITA PROJECT NO. 472-83782

CITY OF WICHITA, KANSAS
 JAMES L. ARMOUR, P.E.-ACTING CITY ENGINEER

INDEX OF SHEETS

1. TITLE SHEET
2. KEY MAP AND GENERAL NOTES
3. PLAT
4. TYPICAL SECTION
5. PAVING PLAN-PARKDALE
6. PAVING PLAN-BRISTLECONE CIR.
7. PAVING PLAN-BRISTLECONE
8. PAVING PLAN-BRISTLECONE/LANTANA
9. PAVING PLAN-LANTANA CIR.
10. PAVING PLAN-LANTANA
11. TEMPORARY ACCESS ROAD
12. VALLEY GUTTER DETAILS
13. MISCELLANEOUS PAVING DETAILS
14. EROSION CONTROL PLAN
- 15-18. EROSION CONTROL DETAILS
19. FOUR CORNER LOT GRADING PLAN
20. SITE GRADING PLAN
21. SIGNING DETAILS
- 22-23. PLAN/PROFILE-STORM WATER SEWER
24. STD. AREA INLET AND MISCELLANEOUS DETAILS
- 25-44. CROSS SECTIONS

Construction Sequencing

All Evergreen 4th work shall be coordinated with Evergreen 4th Sanitary Sewer Improvements (Project No. 468-83639) and Evergreen 4th Waterline Improvements (Project No. 448-89831) such that construction can proceed concurrently whenever possible.

Sanitary Sewer Construction

Construction of Evergreen 4th Sanitary Sewer Improvements (Project No. 468-83639) shall be complete by March 5, 2004.

Waterline Construction

Construction of Evergreen 4th Waterline Improvements (Project No. 448-89831) shall be complete by April 2, 2004.

Street & SWS Construction

Substantial completion of Evergreen 4th Street & SWS Improvements (Projects No. 472-83782 & 468-83640), ie. grading, storm sewer, and all paving items except 2" asphalt surface, shall be accomplished by May 7, 2004. All remaining items of work shall be complete by May 21, 2004.

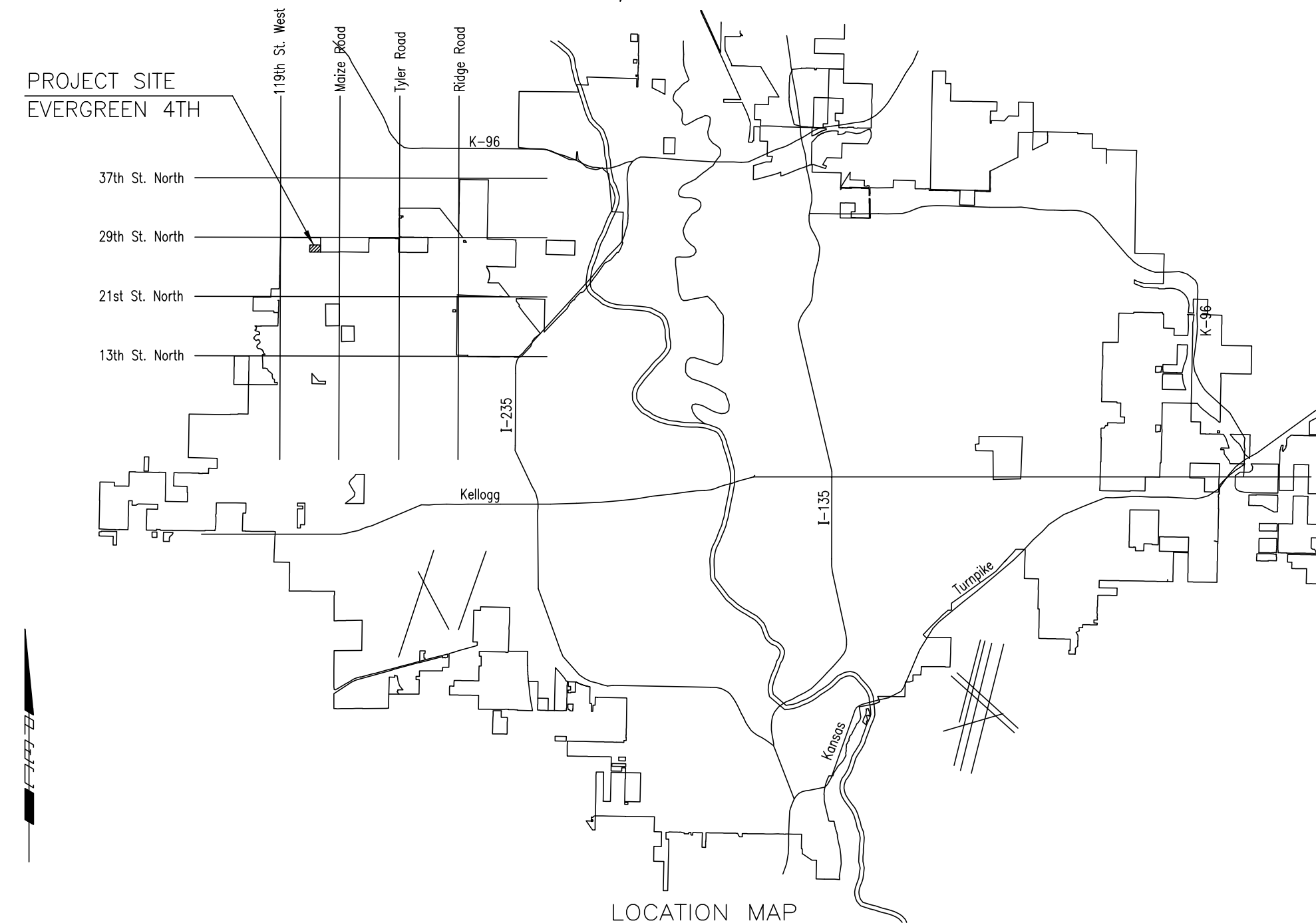

EARTHWORK

EXCAVATION 18,758 CU. YDS.
 COMPACTED FILL 1,710 CU. YDS.

PROJECT LENGTH = 2,619 LIN. FT.

EXCESS EXCAVATED MATERIAL FROM ON-SITE SHALL BE USED FOR LOT GRADING WITHIN THE IMPROVEMENT DISTRICT BOUNDARY (APPROX. 14,500 C.Y. REQUIRED). SEE SHEET NO. 20 FOR SITE GRADING PLAN.

SUBDIVISION BENCH MARKS (SBM)				
NO.	STREET AND STATION	FROM C	DESCRIPTION	ELEVATION
1	PARKDALE, STA. 11+23.00	14.5' LT.	N. END, WEST CURB RETURN, BRISTLECONE CIR.	
2	PARKDALE, STA. 15+05.00	14.5' LT.	S. END, WEST CURB RETURN, PARKDALE CT.	
3	BRISTLECONE, STA. 35+61	14.5' LT.	ON WEST CURB, 15' NORTH OF CURB INLET	

THE COST OF THE BENCH MARK DISC, INCLUDING INSTALLATION, SHALL BE INCIDENTAL TO THE CURB.

FEBRUARY 2004

PLANS PREPARED BY
PROFESSIONAL ENGINEERING CONSULTANTS, P.A.
 ENGINEERS
 WICHITA, KANSAS

DSNR: BDB OPER: BJS SCALE: 1=1.00
 03/2003/03123/000/STRITILE 02-05-2004 10:55:55 am