

Sta. 30+00.00 @ Bristlecone=
Sta. 11+57.00 @ Parkdale

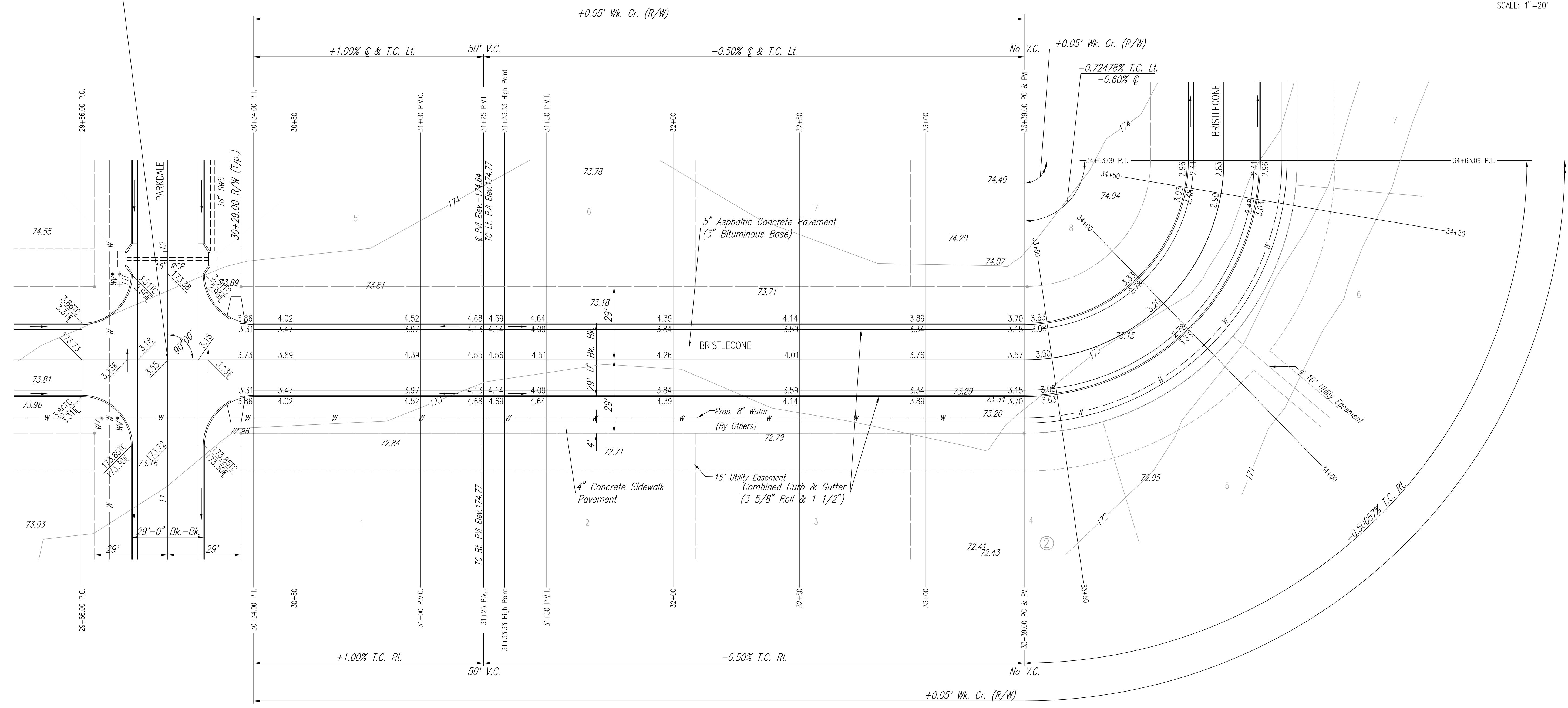

NOTE: THIS STREET TO BE CONSTRUCTED WITH ROLL-TYPE CURB. TOP OF CURB ELEVATIONS GIVEN ARE FOR FULL HEIGHT CURB.

DSNR: BDB OPER: BJS SCALE: 1"=20.00
 Q:\2003\03123\000\STR30-34_02-04-2004_02:18:14 pm

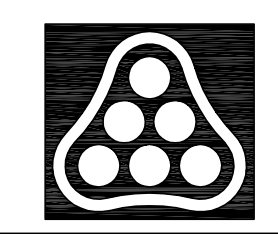

No.	Revision	By	Date
	EVERGREEN 4TH		
BRISTLECONE STA. 30+00 TO STA. 34+39.00 JAMES L. ARMOUR, P.E.—ACTING CITY ENGINEER CITY OF WICHITA PROJECT NO. 472-83782			
Professional Engineering Consultants, P.A. 303 S. TOPEKA • WICHITA, KANSAS 67202 316-262-2691 • FAX 316-262-3003			
Designed by	BDB, BLB	Job No.	35-03123
Drawn by	BJS	Date	MARCH 2003
			Sht. 7 of 44