

Subdivision Bench Marks

No.	Street and Station	From CL	Description	Elevation
1	Andrea, Sta. 9+87	14' Lt.	East End of NE Curb Return Intersection of Andrea & Andrea Ct.	
2	Andrea Ct., Sta. 3+72	14' Rt.	North End of West Return of Cul-de-Sac	

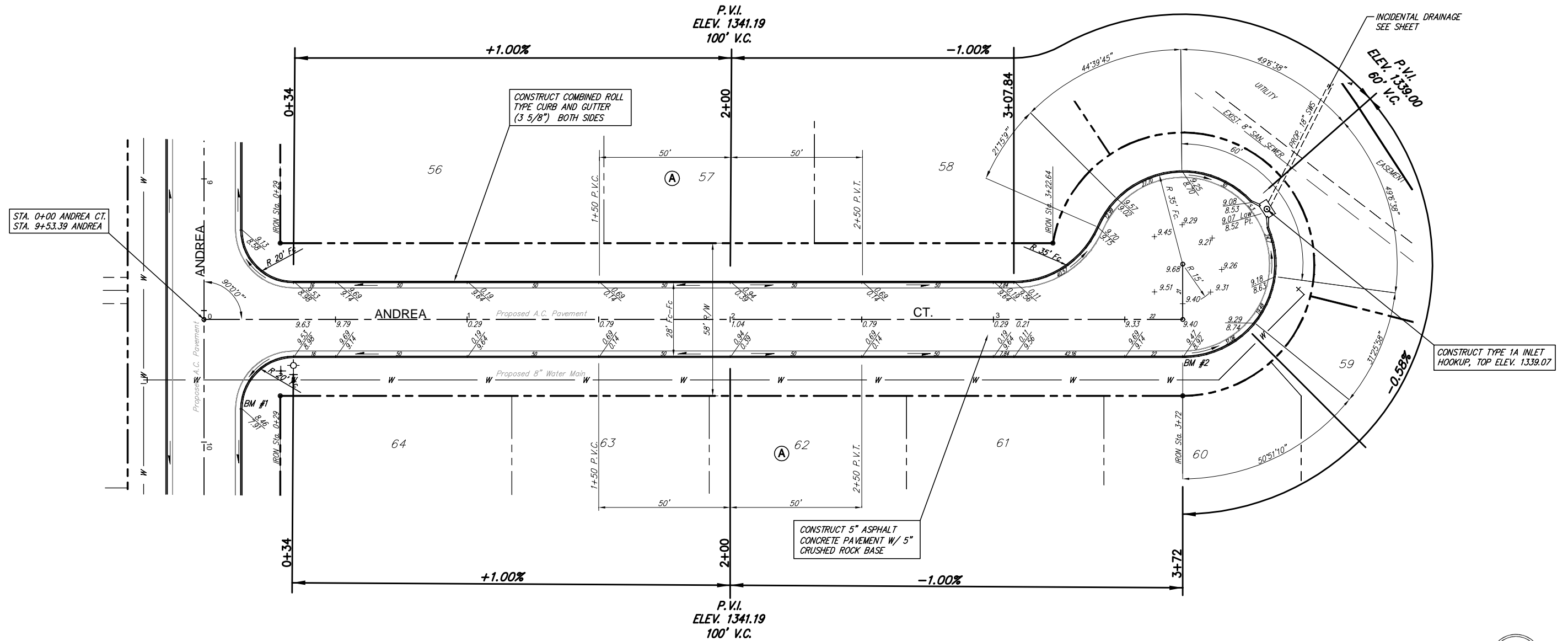

STA. 0+00 ANDREA CT.
STA. 9+53.39 ANDREA

CONSTRUCT TYPE 1A INLET
HOOKUP, TOP ELEV. 1339.07

CONSTRUCT 5" ASPHALT
CONCRETE PAVEMENT W/ 5"
CRUSHED ROCK BASE

CONSTRUCT COMBINED ROLL
TYPE CURB AND GUTTER
(3 5/8") BOTH SIDES



SCALE 1" = 20'

NOTE: ROLL TYPE CURB AND
GUTTER TO BE CONSTRUCTED ALONG
PAVEMENT DEPICTED ON THIS SHEET

Tara Falls Addition, Paving Improvements
Andrea Ct.
WICHITA, KANSAS



Ruggles & Bohm, P.A.
Engineering, Surveying, Land Planning

924 North Main
Wichita, Kansas 67203
www.rbkansas.com

(316) 264-8008
(316) 264-4621 fax
E-mail: info@rbkansas.com

DESIGN	KWL	REV	DATE	SHEET
DRAWN	TEB			5
REVIEW				OF
UTILITY				32
DATE	Dec. 10, 2003			

DRAWING FILE	PROJECT NUMBER
Base Paving {Andrea Ct N}	472-83848