

**BENCHMARKS:**  
 City Disc In T.C. Adj. to F.H. 38'  
 South of intersection of Onewood  
 and Auburn Hills.  
 Elev. = 178.48 (City Datum)

"□" cut in south curb of Onewood  
 272' west of C.L. Auburn Hills.  
 Elev. = 179.73 (City Datum)

P.V.I.  
 Elev. = 184.90  
 NO V.C.

P.V.I.  
 Elev. = 179.20  
 NO V.C.

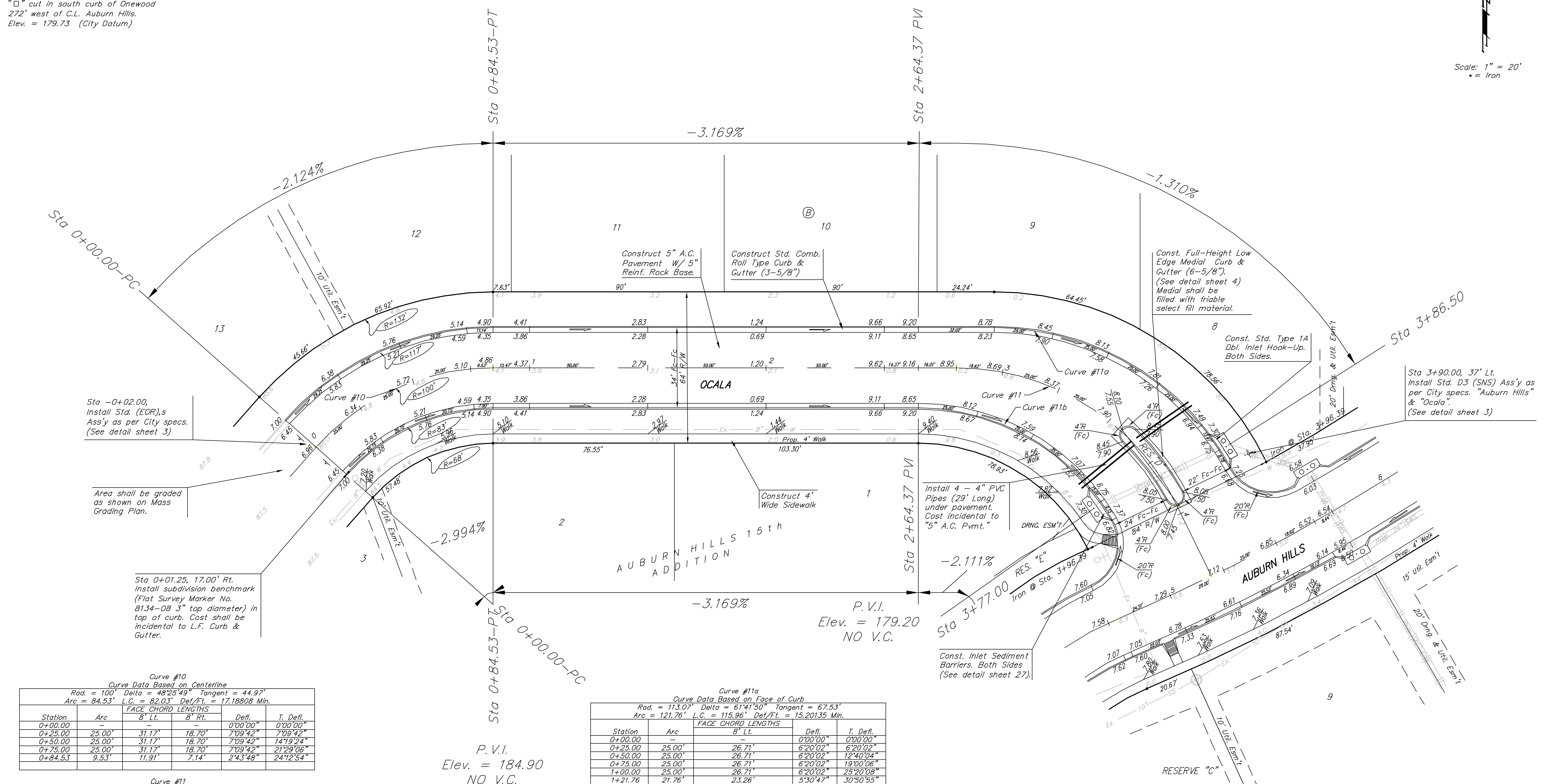
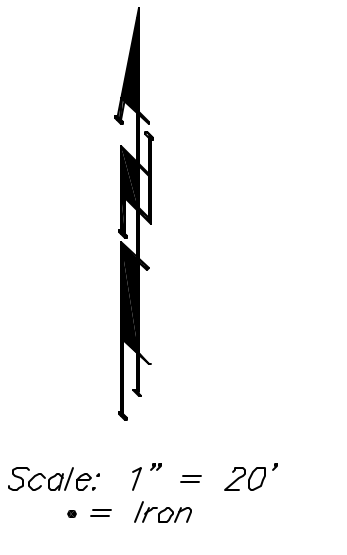

**Curve #10**  
 Curve Data Based on Centerline  
 Rad. = 100' Delta = 48°25'49" Tangent = 44.97'  
 Arc = 84.53' L.C. = 82.03' Def/Ft. = 17.18808 Min.

Station	Arc	FACE CHORD LENGTHS		Defl.	T. Defl.
		8' Lt.	8' Rt.		
0+00.00	-	-	-	0°00'00"	0°00'00"
0+25.00	25.00'	31.17'	18.70'	7°09'42"	7°09'42"
0+50.00	25.00'	31.17'	18.70'	7°09'42"	14°19'24"
0+75.00	25.00'	31.17'	18.70'	7°09'42"	21°29'06"
0+84.53	9.53'	11.91'	7.14'	2°43'48"	24°12'54"

**Curve #11**  
 Curve Data Based on Centerline  
 Rad. = 103.89' Delta = 63°58'37" Tangent = 64.89'  
 Arc = 116.01' L.C. = 110.07' Def/Ft. = 16.54433 Min.

Station	Arc	FACE CHORD LENGTHS		Defl.	T. Defl.
		8' Lt.	8' Rt.		
2+80.38	-	-	-	0°00'00"	0°00'00"
3+00.00	19.62'	24.30'	14.88'	5°24'36"	5°24'36"
3+25.00	25.00'	30.94'	18.94'	6°53'37"	12°18'12"
3+50.00	25.00'	30.94'	18.94'	6°53'37"	19°11'49"
3+75.00	25.00'	30.94'	18.94'	6°53'37"	26°05'25"
3+96.39	21.39'	26.49'	16.21'	5°53'53"	31°59'18"

**Curve #11a**  
 Curve Data Based on Face of Curb  
 Rad. = 113.07' Delta = 61°41'50" Tangent = 67.53'  
 Arc = 121.76' L.C. = 115.96' Def/Ft. = 15.20135 Min.

Station	Arc	FACE CHORD LENGTHS		Defl.	T. Defl.
		8' Lt.	8' Rt.		
0+00.00	-	-	-	0°00'00"	0°00'00"
0+25.00	25.00'	26.71'	16.20'	6°20'02"	6°20'02"
0+50.00	25.00'	26.71'	16.20'	6°20'02"	12°40'04"
0+75.00	25.00'	26.71'	16.20'	6°20'02"	19°00'06"
1+00.00	25.00'	26.71'	16.20'	6°20'02"	25°20'08"
1+21.76	21.76'	23.26'	13.50'	5°30'47"	30°50'55"

**Curve #11b**  
 Curve Data Based on Face of Curb  
 Rad. = 94.71' Delta = 59°59'10" Tangent = 54.67'  
 Arc = 99.15' L.C. = 94.69' Def/Ft. = 18.15011 Min.

Station	Arc	FACE CHORD LENGTHS		Defl.	T. Defl.
		8' Lt.	8' Rt.		
1+00.00	-	-	-	0°00'00"	0°00'00"
1+25.00	25.00'	22.82'	13.33'	7°33'45"	7°33'45"
1+50.00	25.00'	22.82'	13.33'	7°33'45"	15°07'30"
1+75.00	25.00'	22.82'	13.33'	7°33'45"	22°41'15"
1+99.15	24.15'	22.05'	11.82'	7°18'20"	29°59'35"

**NOTE:** ROLL TYPE CURB & GUTTER TO BE CONSTRUCTED ON THE PAVEMENT SHOWN ON THIS SHEET. TOP OF CURB ELEVATIONS ARE GIVEN FOR FULL HEIGHT CURB.

**AUBURN HILLS 15th ADDITION**  
**OCALA**  
 STA 0+00.00 TO STA 4+29.54

**BAUGHMAN COMPANY P.A.**  
 ENGINEERING, SURVEYING, & PLANNING  
 316-262-7271 • 315 ELLIS • WICHITA, KANSAS 67211

PROJECT NUMBER  
**472-83930**

DESIGN: NBW    DRAWN: ATD    APPROVED: [Signature]    DATE: 02/04    SCALE: Noted

SHEET **12** OF **48**