

BENCHMARKS:
 City Disc In T.C. Adj to F.H. 38'
 South of Intersection of Onewood
 and Auburn Hills.
 Elev. = 178.48 (City Datum)

"□" cut in south curb of Onewood
 272' west of C.L. Auburn Hills.
 Elev. = 179.73 (City Datum)

P.V.I.
 Elev. = 174.05
 49.05' V.C.



Scale: 1" = 20'
 • = Iron

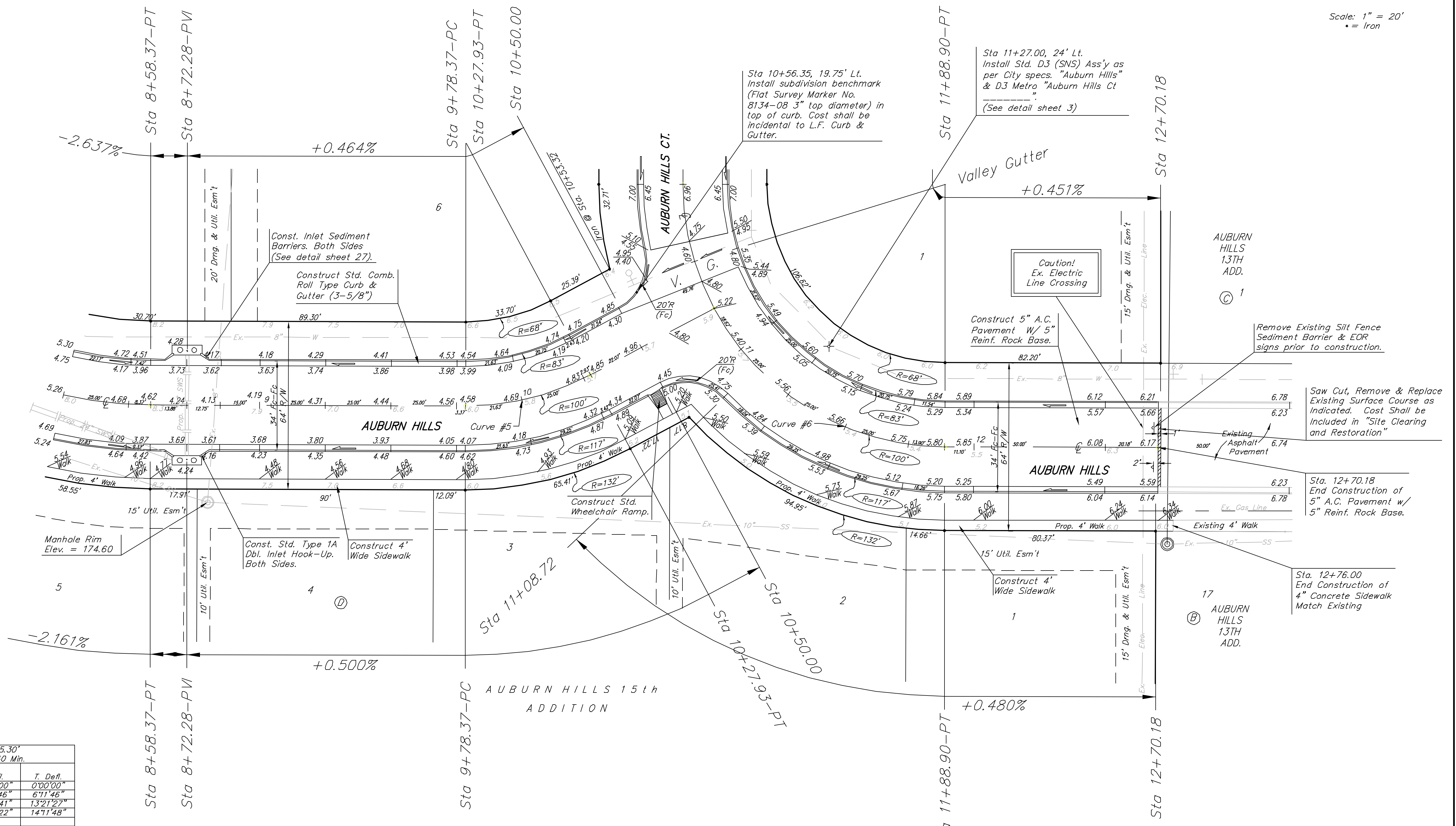

Curve #5
 Curve Data Based on Centerline
 Rad. = 100' Delta = 28°23'37" Tangent = 25.30'
 Arc = 49.56' L.C. = 49.05' Def./Ft. = 17.18740 Min.

Station	Arc	FACE CHORD LENGTHS		Defl.	T. Defl.
		B' Lt.	B' Rt.		
9+78.37	-	-	-	0°00'00"	0°00'00"
10+00.00	21.63'	16.19'	26.98'	6°11'46"	6°11'46"
10+25.00	25.00'	18.70'	31.17'	7°09'41"	13°21'27"
10+27.93	2.93'	2.20'	3.66'	0°50'22"	14°11'48"

Curve #6
 Curve Data Based on Centerline
 Rad. = 100' Delta = 61°36'23" Tangent = 59.62'
 Arc = 107.52' L.C. = 102.42' Def./Ft. = 17.18928 Min.

Station	Arc	FACE CHORD LENGTHS		Defl.	T. Defl.
		B' Lt.	B' Rt.		
10+81.38	-	-	-	0°00'00"	0°00'00"
11+00.00	18.62'	13.95'	23.24'	5°20'04"	5°20'04"
11+25.00	25.00'	18.70'	31.17'	7°09'44"	12°29'48"
11+50.00	25.00'	18.70'	31.17'	7°09'44"	19°39'32"
11+75.00	25.00'	18.70'	31.17'	7°09'44"	26°49'16"
11+88.90	13.90'	10.42'	17.36'	3°58'56"	30°48'11"

P.V.I.
 Elev. = 174.05
 50.95' V.C.

NOTE:
 ROLL TYPE CURB & CUTTER TO
 BE CONSTRUCTED ON THE
 PAVEMENT SHOWN ON THIS SHEET.
 TOP OF CURB ELEVATIONS ARE
 GIVEN FOR FULL HEIGHT CURB.

AUBURN HILLS 15th ADDITION
AUBURN HILLS
 STA 8+58.37 TO STA 12+70.18

BAUGHMAN COMPANY P.A.
 ENGINEERING, SURVEYING, & PLANNING
 318-282-7271 • 315 ELLIS • WICHITA, KANSAS 67211

DESIGN NBW	DRAWN ATD	APPROVED	DATE 02/04	SCALE Noted
PROJECT NUMBER 472-83830			SHEET 9 OF 48	