

NOTE:
Easements on both sides of roadway are "15' Street, Drainage, Sidewalk, & Utility Easements."

NOTE:
Electric Service to existing home may be installed prior to water main installation. Contractor shall field verify prior to construction.

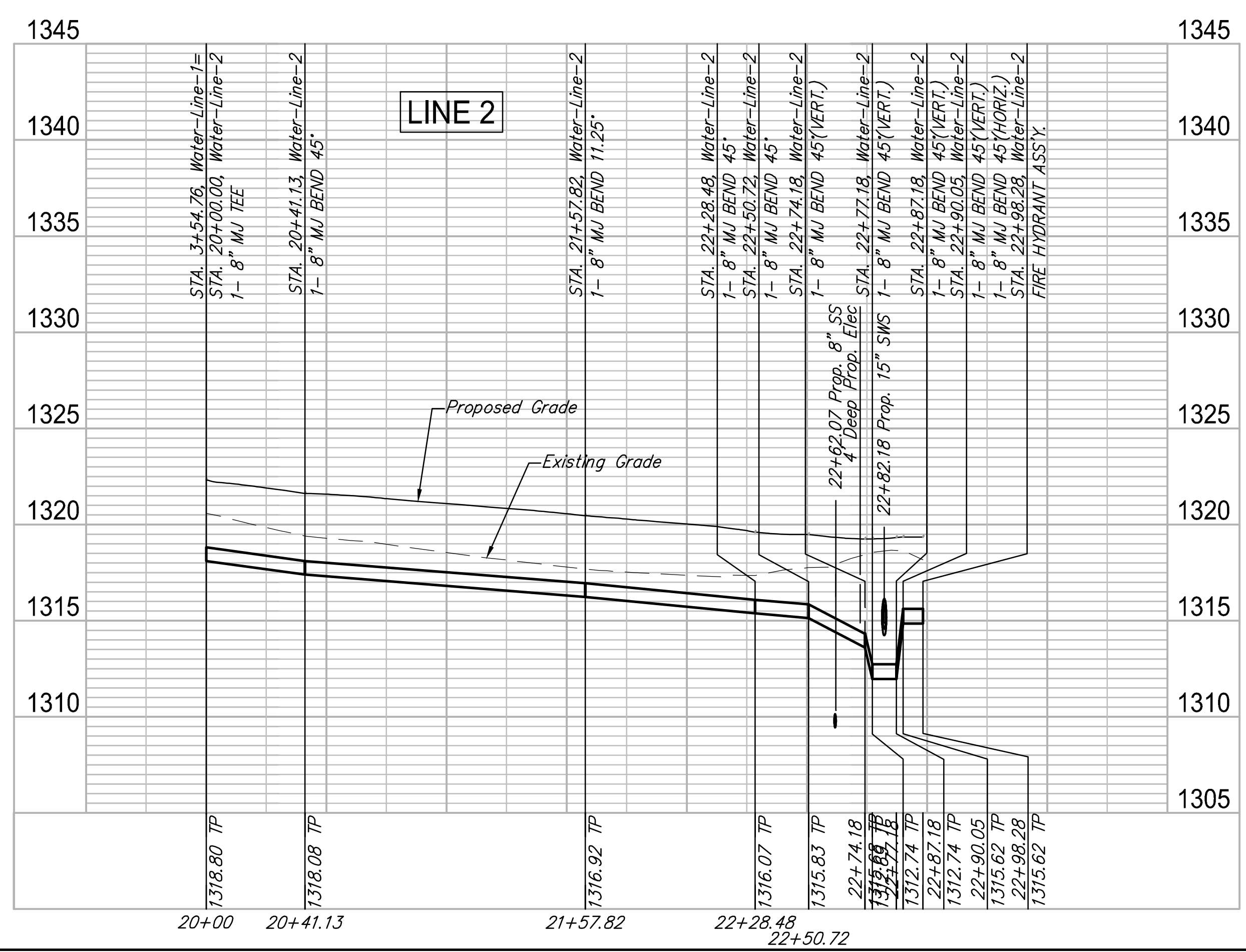

NOTE:
Protection Fill will be required from Sta. 20+00 to Sta. 22+50 if waterline is installed prior to completion of Site Grading. Incidental to "Site Clearing."

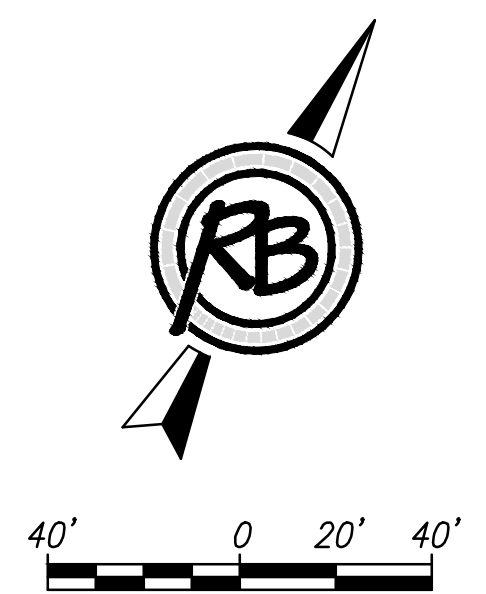

REVIEW	2/14/2015
DATE	2/24/2015
DESIGN	KL
DRAWN	DPS
PROJECT NUMBER	448-90642
DRAWING FILE	4372E Engineering Base

The Steppes at Ark Valley
Water Line 2
Wichita, Kansas