

Plotted By: svb Date: 2/20/2015 10:48:20 AM
 FILE: U:\Wichita\Civil\2014\136\000\Trans\Road\DN Project\Traffic Control\136-TC Stage\37th 102.dgn

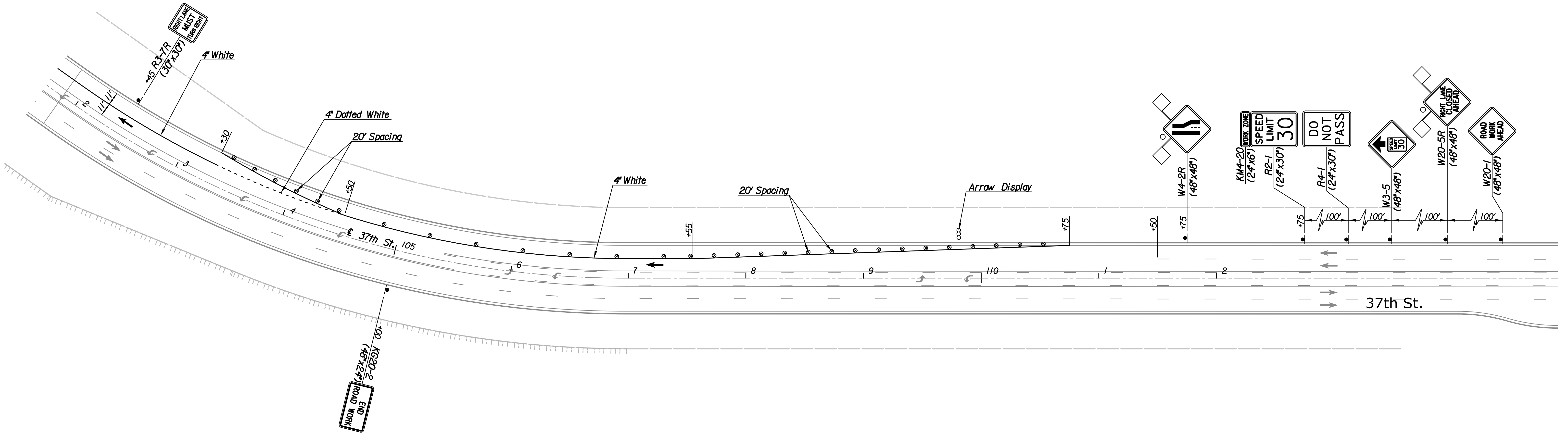
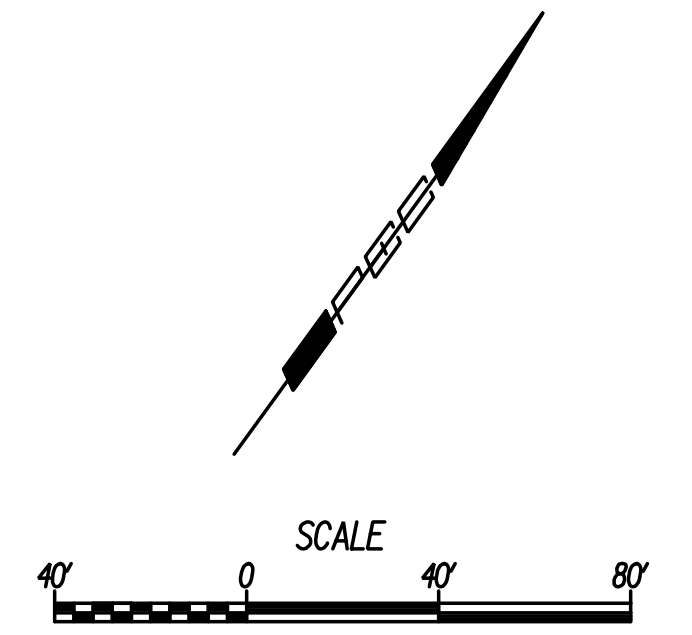

Note: Utilities are not shown on Traffic Control Plans. The Contractor is responsible for verification as to type and location of underground utilities as may be necessary to avoid damage thereto. The Contractor is responsible for repairing any damage to underground utilities.

- LEGEND**
- ⊙ Channelizing Device at 40' Spacing unless otherwise Noted.
 - Traffic Control Sign
 - Yellow Type "A" Low Intensity Warning Light
 - ◊ 18"x18" Fluorescent Red-Orange Flags
 - Direction of Traffic

Note: Signs and barricades are shown diagrammatically only. Contractor will be responsible to install the required number of posts to support the installation.

No.		Revision		By		Date	
37TH ST.							
TRAFFIC CONTROL PLAN							
STAGE 1 & 2 - STA. 102+00 TO STA. 112+00							
GARY JANZEN, P.E.-CITY ENGINEER CITY OF WICHITA PROJECT NO. 472-85161							
				PROFESSIONAL ENGINEERING CONSULTANTS, P.A. 303 SOUTH TOPEKA WICHITA, KS 67202 316-262-2691 www.pec1.com			
Designed by		JPS		Job No.		14136	
Drawn by		SVB		Date		Feb., 2015	
							Sht. 43 of 62