

**BENCHMARK:**  
 BM #5 - "□" Chiseled on Top of Curb at West End of Median at Brookview Entrance  
 Sta. 36+66, 62' Rt.  
 Elev. = 1352.54 (NGVD 29)

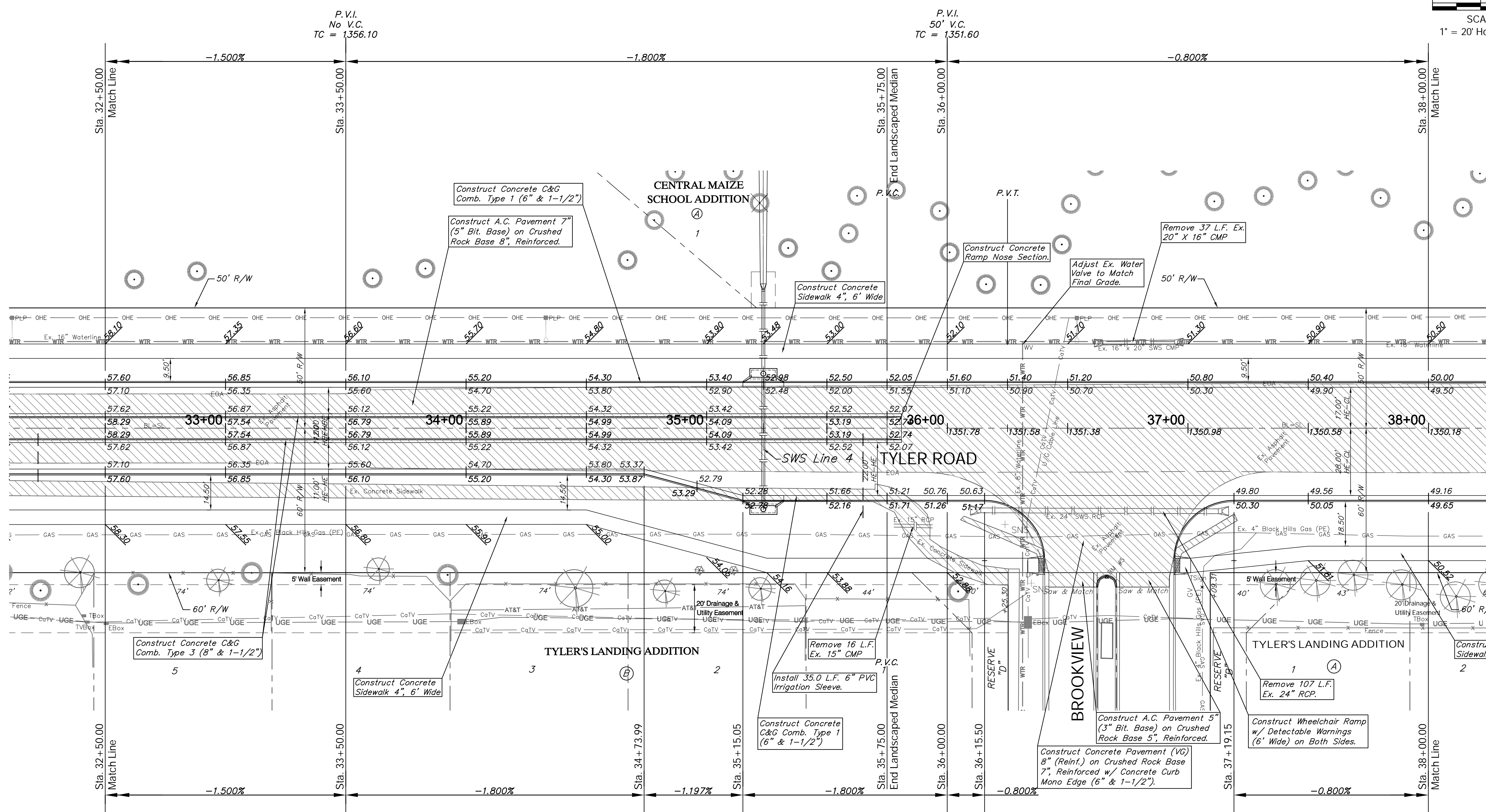

**Note:**  
 Pavement, Sidewalks, Etc. To Be Removed Are Indicated By:

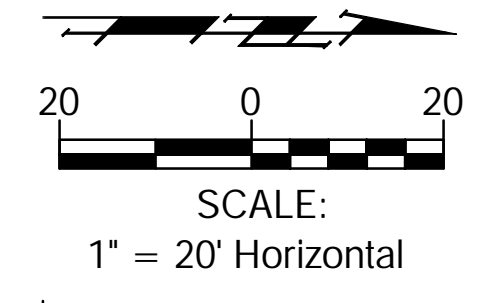
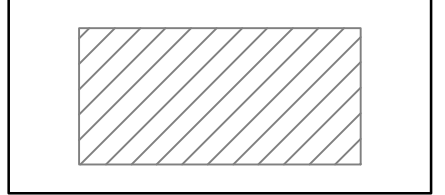

Drawing File: E:\eng\Tyler\29th to 37th\Land\tyler Base.dwg (Pav07)  
 Project No. 0802E057 CAPITAL IMPROVEMENT PROJECT  
**TYLER ROAD PAVING**  
 Sta. 32+50.00 to Sta. 38+00.00  
 TYLER ROAD - 29TH STREET NORTH to 37TH STREET NORTH

**Baughman Company, P.A.**  
 315 Ellis St., Wichita, KS 67211 P 316.262.7271 F 316.262.0149  
 ENGINEERING | SURVEYING | PLANNING | LANDSCAPE ARCHITECTURE

March 2015  
 SHEET 16 OF 95