

LANDSCAPE NOTES

- All landscape work shall be done in accordance with industry standards.
- Refer to Engineer's Seeding plan for all turf ground cover, except turf in medians. Median turf shall be sodded with Buffalo Sod
- Trees with broken leaders or no central leader will not be accepted.
- All planting beds shall be prepared by killing all existing vegetation with Round-Up (or equal) according to label directions. A Pre-emergent herbicide such as Treflan (5%) (or equal) shall be applied per label directions. All planting beds to receive 2" organic matter (such as cotton bur mulch, compost, or humus) and shall be rototilled in to a depth of 10-12".
- Mulch all planting beds with min. 3" of mulch. Mulch all tree saucer wells with min. 3" of mulch. Mulch material to be shredded cypress mulch of uniform consistency.
- Metal edging shall be used to separate all turf areas from planting beds. Edging shall be 10 gauge thickness, commercial grade, or approved equal.
- Topsoil hauled onto site shall be fertile, friable, natural loam topsoil, of uniform quality characteristic of representative local soils which produce heavy growth of crops, grass, or other vegetation. It shall be free of trash, or other matter toxic to plant growth.
- Topsoil shall be delivered in an unfrozen and non- muddy condition and shall be subject to approval by the Landscape Architect.
- Prior to any excavation for landscaping purposes the location of underground utilities shall be determined by calling Kansas One Call at 687-2470/1-800-344-7233. Contractor shall be responsible for any damage done to existing utilities.
- Report any discrepancies in the planting plan to the Landscape Architect, prior to starting construction.
- The Landscape Contractor shall coordinate with the G.C. to gain site access to install the plants and maintain grounds, until final acceptance from owner. Upon final acceptance, the one (1) year guarantee period will begin.
- The Landscape Contractor shall coordinate with the G.C. to install the plants and maintain grounds, until final acceptance from owner.
- The Landscape Contractor shall submit bid with unit prices for all plants, including mulch, installation, 1 year guarantee, bed preparation, fertilizer, etc.
- The Landscape Contractor is responsible for any damage done to sidewalks, curbs, pavement, utilities, existing trees to remain, or adjacent property not within project limits when installing or maintaining the plantings before final acceptance.
- General Contractor to coordinate with appropriate Local City Official to Remove/Transplant existing trees.
- Fall planting season shall be September 1 through October 31. Spring planting season shall be April 1 through June 30. For grass seeding, fall season shall be September 1 through mid October. Spring season for seeding shall be from March 15 through mid May.
- Quantities listed on the plant palette are for informational purposes only. Landscape Contractor shall be responsible for calculating quantities necessary to complete the installation of these plans.
- Landscape Contractor shall provide maintenance until final project acceptance including landscape maintenance and watering.

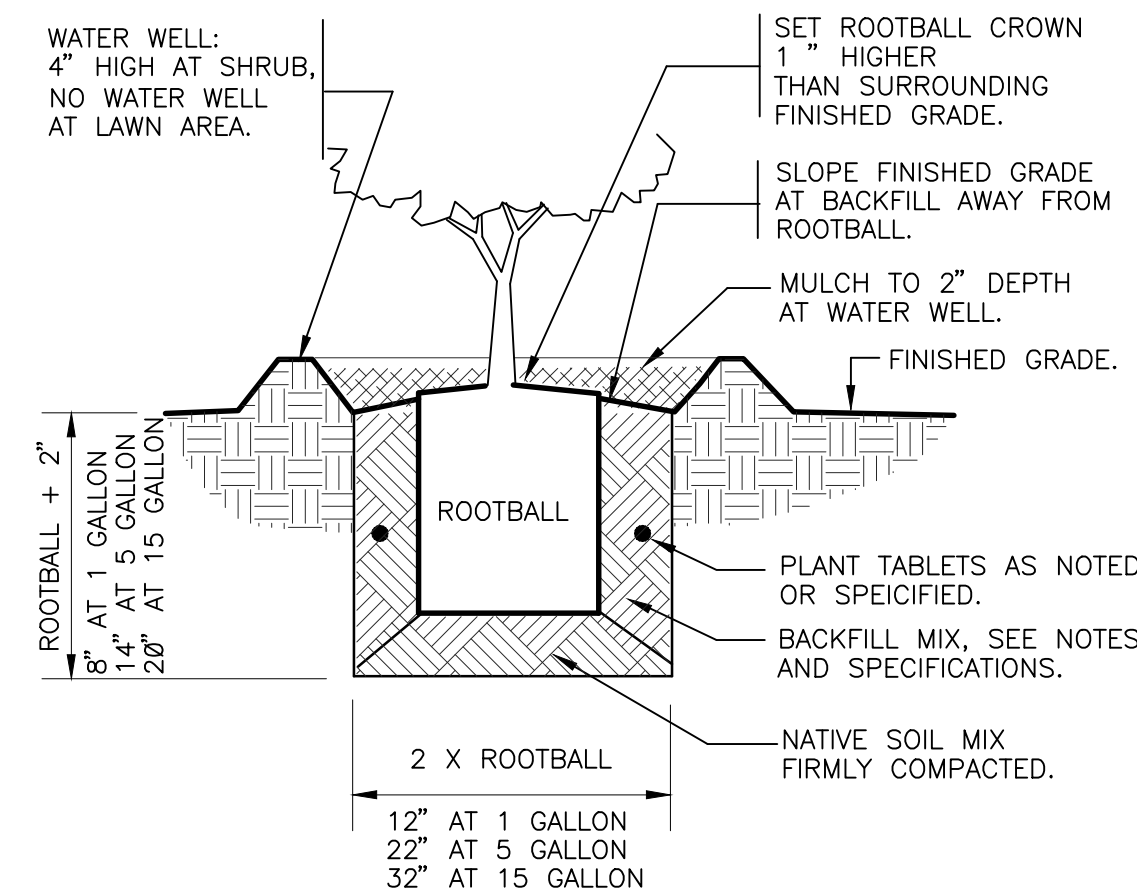

1 SHRUB PLANTING
1" = 1'-0" 329333.13-01

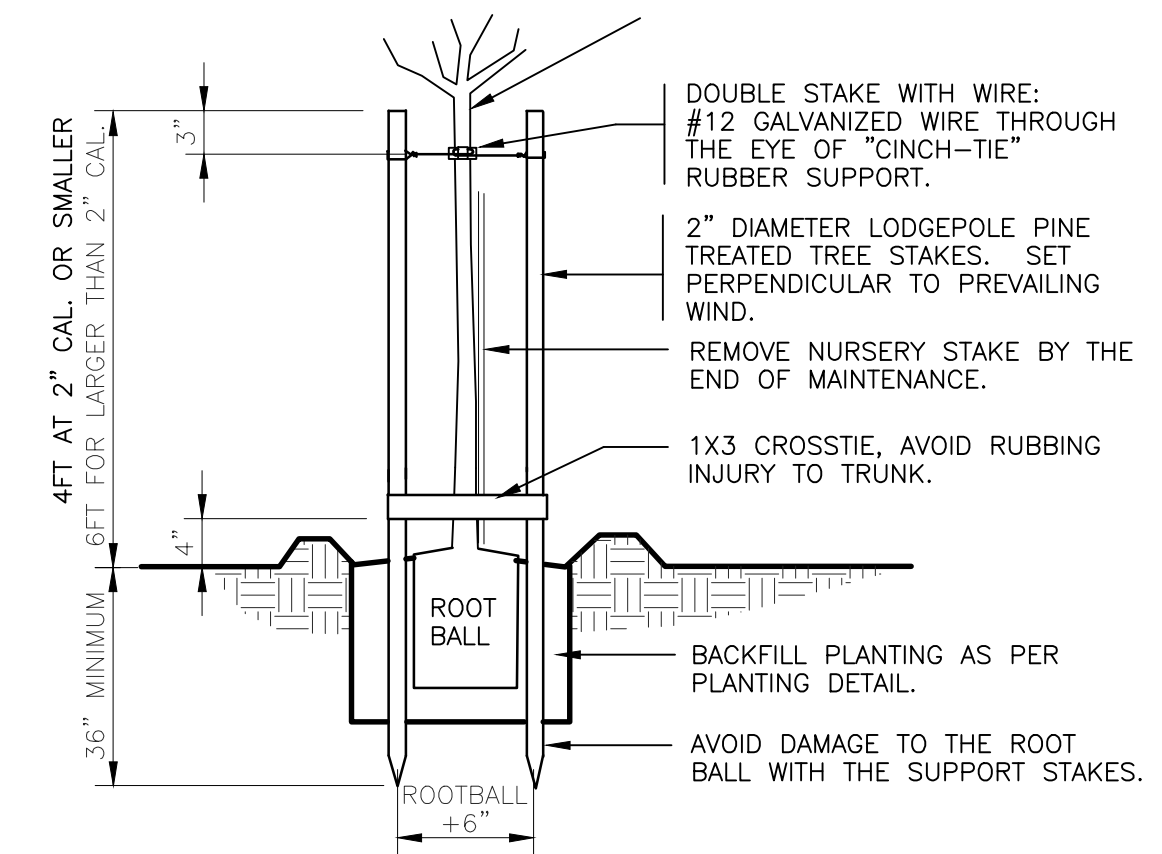

STAKING DETAIL

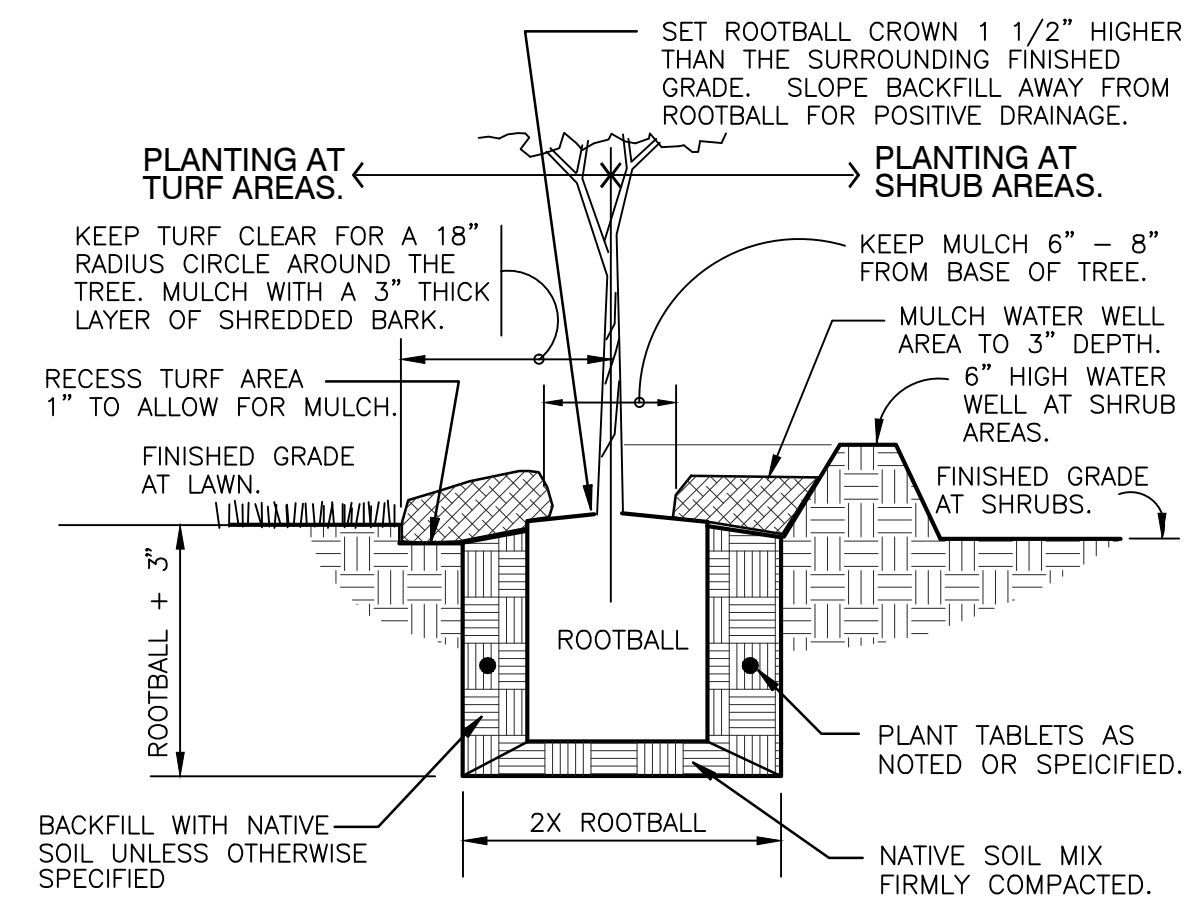

PLANT PIT DETAIL

2 TREE PLANTING DOUBLE STAKE B&B
1" = 1'-0" 329343.19-04

PLANT SCHEDULE

DECIDUOUS TREES	BOTANICAL NAME	COMMON NAME	CONT	CAL	SIZE
3	<i>Acer truncatum</i>	Shantung Maple	B & B	2"Cal	
7	<i>Cercis canadensis texensis 'Oklahoma Whitebud'</i>	Oklahoma Whitebud	B & B	2"Cal	
13	<i>Cercis canadensis 'Oklahoma'</i>	Oklahoma Redbud	B & B	2"Cal	
19	<i>Chionanthus retusus</i>	Chinese Fringe Tree	B & B	2"Cal	
29	<i>Malus x 'Prairifire'</i>	Prairifire Crab Apple	B & B	2"Cal	
13	<i>Pistacia chinensis</i>	Chinese Pistache	B & B	2"Cal	
14	<i>Quercus bicolor</i>	Swamp White Oak	B & B	2"Cal	
29	<i>Quercus robur x alba 'Crimson Spire'</i>	Crimson Spire Oak	B & B	2"Cal	
12	<i>Ulmus parvifolia 'Allee'</i>	Allee Lacebark Elm	B & B	2"Cal	
19	<i>Zelkova serrata 'Musashino'</i>	Sawleaf Zelkova	B & B	2"Cal	
EVERGREEN TREES	BOTANICAL NAME	COMMON NAME	CONT	CAL	SIZE
13	<i>Juniperus virginiana 'Canaertii'</i>	Canaerti Juniper	B & B		8'-10' H

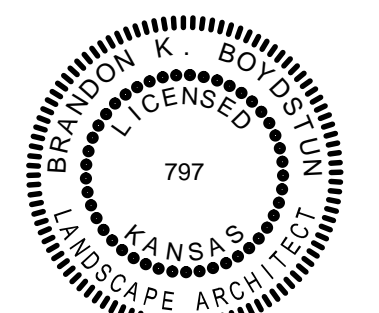

The above Seal and Signature is for the Landscape portions of this project only. (Sheets 69-78)

Drawing File: ...Projects\Tyler29th to 37th\Landscape

Design: BKB
Drawn: BKB
Approved:
Scale: 1"=20'

Project No. 08-02-E051 CAPITAL IMPROVEMENT PROJECT
Tyler Road Landscape
Sta. 0+00 to Sta. 4+79
Tyler Road 29th Street North to 37th Street North

Baughman Company, P.A.
315 Ellis St. Wichita, KS 67211 P 316-262-7271 F 316-262-0149
ENGINEERING | SURVEYING | PLANNING | LANDSCAPE ARCHITECTURE

March 2015
SHEET 69 OF 95