

PLOTTED: Tuesday, May 12, 2015 @ 01:25PM

PAVING & INCIDENTAL DRAINAGE FOR
17TH STREET SANITARY SEWER
WICHITA, KANSAS

©2015 MKEC Engineering All Rights Reserved
www.mkec.com
These drawings and their contents, including, but not limited to, all concepts, designs, & ideas are the exclusive property of MKEC Engineering (MKEC), and may not be used or reproduced in any way without the express consent of MKEC.

PAVING REPLACEMENT & SITE RESTORATION PLANS

PROJECT NO.	468-85021	
DATE	MARCH 2015	
SCALE	AS SHOWN	
DESIGNED	DRAWN	CHECKED
JRA	LES	JRA
NO.	REVISION	DATE
SHEET NO.	21 OF 51	

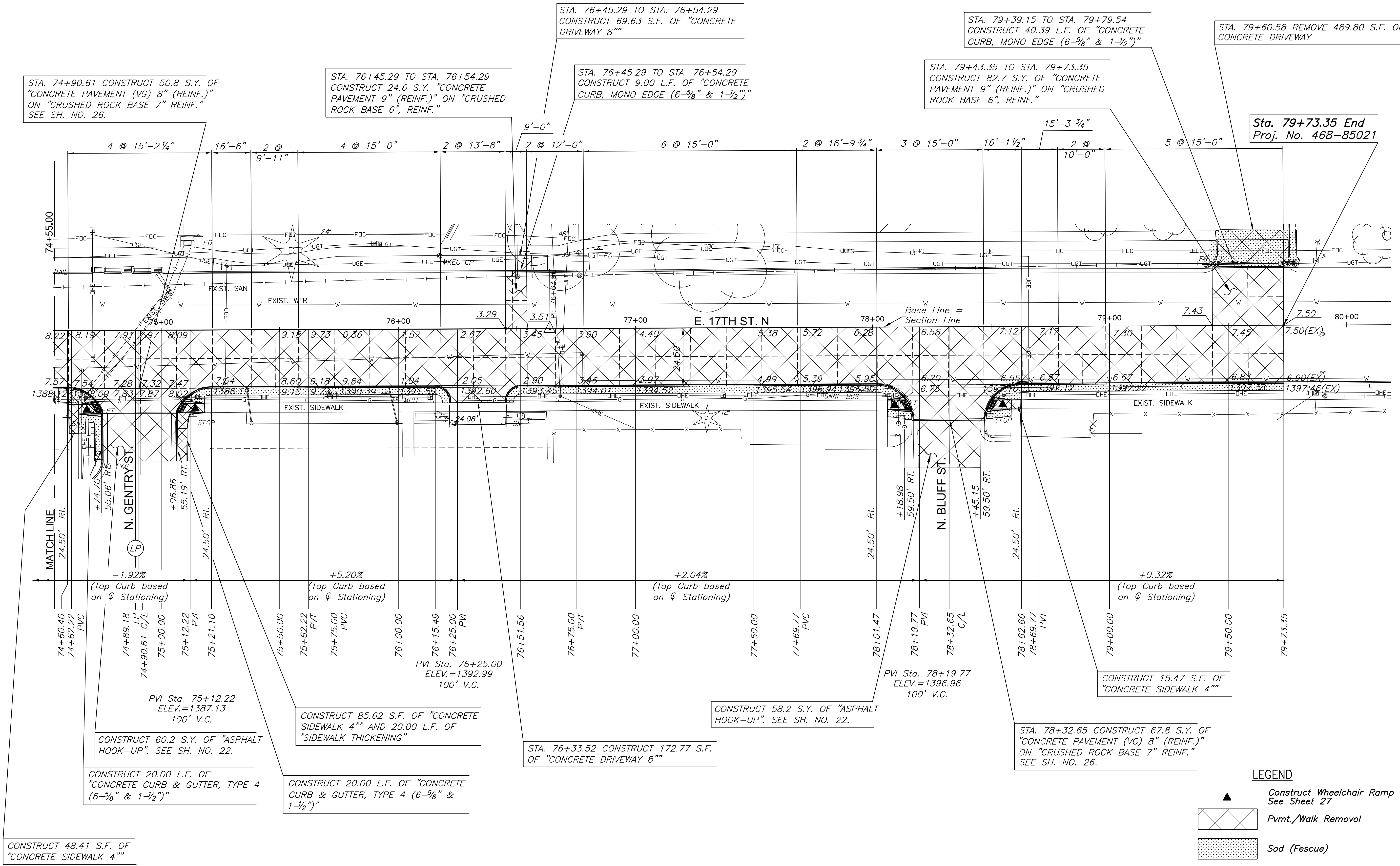

STA. 74+90.61 CONSTRUCT 50.8 S.Y. OF "CONCRETE PAVEMENT (VG) 8" (REINF.)" ON "CRUSHED ROCK BASE 7" REINF." SEE SH. NO. 26.

STA. 76+45.29 TO STA. 76+54.29 CONSTRUCT 24.6 S.Y. "CONCRETE PAVEMENT 9" (REINF.)" ON "CRUSHED ROCK BASE 6", REINF."

STA. 76+45.29 TO STA. 76+54.29 CONSTRUCT 69.63 S.F. OF "CONCRETE DRIVEWAY 8"

STA. 76+45.29 TO STA. 76+54.29 CONSTRUCT 9.00 L.F. OF "CONCRETE CURB, MONO EDGE (6-5/8" & 1-1/2")"

STA. 79+39.15 TO STA. 79+79.54 CONSTRUCT 40.39 L.F. OF "CONCRETE CURB, MONO EDGE (6-5/8" & 1-1/2")"

STA. 79+43.35 TO STA. 79+73.35 CONSTRUCT 82.7 S.Y. OF "CONCRETE PAVEMENT 9" (REINF.)" ON "CRUSHED ROCK BASE 6", REINF."

STA. 79+60.58 REMOVE 489.80 S.F. OF CONCRETE DRIVEWAY

Sta. 79+73.35 End Proj. No. 468-85021

MATCH LINE
24.50' Rt.

-1.92%
(Top Curb based on ϕ Stationing)

+5.20%
(Top Curb based on ϕ Stationing)

+2.04%
(Top Curb based on ϕ Stationing)

+0.32%
(Top Curb based on ϕ Stationing)

PVI Sta. 75+12.22
ELEV.=1387.13
100' V.C.

PVI Sta. 76+25.00
ELEV.=1392.99
100' V.C.

PVI Sta. 78+19.77
ELEV.=1396.96
100' V.C.

CONSTRUCT 60.2 S.Y. OF "ASPHALT HOOK-UP". SEE SH. NO. 22.

CONSTRUCT 20.00 L.F. OF "CONCRETE CURB & GUTTER, TYPE 4 (6-5/8" & 1-1/2")"

CONSTRUCT 85.62 S.F. OF "CONCRETE SIDEWALK 4" AND 20.00 L.F. OF "SIDEWALK THICKENING"

CONSTRUCT 20.00 L.F. OF "CONCRETE CURB & GUTTER, TYPE 4 (6-5/8" & 1-1/2")"

STA. 76+33.52 CONSTRUCT 172.77 S.F. OF "CONCRETE DRIVEWAY 8"

CONSTRUCT 58.2 S.Y. OF "ASPHALT HOOK-UP". SEE SH. NO. 22.

CONSTRUCT 15.47 S.F. OF "CONCRETE SIDEWALK 4"

STA. 78+32.65 CONSTRUCT 67.8 S.Y. OF "CONCRETE PAVEMENT (VG) 8" (REINF.)" ON "CRUSHED ROCK BASE 7" REINF." SEE SH. NO. 26.

CONSTRUCT 48.41 S.F. OF "CONCRETE SIDEWALK 4"

NOTES:
JOINT SPACING IS SHOWN FOR INFORMATION ONLY. IT IS IMPORTANT THAT TRANSVERSE JOINTS BE PROVIDED TO MATCH THE TRANSVERSE JOINTS OF THE ADJACENT EXISTING PAVEMENT.

LEGEND

- Construct Wheelchair Ramp See Sheet 27
- Pvmnt./Walk Removal
- Sod (Fescue)



J:\PROJECTS\2014\1401073_COW_17TH STREET SANITARY SEWER\DWG\CAD\PAV\1473_LPR05.DWG