

- NOTES:
- INSTALL FLOWABLE FILL ON ALL STORM SEWER ON THIS PROJECT.
 - UTILITIES SHOWN TO BE REMOVED OR ABANDONED SHOULD BE CONSIDERED TO BE IN CONFLICT AT THE TIME OF CONSTRUCTION. THE CONTRACTOR SHALL BE RESPONSIBLE FOR THE ADJUSTMENT OF LINES IN CONFLICT THAT MUST REMAIN IN SERVICE AT THE TIME, COSTS SUBSIDIARY TO PIPE. THE ABANDONMENT OR REMOVAL OF LINES IS DEPENDANT ON THE ACTUAL CONSTRUCTION PHASING OF THE PROJECT.

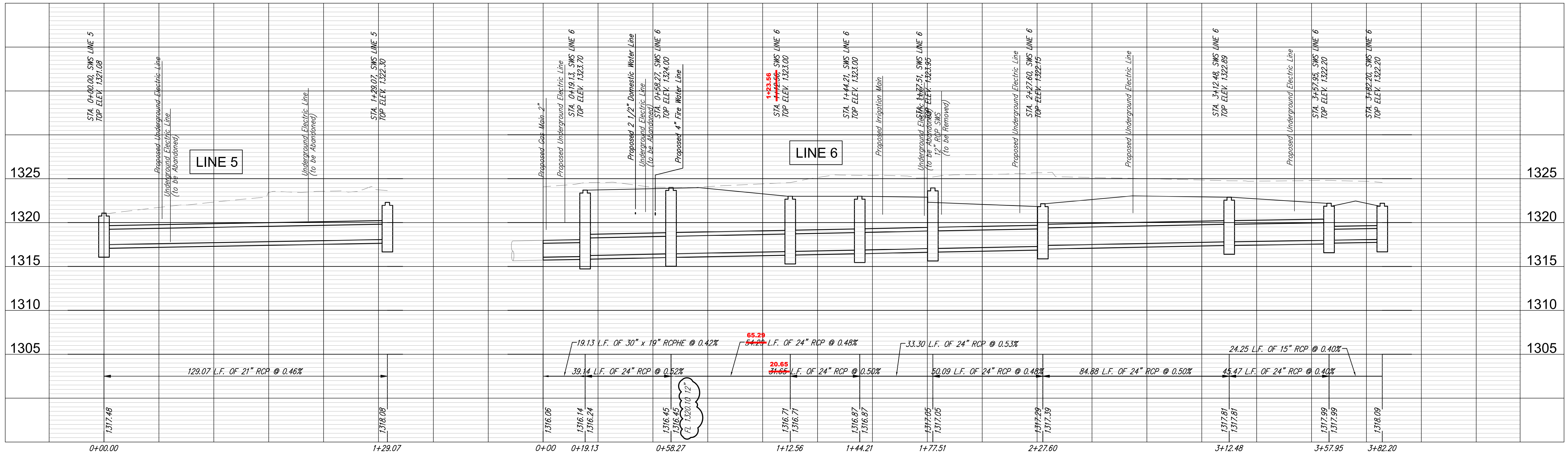

| NO. | DATE | DESCRIPTION |
|-----|----------|------------------------|
| 1 | 05-08-13 | Update for Addendum #5 |
| 2 | 05-21-11 | CONFORMED DOCUMENTS |

PROJECT NO. NS-2011-443
DRAWN BY RA
CHECKED BY GMB

The Drawings are the property of Carl Walker, Inc. and are not to be reused or reproduced without written permission from Carl Walker, Inc.

SHEET TITLE
STORM SEWER PLAN / PROFILES

C104.3

