

NOTE:
 2 - EX 1" TAPS 14.5' W AND 37.5' N OF NE CORNER OF HOUSE AT 1823 E MACFARLAND. CONTRACTOR SHALL PLUG AND ABANDON EX TAPS.

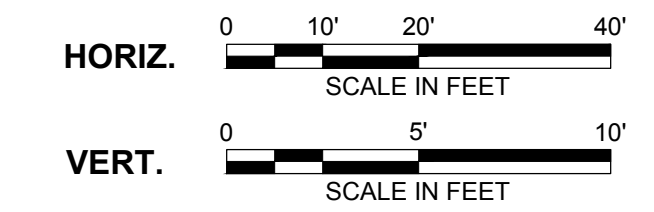

- NOTE:**
- REFER TO THE WATER SERVICE TRANSFER TABLES, DRAWINGS C092 - C093 FOR METER RELOCATES.
 - INSTALL WATERMAIN BY DIRECTIONAL DRILLING UNLESS OTHERWISE NOTED.
 - FOR SANITARY SEWER CROSSINGS LESS THAN 24" VERTICAL CLEARANCE FROM WATERMAIN, REBUILD SANITARY SEWER PER SPECIFICATION 803.4a.

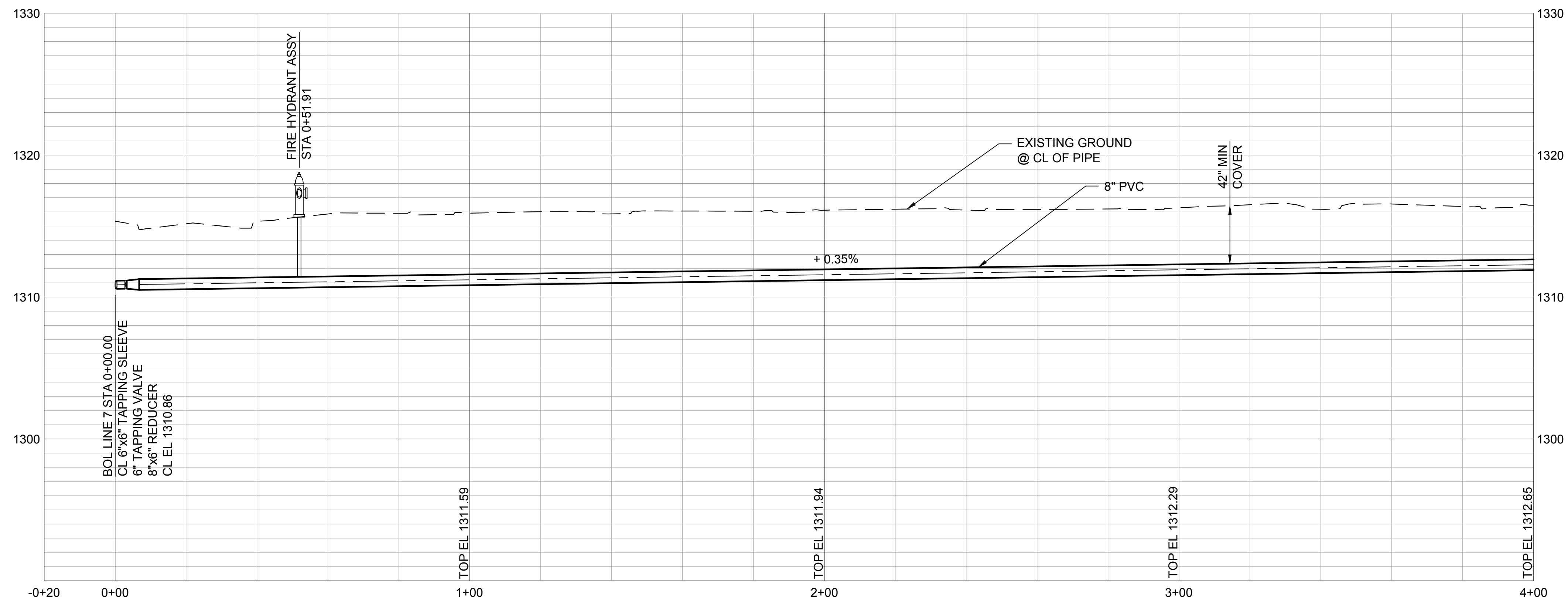

Burns & McDonnell
 SINCE 1958
 9400 WARD PARKWAY
 KANSAS CITY, MO 64114
 816-333-9400
 LICENSEE NO. 000165

date APRIL 24, 2014	detailed M. CHARRETTE
designed J. MCNIFF	checked S. WILSON

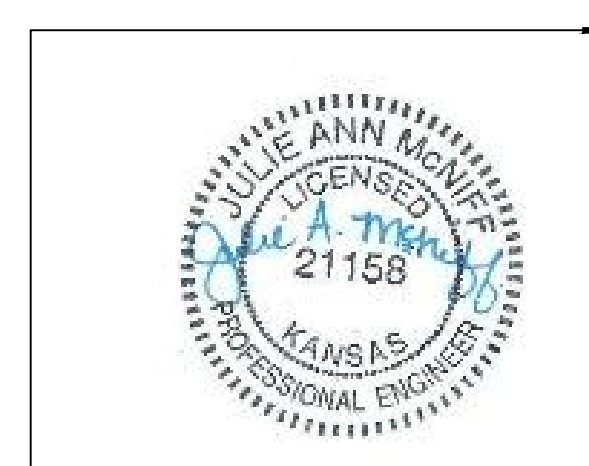

This document has been digitally signed.
 05/08/15 9:44 AM

ETHEL NEIGHBORHOOD WATER MAIN REPLACEMENT
 LINE 7 - N MINNEAPOLIS STREET (MCFARLAND TO 25TH STREET)

project 77025	contract 448-90612	
drawing C020 - 0		
sheet 27	of 101	sheets
file LINE 7.dwg		