

OLD MANOR & 2nd STREET DETAIL
LINE 5, PAGE 17, & LINE 10, PAGE 29

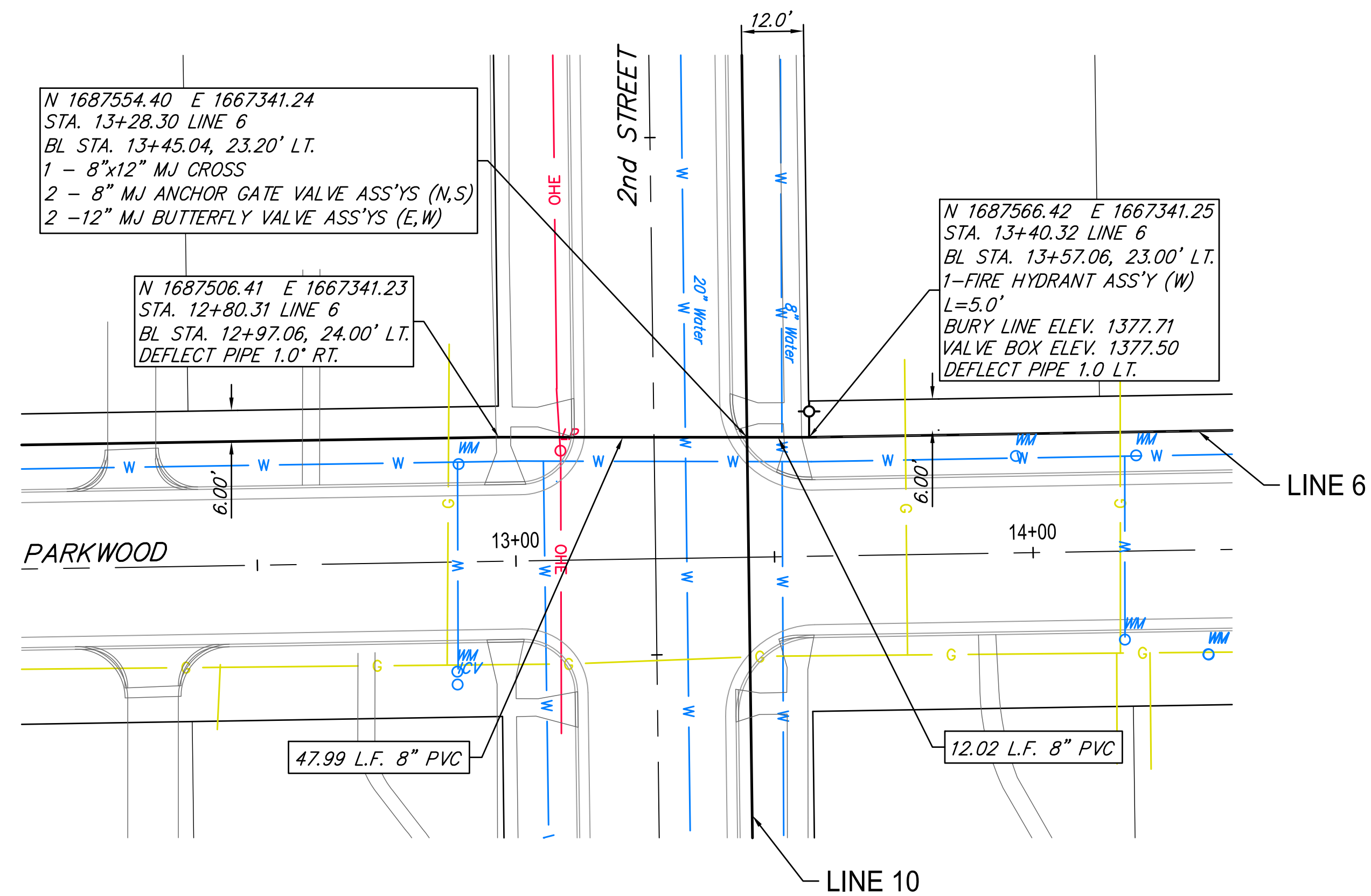

PARKWOOD & 2nd STREET DETAIL
LINE 6, PAGE 20, & LINE 10, PAGE 29

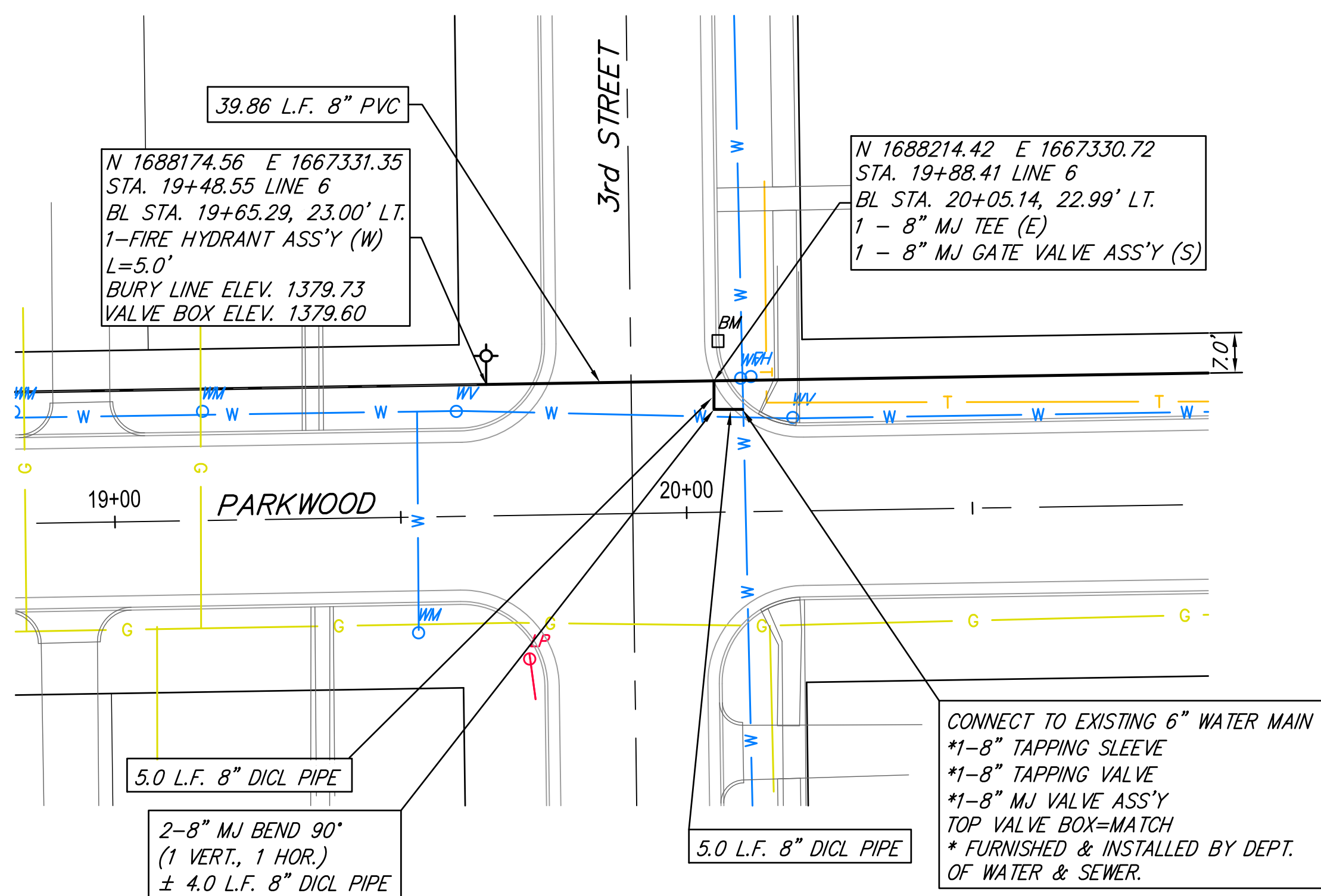

PARKWOOD & 3rd STREET DETAIL
LINE 6, PAGE 21

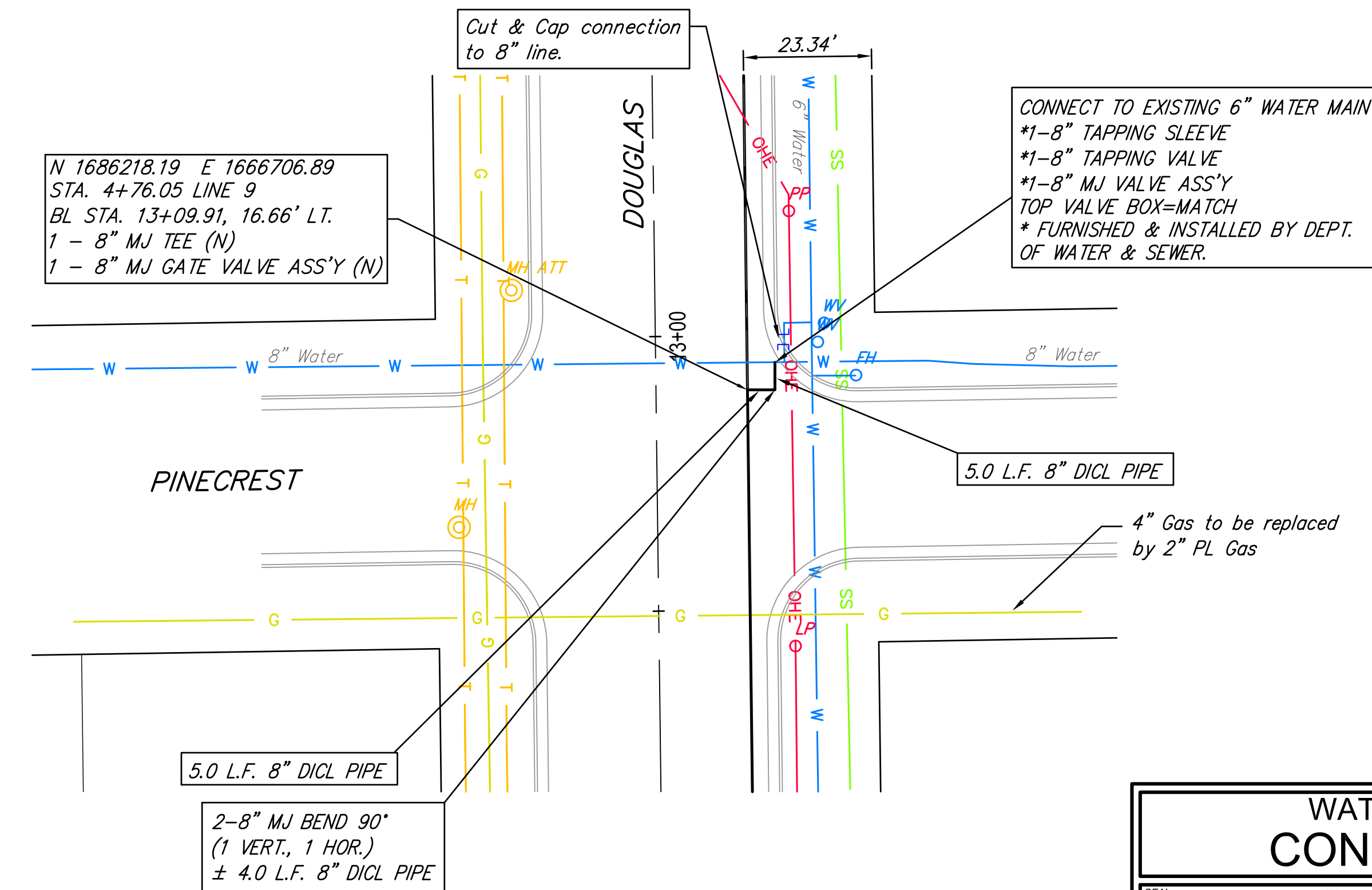

DOUGLAS & PINECREST DETAIL
LINE 9, PAGE 27

Existing Pavement, Curb and Gutter to be Removed and Replaced as necessary for construction. No additional pay shall be made for this work, *Subsidiary* to other pay items.

WATER MAIN REPLACEMENT CONNECTION DETAILS		DATE: 09/29/2015
	RUGGLES & BOHM	
	<small>ENGINEERING SURVEYING LANDSCAPE ARCHITECTURE GOVERNMENT</small> 924 NORTH MAIN WICHITA, KANSAS 67203 P (316) 264-8008 F (316) 264-4021 WWW.RUGGLESANDBOHM.COM	
PROJECT NUMBER: 448-90611	RB JOB NO.: 4227W	DWG. SCALE: 1" = 20'
DRAWING FILE: Plaza Engineering Base [CONNECTION DETAILS]		SHEET: 34 OF 40