

20" MAIN DISCONNECT DETAIL

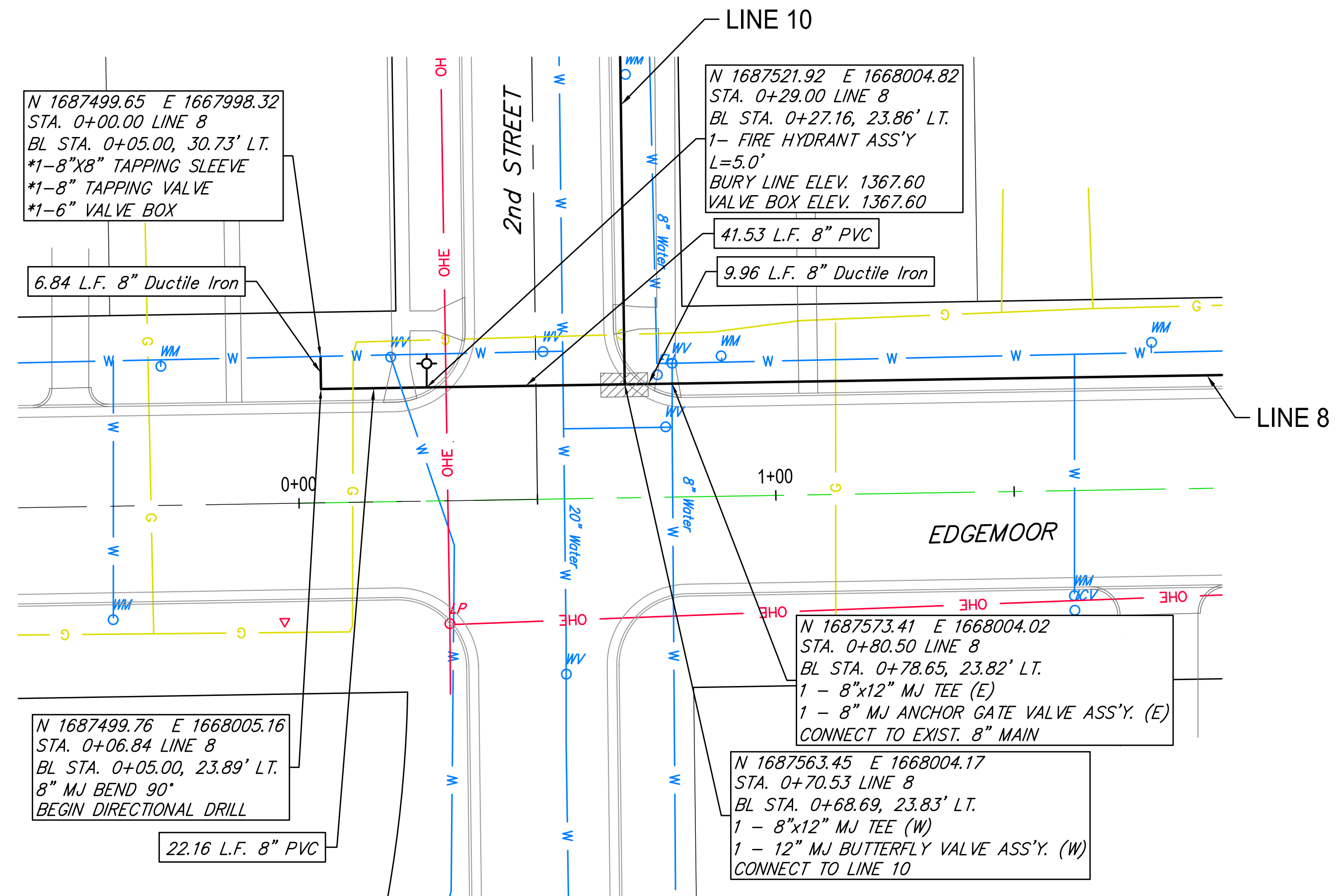

EDGEMOOR & 2nd STREET DETAIL  
LINE 8, PAGE 25, & LINE 10, PAGE 29

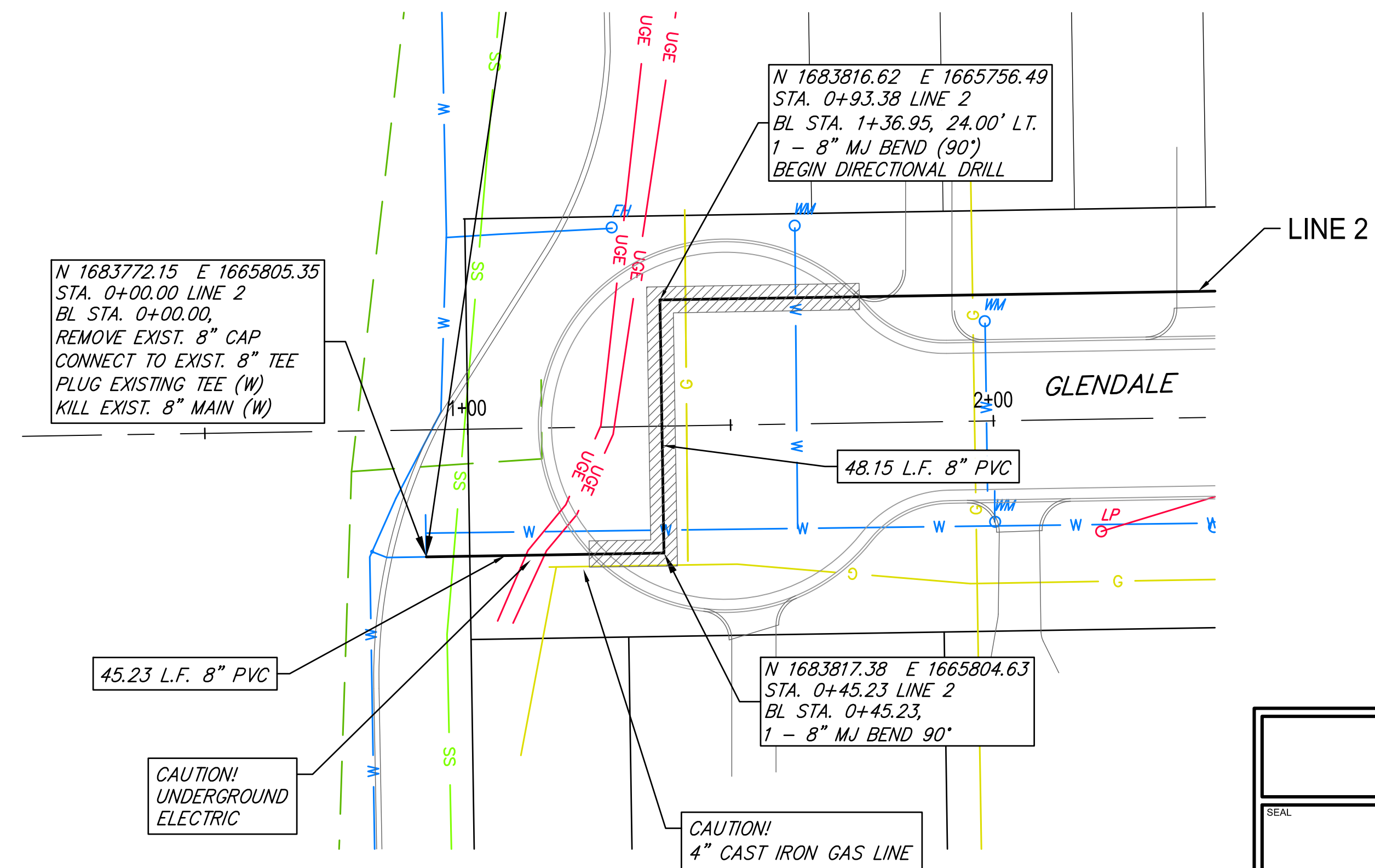

GLENDALE & KELLOGG DETAIL  
LINE 2, PAGE 8

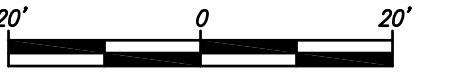
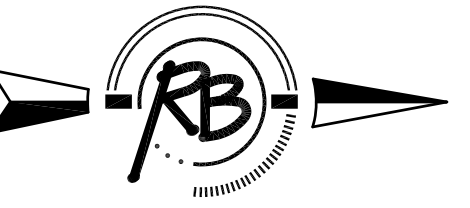

Existing Pavement, Curb and Gutter to be Removed and Replaced as necessary for construction. No additional pay shall be made for this work, Subsidiary to other pay items.

WATER MAIN REPLACEMENT CONNECTION DETAILS			
			DATE: 09/29/2015 DESIGN: RA / EJG DRAWN: RA / DRS REVIEW: RA / DRS SHEET: 35 OF 40
	ENGINEERING   SURVEYING   LANDSCAPE ARCHITECTURE   GOVERNMENT 924 NORTH MAIN WICHITA, KANSAS 67203 P (316) 264-8008 F (316) 264-4021 WWW.RB-KANSAS.COM		
PROJECT NUMBER: 448-90611 DRAWING FILE: Plaza Engineering Base [CONNECTION DETAILS]	RB JOB NO.: 4227W DWG. SCALE: 1" = 20'	(c) Copyright 2014, Ruggles & Bohm, P.A.	