

W 1/4 Cor., Sec. 29, T26S, R1E
 1. "+" Cut TC 8.041 m W
 2. "+" Cut TC 15.987 m SW
 3. "+" Cut TC 8.096 m E
 4. PK Nail & Washer in Power Pole 10.592 m E
 5. N=523514.536, E=499381.769

FHWA REG NO.	STATE	PROJECT NO.	YEAR	SHEET NO	TOTAL SHEETS
7	KANSAS	87N-0116-01	1999	69	110

DATE	BY	REFERENCES NOTED	REFERENCES CHECKED

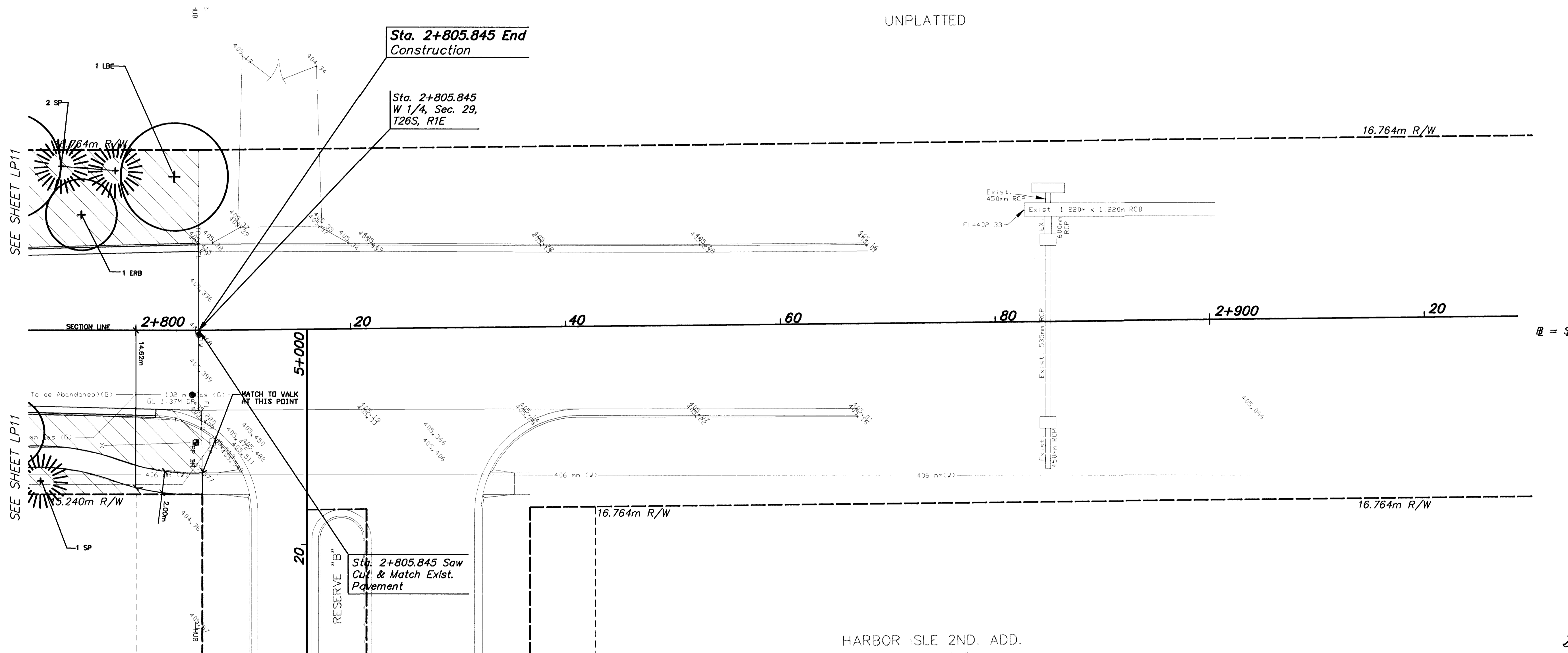

Legend
 [Hatched Box] Area designated for turf seeding



NO.	DATE	REVISIONS	BY	APP'D
2				
1				

KANSAS DEPARTMENT OF TRANSPORTATION
LANDSCAPE PLANTING PLAN
MERIDIAN AVE.
STA. 2+790 TO STA. 2+930
 PROJ. NO. 87N-0116-01 SEDGWICK COUNTY
MID-KANSAS ENGINEERING CONSULTANTS, INC.
 WICHITA, KANSAS

DESIGNED BY: SMH CHECKED BY: TDM
 DRAWN BY: SMH DATE: DEC. 1998 SHEET 69 OF 110