

DATE
BY
REFERENCES NOTED
REFERENCES CHECKED

**GENERAL NOTES**

Temporary Type I 100 mm Yellow Pavement Marking (Solid Double) to continue beyond ends of work area to channel traffic to existing lanes. (See Plan)

FHWA REG NO.	STATE	PROJECT NO.	YEAR	SHEET NO	TOTAL SHEETS
7	KANSAS	87N-0116-01	1999	77	110

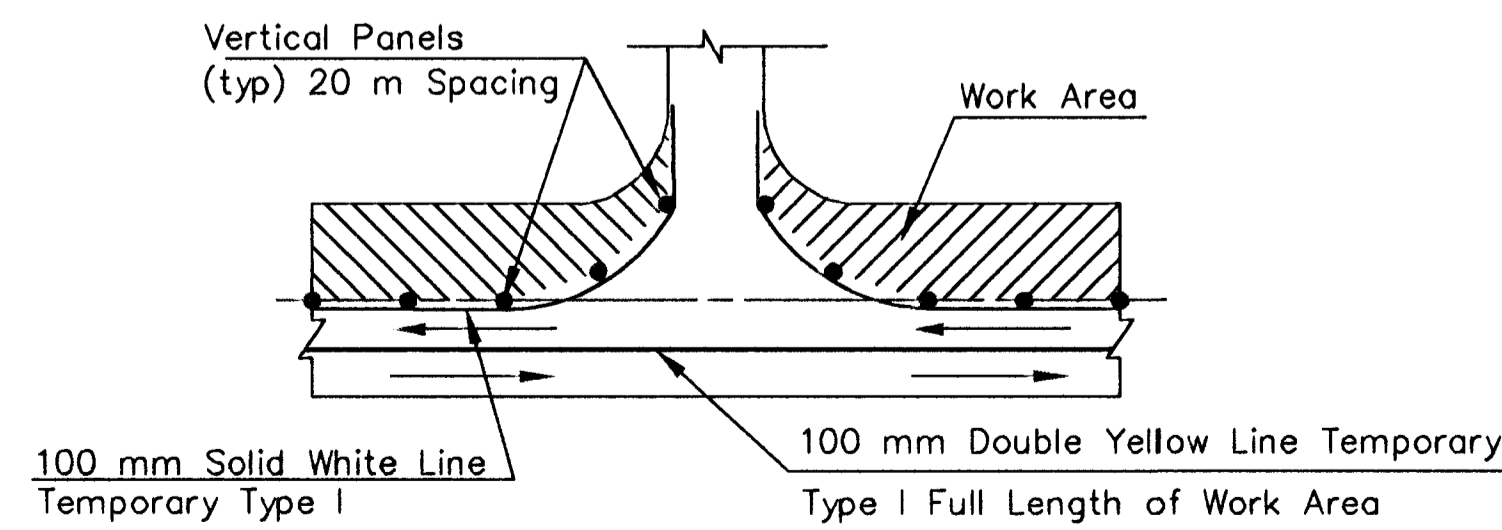
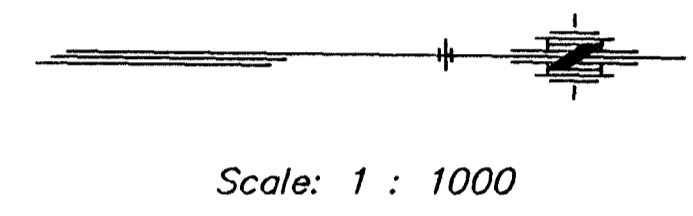
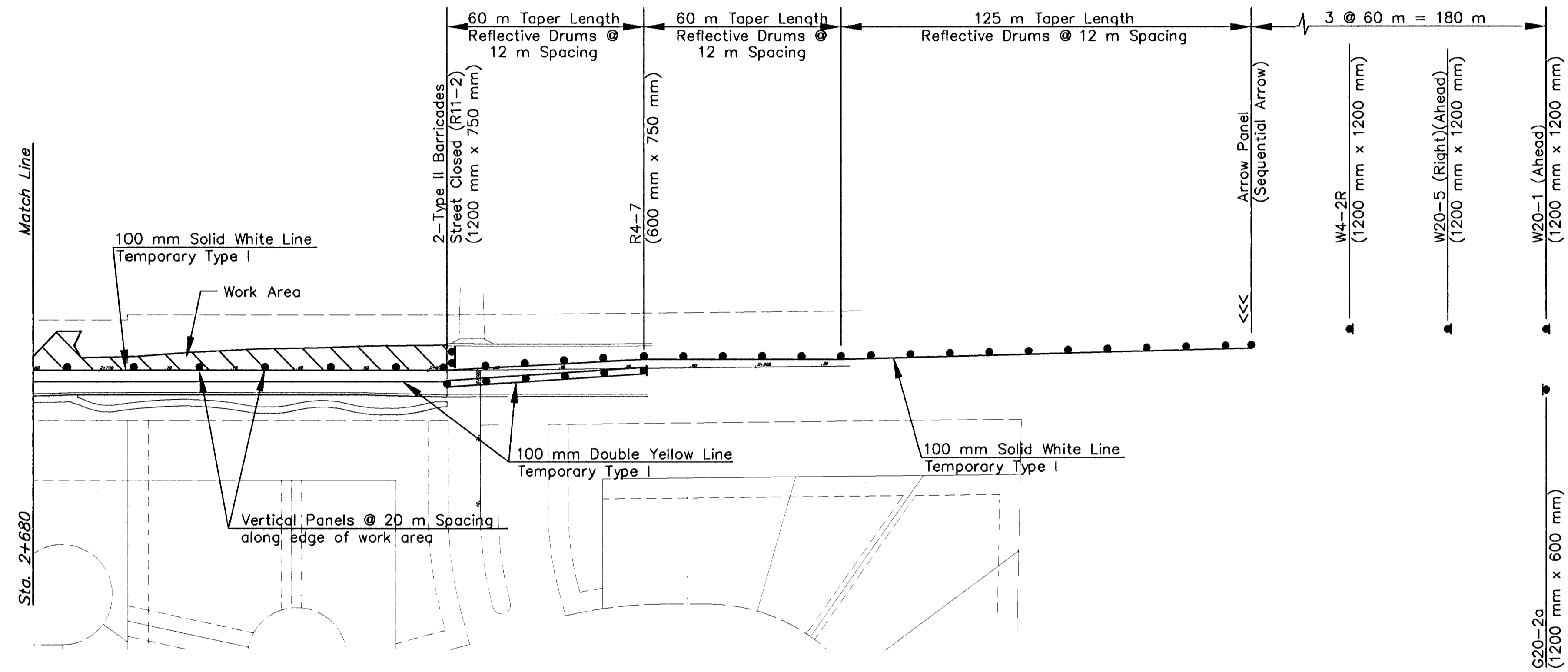

**TYPICAL ENTRANCE AND SIDE STREET**

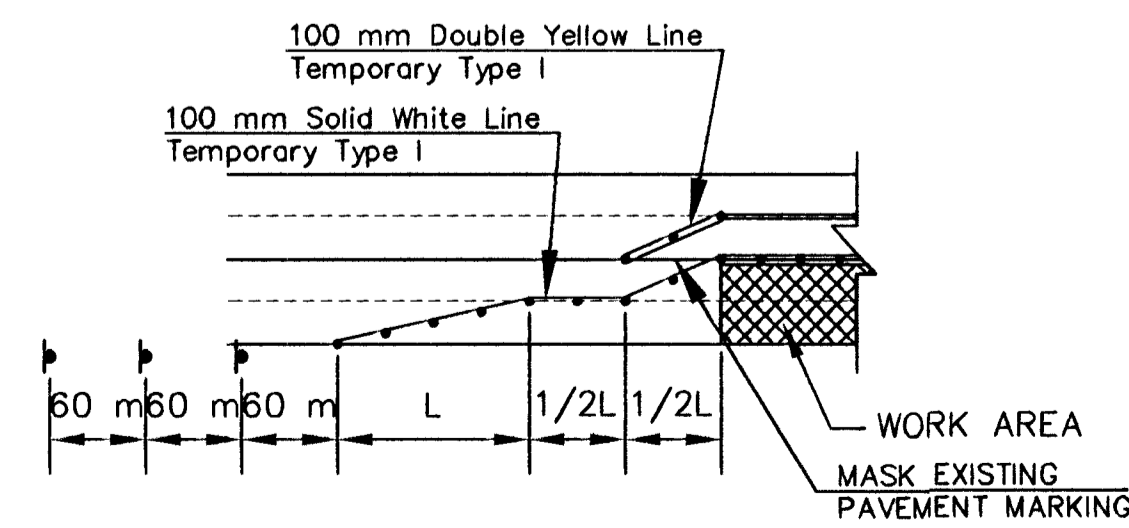

**TYPICAL TAPER PLAN**

2					
1					
NO.	DATE	REVISIONS	BY	APP'D	
KANSAS DEPARTMENT OF TRANSPORTATION <b>MERIDIAN AVE.</b> <b>TRAFFIC CONTROL</b> <b>PHASE IV</b> PROJ. NO. 87N-0116-01 SEDGWICK COUNTY					
<b>MID-KANSAS ENGINEERING CONSULTANTS, INC.</b> WICHITA, KANSAS					
DESIGNED BY:	WNJ	CHECKED BY:	DCH		
DRAWN BY:	WNJ	DATE:	DEC. 1999	SHEET	77 OF 110