

REGION NO.	STATE	PROJECT NO.	FISCAL YEAR	SHEET NO.	TOTAL SHEETS
7	KANSAS	087 N-0593-01	2015	102	153

The Striping Contractor may be required to adjust the proposed pavement markings to match the existing pavement markings in the field. The Contractor may also be required to remove and replace the existing pavement markings as necessary, including those removed for traffic control beyond the construction limits. These cost shall be *SUBSIDIARY* to the Lump Sum Bid Item "Pavement Marking".

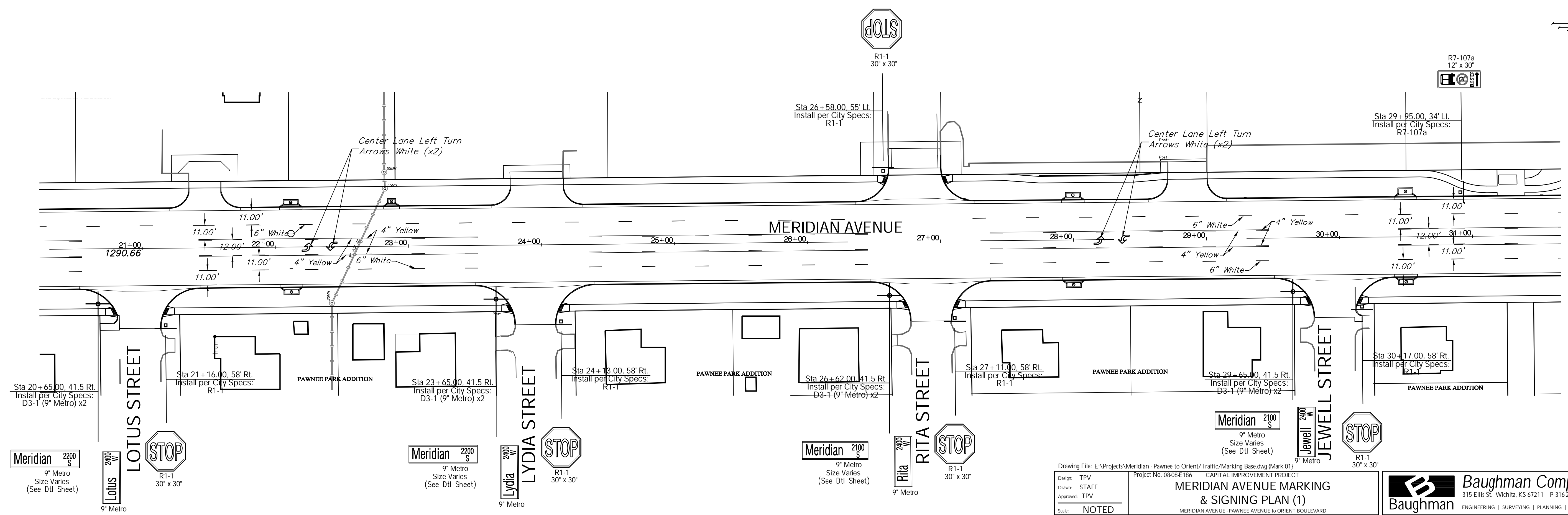
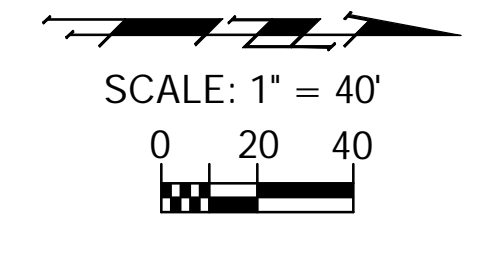
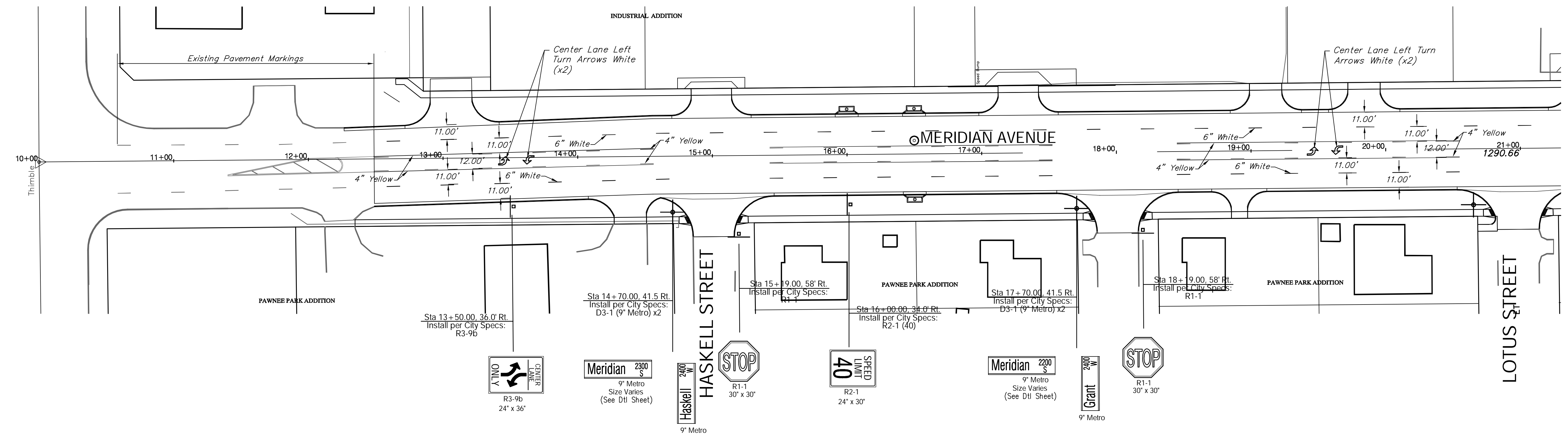
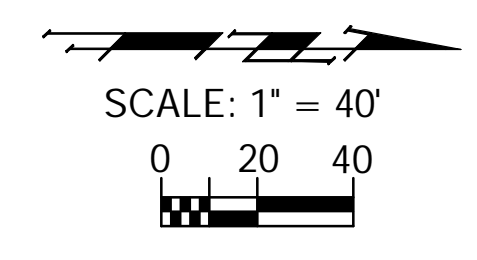

Drawing File: E:\Projects\Meridian - Pawnee to Orient/Traffic/Marking Base.dwg (Mark 01)
 Design: TPV
 Drawn: STAFF
 Approved: TPV
 Scale: NOTED

Project No. 0808E186 CAPITAL IMPROVEMENT PROJECT
MERIDIAN AVENUE MARKING & SIGNING PLAN (1)
 MERIDIAN AVENUE - PAWNEE AVENUE TO ORIENT BOULEVARD

May 2015
 SHEET 102 OF 153

Baughman Company, P.A.
 315 Ellis St. Wichita, KS 67211 P 316-262-7271 F 316-262-0149
 ENGINEERING | SURVEYING | PLANNING | LANDSCAPE ARCHITECTURE