

City of Wichita
Sedgwick County, Kansas

8" SANITARY SEWER EXTENSION
AT 1040 S VASSAR AVE,

CITY PROJECT NUMBER: 468-85022_744388

Dutton Construction & Plumbing - Contractor
J. Terhune - City of Wichita, Field Project Engineer
J. Jaso - City of Wichita, Inspector
As-built
Stub & Riser
Release Date: 7/2/2015
pdf: APRosas 11/9/2015

CITY ENGINEER:
MR. GARY JANZEN, PE

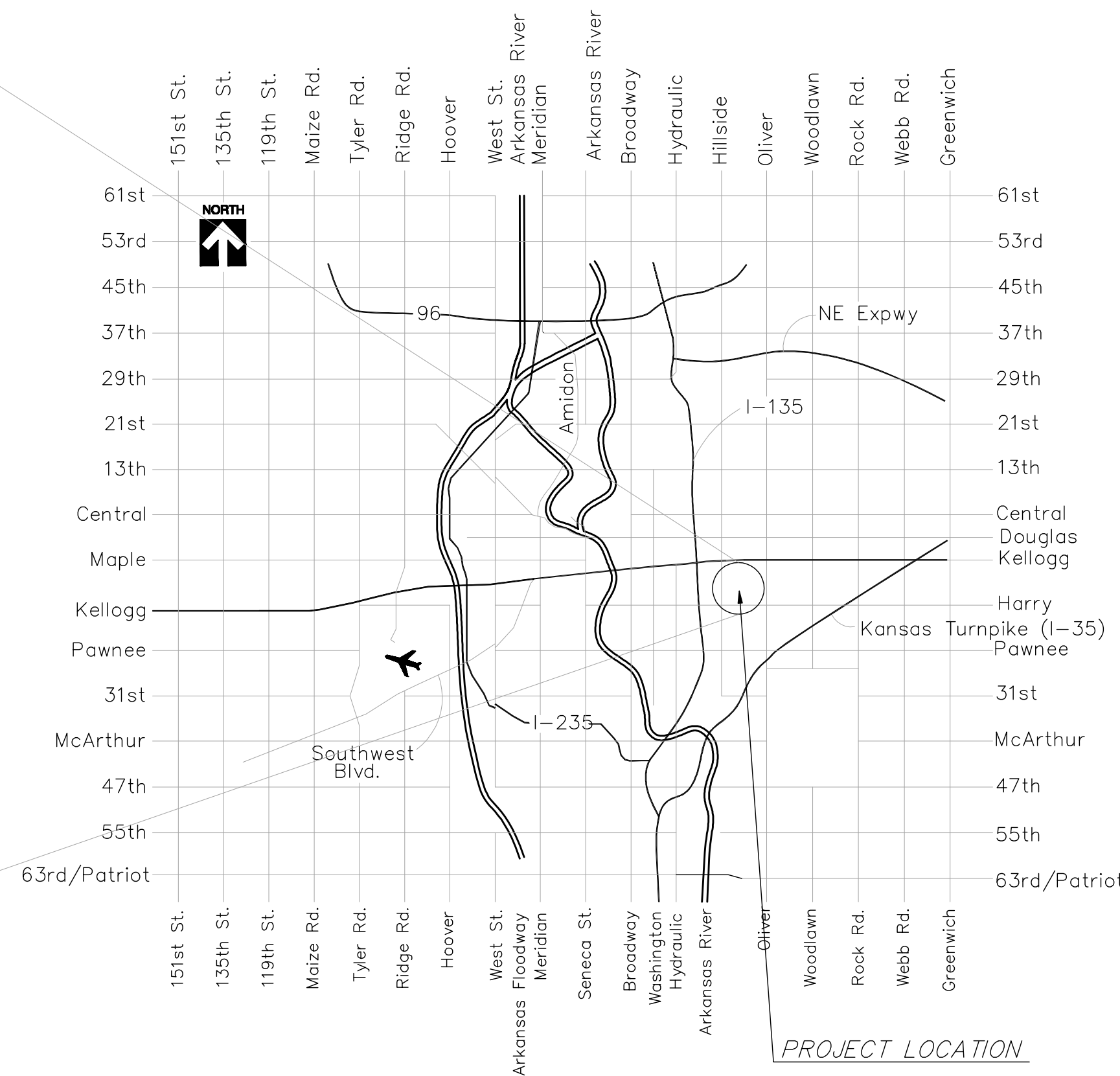
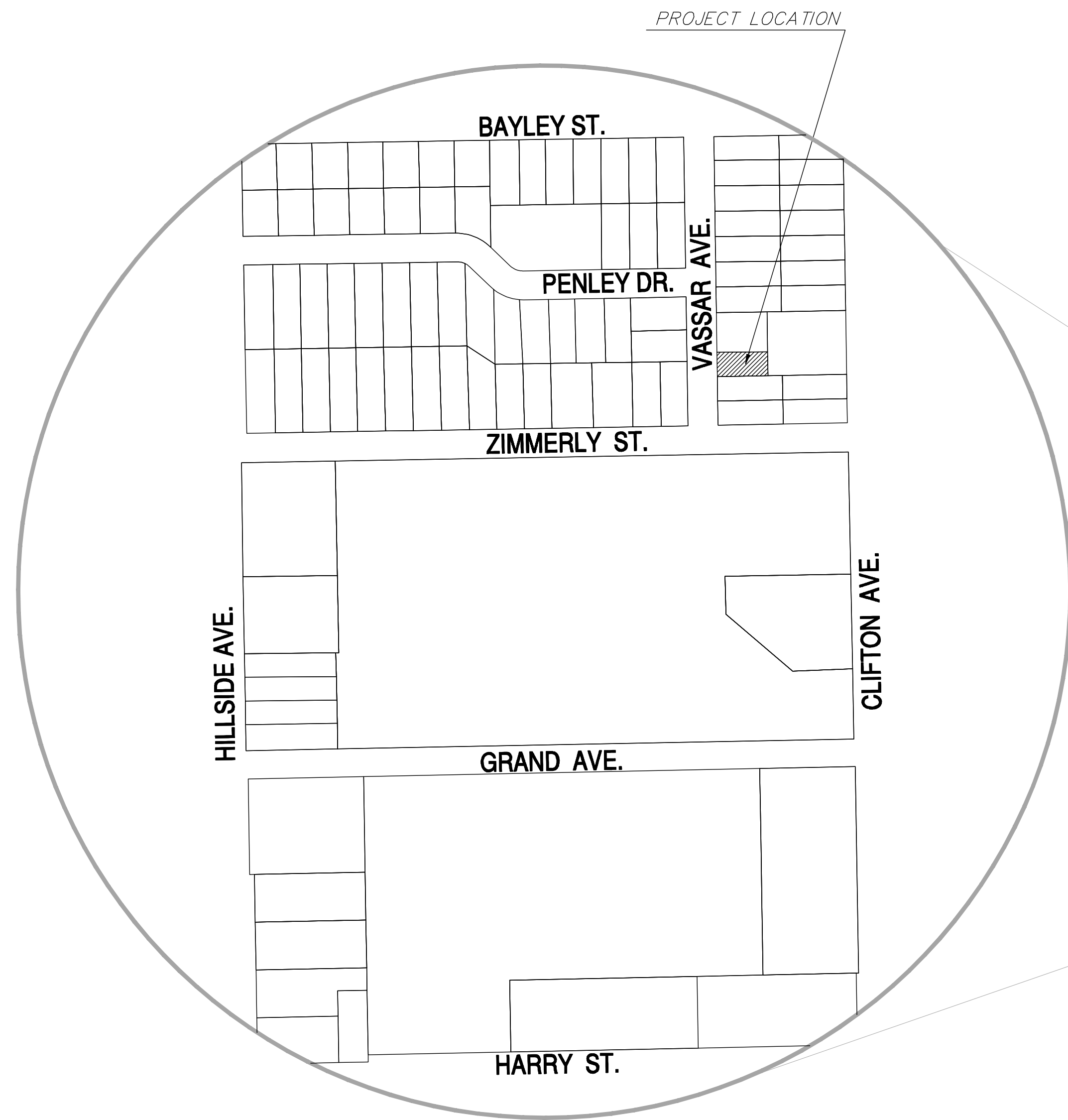

INDEX OF SHEETS:

TITLE SHEET	1
KEY MAP, GENERAL NOTES & COORDINATE CONTROL	2
8" SANITARY SEWER - PLAN & PROFILE	3
PRECAST SANITARY SEWER DETAILS	4
MANHOLE FRAME AND COVER (SANITARY SEWER) DETAILS	5
VERTICAL RISER ASSEMBLY DETAILS	6
BACK OF CURB PROTECTION, CURB INLET PROTECTION AND CONSTRUCTION ENTRANCE DETAILS	7
SILT FENCE DITCH CHECK AND BARRIER DETAILS	8
STRAW BALE DITCH CHECK AND BARRIER DETAILS	9
STREET IMPROVEMENT PROJECTS	10
SUBDIVISION DEVELOPMENT PROCESS	11

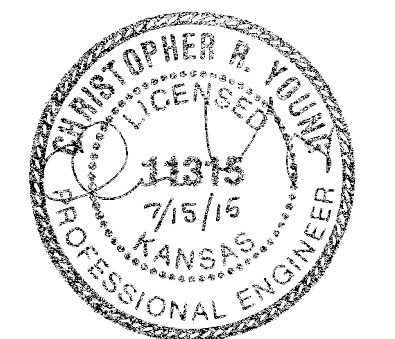

UTILITY NOTES:

VISUAL INDICATIONS OF UTILITIES ARE AS SHOWN. UNDERGROUND LOCATIONS SHOWN, AS FURNISHED BY THEIR LESSERS, ARE APPROXIMATE AND SHOULD BE VERIFIED IN THE FIELD AT THE TIME OF CONSTRUCTION. FOR ACTUAL FIELD LOCATIONS OF UNDERGROUND UTILITIES, CALL 1-800-344-7233, KANSAS OR 1-800-344-7483, MISSOURI.

JULY 2015

PLANS PREPARED BY:

YOUNG & ASSOCIATES, P.A.
Professional Civil Engineering Consultants

100 S. Georgie, Derby, KS 67037
tele: (316)788-2552 fax: (316)788-4408 email: engineering@yngpa.com

GENERAL NOTES:

- THE CONTRACTOR SHALL COMPLY WITH ALL APPLICABLE SAFETY REGULATIONS. ALL CONSTRUCTION SHALL BE COMPLETED FOLLOWING CURRENT CITY STANDARD SPECIFICATIONS AND SPECIAL PROVISIONS.
- CONTRACTOR WILL BE REQUIRED TO PROVIDE NOTICE TO UTILITY COMPANIES A MINIMUM OF SEVENTY-TWO (72) HOURS PRIOR TO ANY EXCAVATION, AS FOLLOWS:
KANSAS ONE-CALL 687-2470
THE CONTRACTOR MUST NOTIFY THE FOLLOWING IN CASE OF AN EMERGENCY:
AT&T 1-800-246-8464
BLACK HILLS ENERGY 1-800-694-8889
COX COMMUNICATIONS 1-888-249-3530
KANSAS GAS SERVICE 1-888-482-4950
WESTAR ENERGY 1-800-544-4857
CITY OF WICHITA WATER 316-268-4555
CITY OF WICHITA SEWER 316-268-4073
CITY OF WICHITA STORMWATER 316-268-4090
CITY OF WICHITA TRAFFIC 316-268-4034
- THE CONTRACTOR SHALL CONTACT THE CITY OF WICHITA AT LEAST 72 HOURS PRIOR TO BEGINNING CONSTRUCTION TO COORDINATE INSPECTION. ANY WORK COMPLETED BEFORE THE RESIDENT PROJECT INSPECTOR IS ON SITE SHALL BE UNCOVERED FOR INSPECTION AND MAY BE REJECTED AT NO COST TO THE CITY.
- THE CONTRACTOR SHALL GIVE ALL PROPERTY OWNERS AND/OR TENANTS OF DEVELOPED PROPERTY ABUTTING THE CONSTRUCTION OF THIS PROJECT A MINIMUM OF TEN (10) DAYS NOTICE PRIOR TO START OF CONSTRUCTION.
- PRIOR TO BIDDING THE WORK, THE CONTRACTOR SHALL INSPECT THE PROPOSED PROJECT SITE AND CLOSELY REVIEW THE BID DOCUMENTS TO DETERMINE IF ANY EXISTING UTILITY INFRASTRUCTURE WILL BE IN DIRECT CONFLICT WITH THE INSTALLATION OF THE PROPOSED WORK. UNLESS OTHERWISE SPECIFIED IN THE PLANS, ALL UNDERGROUND UTILITY SERVICES, UTILITY POLES AND PEDESTALS, AND OVERHEAD UTILITY LINES, AS SHOWN IN THE PLANS OR VISUALLY IDENTIFIED IN THE FIELD, SHALL BE SUPPORTED IN PLACE BY THE CONTRACTOR DURING CONSTRUCTION. ALL COST AND EXPENSES FOR PROTECTING AND MAINTAINING THESE "IDENTIFIED" UTILITY SERVICES SHALL BE INCLUDED IN THE UNIT PRICES BID FOR THE WORK.
- ANY EXCESS EXCAVATION OR RUBBLE FROM THE REMOVAL OF MISCELLANEOUS STRUCTURES INCLUDING ANY TREES REMOVED AND TREE TRIMMINGS SHALL BE DISPOSED OF ON SITES PROVIDED BY THE CONTRACTOR. THESE SITES SHALL ALSO BE APPROVED OF BY THE ENGINEER AS TO SUITABILITY, APPEARANCE, AND SITE LOCATION. LOCATIONS THAT, IN THE OPINION OF THE ENGINEER, LEAVE AN UNSIGHTLY APPEARANCE WILL NOT BE APPROVED. ALL DISPOSAL SITES MUST BE APPROVED BY THE KANSAS DEPARTMENT OF HEALTH AND ENVIRONMENT. MATERIAL EITHER STOCKPILED OR DISPOSED OF IN A FLOOD PLAIN WILL REQUIRE A KANSAS STATE BOARD OF AGRICULTURE PERMIT. ANY MATERIAL DUMPED IN WATERS OF THE UNITED STATES OR WETLANDS IS SUBJECT TO US CORPS OF ENGINEERS PERMITTING REGULATIONS. ANY MATERIAL BURIED OR STOCKPILED BEYOND APPROVED CONSTRUCTION LIMITS MAY REQUIRE ARCHAEOLOGICAL INVESTIGATIONS UNLESS BURIED IN A PREVIOUSLY APPROVED DISPOSAL LOCATION.
- TREES AND SHRUBS IN PUBLIC RIGHT-OF-WAY WHICH ARE IN DIRECT CONFLICT WITH PROPOSED NEW CONSTRUCTION SHALL BE REMOVED BY THE CONTRACTOR WITH ENGINEER'S APPROVAL. TREES AND SHRUBS WHICH ARE NOT IN DIRECT CONFLICT WITH PROPOSED NEW CONSTRUCTION SHALL BE SAVED AND PROTECTED FROM DAMAGE.
- THE CONTRACTOR SHALL BE RESPONSIBLE FOR PRESERVING PROPERTY IRONS. THE CONTRACTOR WILL BE REQUIRED TO REESTABLISH ANY PROPERTY IRONS WHICH ARE DAMAGED OR DESTROYED BY HIS CONSTRUCTION OPERATIONS. SAID IRONS SHALL BE REESTABLISHED BY A LICENSED LAND SURVEYOR IN ACCORDANCE WITH STATE LAWS.
- IF TRAFFIC WILL BE IMPACTED BY CONSTRUCTION, A TRAFFIC CONTROL PLAN MUST BE SUBMITTED AND APPROVED BY THE CITY TRAFFIC ENGINEER, BRIAN COON AT TRAFFIC@WICHITA.GOV BEFORE CONSTRUCTION CAN BEGIN. THE CONTRACTOR SHALL BE RESPONSIBLE FOR ALL TRAFFIC CONTROL MEASURES TO FACILITATE CONSTRUCTION. ALL CONSTRUCTION ZONE MARKINGS AND SIGNAGE SHALL CONFORM TO THE LATEST VERSION OF THE MANUAL ON UNIFORM TRAFFIC CONTROL DEVICES (MUTCD) AS PUBLISHED BY THE U.S. DEPT. OF TRANSPORTATION, FEDERAL HIGHWAY ADMINISTRATION. ALL COSTS ASSOCIATED WITH CONSTRUCTION MARKING AND SIGNAGE SHALL BE THE CONTRACTORS RESPONSIBILITY.
- INTERURBAN TRAFFIC GENERATED OUTSIDE THE PROJECT AREA AND LOCAL BUSINESS OR RESIDENTIAL TRAFFIC GENERATED WITHIN THE PROJECT AREA ARE TO BE CARRIED THROUGH CONSTRUCTION AS FURTHER PROMULGATED BY THE PROJECT SPECIAL PROVISIONS. THE CONTRACTOR SHALL UTILIZE BARRICADES, SIGNS, GUARDS, AND FLAGMEN IN FLAGMEN IN ACCORDANCE WITH THE MANUAL ON UNIFORM TRAFFIC CONTROL DEVICES.
- ALL ELEVATION SHOWN ARE NAVD 88.
- ALL AREAS DISTURBED DURING CONSTRUCTION THAT WILL NOT BE UNDER PROPOSED PAVEMENT SHALL BE RESTORED TO MATCH EXISTING CONDITIONS.
- ALL STUBS AND PLUGGED PIPES SHALL BE LOCATED WITH GREEN PLASTIC TAPE IN THE SAME MANNER AS RISERS.
- CONNECTING TO EXISTING MANHOLES: PRIOR TO LAYING SEWER LINES USING EXISTING STUBS IN EXISTING MANHOLES, THE CONTRACTOR SHALL EXPOSE AND VERIFY THE ELEVATION, GRADE AND ALIGNMENT OF EXISTING STUBS AND NOTIFY THE ENGINEER OF ANY DEVIATION FROM THE PLANS. WHERE CONNECTION TO AN EXISTING MANHOLE THAT DOES NOT HAVE AN EXISTING STUB IS UNUSABLE DUE TO ELEVATION GRADE OR ALIGNMENT, THE CONTRACTOR SHALL CORE CUT INTO EXISTING MANHOLE WALL TO MAKE CONNECTION USING APPROVED WATER STOP GASKET, AND RESHAPE THE EXISTING MANHOLE INVERT TO PROVIDE SMOOTH FLOW. THE COST TO CONNECTING TO EXISTING MANHOLES IS INCIDENTAL TO THE PROJECT.
- CONTRACTOR SHALL LIMIT THE EXTENT OF TRENCH OPEN OVERNIGHT AND WEEKENDS TO LESS THAN 50 FEET.
- CONTRACTOR SHALL PROVIDE POSITIVE DRAINAGE AWAY FROM ALL MANHOLE COVERS.
- THE CONTRACTOR SHALL PREVENT ANY CONSTRUCTION DEBRIS FROM ENTERING THE EXISTING SANITARY SEWER DURING CONSTRUCTION.
- THE CONTRACTOR SHALL BE RESPONSIBLE FOR MAINTAINING CONTINUOUS FLOW OF SEWAGE THROUGH CONSTRUCTION. CONTRACTORS PROPOSED METHOD FOR MAINTAINING SEWAGE FLOW SHALL BE SUBMITTED AND APPROVED BY THE SEWER MAINTENANCE DIVISION (316-268-4073) PRIOR TO STARTING AND BY-PASSING OF SEWAGE FLOWS.
- ANY OVER EXCAVATION FROM MANHOLE AND PIPE REMOVAL SHALL BE BACKFILLED WITH AB-3 COMPACTED TO 90-95% ASTM D698.
- CITY MAINTENANCE OF SANITARY SEWER MAINS ENDS AT LAST STRUCTURE WITHIN THE EASEMENT OR RIGHT-OF-WAY OR LINE.
- ANY SIDEWALK, DRIVE APPROACH, CURB, OR STREET PAVEMENT REMOVED TO CONSTRUCT PROJECT MUST HAVE A PAVEMENT CUT PERMIT AND BE REPLACED BY THE CITY CONTRACTOR. PERMITS CAN BE OBTAINED BY CALLING 316-268-4501 OR 316-268-4480.
- WHERE EXISTING ENTRANCE PIPES, DRAINAGE PIPES, SIGNS, FENCES, ETC. CONFLICT WITH THE PROPOSED WORK HEREIN, THEY SHALL BE REMOVED, AND REPLACED OR RESET IF NECESSARY. THE REPLACEMENT OF ALL THE AFOREMENTIONED ITEMS SHALL BE CONSIDERED SUBSIDIARY TO "SITE CLEARING" AND "SITE RESTORATION".
- POSITIVE DRAINAGE SHALL BE PROVIDED FOR ALL AREAS ON OR NEAR SPOT AREAS. NATURAL DRAINAGE WAYS SHALL BE MAINTAINED.
- EXISTING UTILITIES AND THEIR LOCATION, AS SHOWN ON THE PLANS, REPRESENT THE RECORD INFORMATION PROVIDED TO THE ENGINEER FROM THE UTILITY OWNER, OR AS FIELD LOCATED BY DESIGN SURVEY(S) DURING THE PREPARATION OF THESE PLANS. THE CONTRACTOR SHALL BE ADVISED THAT OTHER BURIED UTILITY LINES, CABLES, AND BURIED INFRASTRUCTURE MAY EXIST WHICH ARE NOT SHOWN IN THE PLANS OR FLAGGED IN THE FIELD. THE CONTRACTOR SHALL THEREFORE EXERCISE EXTREME CAUTION DURING TRENCHING AND EXCAVATING OPERATIONS TO AVOID DAMAGING THESE LINES AND CABLES. ANY UTILITIES DAMAGED SHALL BE REPLACED OR REPAIRED IMMEDIATELY AS DIRECTED BY THE ENGINEER AT THE CONTRACTOR'S EXPENSE. THE CONTRACTOR SHALL PROTECT FROM DAMAGE AND SUPPORT EXISTING UTILITIES THROUGH CONSTRUCTION AS APPROVED BY THE UTILITY OWNER AND THE ENGINEER AT THE CONTRACTOR'S EXPENSE.
- EASEMENTS AND RIGHT-OF-WAY PROVIDED BY THE OWNER FOR THE PROJECT ARE SHOWN IN THE PLANS. THE CONTRACTOR SHALL BE RESPONSIBLE FOR THE ACQUISITION OF ANY ADDITIONAL TEMPORARY CONSTRUCTION EASEMENTS OR RIGHT-OF-WAY THAT HE DESIRES TO USE IN COMPLETING THE WORK.
- ANY STREET CURBS OR OTHER EXISTING PAVING IMPROVEMENTS, DAMAGED BY THE CONTRACTOR SHALL BE REPLACED IN KIND TO THE NEAREST EXISTING CONSTRUCTION JOINT OR TO LIMITS APPROVED BY THE CITY ENGINEER AT NO ADDITIONAL COST TO THE PROJECT.
- THE CONTRACTOR SHALL INSTALL TEMPORARY EROSION CONTROL STRUCTURES AT ALL AREAS DISTURBED BY CONSTRUCTION IN ACCORDANCE WITH FEDERAL, STATE, AND LOCAL REGULATIONS. HAY BALES OR SILT FENCES SECURELY ANCHORED INTO THE GROUND MAY BE USED. MAXIMUM STRUCTURE INTERVAL SHALL BE 200-FEET PARALLEL TO THE FLOW OF WATER.
- ALL COSTS ASSOCIATED WITH SEEDING, MULCHING, AND FERTILIZING SHALL BE INCLUDED IN THE BID ITEM "SEEDING". ALL SEEDING OPERATIONS SHALL CONFORM TO CITY OF WICHITA STANDARD SPECIFICATIONS.
- PROJECT SITE SHALL BE RESTORED TO AS GOOD OR BETTER CONDITIONS THAN EXISTED PRIOR TO CONSTRUCTION. CONTRACTOR SHALL PHOTOGRAPHICALLY DOCUMENT THE EXISTING CONDITIONS PRIOR TO BEGINNING CONSTRUCTION. ALL COST FOR RESTORATION TO BE INCLUDED IN "SITE RESTORATION".
- THE CONTRACTOR SHALL NOT START WORK ON THE PROJECT UNTIL THE PROJECT INSPECTOR IS ASSIGNED TO THE PROJECT AND IS PRESENT ON THE SITE. ANY WORK PERFORMED WITHOUT INSPECTION IS SUBJECT TO BE UNCOVERED FOR INSPECTION.
- THE CONTRACTOR SHALL RESTORE ALL DITCHES, SWALES, ROAD SHOULDERS, ENTRANCES, AND BANK LINES TO THEIR ORIGINAL SLOPES AND GRADES UNLESS SHOWN OTHERWISE IN THE PLANS.
- ALL LAWN AREAS DISTURBED BY CONSTRUCTION OF THE PROPOSED IMPROVEMENTS SHALL BE RESTORED WITH THE SAME GRASS AS EXISTING. RESTORATION OF DISTURBED AREAS SHALL INCLUDE, BUT NOT LIMITED TO, TOP SOIL PREPARATION, SEEDING, MULCH AND/OR RESEEDING. ALL SEEDING WORK SHALL BE IN ACCORDANCE WITH THE SPECIFICATIONS AND THE CITY OF WICHITA ADMINISTRATIVE REGULATION NO. AR 6.5 WHICH CITY OF WICHITA STANDARD GOVERNS CLEANUP AND RESTORATION OF REPLACEMENT FOLLOWING CONSTRUCTION. ALL COSTS FOR THIS WORK SHALL BE SUBSIDIARY TO THE LUMP SUM PRICE BID FOR "SEEDING".
- THE CONTRACTOR SHALL SEED ALL AREAS DISTURBED BY CONSTRUCTION ACTIVITIES WITH TEMPORARY RYE GRASS. RYE GRASS SHALL BE PLANTED AT A MINIMUM RATE OF SIX (6) POUNDS PER ONE THOUSAND (1000) SQUARE FEET. THIS TEMPORARY SEEDING MAY BE OMITTED ONLY IF OTHER SEEDING IS REQUIRED IN ACCORDANCE WITH GENERAL NOTE NO. 13 ABOVE. TEMPORARY SEEDING OR PERMANENT SEEDING SHALL BE APPLIED WITHIN 14 DAYS AFTER THE AREA HAS BEEN DISTURBED.
- PROPERTIES WITHIN THE PROJECT LIMITS MAY HAVE UNDERGROUND SPRINKLER SYSTEMS IN PUBLIC RIGHT-OF-WAY WHICH CONFLICT WITH NEW CONSTRUCTION. CONTRACTOR WILL BE REQUIRED TO REMOVE SUCH IMPROVEMENT SHOULD THEY NOT BE REMOVED BY THEIR OWNER AT THE TIME OF CONSTRUCTION OF THE PROJECT. THE CONTRACTOR WILL BE REQUIRED TO SALVAGE ALL SPRINKLER HEADS AND/OR VALVES AND ONE SUCH MATERIAL TO THEIR OWNER. PORTIONS OF THE UNDERGROUND SPRINKLER SYSTEM NOT IN CONFLICT WITH NEW CONSTRUCTION SHALL BE PROTECTED FROM DAMAGE AND SHALL REMAIN IN PLACE. ALL WORK IN CONNECTION WITH UNDERGROUND SPRINKLER SYSTEMS SHALL BE CONSIDERED AS SUBSIDIARY TO THE CONTRACT PAY ITEMS OF WORK.
- ALL IRRIGATION, LANDSCAPING, AND FENCING DISTURBED DURING CONSTRUCTION SHALL BE REMOVED AND RESET IN KIND, BY THE CONTRACTOR. THE CONTRACTOR SHALL PROVIDE A MINIMUM ADVANCE NOTICE OF FORTY-EIGHT HOURS TO THE AFFECTED PROPERTY OWNERS PRIOR TO BEGINNING CONSTRUCTION. THIS WORK SHALL BE CONSIDERED SUBSIDIARY TO "SITE RESTORATION".
- ANY EXISTING METER BOXES, RINGS, AND LIDS REMOVED DURING THE PROJECT SHALL BE TRANSPORTED AND PROVIDED TO THE CITY AT THE CENTRAL MAINTENANCE FACILITY (CMF) AT 1801 S. McLEAN BLVD.
- THE CONTRACTOR SHALL USE BEST MANAGEMENT PRACTICES (BMP'S) TO PREVENT ERODED SOIL FROM ENTERING DITCHES, STORM SEWERS, OR ANY OTHER DRAINAGE FEATURE. THE CITY OF WICHITA STANDARD DETAILS FOR SOIL EROSION BMP'S ARE A PART OF THIS SET OF PLANS AND ARE INTENDED TO PROVIDE GUIDELINES AS TO WHAT TYPE OF SOIL EROSION PROTECTION WILL BE INSTALLED DURING THE CONSTRUCTION PROCESS. THE CONTRACTOR SHALL BID THE PROJECT ACCORDINGLY. BMP'S SHALL BE MAINTAINED DURING THE CONSTRUCTION PROCESS BY THE CONTRACTOR. THE CONTRACTOR SHALL IMMEDIATELY REPAIR OR REPLACE ANY SOIL EROSION BMP'S DAMAGED OR DESTROYED DURING THE CONSTRUCTION PROCESS.
- PAVEMENT REMOVAL AND/OR REPLACEMENT WILL BE MEASURED AND PAID FOR ON THE LINEAL FOOT BASIS AS MEASURED ALONG THE CENTERLINE OF THE SANITARY SEWER LINE REGARDLESS OF WIDTH, PAVEMENT TYPE, AND OR PAVEMENT THICKNESS. MINIMUM LIMITS OF SUCH PAVEMENT REMOVAL AND REPLACEMENT SHALL BE 1.0 FOOT BEYOND THE LIMITS OF THE EXCAVATION MADE FOR THE SANITARY SEWER LINE OR THE STRUCTURE, EXCEPT WHEN SUCH SAW CUTS ARE WITHIN 3.0 FEET OF AN EXISTING JOINT THE LIMITS OF REMOVAL SHALL BE EXTENDED TO THE EXISTING JOINT. REMOVAL AND REPLACEMENT OF EXISTING PAVEMENT SHALL CONFORM TO THE APPLICABLE SECTIONS OF THE CITY OF WICHITA STANDARD SPECIFICATION. PAVEMENT REMOVAL AND REPLACEMENT FOR THE SANITARY SEWER LINE CONSTRUCTION SHALL BE INDEPENDENT OF THE STREET CONSTRUCTION.
- A SAW CUT OF AT LEAST ONE-HALF THE DEPTH OF EXISTING SURFACE COURSES OR ONE FOURTH THE DEPTH OF THE EXISTING TOTAL PAVEMENT THICKNESS SHALL BE PROVIDED AT LOCATIONS WHERE PROPOSED CONSTRUCTION ABUTS AN EXISTING SURFACE COURSE OR PAVEMENT FOR WHICH PARTIAL REMOVAL OF THAT SURFACE OR PAVEMENT IS REQUIRED. WHEN SUCH SAW CUTS ARE WITHIN 3.0 FEET OF AN EXISTING JOINT THE LIMITS OF REMOVAL SHALL BE EXTENDED TO THE EXISTING JOINT. SUCH SAW CUTS WILL NOT BE PAID FOR DIRECTLY AND THIS COST SHALL BE CONSIDERED AS SUBSIDIARY TO THE REMOVAL OF THE SURFACE OR PAVEMENT.
- THE CONTRACTOR SHALL MAINTAIN ACCESS TO THE PROPERTIES IN THE PROJECT AREA DURING CONSTRUCTION OF THE SANITARY SEWER MAIN. THE TEMPORARY CLOSINGS OF ANY STREETS OR ACCESS DRIVES SHALL BE KEPT TO A MINIMUM AND APPROVED BY THE ENGINEER. CONSTRUCTION AFFECTING ACCESS TO PROPERTIES MAY BE REQUIRED TO BE PERFORMED DURING NON-PEAK HOURS. REMOVAL OF DRIVEWAYS SHALL BE APPROVED BY THE ENGINEER.
- TREE TRIMMING SHALL BE TO CITY STANDARDS AND NOT PERFORMED WITH A BACKHOE.
- REMOVE TRUMPS & BALLS, OR GRIND DOWN TO A MINIMUM OF 6" BELOW GRADE.
- POWER POLES MAY REQUIRE BRACING, CONTACT WESTAR AT 261-6828.
- UTILITY SERVICE LINES, POLES, VALVE BOXES, METERS, ETC., ARE TO BE ADJUSTED AS NECESSARY BY OTHERS PRIOR TO CONSTRUCTION UNLESS THE PLANS SPECIFICALLY CALL FOR THEIR ADJUSTMENT BY THE CONTRACTOR OR UNLESS THE PLANS SPECIFICALLY IDENTIFY A UTILITY TO BE ADJUSTED BY ITS OWNER DURING CONSTRUCTION. EXISTING UTILITIES AND THEIR LOCATION, AS SHOWN ON THE PLANS, REPRESENT THE BEST INFORMATION OBTAINABLE FOR DESIGN. THE CONTRACTOR WILL BE REQUIRED TO WORK AROUND EXISTING UTILITIES WITHIN THE RIGHT-OF-WAY WHICH DO NOT CONFLICT WITH PROPOSED CONSTRUCTION.

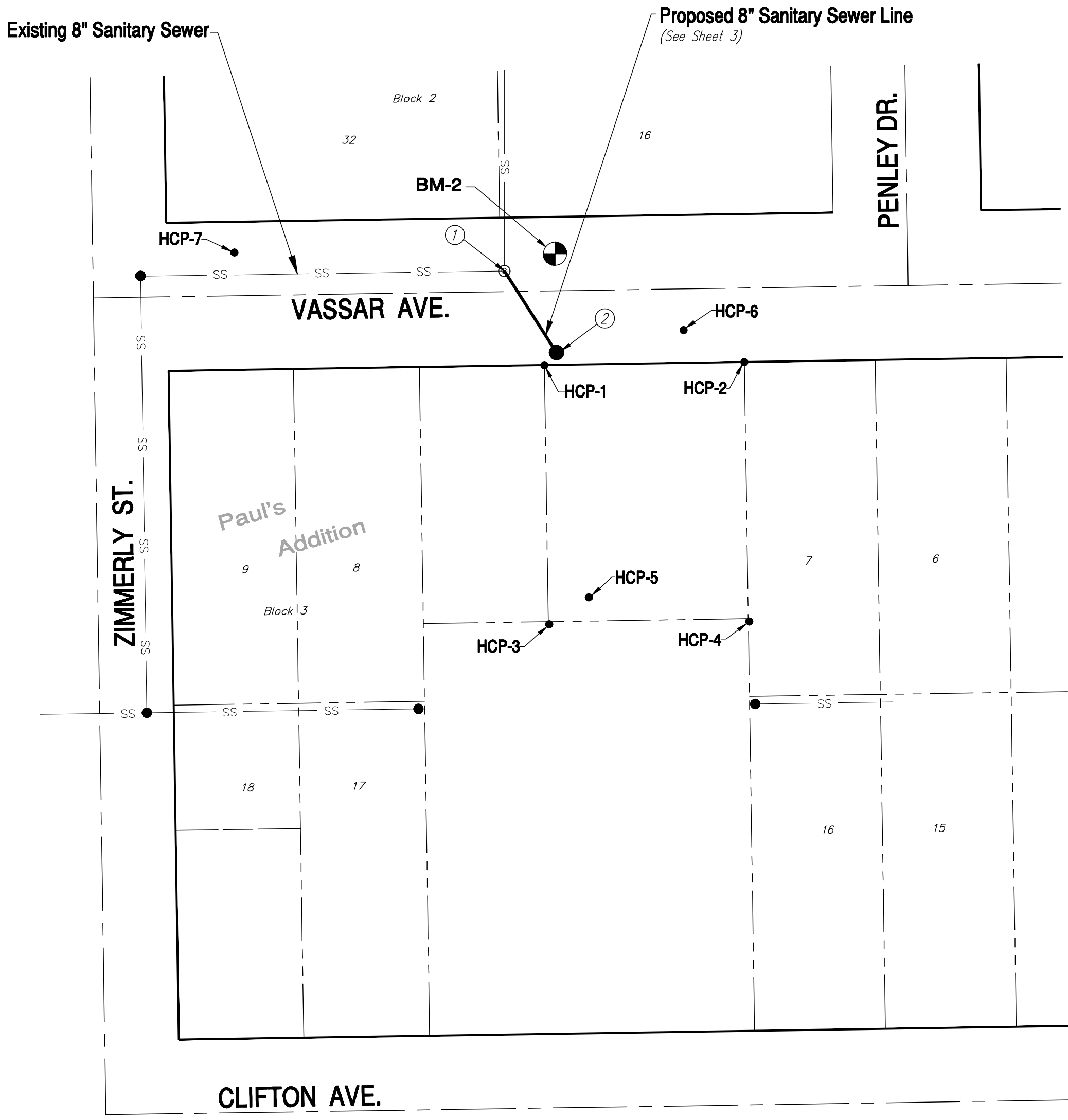
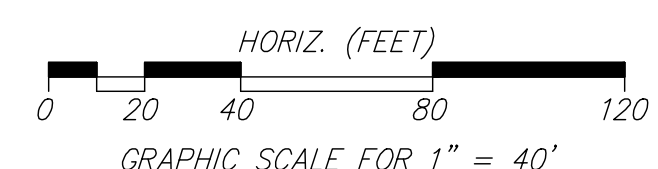

COORDINATE CONTROL TABLE:

HC #	WL CL STATION	GENERAL DESCRIPTION	NORTHING	EASTING
1	1+00.00	Connect to Exist. Manhole	1679440.252	1660975.579
2	1+48.80	Install 4" Dia. Manhole	1679461.363	1661028.637

HORIZONTAL COORDINATE CONTROL:

- HCP 1. - 1/2" Rebar w/Plastic Cap, stamped "Armstrong LS 780", located at the Southwest corner of 1040 S. Vassar Ave.
N= 1679456.440
E= 1661013.712
- HCP 2. - 1/2" Rebar w/Plastic Cap, stamped "Armstrong LS 780", located at the Northwest corner of 1040 S. Vassar Ave.
N= 1679537.523
E= 1661012.473
- HCP 3. - 1/2" Rebar w/Plastic Cap, stamped "Armstrong LS 780", located at the Southeast corner of 1040 S. Vassar Ave.
N= 1679458.430
E= 1661118.747
- HCP 4. - 1/2" Rebar w/Plastic Cap, stamped "Armstrong LS 780", located at the Northeast corner of 1040 S. Vassar Ave.
N= 1679539.491
E= 1661117.583
- HCP 5. - Hub & Tack (set) in grass, approx. 16' North and 10' West of the Southeast corner of 1040 S. Vassar Ave.
N= 1679474.433
E= 1661107.857
- HCP 6. - Hub & Tack (set) in grass, approx. 91' South and 16' East of the intersection of Penley Drive and Vassar Avenue.
N= 1679512.841
E= 1660999.519
- HCP 7. - Hub & Tack (set) in grass, approx. 57' North and 18' East of the intersection of Zimmerly Avenue and Vassar Avenue.
N= 1679330.978
E= 1660968.125

BENCHMARK:

- BM 1 - City of Wichita Bench Mark located Southwest corner of intersection of Hillside Avenue and Harry Street on the southeast corner of the traffic signal light concrete base. (Not shown on map)
Elev = 1315.07 (NAVD 88)
- BM 2 - Square Cut (set) on West Top of Curb, approx. 143' South and 13' West of the intersection of Penley Drive and Vassar Avenue.
Elev = 1327.04 (NAVD 88)

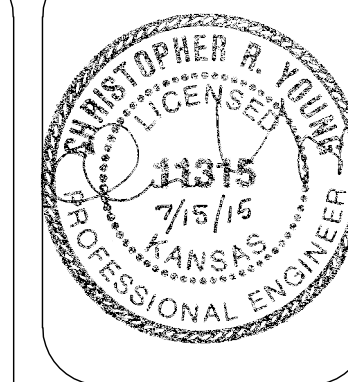

YOUNG & ASSOCIATES, P.A.
Professional Civil Engineering Consultants
100 S. Geologie, Derby, KS 67037
Tel: (316)788-2552 fax: (316)788-4408 email: engineering@ynaps.com
Copyright 2010 by Young & Associates, P.A. All rights reserved. Prepared in the State of Kansas. This plan and design are the exclusive property of Young & Associates, P.A. The delivery of this original or digital master does not constitute professional release.

KEY MAP, GENERAL NOTES & COORDINATE CONTROL
8" Sanitary Sewer Extension at 1040 S. Vassar Ave.
City of Wichita
Sedgewick County, Kansas

scale: as noted

Design By: TWE

Drawn By: DSB

Checked By: CRY

P/N: 15-374

Prints Issued:

Office Check, 6-12-15

Final Plans, 7-15-15

Revisions:

△	
△	
△	
△	

N.1679440.252, E.1660975.579
 SS Line Sta. 1+00
 Connect to Existing Brick MH
 Top of Rim = 1326.64
 Exist. FL 8" (Out, W)=1315.49
 Exist. FL 8" (In, S)=1315.51
 *Exist. FL 4" Service (In, E)=1315.83
 *Exist. FL 4" Service (Clogged/Collapsed, In, NE)=1315.94
 Prop. 8" FL (In, NE)=1317.40
 (* See Special Note #5)

N.1679461.363, E.1661008.637
 SS Line Sta. 1+39.22
 Construct Std. 4' Dia. MH, see details sheets 4 & 5.
 Top of Rim = 1328.51
 FL 8" (Out, SW) = 1318.57
 Install 4" Stub and Vertical Riser Assembly, NE, see details sheet 6.
 FL 4" Stub (In, NE) = 1320.47

SS Line Sta. 1+00 to 1+39.22
 Install 39.22 LF 8" San. Sewer Pipe

Install Approx. 17 LF Silt Fence Barrier, see details Sht. 8

Sawcut, remove and replace approx. 32 LF Concrete Pavement, in kind

SS Line Sta. 1+02.50 to 1+30.96
 Install 28.46 LF Flowable Fill

Sawcut, remove and replace approx. 12 LF Monolithic Concrete curb & gutter

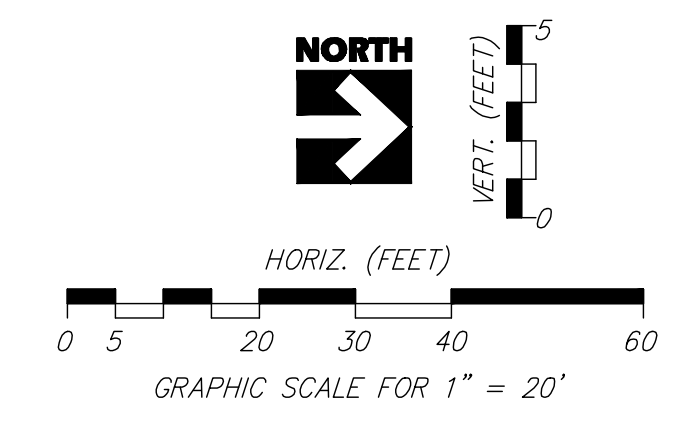

- LEGEND**
- TC = Top of curb elev.
 - FL = Flow-line elev.
 - = Existing Contours, 1-ft. intervals
 - G- = Existing Buried Gas Line
 - DHE- = Existing Overhead Electric Line
 - W- = Existing Water Line
 - SS- = Existing Sanitary Sewer Line
 - = Proposed Sanitary Sewer

SPECIAL NOTES:

1. THE CONTRACTOR SHALL USE BEST MANAGEMENT PRACTICES TO CONTROL EROSION AND SEDIMENT DISCHARGE IN ALL DISTURBED AREAS OF CONSTRUCTION. THE CONTRACTOR SHALL PROVIDED ALL NECESSARY MATERIALS, AND EQUIPMENT, AND LABOR TO CONSTRUCT, OPERATE AND MAINTAIN TEMPORARY EROSION AND SEDIMENT CONTROLS DURING CONSTRUCTION.
2. UNLESS OTHERWISE NOTED ALL DIMENSIONS ARE CENTER OF STRUCTURE TO CENTER OF STRUCTURE.
3. THE CONTRACTOR SHALL FIELD VERIFY HORIZONTAL AND VERTICAL LOCATIONS OF ALL EXISTING BURIED UTILITY LINES PRIOR TO CONSTRUCTION. REPORT ANY DISCREPANCIES TO THE ENGINEER.
4. DRILL & DOWEL #4X24" BARS @ 30" O.C., IN ALL AREAS WHERE NEW CONCRETE IS INSTALLED ADJACENT TO EXISTING CONCRETE.
5. THE CONTRACTOR SHALL DETERMINE IF THE EXISTING 4" SERVICE LINE IS IN USE. IF THIS LINE IS NOT IN USE THEN THE CONTRACTOR SHALL PLUG AND SECURE THIS PIPE AT THE MANHOLE.

Refer to next sheet

ZIMMERLY ST.

PENLEY DR.

VASSAR AVE.

Paul's Addition

Block 13

SANITARY SEWER PROFILE

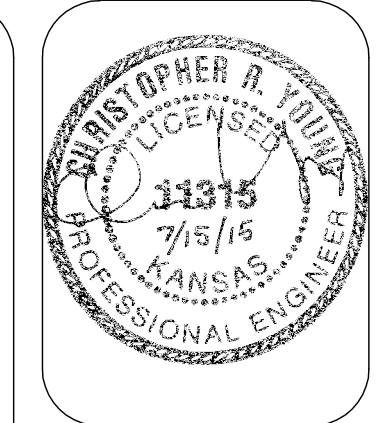
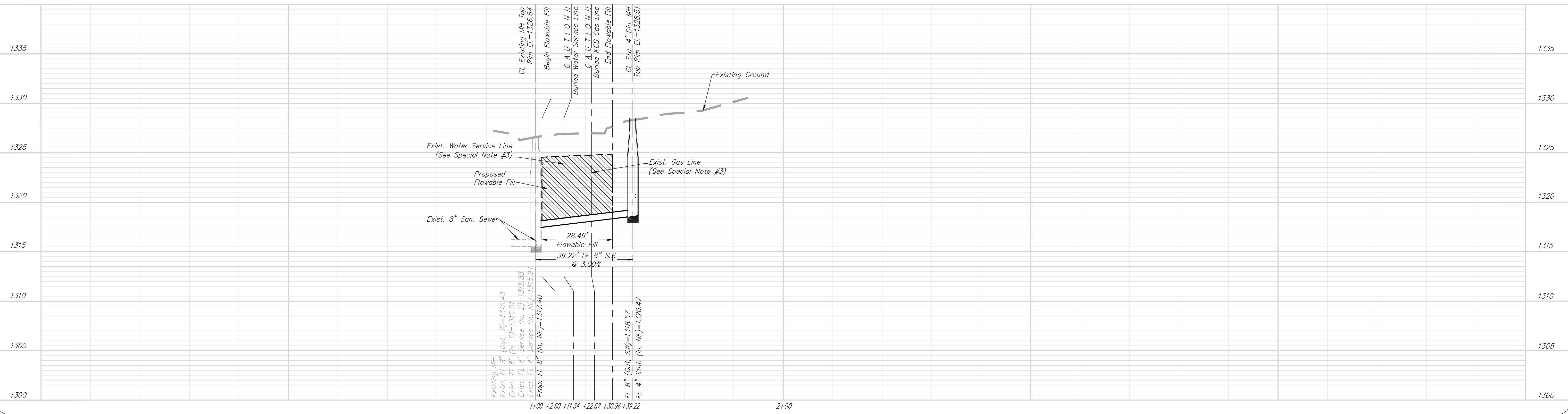

YOUNG & ASSOCIATES, P.A.
 Professional Civil Engineering Consultants
 100 S. Geary, Derby, KS 67037
 tele: (316)788-2552 fax: (316)788-4408 email: engineering@ynpc.com

Copyright, by Young & Associates, P.A., all rights reserved. Prepared in the United States of America. This document, or parts thereof, reproduced in any form without the specific written permission of Young & Associates, P.A. This plan and design is the exclusive property of Young & Associates, P.A. The delivery of the original or copies thereof does not constitute publication thereof.

8" SANITARY SEWER PLAN & PROFILE
 Sanitary Sewer Extension at 1040 S. Vassar Ave.
 City of Wichita
 Sedgewick County, Kansas

scale: as noted

Design By: TWE
 Drawn By: DSB
 Checked By: CRY
 P/N: 15-374
 Prints Issued:
 Office Check, 06-12-15
 Final Plans, 07-15-15

Revisions:

△
△
△

N.1679440.252, E.1660975.579
 SS Line Sta. 1+00
 Connect to Existing Brick MH
 Top of Rim = 1326.64
 Exist. FL 8" (Out, W)=1315.49
 Exist. FL 8" (In, S)=1315.51
 *Exist. FL 4" Service (In, E)=1315.83
 *Exist. FL 4" Service (Clogged/Collapsed, In, NE)=1315.94
 Prop. 8" FL (In, NE)=1317.40
 (* See Special Note #5)

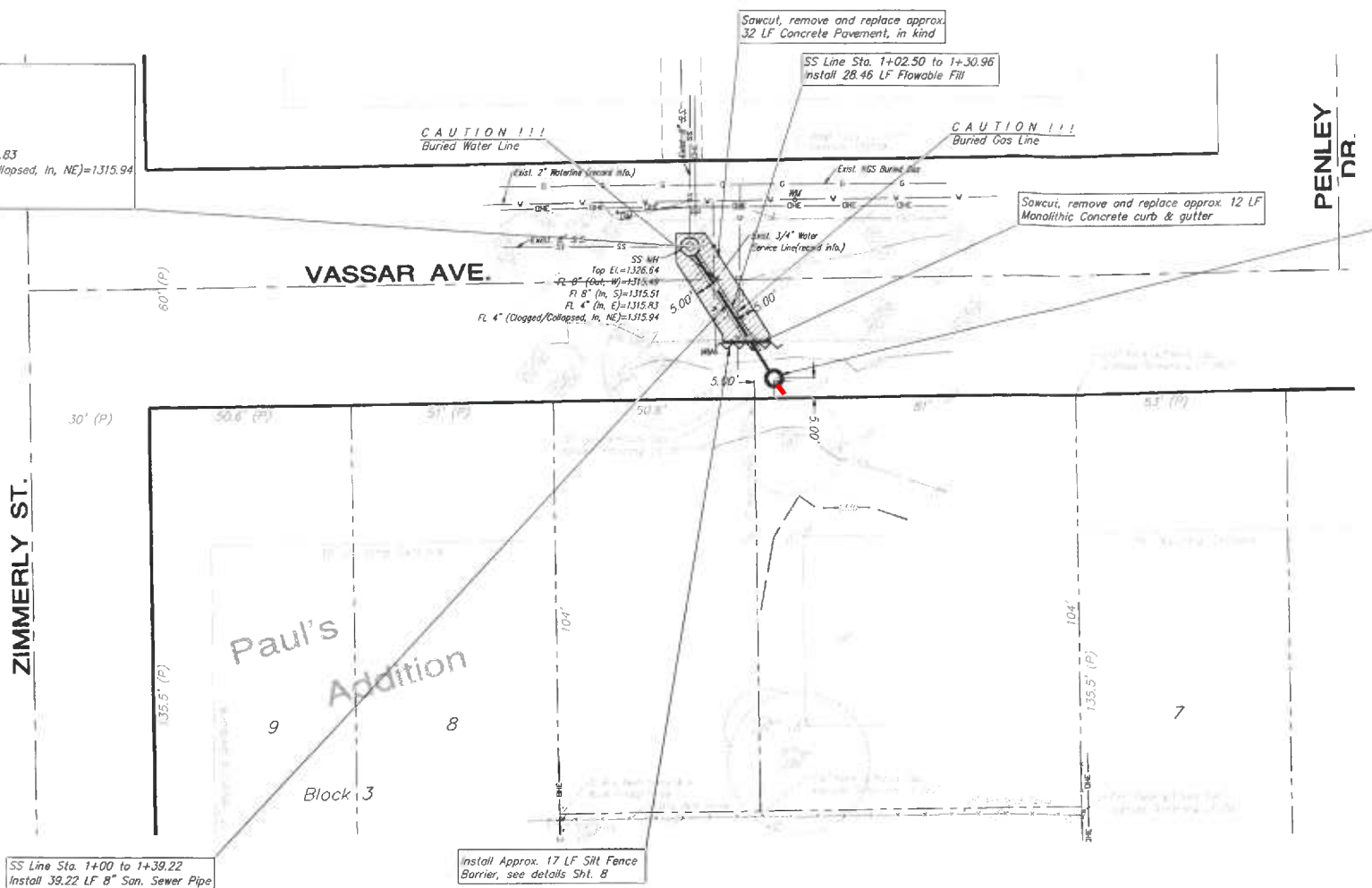

N.1679461.363, E.1661008.637
 SS Line Sta. 1+39.22
 Construct Std. 4' Dia. MH, see details sheets 4 & 5.
 Top of Rim = 1328.51
 FL 8" (Out, SW) = 1318.57
 Install 4" Stub and Vertical Riser Assembly, NE, see details sheet 6.
 FL 4" Stub (In, NE) = 1320.47

Riser #1, Line 1
 Distance from Main to Riser: 1.0' Rt
 Distance from USMH: (top)

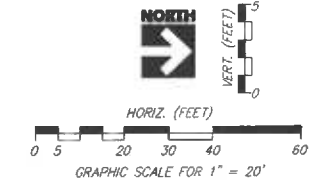

- LEGEND**
- TC = Top of curb elev.
 - FL = Flow-line elev.
 - = Existing Contours, 1-ft. intervals
 - - - - = Existing Buried Gas Line
 - - - - = Existing Overhead Electric Line
 - - - - = Existing Water Line
 - - - - = Existing Sanitary Sewer Line
 - — — = Proposed Sanitary Sewer

- SPECIAL NOTES:**
1. THE CONTRACTOR SHALL USE BEST MANAGEMENT PRACTICES TO CONTROL EROSION AND SEDIMENT DISCHARGE IN ALL DISTURBED AREAS OF CONSTRUCTION. THE CONTRACTOR SHALL PROVIDED ALL NECESSARY MATERIALS, AND EQUIPMENT, AND LABOR TO CONSTRUCT, OPERATE AND MAINTAIN TEMPORARY EROSION AND SEDIMENT CONTROLS DURING CONSTRUCTION.
 2. UNLESS OTHERWISE NOTED ALL DIMENSIONS ARE CENTER OF STRUCTURE TO CENTER OF STRUCTURE.
 3. THE CONTRACTOR SHALL FIELD VERIFY HORIZONTAL AND VERTICAL LOCATIONS OF ALL EXISTING BURIED UTILITY LINES PRIOR TO CONSTRUCTION. REPORT ANY DISCREPANCIES TO THE ENGINEER.
 4. DRILL & DOWEL #4X24" BARS @ 30" O.C., IN ALL AREAS WHERE NEW CONCRETE IS INSTALLED ADJACENT TO EXISTING CONCRETE.
 5. THE CONTRACTOR SHALL DETERMINE IF THE EXISTING 4" SERVICE LINE IS IN USE. IF THIS LINE IS NOT IN USE THEN THE CONTRACTOR SHALL PLUG AND SECURE THIS PIPE AT THE MANHOLE.



YOUNG & ASSOCIATES, P.A.
 Professional Civil Engineering Consultants
 100 S. Georgia, Derby, KS 67037
 Tele: (316)788-2552 Fax: (316)788-4408 email: engineering@yngpa.com

8" SANITARY SEWER PLAN & PROFILE
 Sanitary Sewer Extension at 1040 S. Vassar Ave.
 City of Wichita
 Sedgwick County, Kansas

scale: as noted
 Design By: TWE
 Drawn By: DSB
 Checked By: CRY
 P/N: 15-374
 Prints Issued:
 Office Check, 06-12-15
 Final Plans, 07-15-15

Revisions:
 △
 △
 △

Sheet No.
3 of 11

