

BENCHMARK  
 BM #1 - City of Wichita Disc Located  
 at the SW Corner of the Lincoln  
 Street Bridge at McLean.  
 Elev. 395.110 SI Units (1296.29 MSL)

FHWA REGION NO.	STATE	PROJECT NO.	FISCAL YEAR	SHEET NO.	TOTAL SHEETS
7	KANSAS	87-N-0225-01	2002	10	47

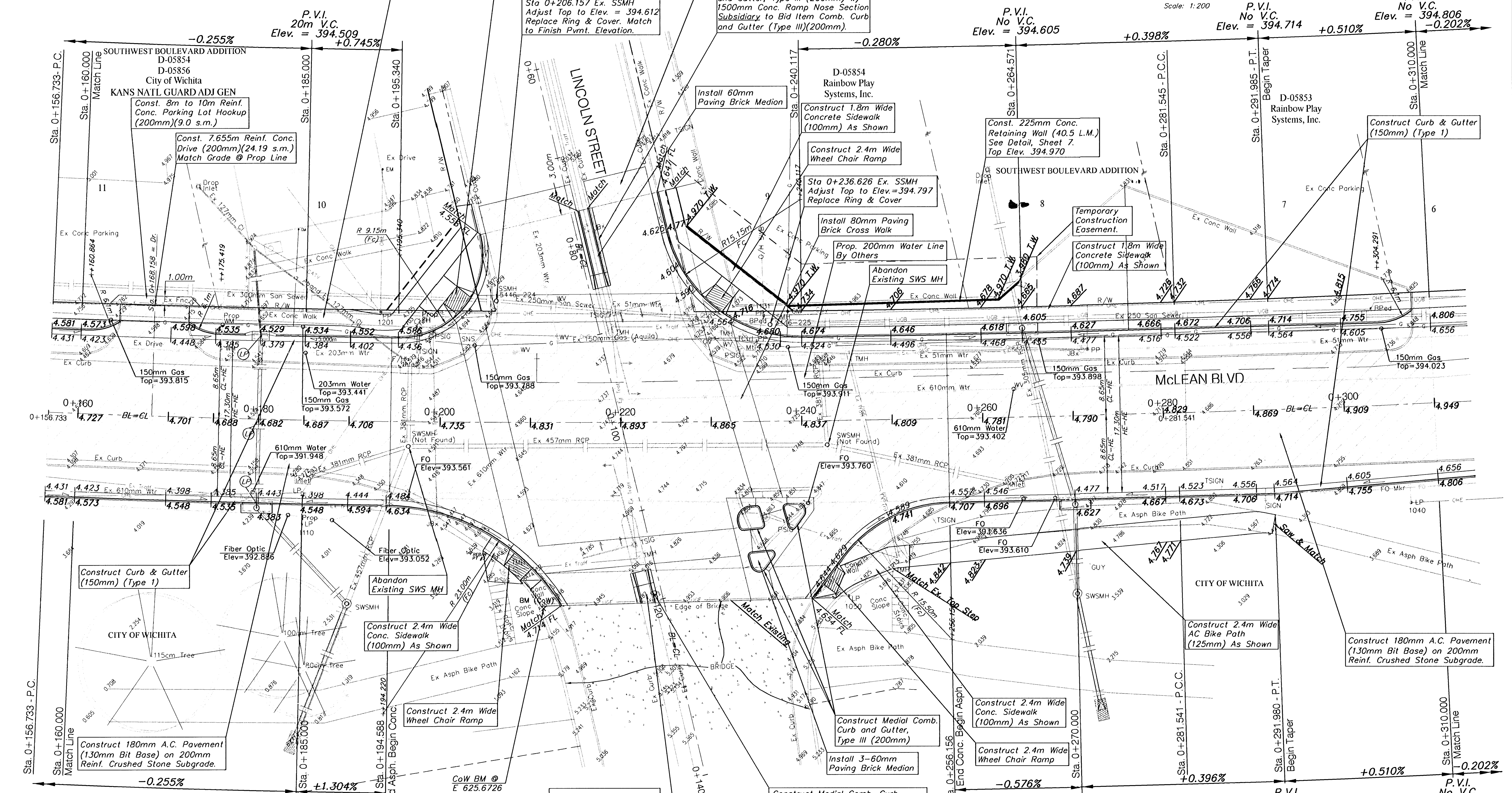
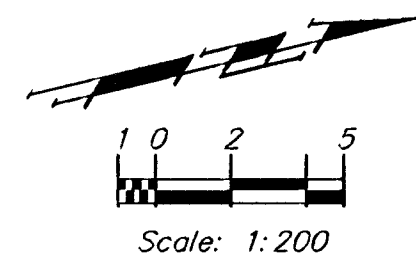

NOTE:  
 Ex Traffic Manholes, Ped. Signals,  
 Signal Poles, Traffic Boxes, etc.  
 shall be removed by the Contractor.  
 Paid as "Removal of Existing  
 Structures".

NOTE:  
 Gas Meters, Utility poles, and Electrical  
 junction pedestals, boxes, etc. are to be  
 REMOVED and RELOCATED as necessary by  
 the Respective Utility Company/Owner PRIOR  
 TO CONSTRUCTION of this Project.

NOTE:  
 Ex SWS Manholes & Inlets in the Project  
 Limits shall be removed/abandoned as  
 necessary for construction and Ex. SWS  
 pipes are to be plugged and abandoned  
 in place per City Specifications unless  
 otherwise noted.

NOTE:  
 Pavement, Sidewalks  
 Etc. To Be Removed  
 Are Indicated By:

PROJECT NUMBER		SHEET NAME		ENGINEERING DIRECTORY	
472-83799		Pav02		F:\Lin\McMnPav	
DESIGN	DRAWN	APPROVED	DATE	SCALE	BAUGHMAN NO.
JFB	KWR	JFB	July 2003	Noted	01-03-E944

CAPITAL IMPROVEMENT PROJECT  
**MCLEAN BOULEVARD PAVING**  
 Sta. 0+160,000 to Sta. 0+310,000  
 LINCOLN AND MCLEAN INTERSECTION IMPROVEMENTS

**BAUGHMAN COMPANY, P.A.**  
 ENGINEERING, SURVEYING, & PLANNING  
 316-262-7271 • 315 ELLIS • WICHITA, KANSAS 67211

SHEET  
 10  
 OF  
 47

