

FHWA REG. NO.	STATE	PROJECT NO.	YEAR	SHEET NUMBER	TOTAL SHEETS
7	KANSAS	87N-0197-01	2004	5	51

FED. AID NO. CM-019 (701)

1:200

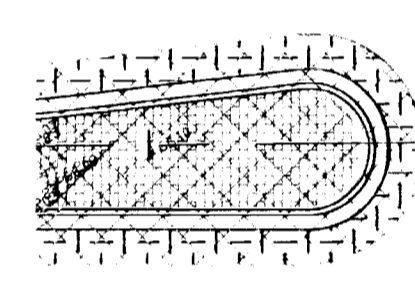
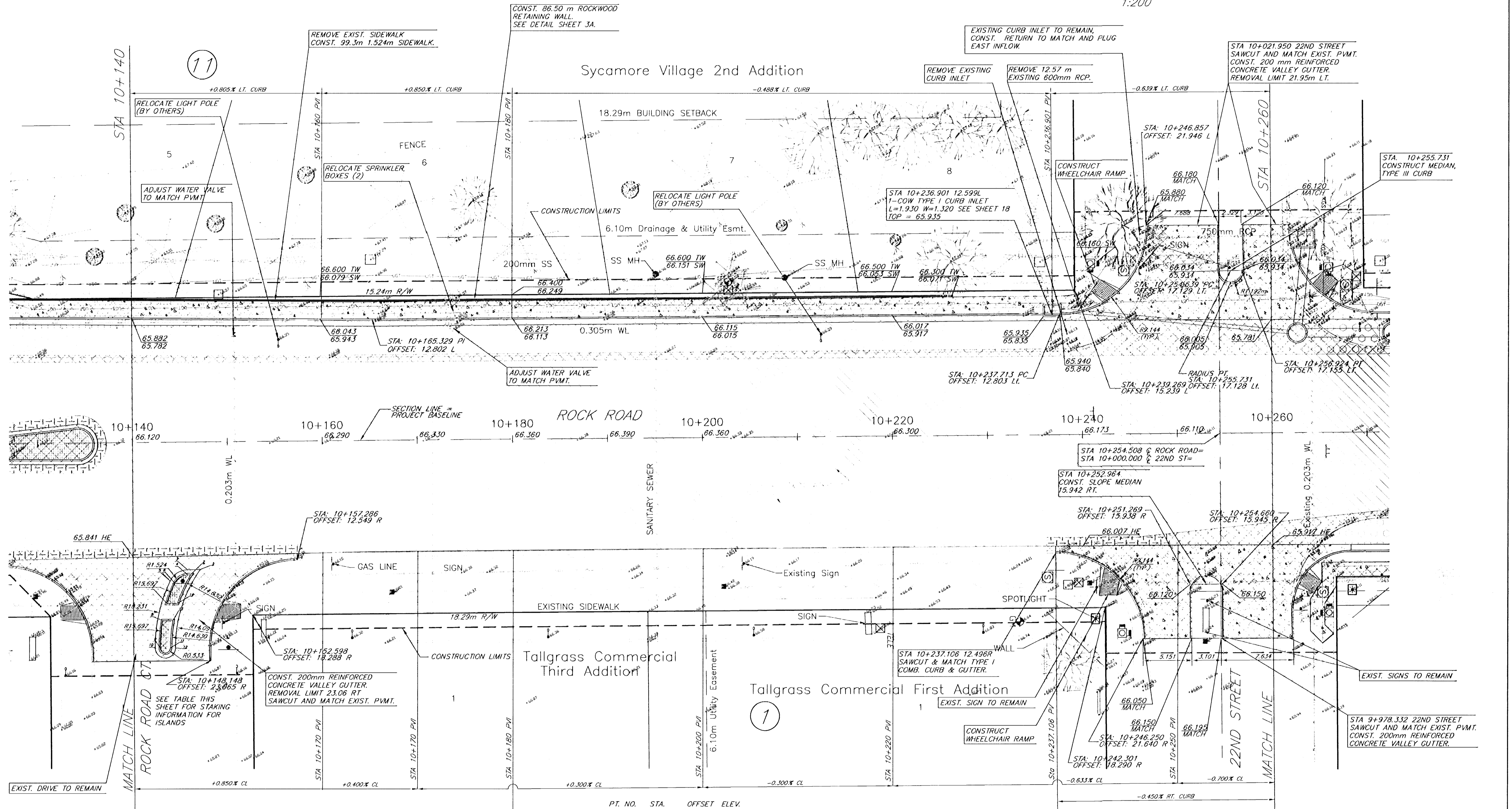

	Remove		50 mm Overlay		XX.XXX(TOP OF CURB, TC)
	50 mm Mill and Overlay		200mm Asphalt Pavement See Detail Sheet		XX.XXX(EDGE OF PAVEMENT, HIGH EDGE.)
	Edge Mill and Overlay		Portland Cement See Detail Sheet		Fescue Sod
			150mm Concrete Base w/ 50mm Asphalt Wearing Course		

PT. NO.	STA.	OFFSET	ELEV.
1	10+147.080	13.44	65.922
2	10+146.072	13.99	66.122
3	10+145.726	13.46	65.911
4	10+145.733	14.00	66.111
5	10+143.901	14.62	65.920
6	10+144.381	14.86	66.120
7	10+143.536	16.99	66.130
8	10+143.080	18.82	66.170
9	10+142.814	21.69	66.241
10	10+142.281	21.69	66.041
11	10+143.881	21.69	66.241
12	10+144.414	21.69	66.041
13	10+144.167	18.82	66.180
14	10+144.659	16.99	66.139

**Rock Road-21st Street North to 29th Street North**  
**Sta. 10+140 to 10+260**  
 City of Wichita

PROJECT NUMBER  
**472-83889**

	KEM NO.	FILE	DATE	SHEET
	02042	plan2	08/2002	5
DESIGN	DRAWN	REVISED	OF	
		3/2004	51	

516 S. Market, Wichita, KS 67202      316/264-0242