

INDEX OF SHEETS

- 1 TITLE SHEET
- 2-3 TYPICAL SECTION/GENERAL NOTES
- 3A RETAINING WALL DETAILS
- 4-17 PAVING PLANS
- 18-21 STORM SEWER PLAN AND PROFILE
- 21A-C CURB INLET DETAILS
- 22 SUMMARY OF QUANTITIES
- 23 SIDEWALK AND STEPS
- 23A AUXILIARY DETAILS FOR SIDEWALK AND STEPS
- 24 CURB, GUTTER, AND COMBINED CURB AND GUTTER
- 25-26 EROSION CONTROL SEEDING SODDING SUMMARY OF SODDING QUANTITIES
- 27-31 SIGNAL PLANS, WIRING PLANS, TRAFFIC SIGNAL QUANTITIES
- 32 CONTROL POINTS
- 33 STEEL SIGNAL POLE ASSEMBLY DETAILS
- 34 TEMPORARY SIGNAL DETAIL
- 35-36 TRAFFIC SIGNAL SPECIFICATIONS
- 37 PAVEMENT MARKING PLAN
- 38 SIGNAGE MARKING PLAN
- 39-42 CONSTRUCTION STAGING
- 43 TYPICAL TRAFFIC CONTROL SIGNS
- 44-51 CROSS-SECTIONS

STATE OF KANSAS
DEPARTMENT OF TRANSPORTATION



PLAN AND PROFILE OF PROPOSED
FEDERAL AID PROJECT

ROCK ROAD, 21ST STREET NORTH TO 29TH STREET NORTH
WICHITA, SEDGWICK COUNTY, KANSAS

POPULATION = 304,011
K-DOT PROJECT # 87N-0197-01
CITY OF WICHITA PROJECT # 472-83889
OCA # 706874

FHWA REG. NO.	STATE	PROJECT NO.	YEAR	SHEET NUMBER	TOTAL SHEETS
7	KANSAS	87 N-0197-01	2004	1	51

FED. AID NO. CMQ-N019 (701)

GRADING
SURFACING
CONCRETE PAVEMENT
SEEDING
PAVEMENT MARKINGS
LANDSCAPING

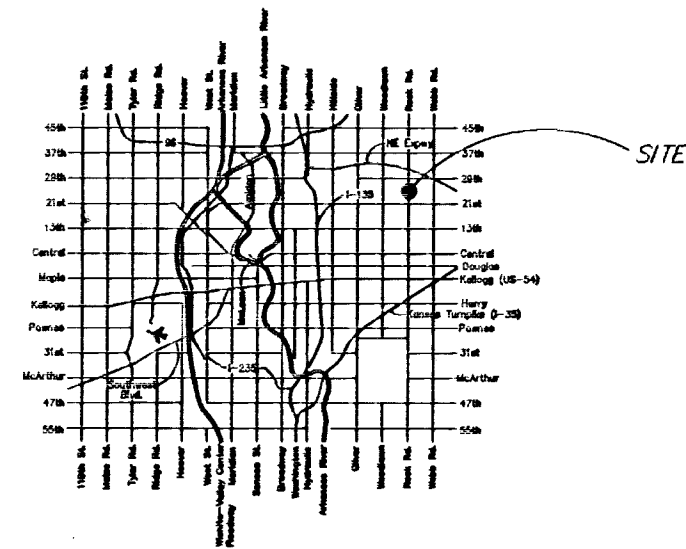

LOCATION MAP

DESIGN DESIGNATION

	21ST	29TH
AADT (2002) =	27,907	25,507
AADT (2030) =	33,500	32,200
DIV =	10K	10K
T =	3%	3%
V =	60 KPH	60 KPH

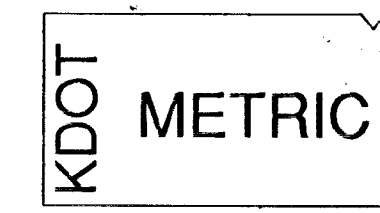

All dimensions shown, without an SI suffix, are in millimeters. All elevations shown are in meters.

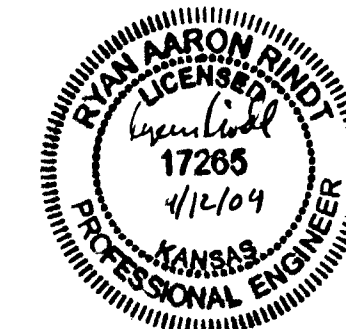
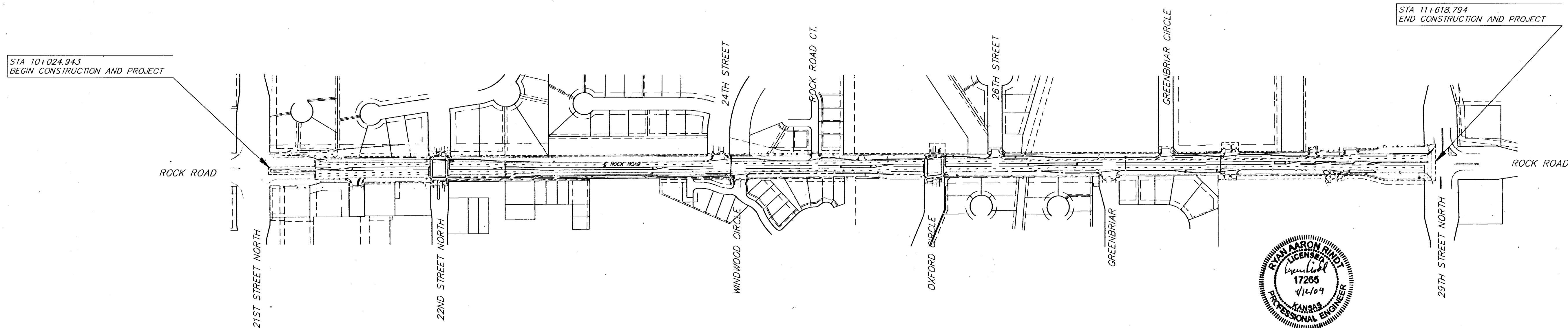

GROSS LENGTH OF PROJECT	1593.851 m
EXCEPTIONS	0.000 m
NET LENGTH OF PROJECT	1593.851
NET LENGTH OF BRIDGES	0.000 m
NET LENGTH OF ROAD	1593.851 m

APPROVED - DATE

JIM ARMOUR, P.E.
CITY ENGINEER
PROJECT NO. 472-83889



516 S. Market,
Wichita, KS 67202

316/264-0242