

BENCHMARKS:
 BM #3 - Top of the 3/4" Iron Pipe at the Property Corner at the Northeast Corner of the Elder and Murdock Intersection
 Elev. = 1312.19 (NAVD 88)

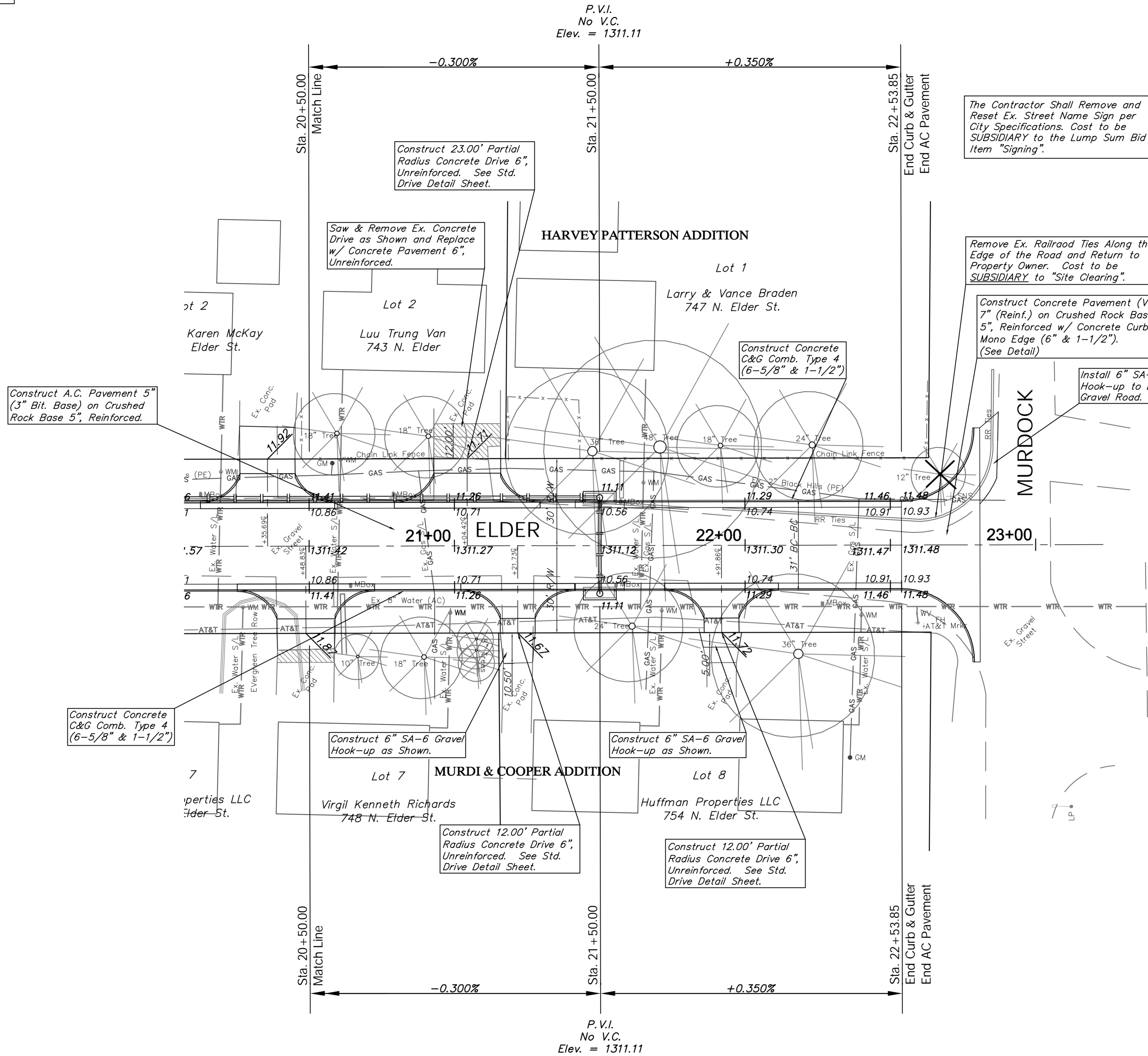
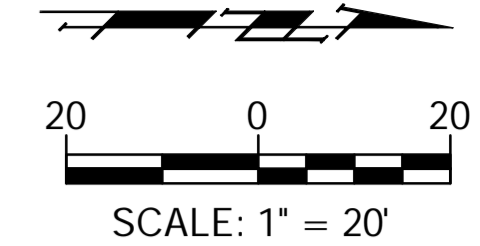

Construct 23.00' Partial Radius Concrete Drive 6", Unreinforced. See Std. Drive Detail Sheet.

Saw & Remove Ex. Concrete Drive as Shown and Replace w/ Concrete Pavement 6", Unreinforced.

Construct A.C. Pavement 5" (3" Bit. Base) on Crushed Rock Base 5", Reinforced.

Construct Concrete C&G Comb. Type 4 (6-5/8" & 1-1/2")

The Contractor Shall Remove and Reset Ex. Street Name Sign per City Specifications. Cost to be SUBSIDIARY to the Lump Sum Bid Item "Signing".

Remove Ex. Railroad Ties Along the Edge of the Road and Return to Property Owner. Cost to be SUBSIDIARY to "Site Clearing".

Construct Concrete Pavement (VG) 7" (Reinf.) on Crushed Rock Base 5", Reinforced w/ Concrete Curb Mono Edge (6" & 1-1/2"). (See Detail)

Install 6" SA-6 Gravel Hook-up to Existing Gravel Road.

Construct Concrete C&G Comb. Type 4 (6-5/8" & 1-1/2")

Construct 6" SA-6 Gravel Hook-up as Shown.

Construct 6" SA-6 Gravel Hook-up as Shown.

Construct 12.00' Partial Radius Concrete Drive 6", Unreinforced. See Std. Drive Detail Sheet.

Construct 12.00' Partial Radius Concrete Drive 6", Unreinforced. See Std. Drive Detail Sheet.

Note:
 Pavement, Sidewalks, and Etc. To Be Removed Are Indicated By:

Note:
 Trees/Shrubs to be removed are marked thus:

Drawing File: E:\Projects\Elm & Elder\Civil 3d\Base Map.dwg (Pav 03)
 Design: TPV
 Drawn: LP
 Approved: TPV
 Scale: Noted

Project No. 15-07-E267 CAPITAL IMPROVEMENT PROJECT
ELDER STREET PAVING
 Sta. 20+50.00 to Sta. 22+53.85
 ELM AND ELDER PAVING PROJECT

Baughman Company, P.A.
 315 Ellis St., Wichita, KS 67211 P 316-262-7271 F 316-262-0149
 ENGINEERING | SURVEYING | PLANNING | LANDSCAPE ARCHITECTURE

March 2016
 SHEET 9 OF 30