

4/21/2016 11:57:40 PM

CITY OF WICHITA, KANSAS RE-USE WATER PUMP STATION TO SERVE SPIRT AEROSYSTEMS

©2016 MKEC Engineering All Rights Reserved www.mkec.com These drawings and their contents, including, but not limited to, all concepts, designs, & ideas are the exclusive property of MKEC Engineering (MKEC), and may not be used or reproduced in any way without the express consent of MKEC.

WALL SECTIONS

Table with project details: PROJECT NO. 468-85112, DATE 04-18-16, SCALE AS NOTED, DESIGNED DGA, DRAWN TEAM, CHECKED DGA

Table with revision history: 0 ISSUED FOR CONSTRUCTION 04/18/16, NO. REVISION DATE

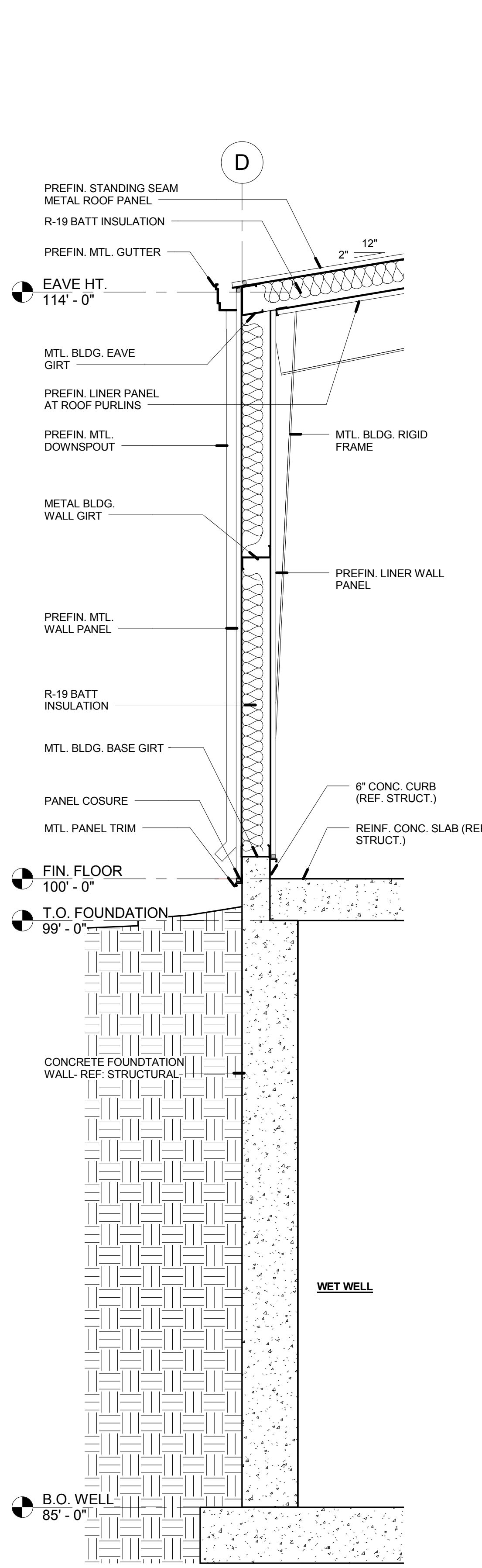

A SIDEWALL @ WET WELL 1/2" = 1'-0"

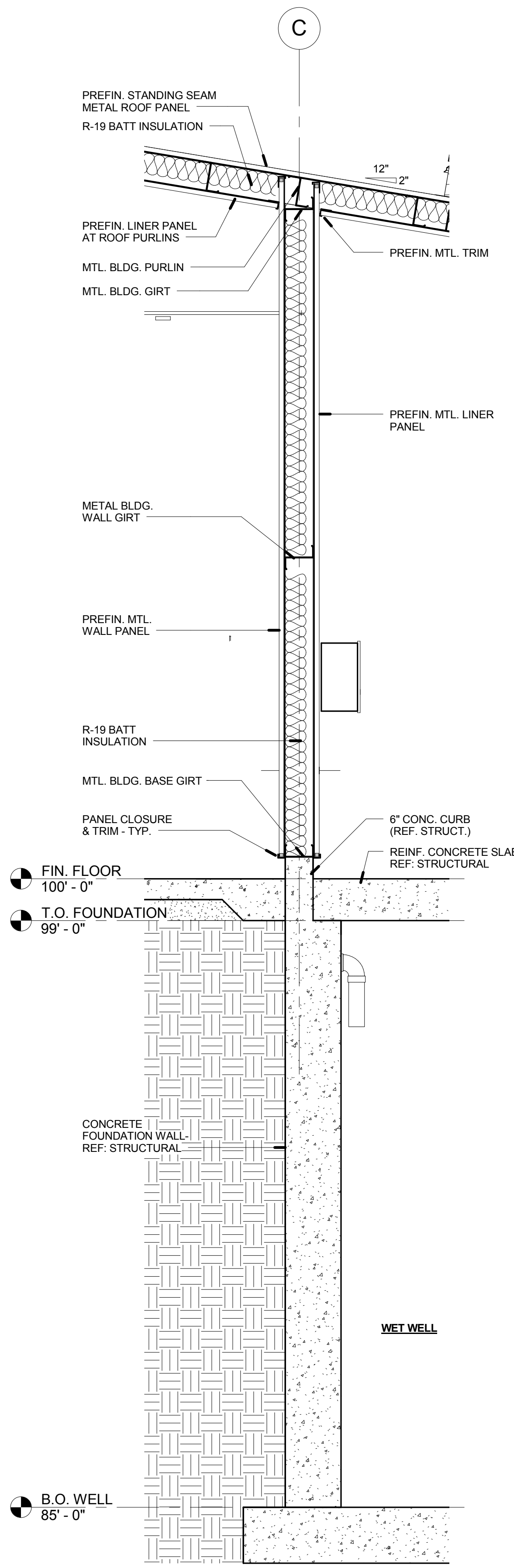

B INTERIOR WET WELL 1/2" = 1'-0"

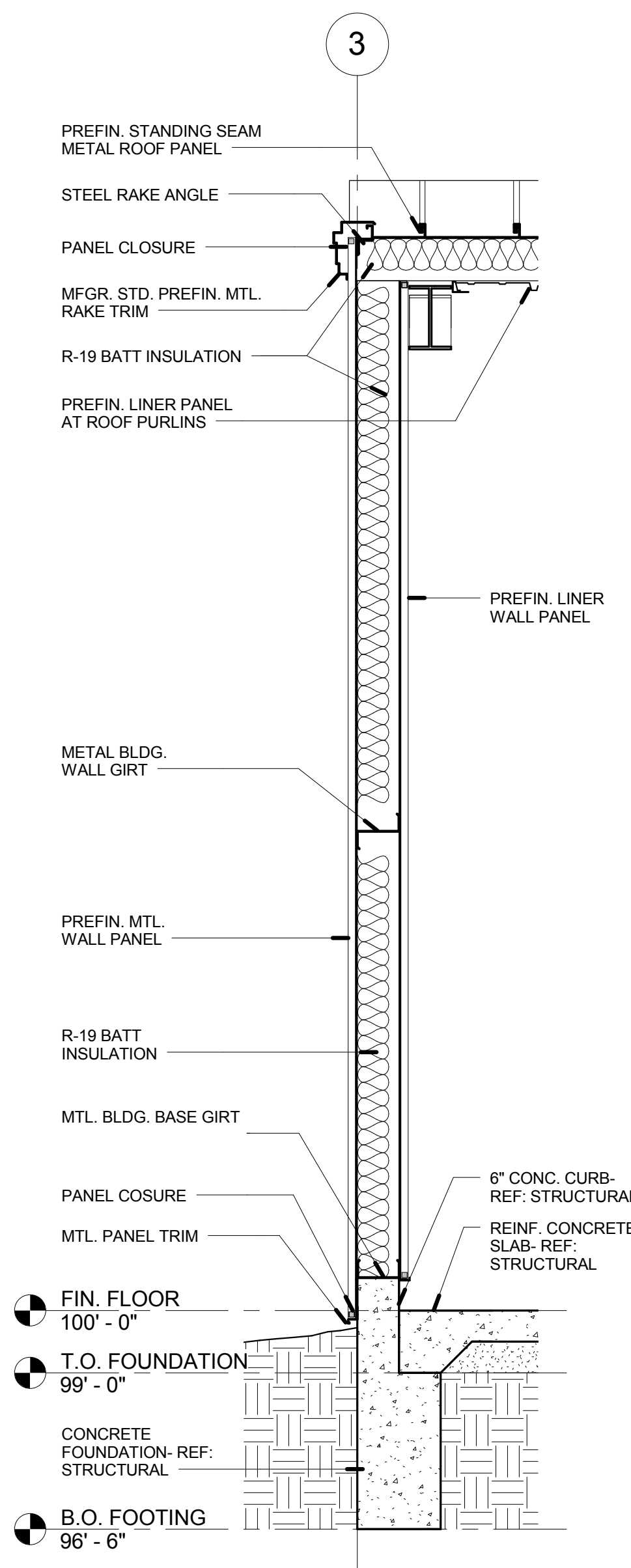

C TYPICAL ENDWALL 1/2" = 1'-0"

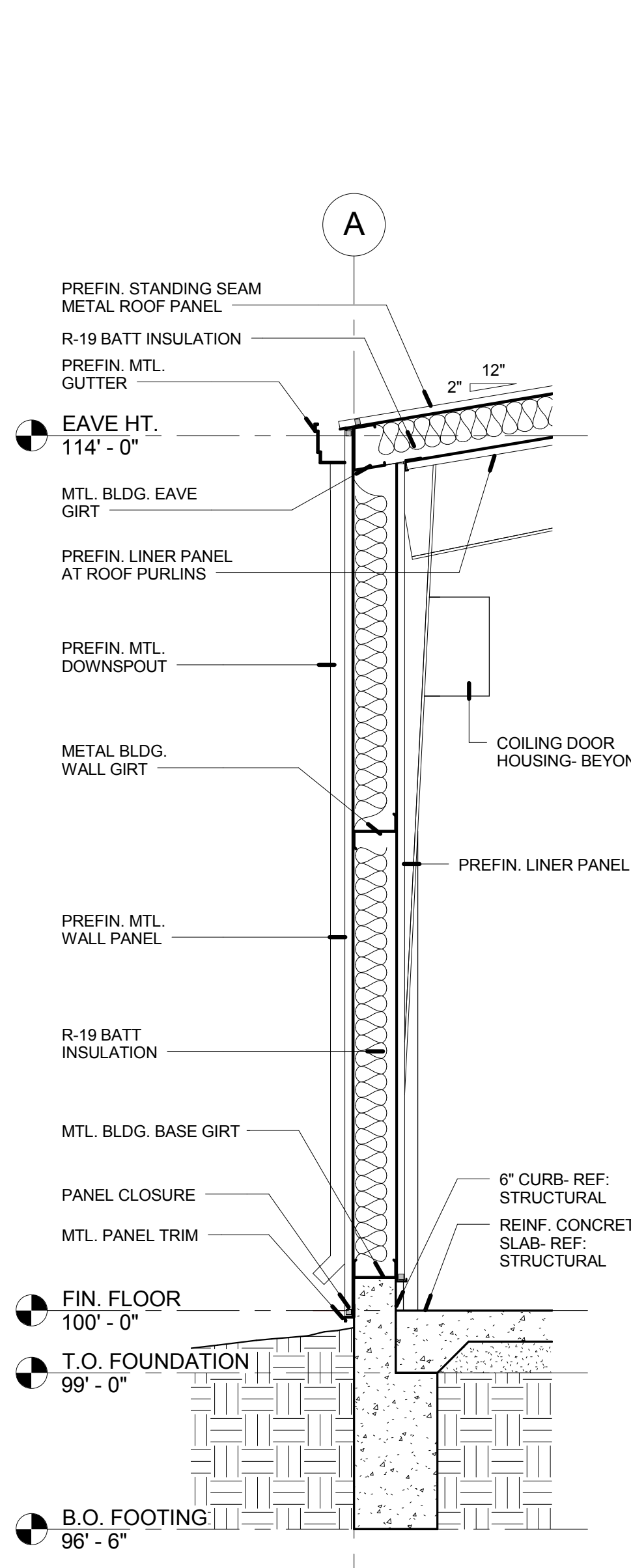

D TYPICAL SIDEWALL 1/2" = 1'-0"

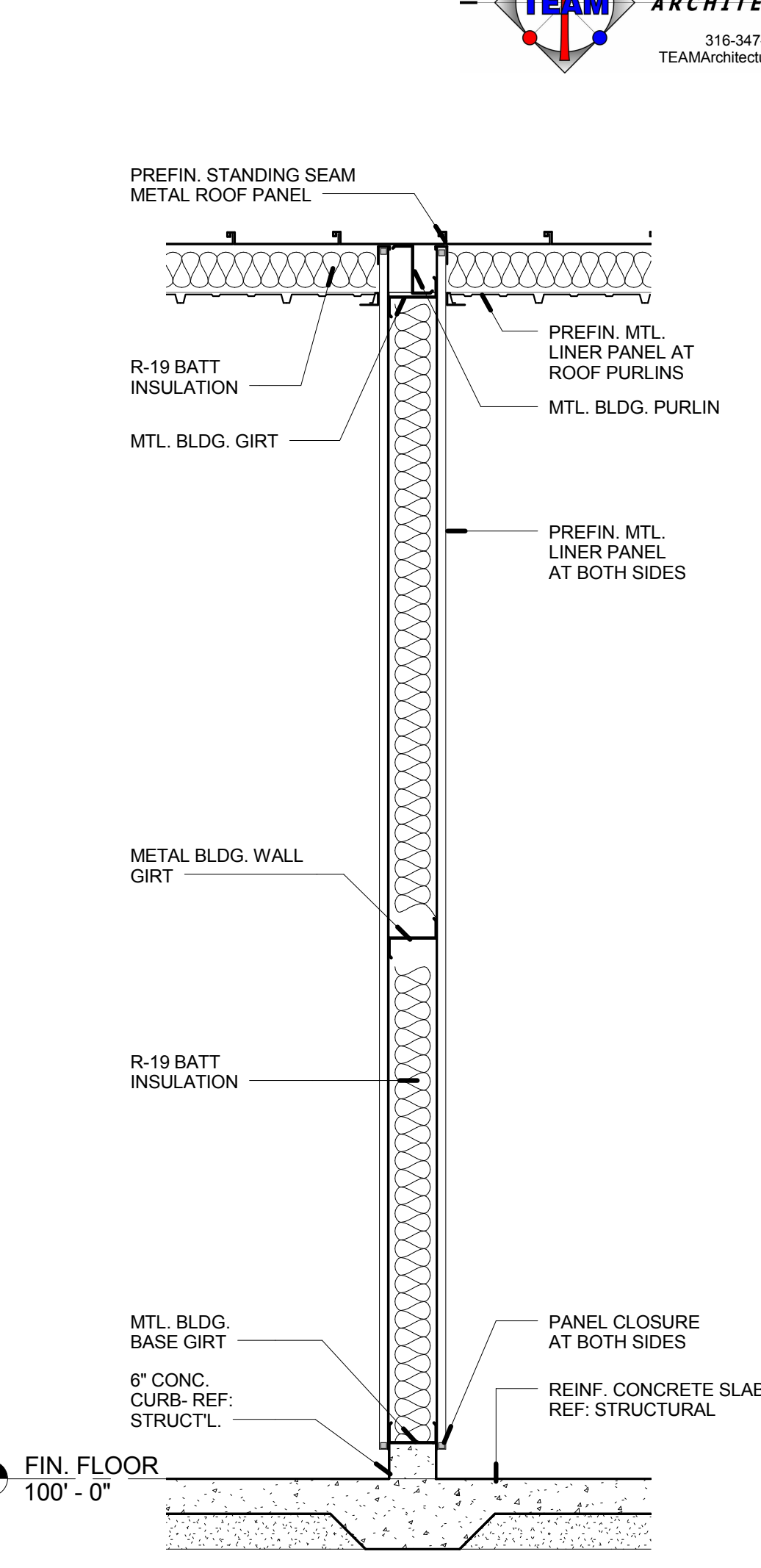

E MCC WALL 1/2" = 1'-0"

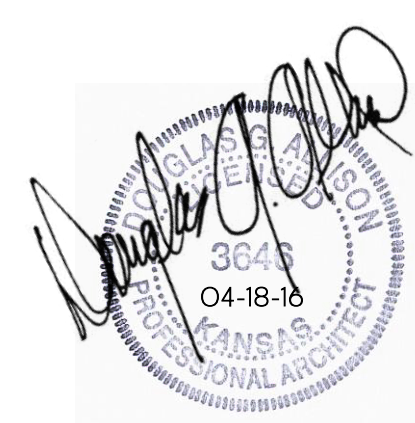

C:\2015-004 CDW Pump Station\Architecture\CDW WATER PUMP.rvt