

PLOTTED: Wednesday, May 04, 2016 @ 10:54AM  
 J:\CIVIL\052110\DWG\CIVIL\3D\CAD\SWR\PH2\BOX\052110 SWR RCB PP.DWG

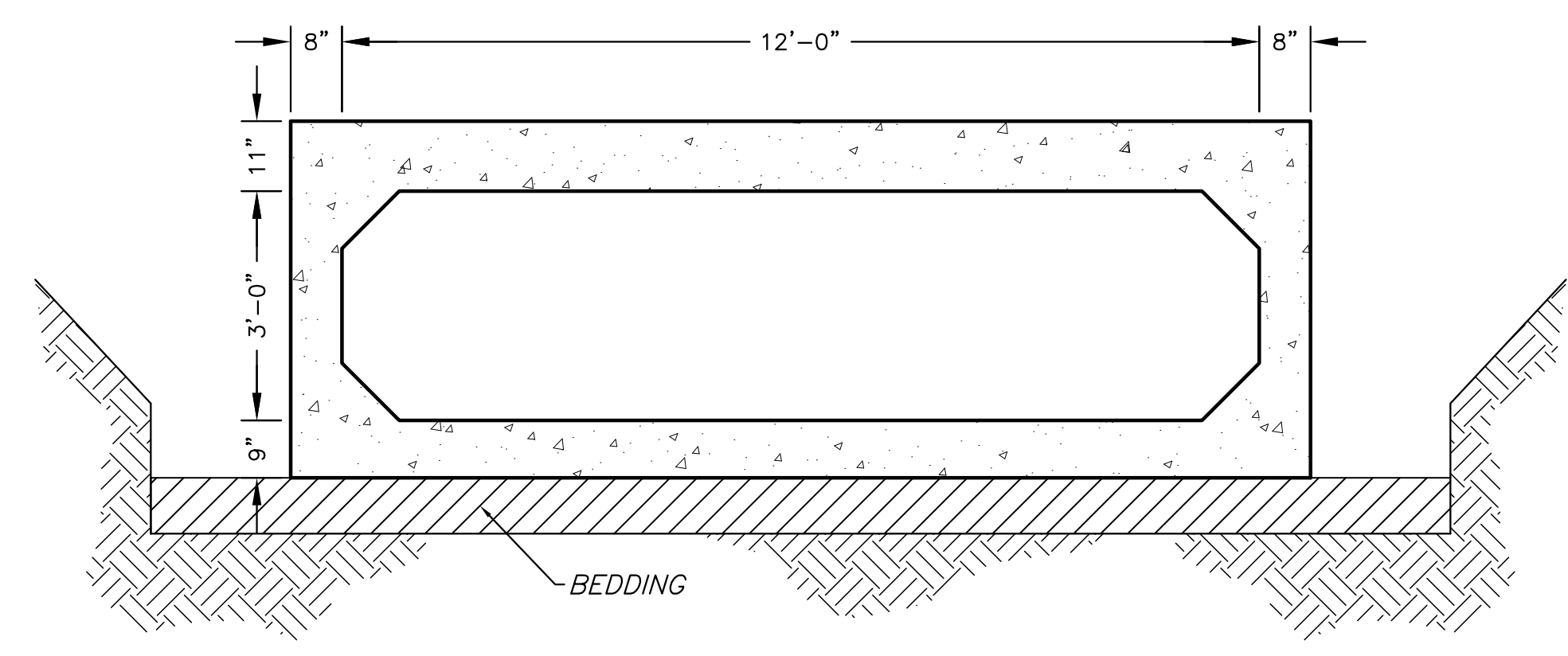

**GENERAL NOTES**

**LOADING:** HS20-44 AASHTO Specifications, 1996 Edition.  
**UNIT STRESSES:** Class AAA (AE) Concrete;  $f'c = 4,000$  p.s.i.  
 Reinforcing Steel;  $f_y = 60,000$  p.s.i.  
**CONCRETE:** Class AAA (AE) Concrete shall be used throughout.  
 Bevel all exposed edges with a 3/4" triangular moulding.  
**REINFORCING:** All reinforcing shall conform to ASTM A615,  
 Grade 60. All dimensions relative to reinforcing steel shall  
 be to centerline of bar unless otherwise noted.  
**EXCAVATION:** Excavation for culvert shall not be paid for directly  
 but shall be subsidiary to box construction.

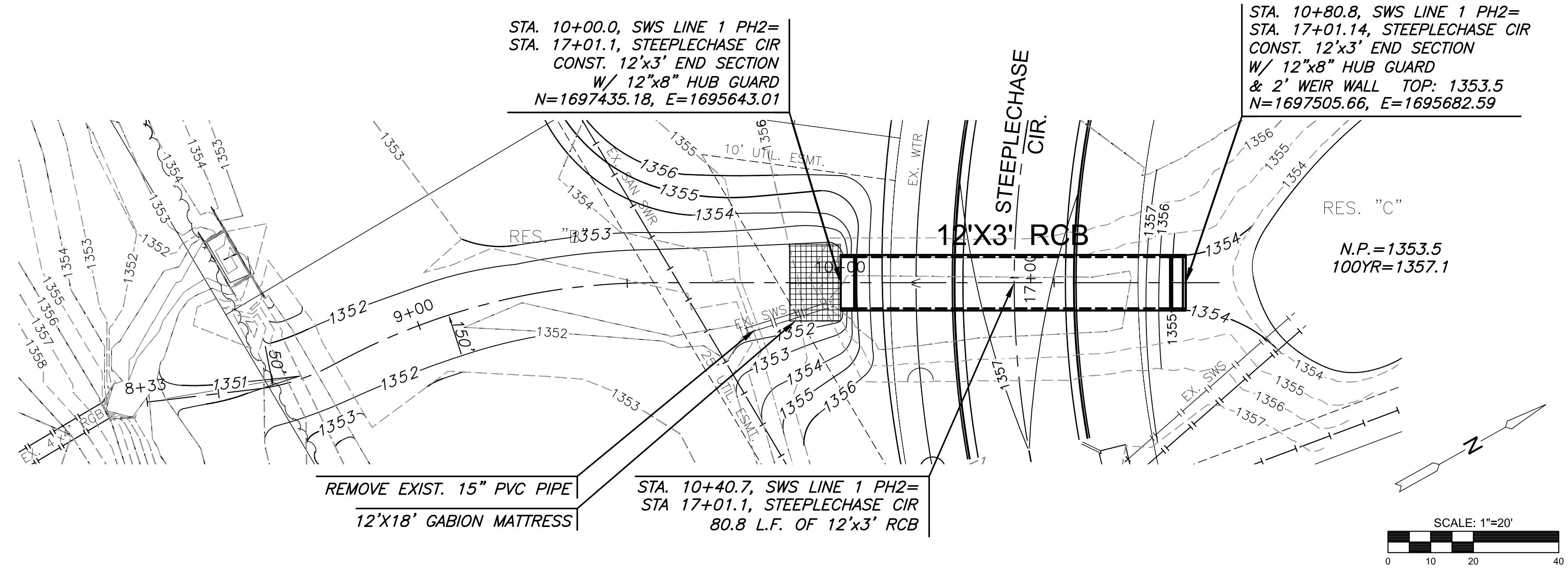

**PLAN SWS LINE 1 PH2  
PROFILE SWS LINE 1 PH2**

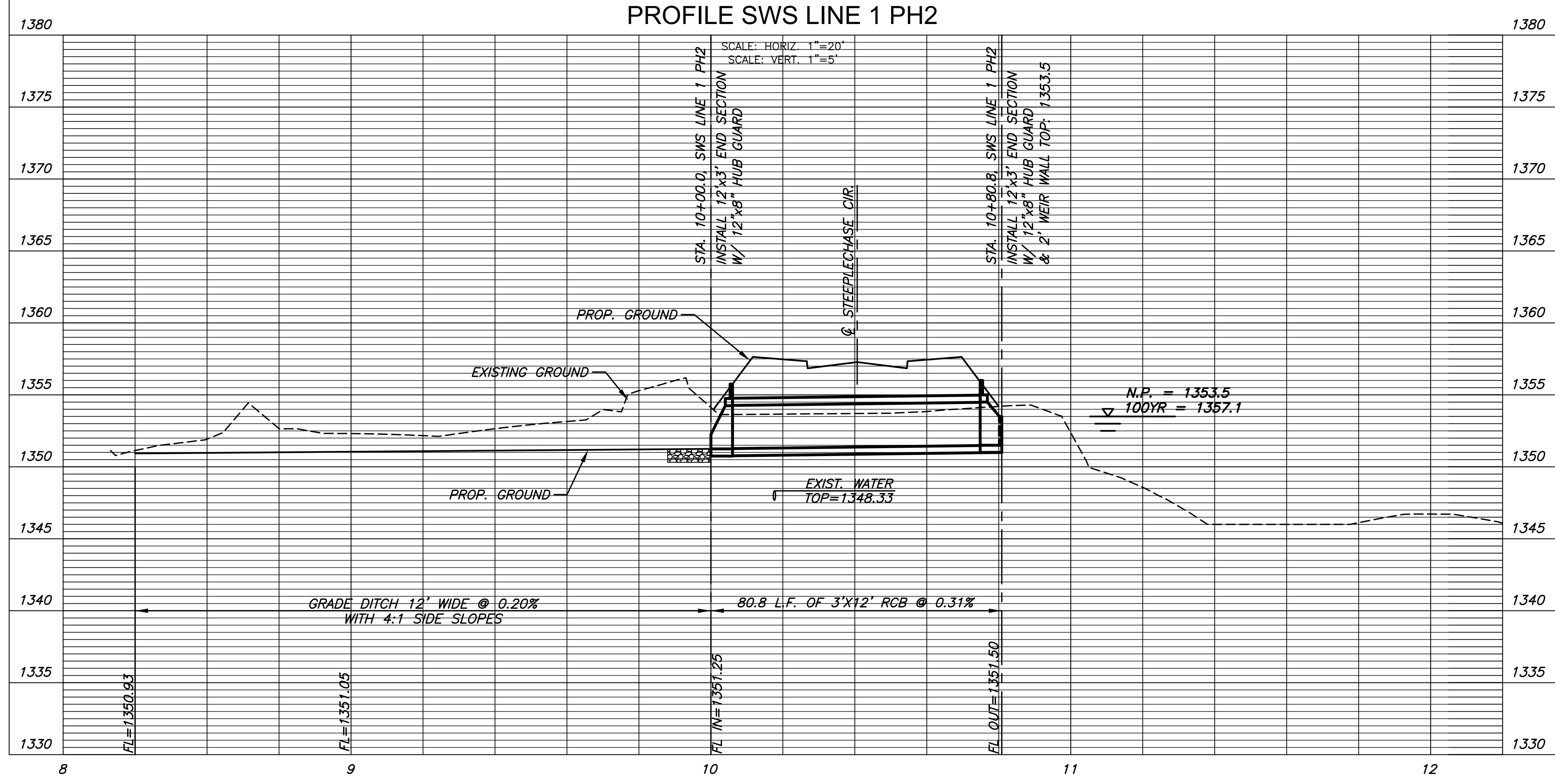

**STORM WATER SEWER PLAN FOR  
KRUG SOUTH ADDITION  
PHASE 2**

©2016  
 MKEC Engineering  
 All Rights Reserved  
 www.mkec.com  
 These drawings and their contents,  
 including, but not limited to, all concepts,  
 designs, & ideas are the exclusive  
 property of MKEC Engineering (MKEC),  
 and may not be used or reproduced in any  
 way without the express consent of MKEC.

**RCB PLAN & PROFILE**

PROJECT NO.	468-84324	
DATE	MAY 2016	
SCALE	1"=20'	
DESIGNED	DRAWN	CHECKED
DFL	BKS	GJA

NO.	REVISION	DATE

SHEET NO. 2 OF 9

