

**PAWNEE AVENUE BRIDGE OVER
ARKANSAS RIVER
BRIDGE REHABILITATION IMPROVEMENTS**

©2013
MKEC Engineering
All Rights Reserved
www.mkec.com
These drawings and their contents, including, but not limited to, all concepts, designs, & ideas are the exclusive property of MKEC Engineering (MKEC), and may not be used or reproduced in any way without the express consent of MKEC.

**EROSION AND
SEDIMENT
CONTROL PLAN**

PROJECT NO. 472-84922

DATE 04/05/2016

SCALE 1"=30'

DESIGNED DRAWN CHECKED
JRA DPG JRA

NO.	REVISION	DATE

SHEET NO.





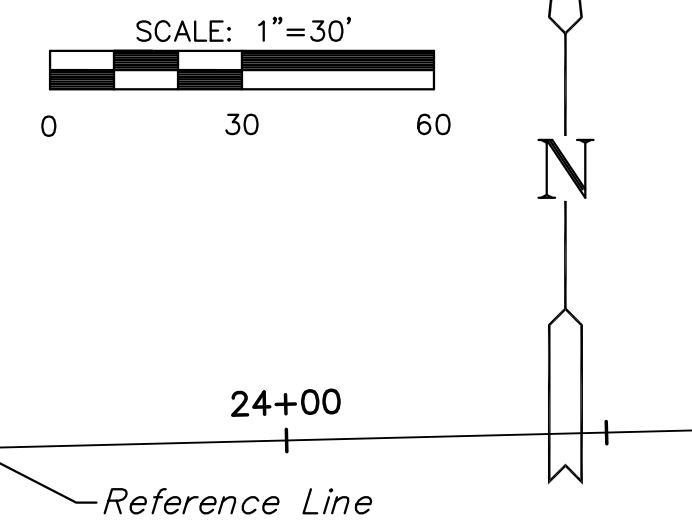
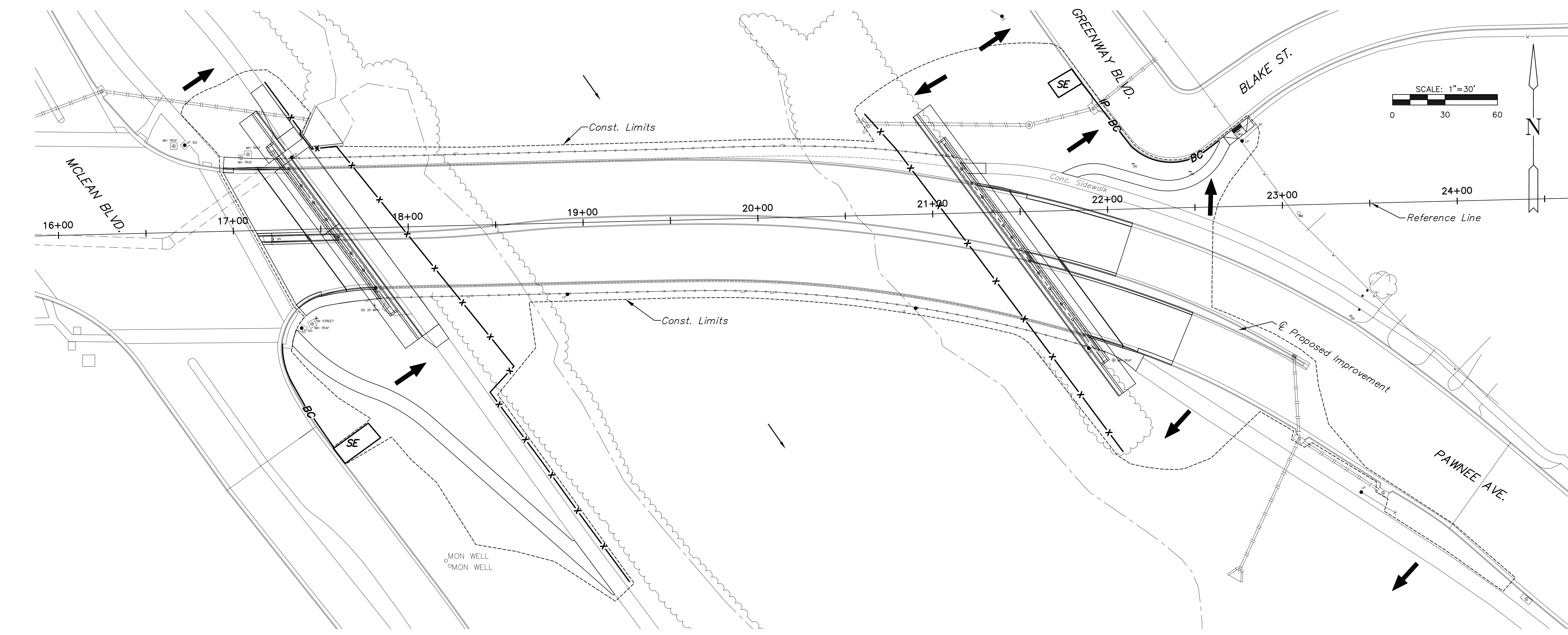



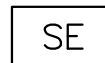
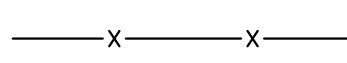
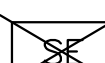

PLOTTED: Tuesday, April 05, 2016 @ 11:56AM

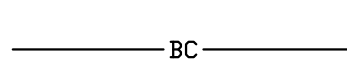
J:\CH\10264\dwg\EROSION\10264 Erosion Plan.dwg

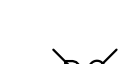

PLAN

LEGEND

- | | | | |
|---|-------------------------------|--|---------------------------------|
|  | STABILIZED ENTRANCE |  | SILT FENCE |
|  | STABILIZED ENTRANCE REMOVED |  | SILT FENCE REMOVED |
|  | AREA INLET PROTECTION |  | BACK OF CURB PROTECTION |
|  | AREA INLET PROTECTION REMOVED |  | BACK OF CURB PROTECTION REMOVED |
|  | CURB INLET PROTECTION |  | DITCH CHECK PROTECTION |
|  | CURB INLET PROTECTION REMOVED |  | DITCH CHECK PROTECTION REMOVED |
|  | CONSTRUCTION LIMITS |  | DIRECTION OF DRAINAGE |

NOTES:

This project will disturb less than 1.0 acres.

Refer to City of Wichita Standards for bmp installation, inspection and maintenance details and specifications.

Cost for each erosion and sediment control item shall include maintenance, inspection and eventual removal. Besides keeping each device in working order, maintenance shall include, at a minimum, sediment removal before 50% of the device's capacity is reached.

Contractor shall adjust erosion and sediment control plans to conform to actual construction operations. All changes to plan shall be approved by the City.

Stabilized entrances shall be provided as directed by the City. It is anticipated that 4 entrances will be necessary during construction.

EROSION CONTROL BMP SUMMARY		
ITEMS	QUANTITY	UNIT
BMP, Back of Curb Protection	158	L.F.
BMP, Construction Entrance	2	Each
BMP, Curb Inlet Protection	1	Each
BMP, Silt Fence	622	L.F.

RECAPITULATION		
BID ITEMS	TOTAL	UNIT
BMP, Back of Curb Protection	158	L.F.
BMP, Construction Entrance	2	Each
BMP, Curb Inlet Protection	1	Each
BMP, Silt Fence	622	L.F.