

Location of Existing Line is Based on Record Information from the City. The Contractor Shall Excavate the Ex. Water and to Verify Size and Location PRIOR to Beginning Construction. This Work Shall be Considered SUBSIDIARY to the Water Line Installation.

Water Line 25 Baseline = Centerline Dunsworth St.

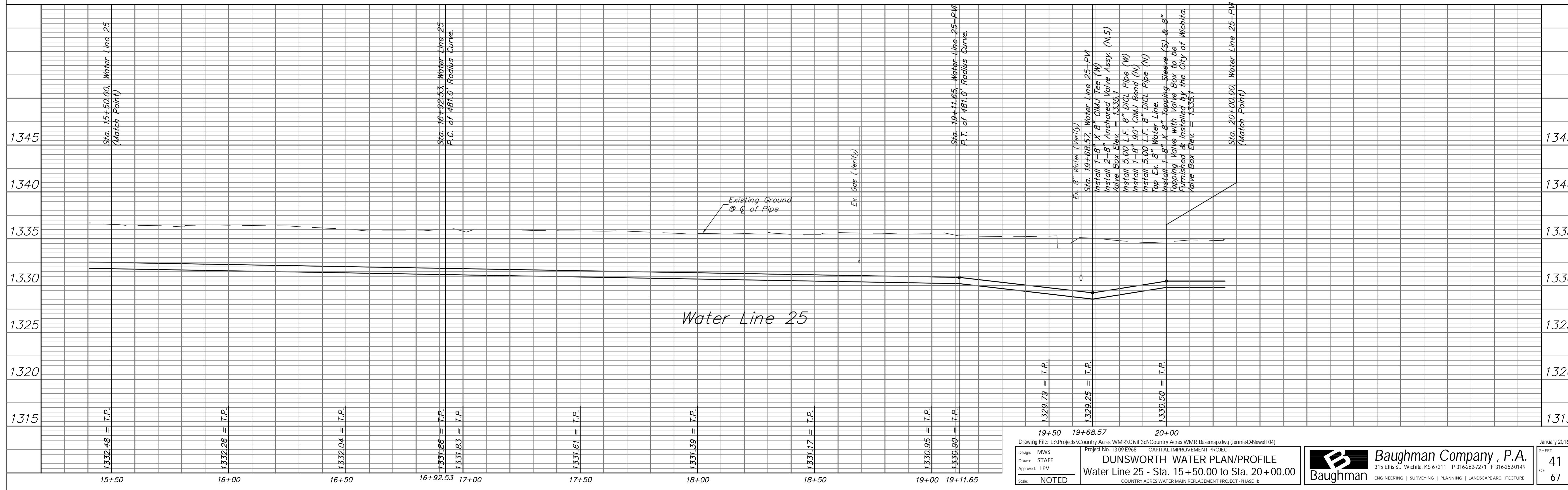

19+50 19+68.57 20+00  
 Design: MWS  
 Drawn: STAFF  
 Approved: TPV  
 Scale: NOTED  
 Project No. 1309E968 CAPITAL IMPROVEMENT PROJECT  
**DUNSWORTH WATER PLAN/PROFILE**  
 Water Line 25 - Sta. 15+50.00 to Sta. 20+00.00  
 COUNTRY ACRES WATER MAIN REPLACEMENT PROJECT - PHASE 1b

**Baughman Company, P.A.**  
 315 Ellis St., Wichita, KS 67211 P 316-262-7271 F 316-262-0149  
 ENGINEERING | SURVEYING | PLANNING | LANDSCAPE ARCHITECTURE

January 2016  
 SHEET 41 OF 67