

STATE OF KANSAS
DEPARTMENT OF TRANSPORTATION



PLAN AND PROFILE OF PROPOSED
ROCK ROAD IMPROVEMENTS

32nd STREET TO K96
FEDERAL AID URBAN SYSTEM PROJECT

WICHITA, SEDGWICK COUNTY
POPULATION 327,000
KDOT PROJECT NO. 87 N-0198-01
CITY PROJECT NO. 472-83439
OCA NO. 708830

FHWA REG NO.	STATE	PROJECT NO.	YEAR	SHEET NO.	TOTAL SHEETS
7	KANSAS	87 N-0198-01	2001	1	82

FED. AID N.D. CMQ-N019(801)

GRADING
SURFACING
ROADSIDE IMPROVEMENT
TRAFFIC SIGNALS
PAVEMENT MARKING AND SIGNING
SEEDING

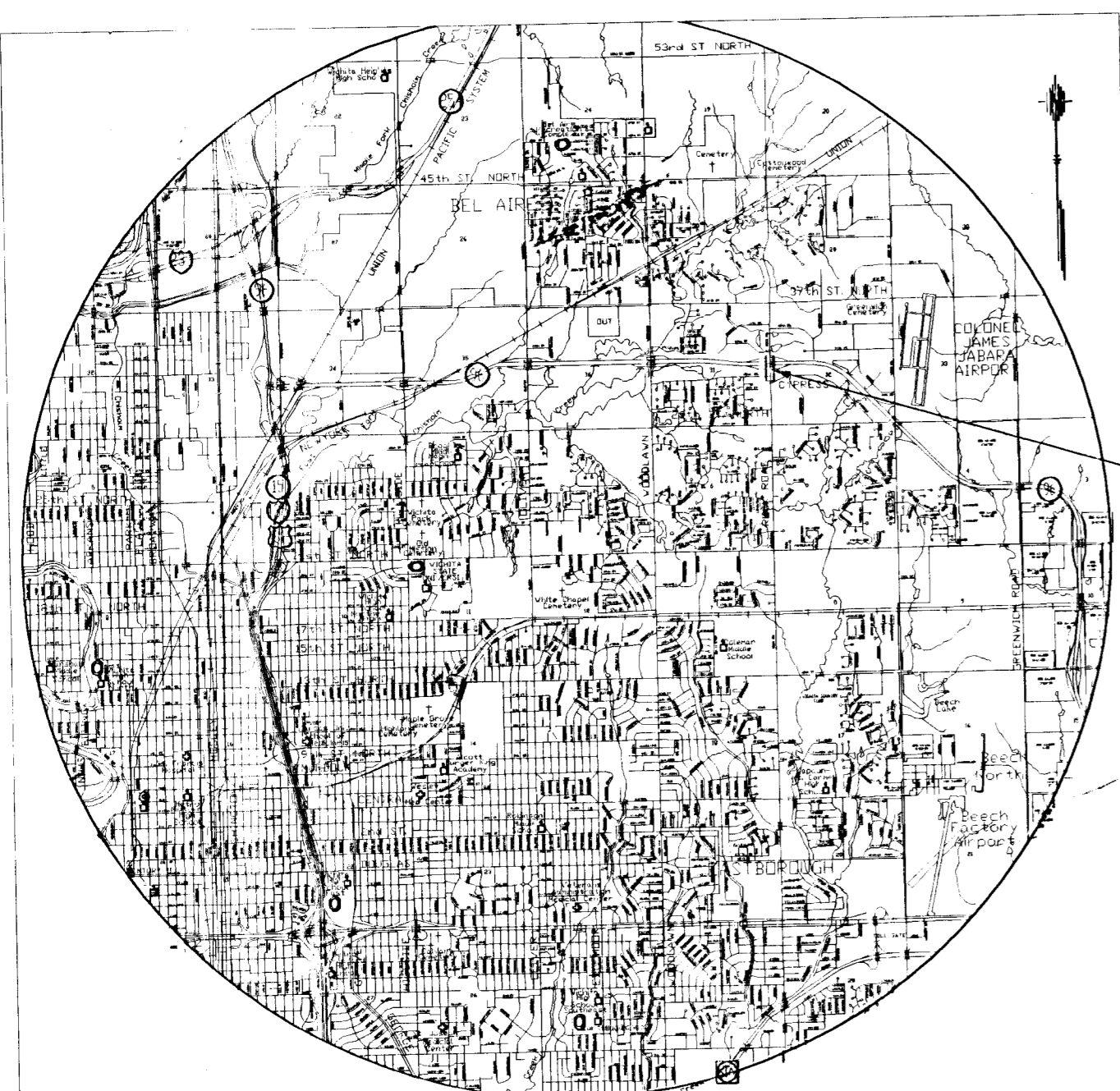

VICINITY MAP
NO SCALE

Project Location

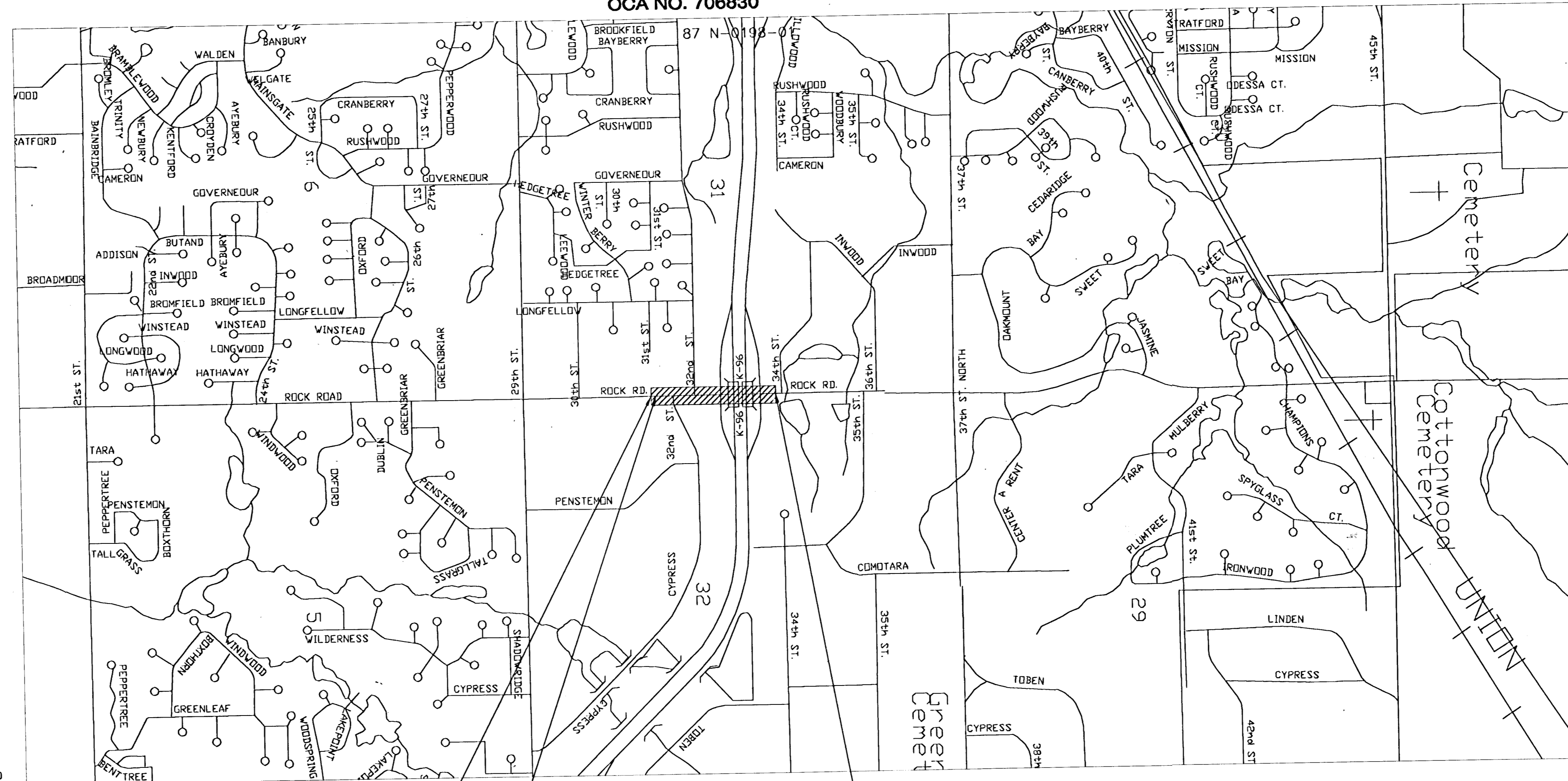

INDEX OF SHEETS

1	Title Sheet
2	General Notes
3-4	Typical Sections
5-8	Plan Sheets - Rock Road
9-10	Plan Sheets - K-96 Off Ramp
11	Concrete Pavement Detail
12	Valley Gutter Detail
13	Curb, Gutter, and Combined Curb and Gutter
14	Sidewalk and Steps
15	Type I-A 1.500m Curb Inlet
16	Type I 1.500m Curb Inlet
17	Type I 3.000m Curb Inlet
18	Reinforced Concrete Manhole
19	Manhole Frame & Cover Detail
20	Miscellaneous Details
21-22	Summary of Quantity Sheets
23-25	Seeding Detail Sheets
26-44	Traffic Signal Plans
45-57	Pavement Marking and Signing Plans
58	Limits of Milling
59	Project Surfacing
60-72	Traffic Control Plans
73-80	Rock Road Cross Sections
81-82	K-96 Off Ramp Cross Sections

DESIGN DESIGNATION

AADT(1998) = 22,000 VPD
AADT (2020) = 22,600 VPD
T = 2%
V = 60 km/h

CONVENTIONAL SIGNS

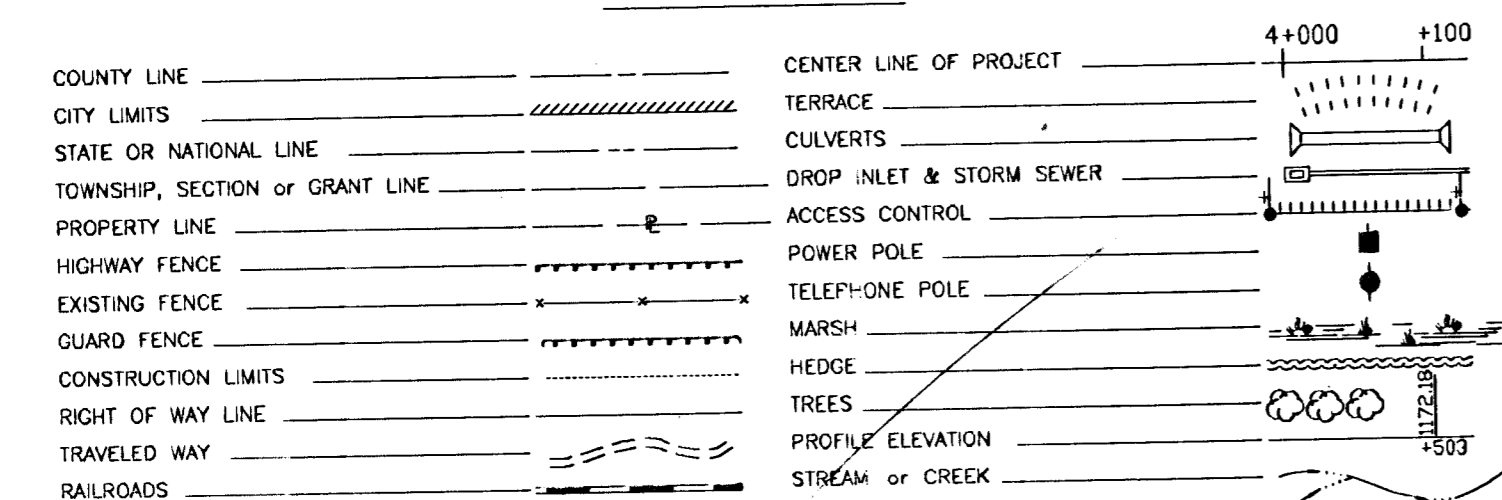

Traffic Control Notes:

- ROCK ROAD IS TO REMAIN OPEN WITH AT LEAST ONE LANE IN EACH DIRECTION THROUGH CONSTRUCTION WITH A SHARED CENTER LEFT TURN LANE SOUTH OF K-96.
- 32nd STREET NORTH WEST OF ROCK ROAD IS TO REMAIN OPEN TO A MINIMUM OF ONE LANE FOR ACCESS. 32ND STREET SOUTH SHALL NOT BE CLOSED.
- DURING CONSTRUCTION THE CONTRACTOR SHALL PROVIDE ACCESS TO ADJACENT PROPERTIES THAT ACCESS ROCK ROAD STREET DIRECTLY.
- SOUTH BOUND ROCK ROAD MAY BE CLOSED FOR UP TO 5 HOURS DURING RELOCATION OF THE TRAFFIC SIGNAL POLE. SOUTH BOUND ROCK ROAD MAY BE CLOSED BETWEEN THE HOURS OF 1:00 AM AND 6:00 AM FOR ONE DAY ONLY.

GROSS LENGTH OR PROJECT 472.52 m
EXCEPTIONS -----

NET LENGTH OF PROJECT 472.52 m
NET LENGTH OF BRIDGES N/A
NET LENGTH OF ROAD 472.52 m

Sta. 3+019.040
Begin Construction

Sta. 3+052.553 Begin
Project 87 N-0198-01

Sta. 3+539.018
End Project

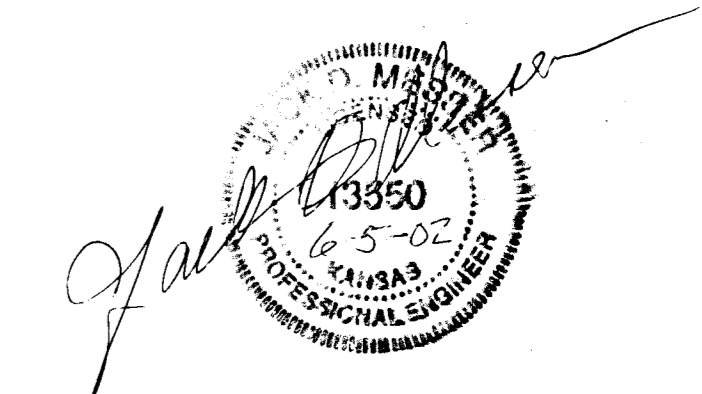

RECOM. FOR APPROVAL-DATE

CITY ENGINEER
CITY OF WICHITA

RECOM. FOR APPROVAL-DATE

CHIEF, BUREAU OF LOCAL PROJECT
KANSAS DEPARTMENT OF TRANSPORTATION

APPROVED - DATE

STATE TRANSPORTATION ENGINEER
KANSAS DEPARTMENT OF TRANSPORTATION

PLANS PREPARED & SURVEY COMPLETED BY:
HWS
Consulting Group Inc

Manhattan Office
3208 Kimball Avenue
Manhattan, KS 66503
Phone: (785) 539-2202
Fax: (785) 539-2393