

FHWA REG NO.	STATE	PROJECT NO.	YEAR	SHEET NO.	TOTAL SHEETS
7	KANSAS	87 N-0198-01	2001	10	82

FED. AID NO. - CMQ-N019(801)

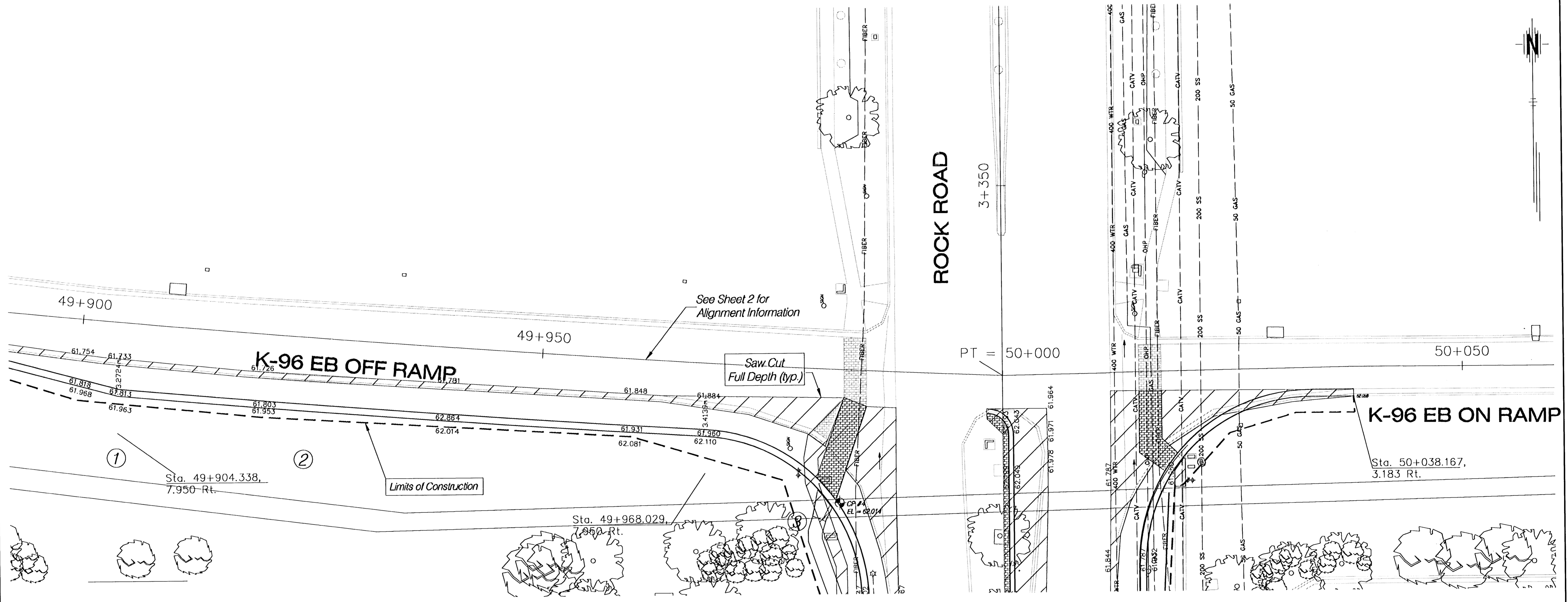
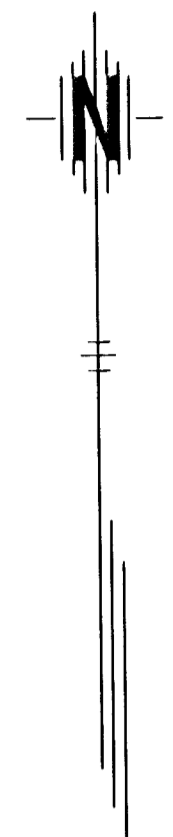

Legend

- Water Flow
- Control Point
- Pavement Removal
- Construction Easement
- Limits of construction
- Right Of Way
- Permanent Easement
- Remove Tree

① Sta. 49+904.338, 7.950 m Rt.
End Taper

② 1838.103 m R
R.P. Sta. = 49+596.099, 1804.581 Lt.
P.C. Sta. = 49+904.338, 7.950 Rt.
P.T. Sta. = 49+968.029, 7.950 Rt.

③ 18.000 m R
R.P. Sta. = 49+968.029, 25.950 Rt.
P.C. Sta. = 49+968.029, 7.950 Rt.
P.T. Sta. = 49+985.755, 24.965 Rt.

CONTROL POINT INFORMATION

CP #4
3/4" REBAR
Sta. 49+982.912, 14.476 RT
N 17968.225 E 11983.598
ELEV 62.014

**ROCK ROAD
PLAN
STA. 49+900 - 50+050**

Manhattan Office
3206 Kimball Avenue
Manhattan, KS 66503
Phone: (785) 539-2202
Fax: (785) 539-2392

Elev. are at even 20m Stations unless otherwise noted.

Designed By: JJH	Checked By: JDM
Drawn By: GEW	Date: FEB 2002 Job No. 55-70-2003