

FHWA REG NO.	STATE	PROJECT NO.	YEAR	SHEET NO.	TOTAL SHEETS
7	KANSAS	87 N-0198-C	2001	29	82

FED. AID NO. - CMQ-N019(80)

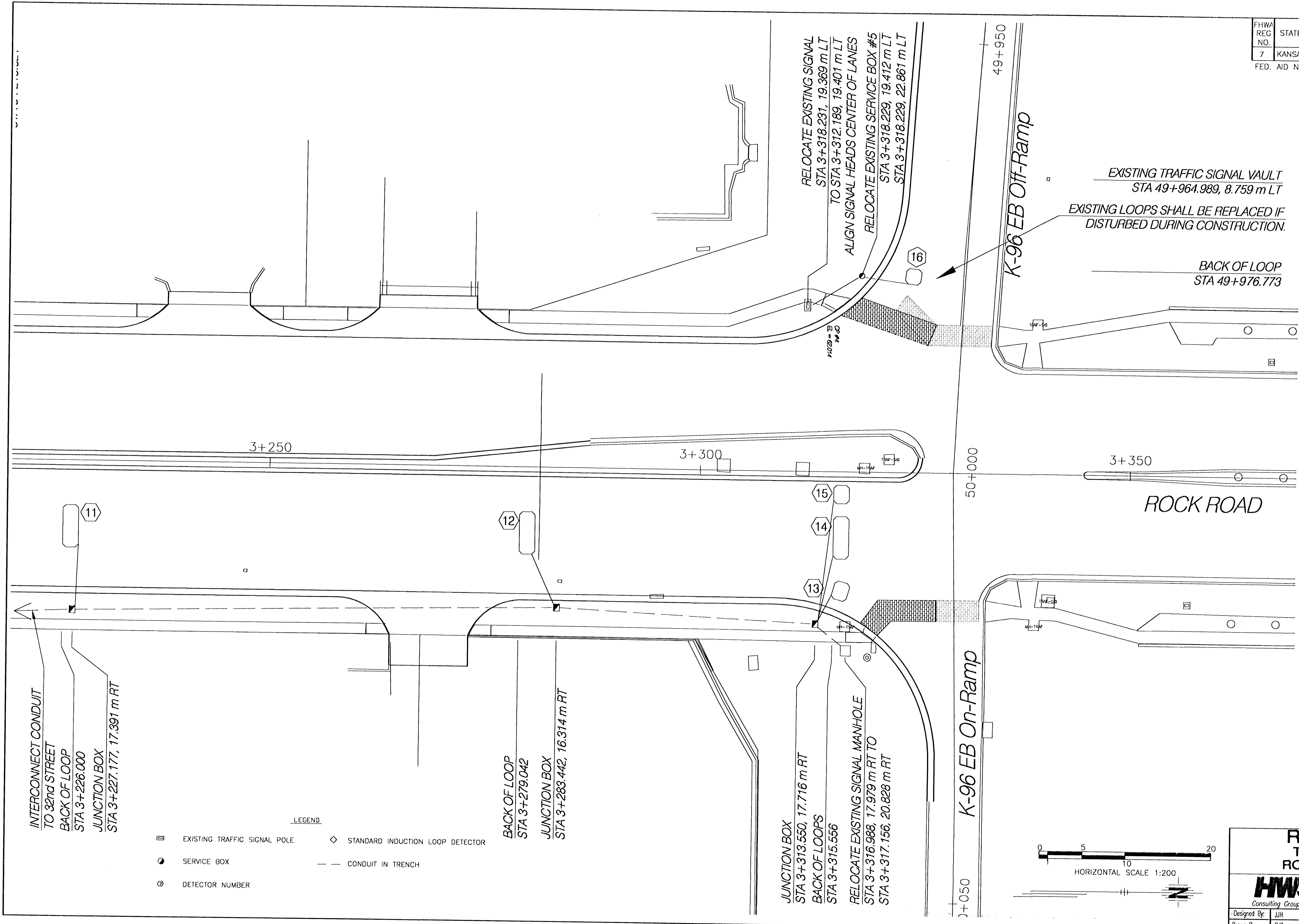

INTERCONNECT CONDUIT
TO 32nd STREET
BACK OF LOOP
STA 3+226.000
JUNCTION BOX
STA 3+227.177, 17.391 m RT

- LEGEND**
- ▣ EXISTING TRAFFIC SIGNAL POLE
 - ◊ STANDARD INDUCTION LOOP DETECTOR
 - SERVICE BOX
 - DETECTOR NUMBER
 - CONDUIT IN TRENCH

BACK OF LOOP
STA 3+279.042
JUNCTION BOX
STA 3+283.442, 16.314 m RT

JUNCTION BOX
STA 3+313.550, 17.716 m RT
BACK OF LOOPS
STA 3+315.556
RELOCATE EXISTING SIGNAL MANHOLE
STA 3+316.988, 17.979 m RT TO
STA 3+317.156, 20.828 m RT

RELOCATE EXISTING SIGNAL
TO STA 3+318.231, 19.369 m LT
ALIGN SIGNAL HEADS CENTER OF LANES
RELOCATE EXISTING SERVICE BOX #5
STA 3+318.229, 19.412 m LT
STA 3+318.229, 22.861 m LT

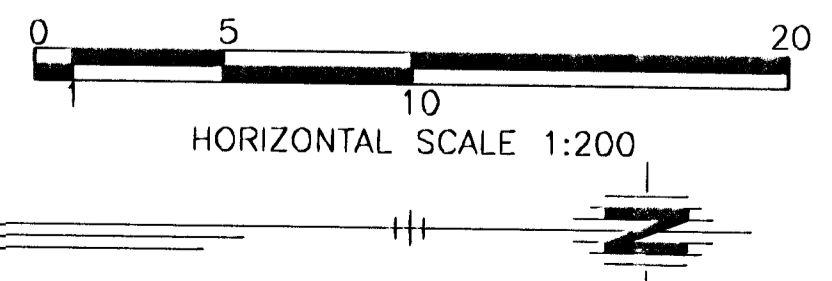

ROCK ROAD TRAFFIC SIGNAL ROCK ROAD & K-96

HWS Consulting Group Inc.

Manhattan Office
3208 Kimball Avenue
Manhattan, KS 66503
Phone: (785) 539-2202
Fax: (785) 539-2393

Designed By: JJH	Checked By: JDM
Drawn By: BJD	Date: 11/14/01 Job No. 55-70-2003