

BENCHMARKS:
 CITY OF WICHITA BENCHMARK DISK
 34.9' S. & 31.2' W. OF THE SW COR.,
 NW1/4, SEC. 2, TWP. 27-S, R-1-W.
 ELEV. = 1327.57 NAVD88

CITY OF WICHITA BENCHMARK DISK
 26.2' S. & 46.1' W. OF THE NW COR.,
 NW1/4, SEC. 2, TWP. 27-S, R-1-W.
 ELEV. = 1330.50 NAVD88

CITY OF WICHITA BENCHMARK DISK
 0.9' E. & 29' N. OF THE NE COR.,
 NW1/4, SEC. 2, TWP. 27-S, R-1-W.
 ELEV. = 1325.19 NAVD88

SANDCREST ADDITION

Existing Pond

Sta. 0+00, Line 4
 Begin Construction of 30"
 RCP w/ End Section and
 33 S.Y. of Light Stone
 Rip-Rap as Indicated.
 Contractor to restrain End
 Section to last section of
 pipe per City of Wichita Specs.

Sta. 1+61.7, Line 4 =
 Sta. 0+00, Begin Line 4A
 Const. Std Type-1A
 Curb Inlet (5' x 4')
 w/ 48 FTB Snout
 Top Elev. = 1323.46
 Match Point

Sta. 0+00, Line 4A to
 Sta. 0+50.7, Line 4A
 Install 50.7 L.F. Sand Backfill
 Jetted and Vibrated

Sta. 0+50.7, End Line 4A
 Const. Std Type-1A
 Curb Inlet (5' x 3')
 1-24" Stub (W)
 Top Elev. = 1322.89

CAUTION!
 10" San. Sewer
 Crossing

CAUTION!
 8" Water Line
 Crossing

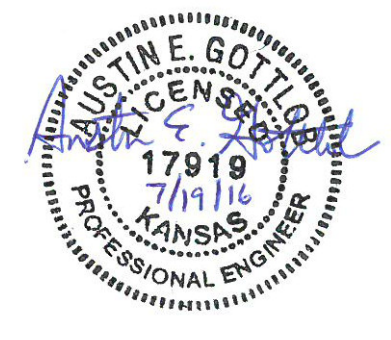
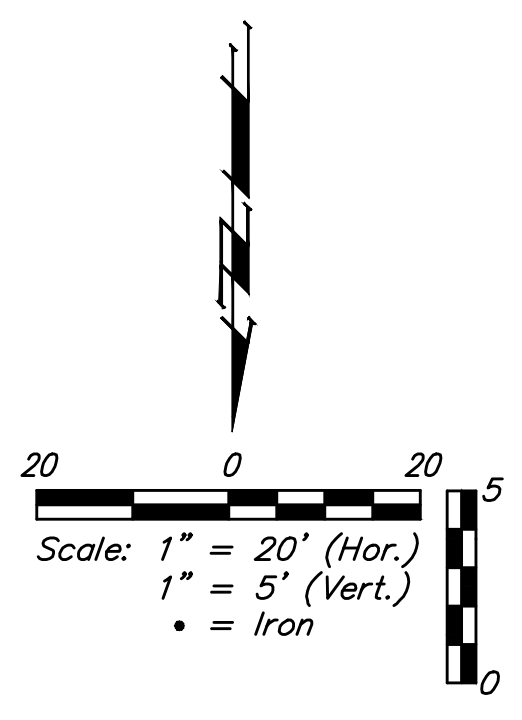
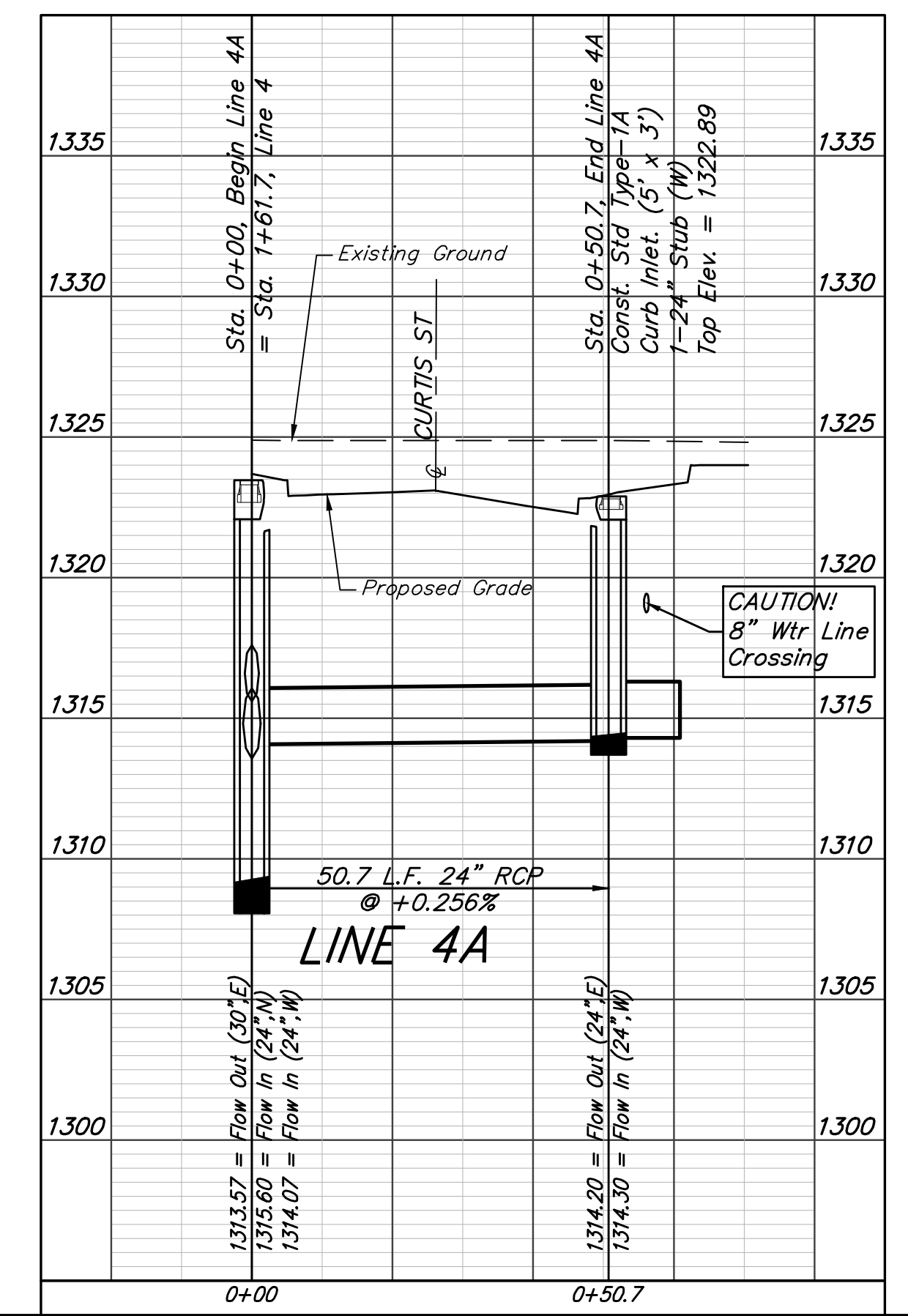
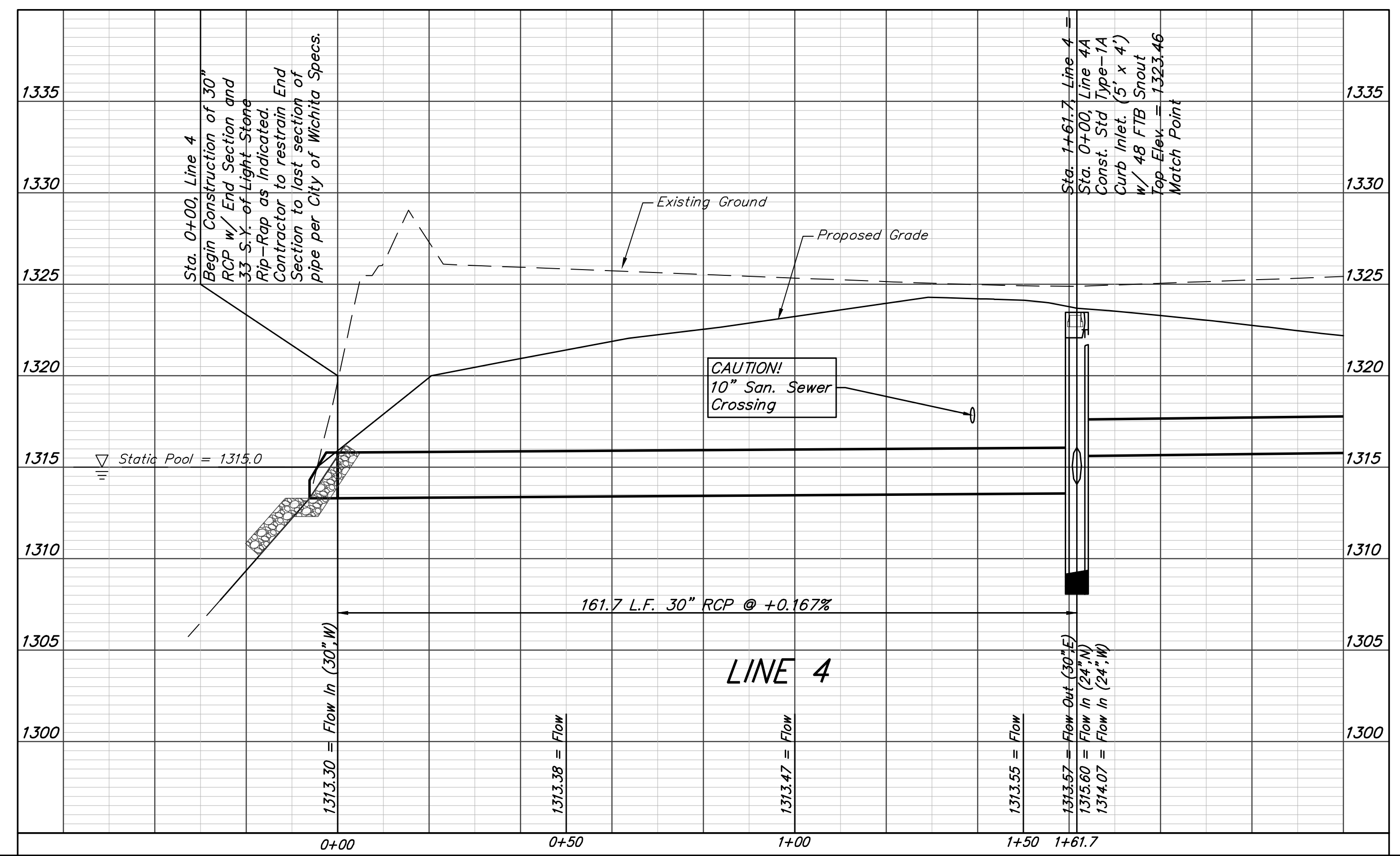
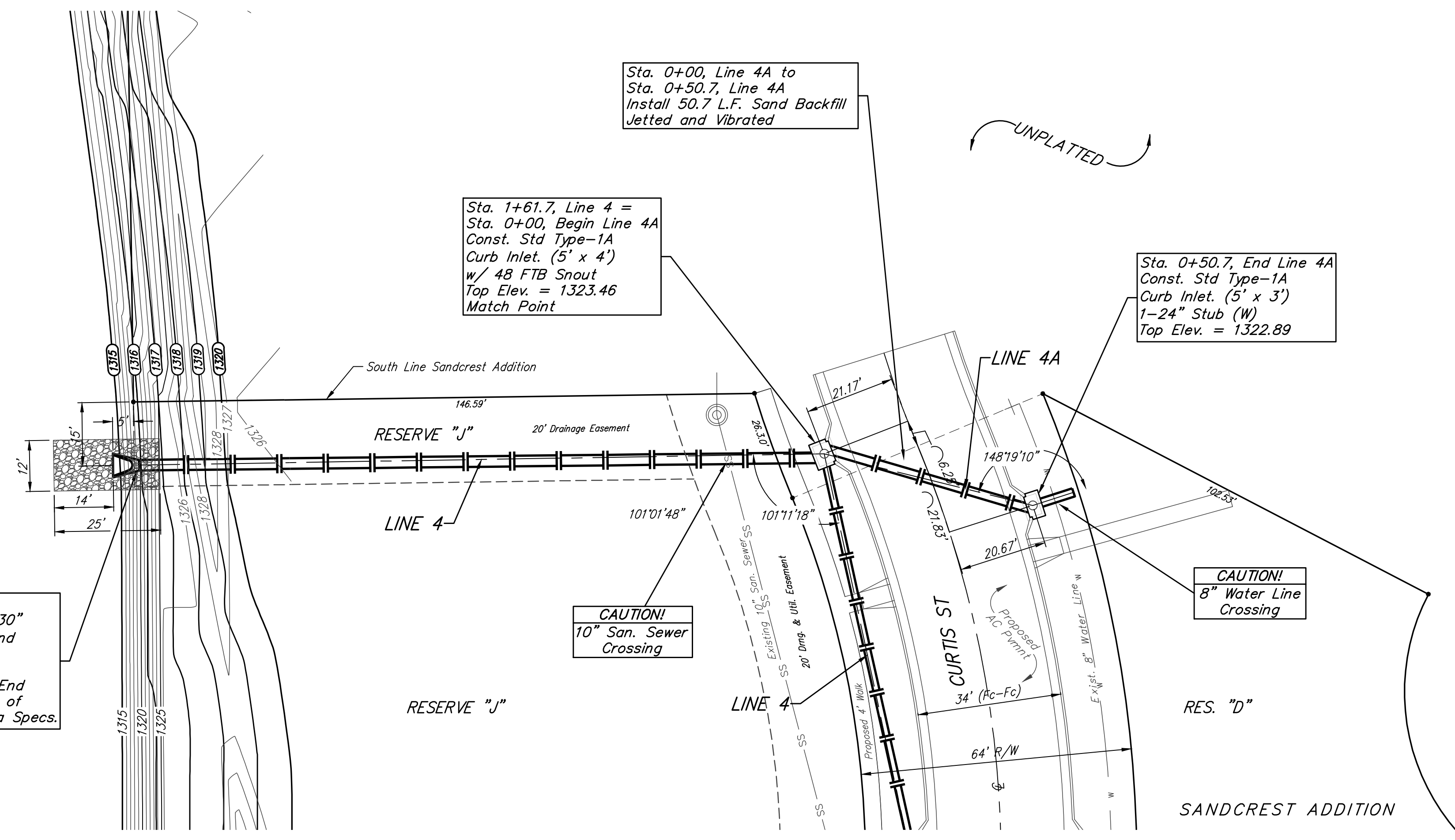

Baughman Sandcrest Addition - Phase I
LINE 4 & LINE 4A
 Storm Water Sewer Improvements

PROJECT NUMBER: 472-85252
 DESIGN: AEG
 DRAWN: JAK
 APPROVED: [Signature]
 DATE: 7/19/16
 SCALE: Noted
 SHEET: 32 OF 66