

FHWA REG. NO.	STATE	PROJECT NO.	YEAR	SHEET NO.	TOTAL SHEETS
7	KANSAS	87 N-0198-01	2001	66	82

FED. AID NO. - CMQ-N019(801)

SEE TE700SI & SHEET NO. 66 FOR TRAFFIC CONTROL

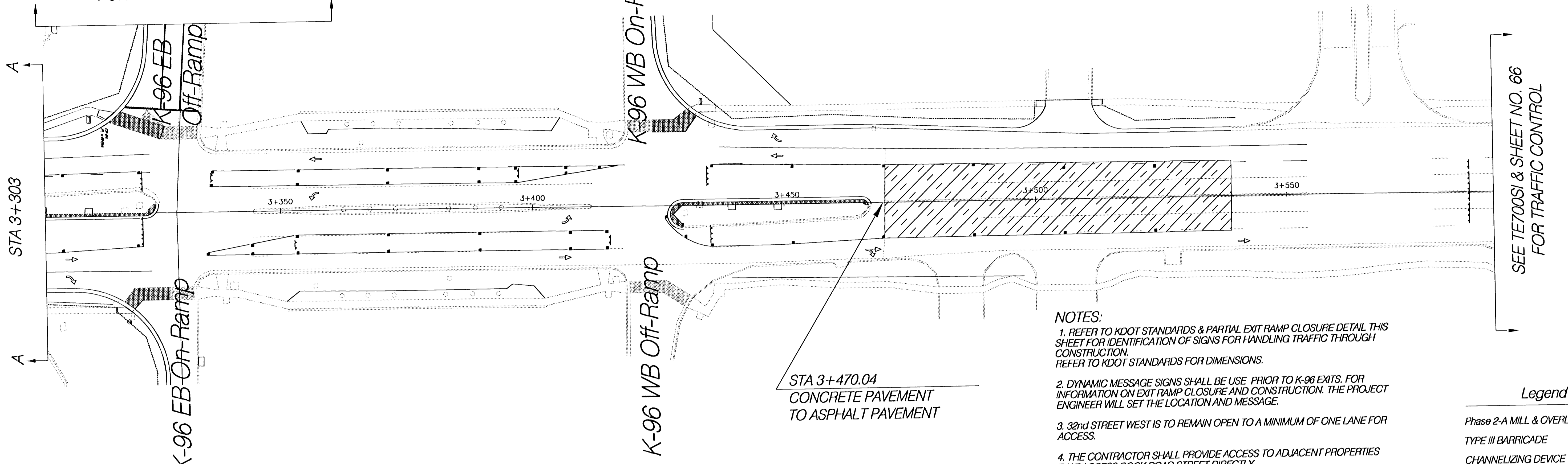

SEE TE700SI & SHEET NO. 66 FOR TRAFFIC CONTROL

- NOTES:**
- REFER TO KDOT STANDARDS & PARTIAL EXIT RAMP CLOSURE DETAIL THIS SHEET FOR IDENTIFICATION OF SIGNS FOR HANDLING TRAFFIC THROUGH CONSTRUCTION. REFER TO KDOT STANDARDS FOR DIMENSIONS.
 - DYNAMIC MESSAGE SIGNS SHALL BE USE PRIOR TO K-96 EXITS. FOR INFORMATION ON EXIT RAMP CLOSURE AND CONSTRUCTION. THE PROJECT ENGINEER WILL SET THE LOCATION AND MESSAGE.
 - 32nd STREET WEST IS TO REMAIN OPEN TO A MINIMUM OF ONE LANE FOR ACCESS.
 - THE CONTRACTOR SHALL PROVIDE ACCESS TO ADJACENT PROPERTIES THAT ACCESS ROCK ROAD STREET DIRECTLY.
 - TEMPORARY PAVEMENT MARKINGS AND USE OF A FLAGGER SHALL BE COORDINATED WITH THE PROJECT ENGINEER DURING PHASE 2-A AND 2-B.

Legend

Phase 2-A MILL & OVERLAY AREAS	
TYPE III BARRICADE	
CHANNELIZING DEVICE (DRUM)	
TRAFFIC FLOW ARROWS (NOT PAVEMENT MARKING)	

STA 3+470.04
CONCRETE PAVEMENT
TO ASPHALT PAVEMENT

STA 3+281.35
ASPHALT PAVEMENT TO
CONCRETE PAVEMENT

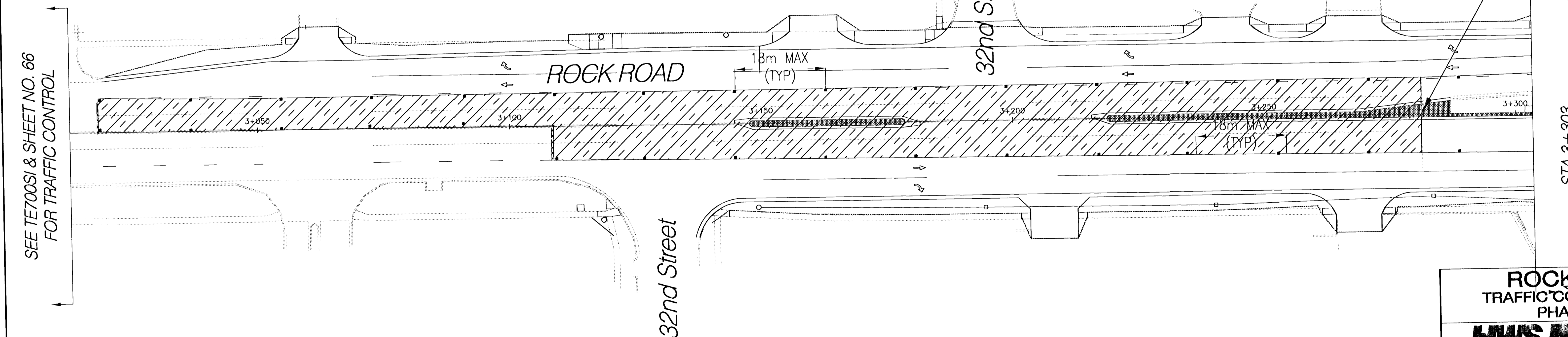

SEE TE700SI & SHEET NO. 66 FOR TRAFFIC CONTROL

ROCK ROAD TRAFFIC CONTROL PLAN PHASE 2-A

HWS Consulting Group, Inc. Manhattan Office 3206 Kimball Avenue Manhattan, KS 66503 Phone: (785) 539-2202 Fax: (785) 539-2393

Designed By: JH	Checked By: JDM
Drawn By: BJD	Date: 11/14/01 Job No. 55-70-2003