

STATE	PROJECT NO.	YEAR	SHEET NO.	TOTAL SHEETS
KANSAS	87 N-0304-01	2004	1	50

BHO-N030(401)

BRIDGE
CONCRETE PAVEMENT
LIGHTING
SODDING

INDEX OF SHEETS

- 1 Title Sheet
- 2 Construction Layout
- 3 Construction Couseway
- 4 Sidewalk West
- 5 Sidewalk East
- 6 Approach Slab
- 7 Miscellaneous Pavement Details
- 8 General Notes
- 9 Summary of Quantities
- 10 Beam Removal Details
- 11 Abutment Removal Details
- 12 Pier Removal Details
- 13 Abutment No. 1 Details
- 14 Abutment No. 2 Details
- 15 Bridge Backwall Protection
- 16 Boat Storage Area Closure
- 17 Superstructure Detail at Pier and Midspan
- 18 Superstructure Layout
- 19 Precast Beam Layout
- 20 Span 1 and 5 K2 Details
- 21 Span 2 and 4 K2 Details
- 22 Span 3 K2 Details
- 23 Standard Prestressed Concrete Beam Details
- 24 Pavement Elevations
- 25 Diaphragm Details
- 26 Diaphragm Details(Temporary and Intermediate)
- 27 Expansion Joint Abutment Details
- 28 Expansion Joint Pier Details
- 29 Concrete Beam and Slab Repair
- 30 Concrete Repair Procedures
- 31 Rail Details
- 32 Electric Schedule
- 33 Electric Site Plan and Light Details
- 34 Reinforcing Details
- 35 Waterline Replacement
- 36 Retaining Wall Details
- 37 Bridge Excavation (BR100)
- 38 Supports and Spacers for Reinforcing Steel (BR120)
- 39-42 Cross Sections
- 43 Seeding and Sodding LA850)
- 44 Pavement Marking Plan
- 45 Traffic Handling and Summary of Traffic Control Devices
- 46 Traffic Control General Notes
- 47 Traffic Control Plan
- 48 Detour Plan
- 49 Channelizing Devices
- 50 Typical Traffic Control Road Closures

STATE OF KANSAS

DEPARTMENT OF TRANSPORTATION

PLAN AND PROFILE OF PROPOSED MURDOCK BRIDGE - BETWEEN WACO AND CENTRAL RIVERSIDE PARK OVER THE LITTLE ARKANSAS RIVER

FEDERAL AID PROJECT

CITY OF WICHITA
SEDGWICK COUNTY

POPULATION 344,631

CITY OF WICHITA PROJECT NO. 472-83895 AND 448-89900

OCA NO.: 715698

QCA NO. 638128

GENERAL NOTES

UNDERGROUND UTILITY SERVICE LINES AND OVERHEAD UTILITY POLE LINES ARE TO BE ADJUSTED AS NECESSARY BY OTHERS PRIOR TO CONSTRUCTION UNLESS THE PLANS SPECIFICALLY CALL FOR THEIR ADJUSTMENT BY THE CONTRACTOR. EXISTING UTILITIES AND THEIR LOCATION, AS SHOWN ON THE PLANS, REPRESENT THE BEST INFORMATION OBTAINABLE FOR DESIGN. LOCATION INFORMATION HAS BEEN OBTAINED FROM THE VARIOUS UTILITY COMPANIES AND IS EITHER FROM COMPANY RECORD DRAWINGS OR COMPANY PROVIDED FIELD LOCATIONS. THE CONTRACTOR WILL BE REQUIRED TO WORK AROUND EXISTING UTILITIES WITHIN THE RIGHT-OF-WAY WHICH DO NOT CONFLICT WITH PROPOSED CONSTRUCTION.

TREES AND SHRUBS IN PUBLIC RIGHT-OF-WAY WHICH ARE IN DIRECT CONFLICT WITH PROPOSED NEW CONSTRUCTION SHALL BE REMOVED BY THE CONTRACTOR WITH THE ENGINEER'S APPROVAL. TREES AND SHRUBS WHICH ARE NOT IN DIRECT CONFLICT WITH PROPOSED NEW CONSTRUCTION SHALL BE SAVED AND PROTECTED FROM DAMAGE.

RUBBLE FROM THE REMOVAL OF MISCELLANEOUS STRUCTURES SHALL BE DISPOSED OF ON SITES TO BE PROVIDED BY THE CONTRACTOR AND APPROVED AS NOTED BELOW.

ALL DISPOSAL SITES MUST BE APPROVED BY THE KANSAS DEPARTMENT OF HEALTH AND ENVIRONMENT. MATERIAL EITHER STOCKPILED OR DISPOSED OF IN A FLOOD PLAIN WOULD REQUIRE A KANSAS STATE BOARD OF AGRICULTURE PERMIT. ANY MATERIAL DUMPED IN WATERS OF THE UNITED STATES OR WETLANDS IS SUBJECT TO U.S. CORPS OF ENGINEERS PERMITTING REGULATIONS. ANY MATERIAL BURIED OR STOCKPILED BEYOND APPROVED CONSTRUCTION LIMITS WOULD REQUIRE ADDITIONAL ARCHEOLOGICAL INVESTIGATIONS UNLESS BURIED IN A PREVIOUSLY APPROVED BORROW LOCATION.

CONTRACTOR SHALL SATISFY HIMSELF OF SUBSURFACE CONDITIONS PRIOR TO BIDDING.

TEMPORARY SURFACING MATERIAL (ROCK, ASPHALT, ETC.) MAY HAVE BEEN PLACED WITHIN STREET RIGHTS-OF-WAY FOR HAUL ROADS AND TEMPORARY ACCESS. CONTRACTOR SHALL FIELD VERIFY EXISTING CONDITIONS TO DETERMINE EXTENT, IF ANY, OF SUCH SURFACING. CONTRACTOR SHALL REMOVE SAID TEMPORARY SURFACING IN THE SAME MANNER AS NOTED ABOVE FOR RUBBLE. THIS REMOVAL SHALL BE SUBSIDIARY TO "REMOVAL OF EXISTING STRUCTURE".

CONTRACTOR SHALL PROVIDE A MINIMUM FORTY-EIGHT (48) HOUR ADVANCE NOTICE (EXCLUDING WEEKENDS AND HOLIDAYS) PRIOR TO BEGINNING ANY EXCAVATION, TO KANSAS ONE-CALL SYSTEM, A UTILITY LOCATION SERVICE, AT (316) 687-2470 TO REQUEST THE FOLLOWING UTILITY COMPANIES TO LOCATE ALL EXISTING LINES WITHIN THE PROJECT AREA: KANSAS GAS SERVICE, AQUILA, WESTAR ENERGY, SBC, COX COMMUNICATIONS, CITY OF WICHITA WATER DEPARTMENT.

THE CONTRACTOR SHALL BE RESPONSIBLE FOR PRESERVING PROPERTY IRONS. THE CONTRACTOR WILL BE REQUIRED TO RE-ESTABLISH ANY PROPERTY IRONS WHICH ARE DAMAGED OR DESTROYED BY HIS CONSTRUCTION OPERATIONS. SUCH IRONS SHALL BE RE-ESTABLISHED BY A LICENSED LAND SURVEYOR IN ACCORDANCE WITH STATE LAWS.

THE WATER DEPARTMENT SHALL FIELD LOCATE WATER VALVES ONE TIME DURING CONSTRUCTION WHEN REQUESTED BY THE CONTRACTOR. IT SHALL BE THE CONTRACTOR'S RESPONSIBILITY TO PRESERVE SUCH FIELD LOCATIONS DURING THE CONSTRUCTION PROCESS. WATER VALVES, WATER VALVE BOXES OR FIRE HYDRANTS DAMAGED DURING CONSTRUCTION SHALL BE REPAIRED BY THE CONTRACTOR AT HIS OWN EXPENSE.

THE CONTRACTOR SHALL ADJUST WATER VALVE BOXES AS DIRECTED BY THE ENGINEER. THIS WORK TO BE SUBSIDIARY TO OTHER BID ITEMS.

Note:

Murdock shall be closed locally during construction.

PLANS PREPARED BY

Professional Engineering Consultants, P.A.
303 S. TOPEKA • WICHITA, KANSAS 67202
316-262-2691 • FAX 316-262-3003

APPROVED - DATE 3-30-04

James L. Amour
ACTING CITY ENGINEER
CITY OF WICHITA, SEDGWICK COUNTY, KANSAS
CITY NO. 472-83895 & 448-89900

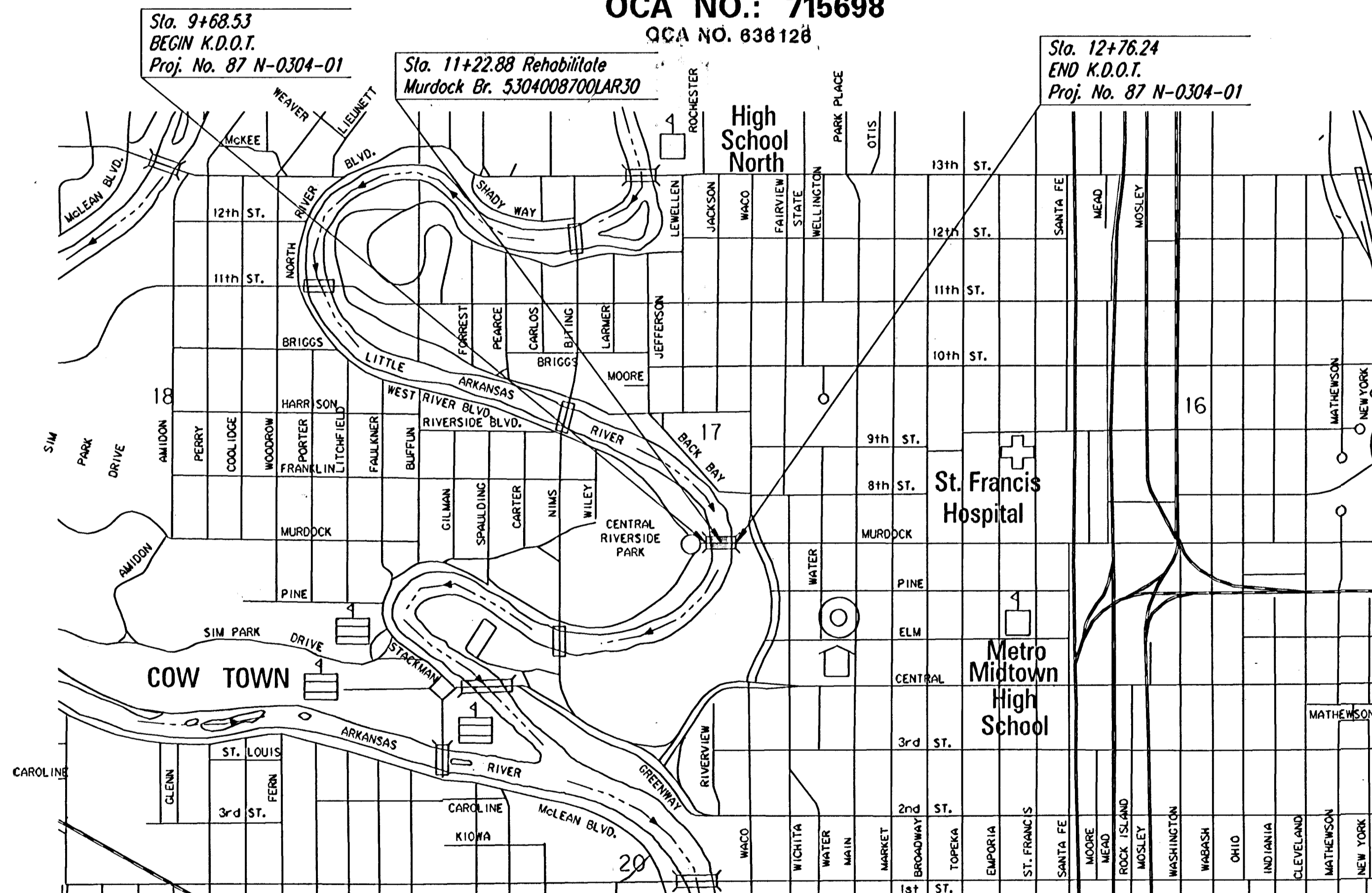
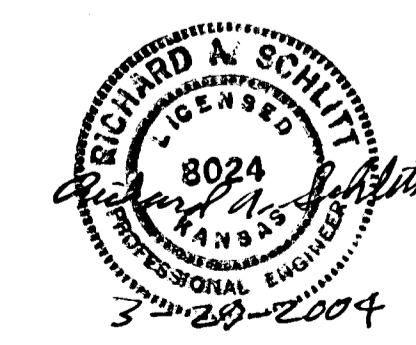

Scale: 1" = 1000'

DESIGN DESIGNATION

AADT (2003) 5,900
AADT (2023) 11,000
T 5%
V 20 MPH
C of A None
Clear Zone 14 feet

CONVENTIONAL SIGNS

COUNTY LINE	CENTER LINE OF PROJECT	
CITY LIMITS	TERRACE	
STATE OR NATIONAL LINE	CULVERTS	
TOWNSHIP, SECTION or GRANT LINE	DROP INLET & STORM SEWER	
PROPERTY LINE	ACCESS CONTROL	
HIGHWAY FENCE	POWER POLE	
EXISTING FENCE	TELEPHONE POLE	
GUARD FENCE	MARSH	
CONSTRUCTION LIMITS	HEDGE	
RIGHT OF WAY LINE	TREES	
TRAVELED WAY	PROFILE ELEVATION	
RAILROADS	STREAM or CREEK	

GROSS LENGTH OF PROJECT 307.71 FT.

EXCEPTIONS

ADDITIONS

NET LENGTH OF PROJECT 307.71 FT. 0.058 MILES

NET LENGTH OF BRIDGES 247.71 FT. 0.047 MILES

NET LENGTH OF ROAD 60.00 FT. 0.011 MILES

4/19/06 13:59:40/002 of feedback generated
 drawn by: ras
 plotted by: ras 3-27-2004