

FHWA REGION NO.	STATE	PROJECT NO.	YEAR	SHEET NO.	TOTAL SHEETS
7	KANSAS	87 N-0212-01	2002	46	59

- GENERAL NOTES:
- ALL REFLECTIVE DRUMS SHOWN SHALL BE SPACED AT 9.000 m SPACING.
 - ALL SIGNS WITHIN LIMITS OF CONSTRUCTION SHALL BE MOUNTED ON SKIDS PER TE752SI TO FACILITATE RELOCATION BETWEEN PHASES.
 - CONTRACTOR TO PROVIDE ACCESS TO ALL PROPERTIES ADJACENT TO THE WORK AREA DURING ALL PHASES OF CONSTRUCTION. ANY DRIVE UNDER CONSTRUCTION SHALL BE PROTECTED WITH TYPE I OR TYPE II BARRICADES.
 - CONTRACTOR RESPONSIBLE FOR REMOVING ALL CONFLICTING EXISTING PAVEMENT MARKING.
 - ALL MARKINGS REMOVED BEYOND PROJECT LIMITS TO BE REPLACED WITH PATTERNED COLD PLASTIC PAVEMENT MARKINGS.
 - CONTRACTOR IS RESPONSIBLE FOR REPOSITIONING TEMPORARY TRAFFIC SIGNAL NEEDS AS REQUIRED AFTER EACH PHASE OF CONSTRUCTION. THE REPOSITIONING WILL BE INCIDENTAL TO "TRAFFIC SIGNALIZATION (TEMPORARY)".

LIST OF TRAFFIC CONTROL DEVICES				
MARK	ITEM	MUTDC DEVICE NO.	SIZE (mm)	REMARKS
(AA)	TYPE III BARRICADE	B III	3 m	RELOCATE AFTER EACH PHASE
(BB)	NO LEFT TURN	R 3-2	600 x 600	RELOCATE AFTER EACH PHASE
(F(L))	WARNING SIGN	W 20-5(L)	1200 x 1200	RELOCATE AFTER EACH PHASE
(CC)	WARNING SIGN	W 4-2(L)	1200 x 1200	RELOCATE AFTER EACH PHASE
(F(R))	WARNING SIGN	W 20-5(R)	1200 x 1200	RELOCATE AFTER EACH PHASE
(DD)	WARNING SIGN	W 4-2(R)	1200 x 1200	RELOCATE AFTER EACH PHASE
(A)	ROAD WORK AHEAD	W 20-1	1200 x 1200	TO REMAIN DURING CONSTRUCTION
(S)	END ROAD WORK	G 20-2A	1200 x 600	TO REMAIN DURING CONSTRUCTION
(EE)	NO TURNS	R 3-3	600 x 600	RELOCATE AFTER EACH PHASE
(FF)	STOP HERE ON RED	R 10-8	600 x 900	RELOCATE AFTER EACH PHASE
(GG)	TWO-WAY TRAFFIC	W 6-3	1200 x 1200	RELOCATE AFTER EACH PHASE

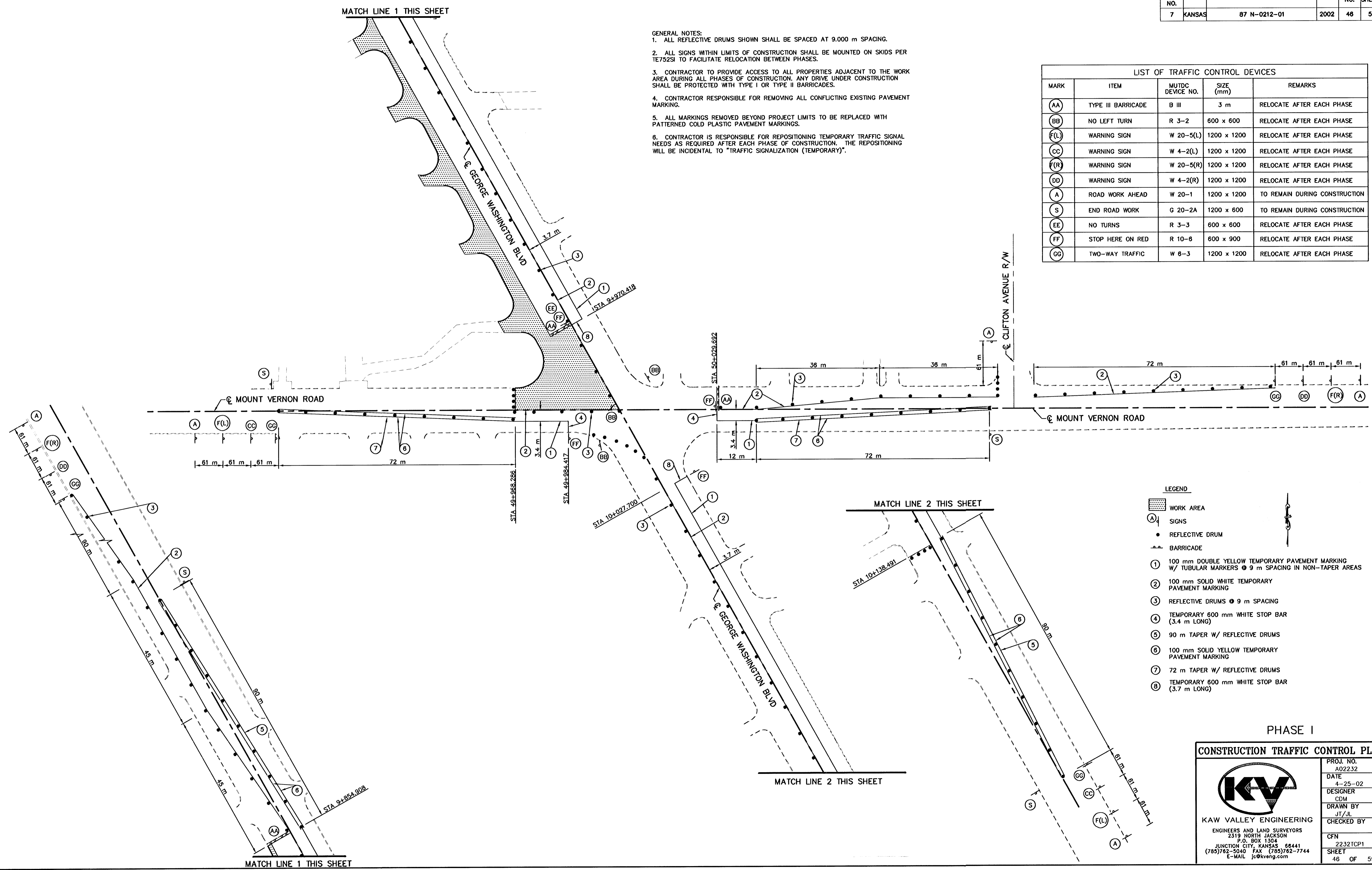

- LEGEND
- WORK AREA
 - SIGNS
 - REFLECTIVE DRUM
 - BARRICADE
 - 100 mm DOUBLE YELLOW TEMPORARY PAVEMENT MARKING W/ TUBULAR MARKERS @ 9 m SPACING IN NON-TAPER AREAS
 - 100 mm SOLID WHITE TEMPORARY PAVEMENT MARKING
 - REFLECTIVE DRUMS @ 9 m SPACING
 - TEMPORARY 600 mm WHITE STOP BAR (3.4 m LONG)
 - 90 m TAPER W/ REFLECTIVE DRUMS
 - 100 mm SOLID YELLOW TEMPORARY PAVEMENT MARKING
 - 72 m TAPER W/ REFLECTIVE DRUMS
 - TEMPORARY 600 mm WHITE STOP BAR (3.7 m LONG)

PHASE I

 KAW VALLEY ENGINEERING ENGINEERS AND LAND SURVEYORS 2319 NORTH JACKSON P.O. BOX 1304 JUNCTION CITY, KANSAS 66441 (785)762-5040 FAX (785)762-7744 E-MAIL jc@kveng.com	PROJ. NO. A02232
	DATE 4-25-02
	DESIGNER CDM
	DRAWN BY JT/JL
	CHECKED BY CFN
	SHEET 46 OF 59

Plotted By : J. TRUMPP
 Plot File : 2232TCP1
 Plot Date : 4-25-02
 Server :
 View =