

**BENCHMARKS:**  
**BM #1:** "□" Cut with Cross in Curb Return at Southeast Corner of Intersection of 37th St. N. and Tyler, Approximately 47' South and 49.5' East of the Center of Intersection  
 Elev. = 1343.53 NAVD88

**BM #2:** "□" Cut with Cross in South Line of 37th St. N. Approximately 41.5' South and 1,026' East of the Center of the Intersection of 37th St. N. and Tyler.  
 Elev. = 1337.39 NAVD88

**COMPACTION TESTING TABLE**

Pad	Block	Location		Pad Elev.	Compaction % and Test Elevation	
		Northing	Easting		1343	1344
1	A	29989.049	40105.725	1344.60	X	
2	A	29923.757	40090.300	1344.60	X	
3	A	29860.315	40105.861	1344.60	X	
4	A	29861.644	40256.563	1344.50	X	
5	A	29925.351	40271.002	1344.40	X	
6	A	29990.370	40255.427	1344.40		

⊗ Compaction Testing Location

X- Compaction Test not Required at this elevation.

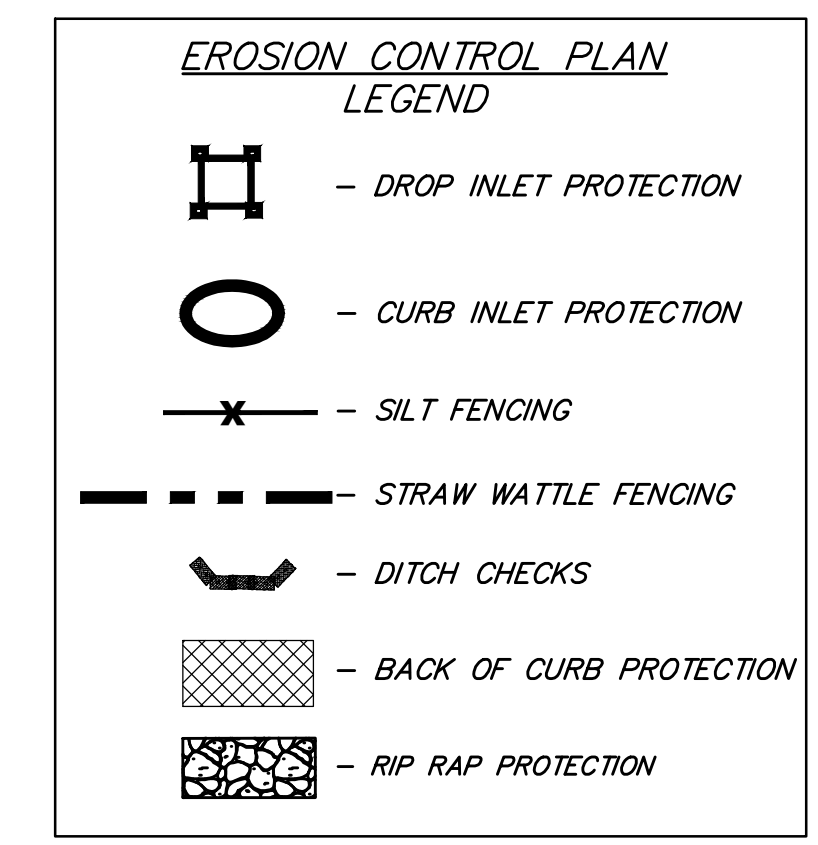
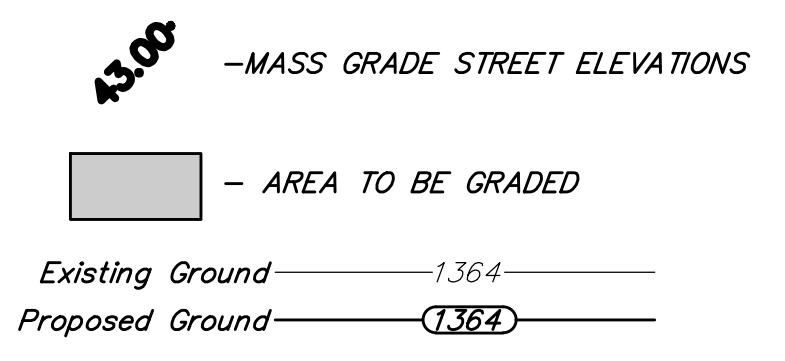
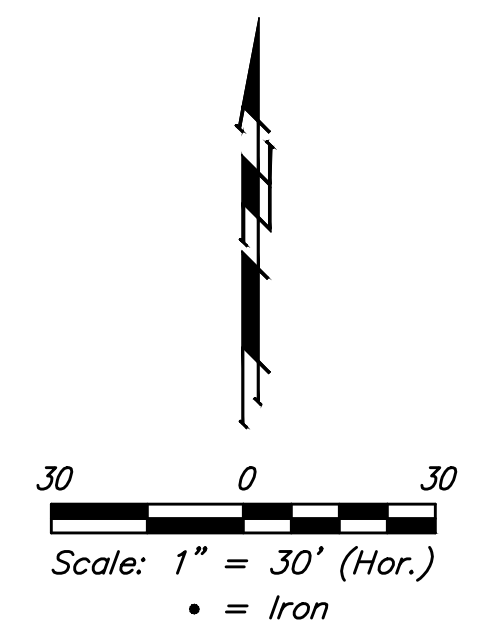

**NOTES:**  
 Contractor shall make sure all erosion control is in place before project is accepted. This plan represents the minimum standard. Any additional erosion control measures shall be installed by the Contractor as needed.

All areas disturbed during construction shall be seeded, mulched, and fertilized as per Cover Sheet General Notes.

EROSION CONTROL MEASURE	INSTALL	MAINTAIN
CUT-OFF TRENCH (LF)	0	0
CONSTRUCTION ENTRANCE (EA)	0	1
CURB INLET BARRIER (EA)	0	0
DITCH CHECK (EA)	0	0
DROP INLET PROTECTION (EA)	2	0
EROSION CONTROL (LS)	0	0
MULCH WATTLES (LF)	0	0
SILT FENCE (LF)	140	448
EROSION CONTROL MAT (SY)	0	0
MAINTAIN EROSION CONTROL BMP's (LS)	0	0

\* ALL EXISTING BMP'S INCLUDING CONSTRUCTION ENTRANCE, SEDIMENT BARRIERS, SILT FENCE, CUT-OFF TRENCH, AND EROSION CONTROL MAT SHALL BE MAINTAINED AND REPAIRED IF NECESSARY.

**Baughman** Tyler's Landing 6th Addition  
**EROSION CONTROL/ MASS GRADING**  
 Storm Water Sewer Improvements

Baughman Company, P.A. 315 Ellis St. Wichita, KS 67211 P 316-262-0149  
 ENGINEERING | SURVEYING | PLANNING | LANDSCAPE ARCHITECTURE

PROJECT NUMBER 468-85144	DESIGN AEG	DRAWN DIL
REVISIONS:	APPROVED DATE 8/16	SCALE Noted
		SHEET

**3 OF 12**

E:\Projects\Tyler's Landing 6th Addition\_16052000\Engineering\Phase 1\STR\SWS Plans.dwg

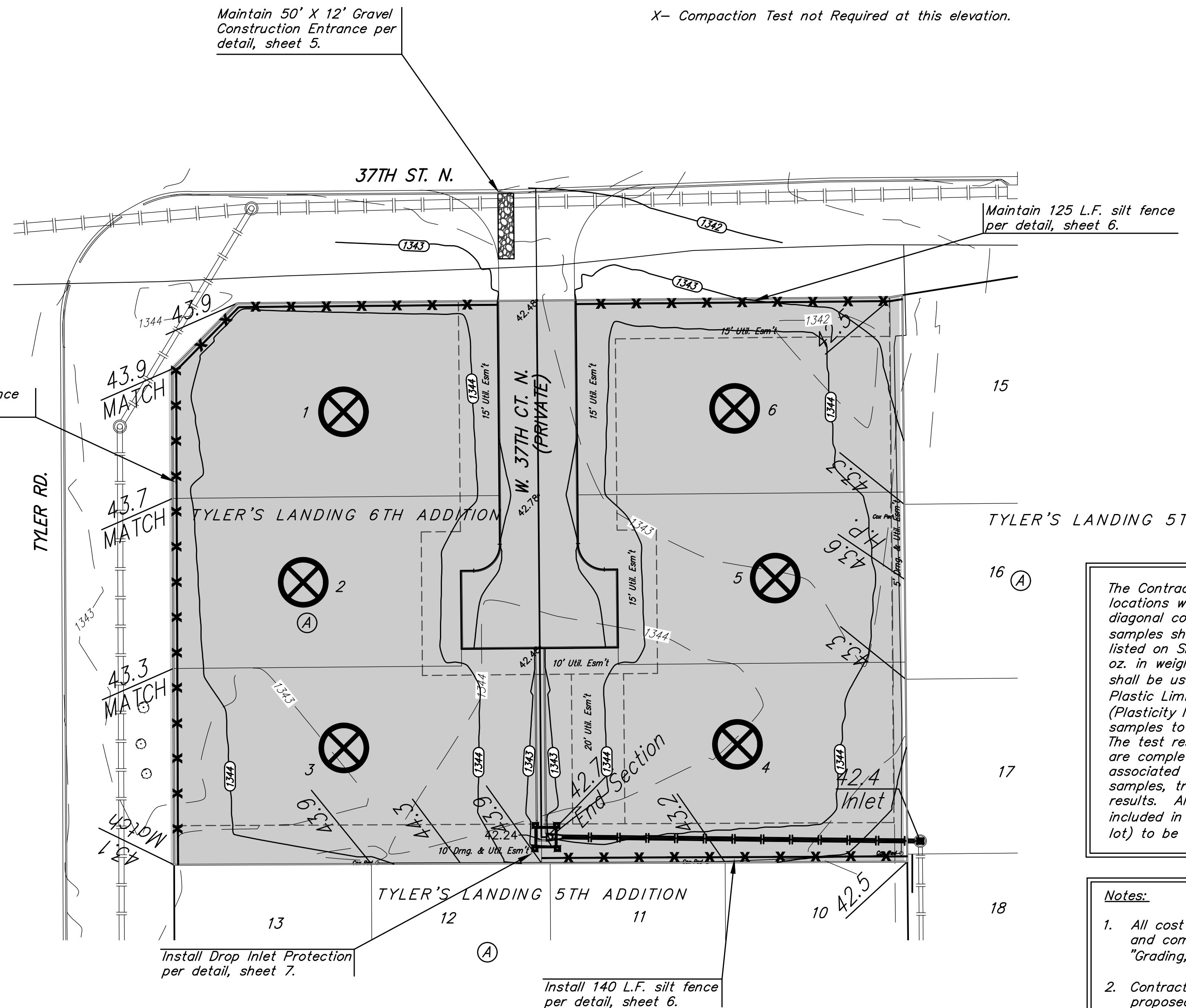

The Contractor shall be responsible to collect soil samples from two locations within each lot. The soil samples are to come from the diagonal corners of the building pads as shown on Sheet 7. The samples shall be collected at a depth of 18" below the pad elevation listed on Sheet 7. Each soil sample shall be approximately 8 oz. to 12 oz. in weight and sealed in a zip-lock plastic bag. The soil samples shall be used for Atterberg Limits testing (ASTM D4318, "Liquid Limit, Plastic Limit, and Plasticity Index of Soils") to determine the PI (Plasticity Index) of the sample. The contractor shall deliver the soil samples to a licensed soils testing laboratory for Atterberg Limits testing. The test results shall be delivered to the Project Engineer as the tests are completed. The contractor shall be responsible for all costs associated with collecting the soil, refilling the test holes, labeling the soil samples, transporting the soil, costs of testing, and delivering the test results. All costs associated with the Atterberg Limits testing are to be included in the bid item, "Testing". There are 6 lots (1 building pad per lot) to be tested at two locations for a total of 12 tests

- Notes:**
- All cost associated with lot fill, street fill, mass grading, compaction, and compaction testing shall be incidental to lump sum bid item "Grading, Mass".
  - Contractor to strip top 4-6" of soil within street right-of-way and proposed compaction areas. Topsoil may be spread in areas not under proposed pavement and on lots above compaction testing elevation.
  - Compaction of 95% Std. Proctor Density shall be obtained in all street R/W's and within specified lots up to the plan elevations as shown. Compaction testing shall be performed at one location in each lot and for each foot of compacted fill placed up to the elevation listed on the table. All compaction test results shall be submitted to the design Engineer along with the completed compaction testing table shown on this sheet.
  - It shall be the Contractor's responsibility to protect existing utilities during mass grading. Any damage done to these systems by Contractor or subcontractor shall be repaired at no additional cost to the project.
  - All areas disturbed by construction shall be seeded as indicated in the cover sheet general notes.

