

PLAN
REINFORCED VALLEY GUTTER
SCALE: NONE

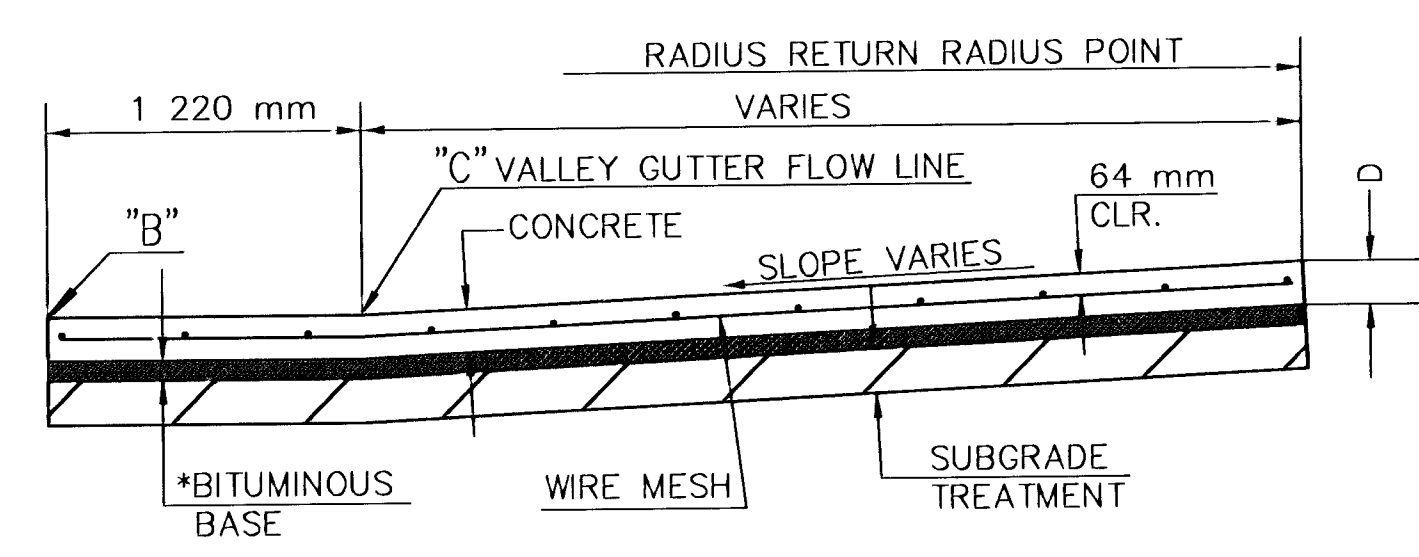

SECTION A-A
SCALE: NONE

*NOT TO BE USED WITH CRUSHED ROCK BASE

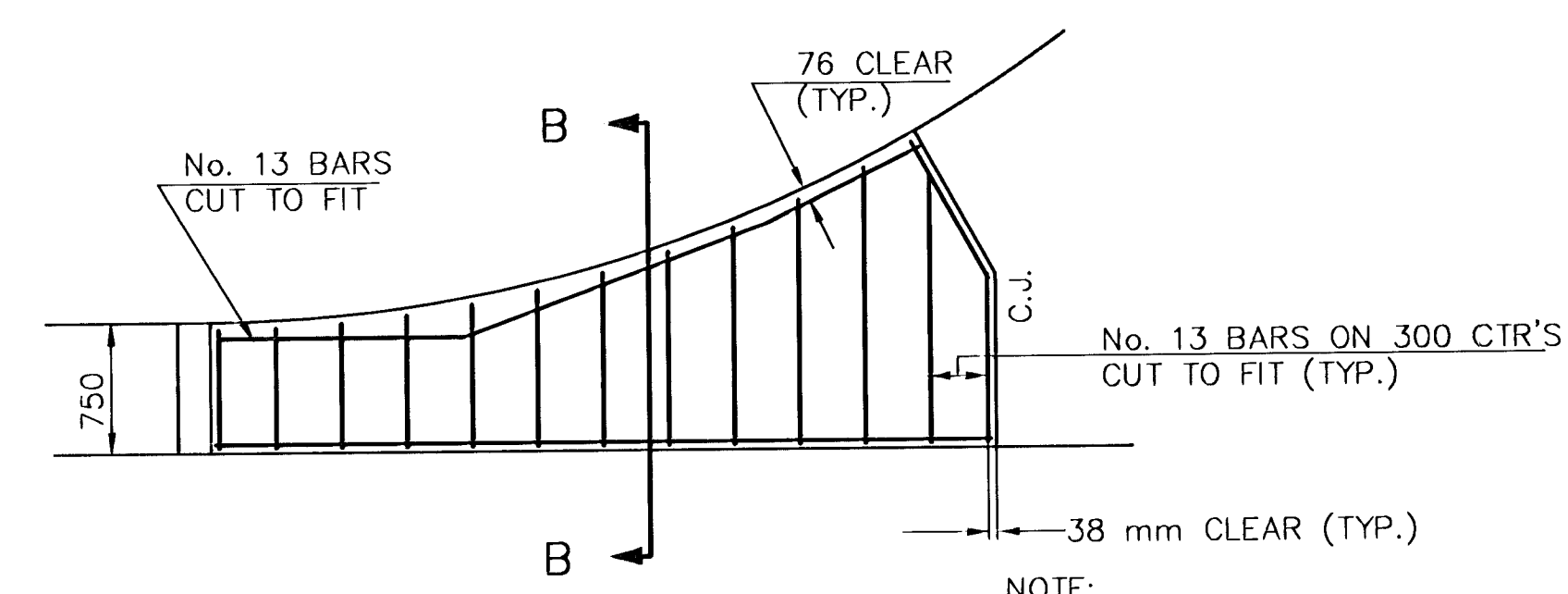

WING REINFORCING DETAIL
SCALE: NONE

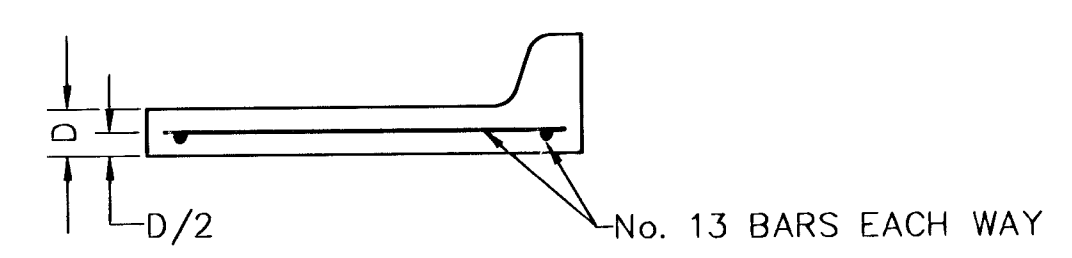

SECTION B-B
SCALE: NONE

150 mm x 300 mm MW25.8 x MW25.8 WIRE FABRIC REINFORCING SHALL BE PLACED SUCH THAT THE WIRES WITH THE 150 mm SPACING WILL RUN PARALLEL WITH THE LONGITUDINAL JOINT.

NOTE: ALL CONCRETE VALLEY GUTTER REINFORCEMENT SHALL BE ADEQUATELY SUPPORTED BY BAR CHAIRS IN THE REQUIRED POSITION UNLESS APPROVED OTHERWISE BY THE ENGINEER.
* NOT TO BE USED WITH CRUSHED ROCK BASE.

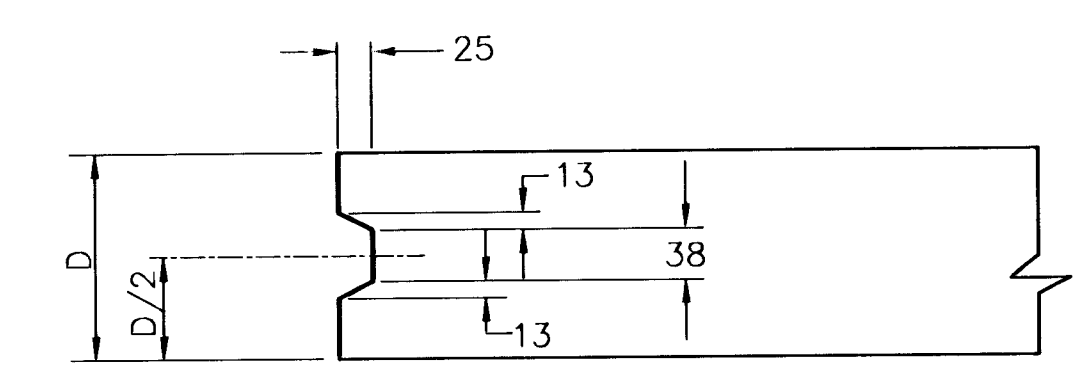

KEYWAY DETAIL
SCALE: NONE

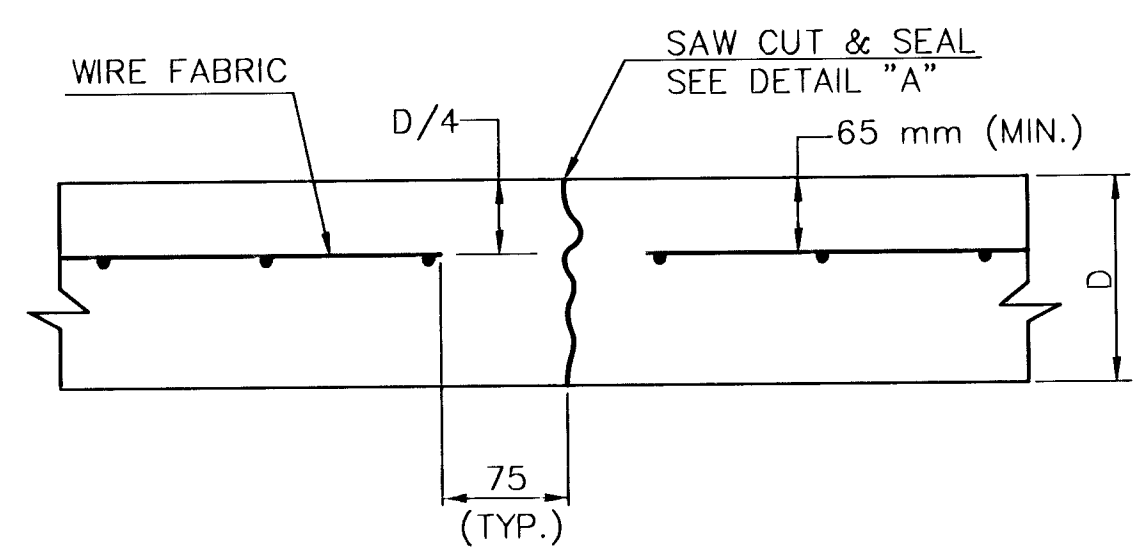

CONTRACTION JOINT DETAIL (C.J.)
SCALE: NONE

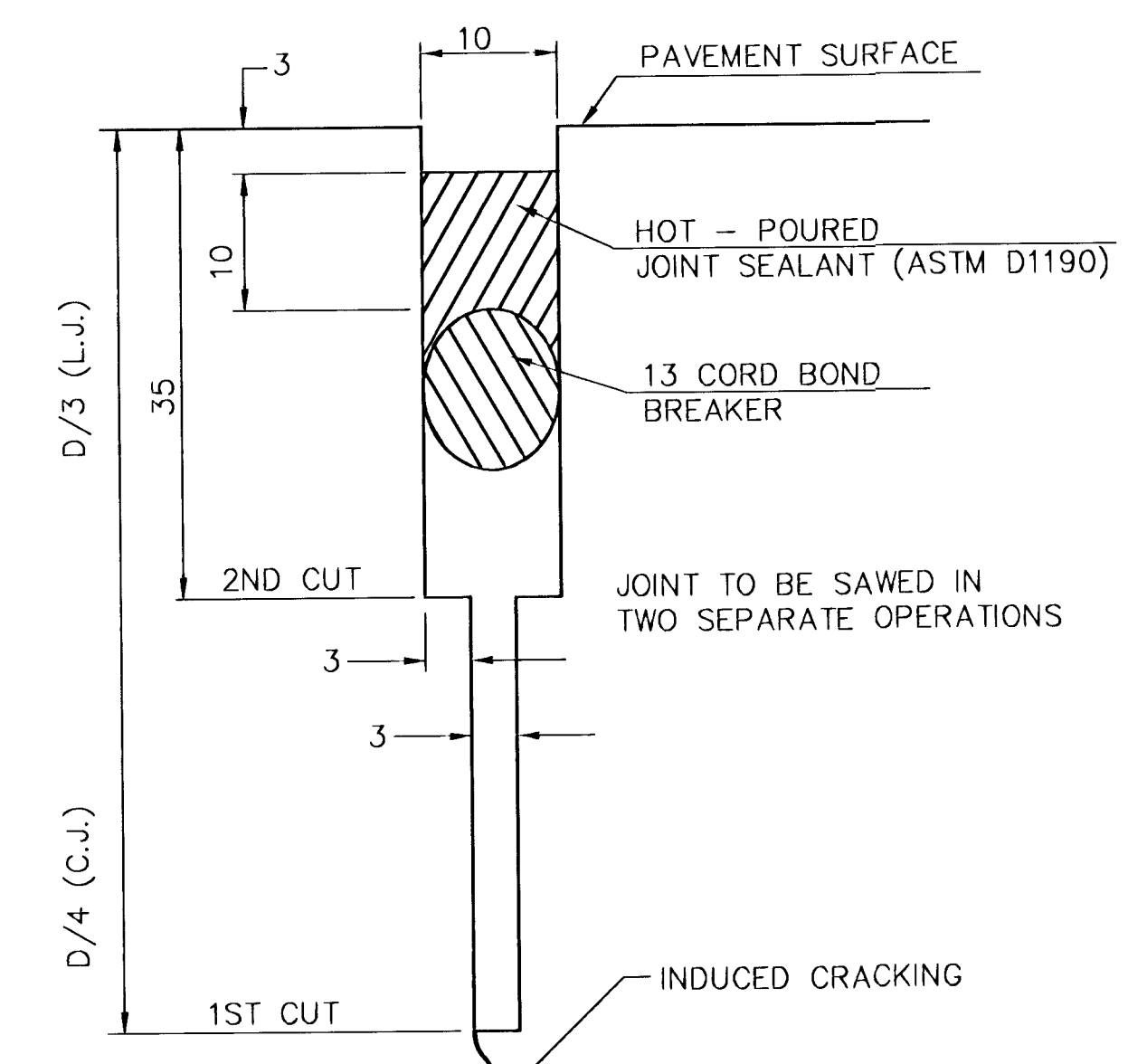

DETAIL "A"
SCALE: NONE

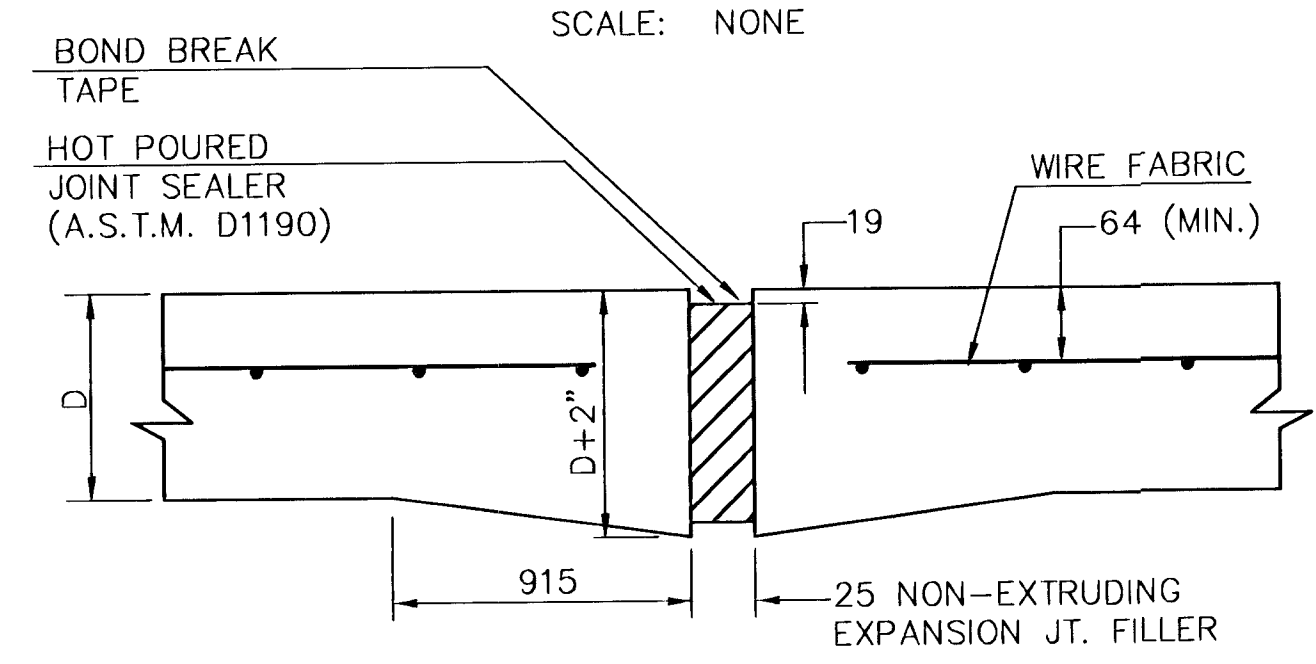

NOTE: EXTRA THICKNESS TO BE SUBSIDIARY TO PRICE OF PAVEMENT.

EXPANSION JOINT
SCALE: NONE

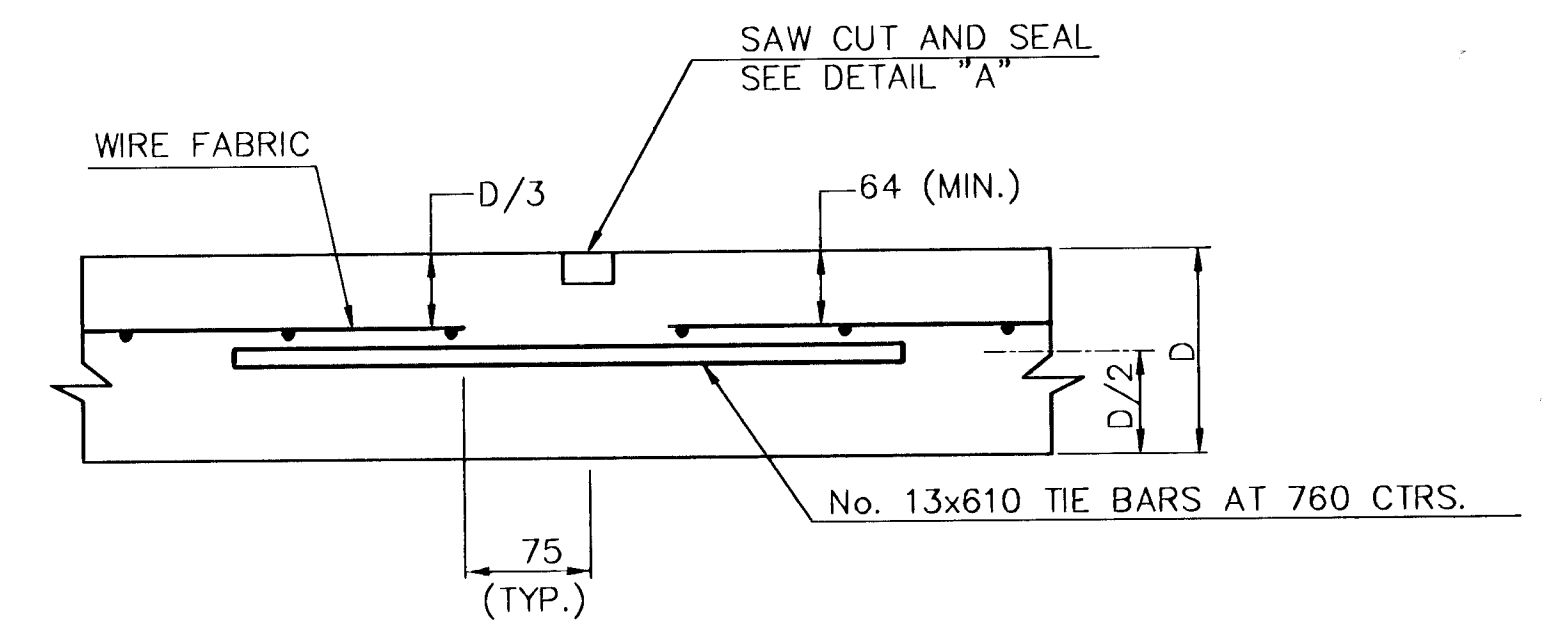

LONGITUDINAL JOINT DETAIL (L.J.)
SCALE: NONE

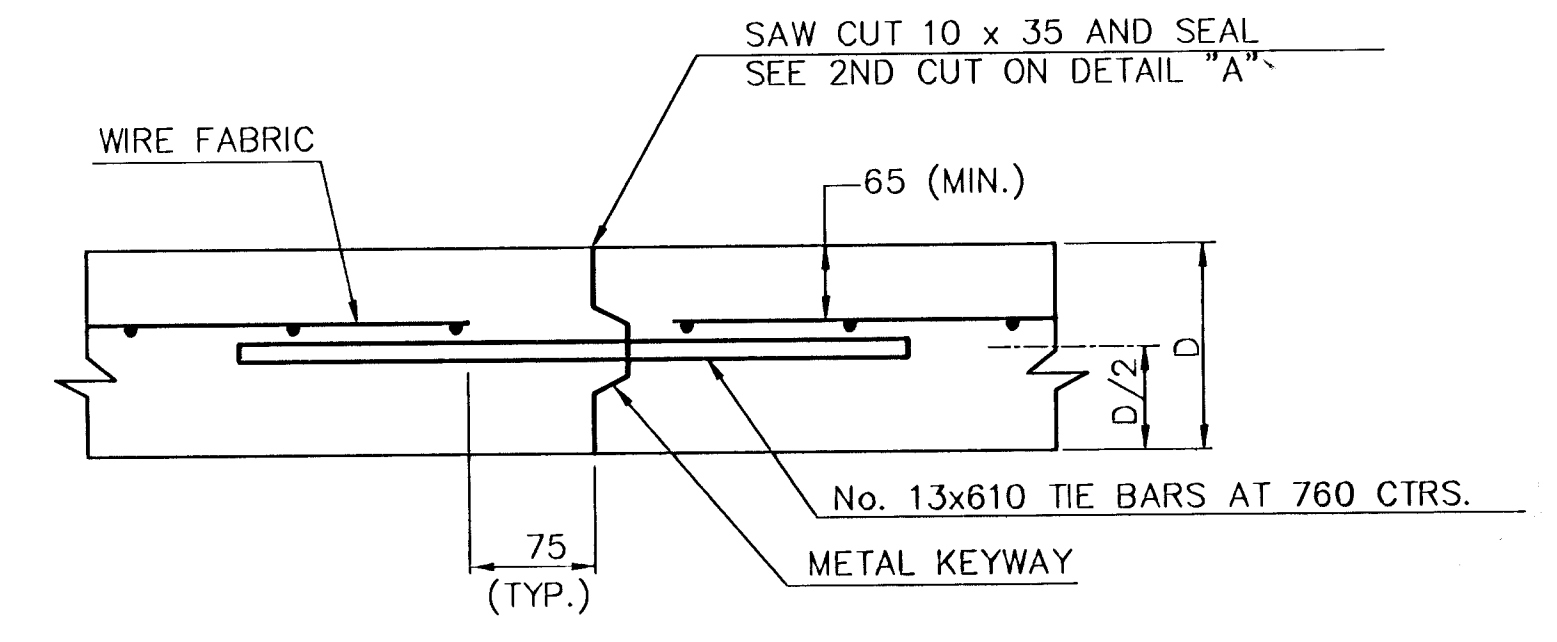

OPTIONAL LONGITUDINAL CONSTRUCTION JOINT (L.J.) (Alternate L.J.)
SCALE: NONE

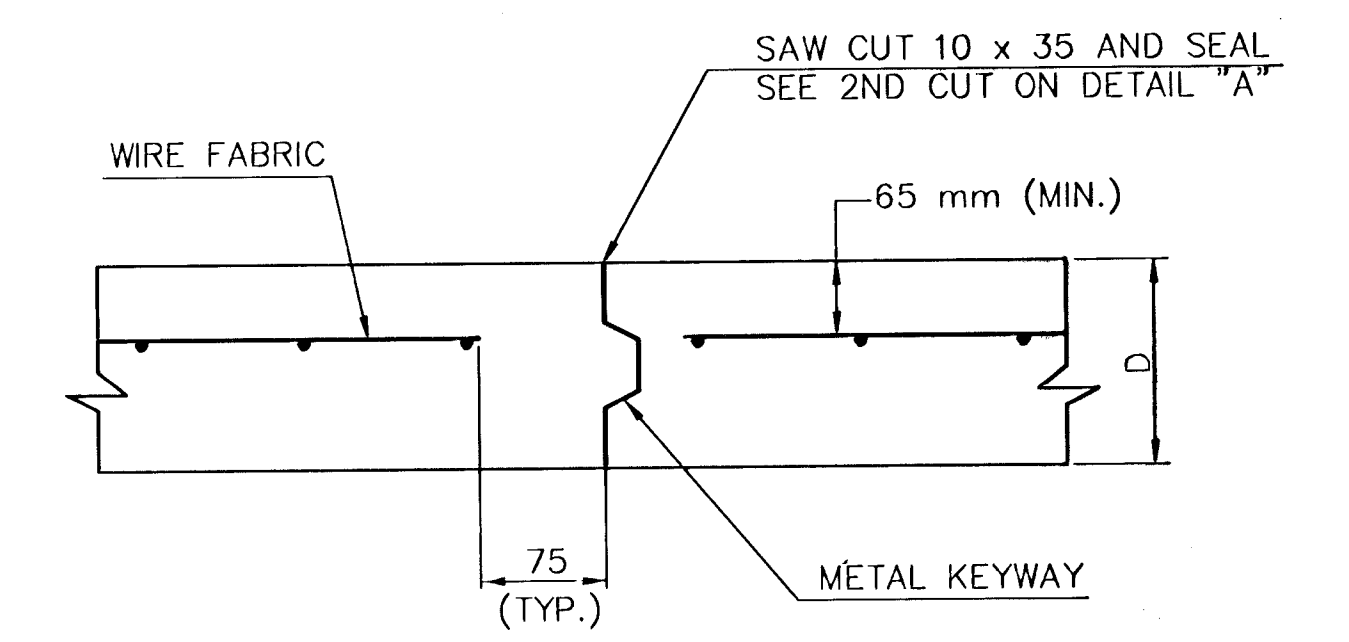

OPTIONAL CONTRACTION JOINT (C.J.) (Alternate C.J.)
SCALE: NONE

NOTE: Valley gutter concrete pavement shall be of 200 mm uniform thickness, with welded wire mesh. Approximate mass of welded wire mesh= 2.1 kg/m².
Where valley gutter, alley, and/or entrance pavement is the only pavement on the project, Class A Concrete (AE) may be used.

VALLEY GUTTER SUMMARY							
Street	Station	Side	Elev. @ Street	Elev. on Approach Str. Pt. "B"	Elev. on Approach Str. Pt. "C"	Appr. Str. Grade	m ² Conc. pavt. (200 mm Uniform)
21St. North	0+775.99	Lt.	60.848	60.581	60.546	0.8%	135.708
21St. North	0+999.89	Lt.	61.217	61.005	60.954	0.8%	135.000
21St. North	1+060.18	Lt.	62.351	62.139	62.088	0.8%	93.844
21St. North	1+186.21	Lt.	64.938	64.726	64.688	0.4%	78.925
21St. North	1+324.79	Rt.	66.496	66.226	66.189	0.8%	154.052
21St. North	1+327.98	Lt.	66.459	66.189	66.139	0.4%	140.329
21St. North	1+502.79	Lt.	62.900	62.630	60.585	0.4%	129.531
21St. North	1+596.32	Lt.	62.598	62.328	62.283	0.4%	110.877

LEGEND
C.J. IDENTIFIES CONTRACTION JOINT
L.J. IDENTIFIES LONGITUDINAL JOINT

VALLEY GUTTER & MISC. DETAILS
CITY OF WICHITA, KANSAS
PROJECT NUMBER