

PAVING & INCIDENTAL DRAINAGE FOR
21ST & OLIVER INTERSECTION
 WICHITA, KANSAS

©2016
MKEC Engineering
All Rights Reserved
www.mkec.com
These drawings and their contents, including, but not limited to, all concepts, designs, & ideas are the exclusive property of MKEC Engineering (MKEC), and may not be used or reproduced in any way without the express consent of MKEC.

TYPICAL SECTIONS

PROJECT NO. 472-85213

DATE SEPT. 2016

SCALE NO SCALE

DESIGNED DRAWN CHECKED
JRA LES JRA

#	NO.	REVISION	DATE

SHEET NO.

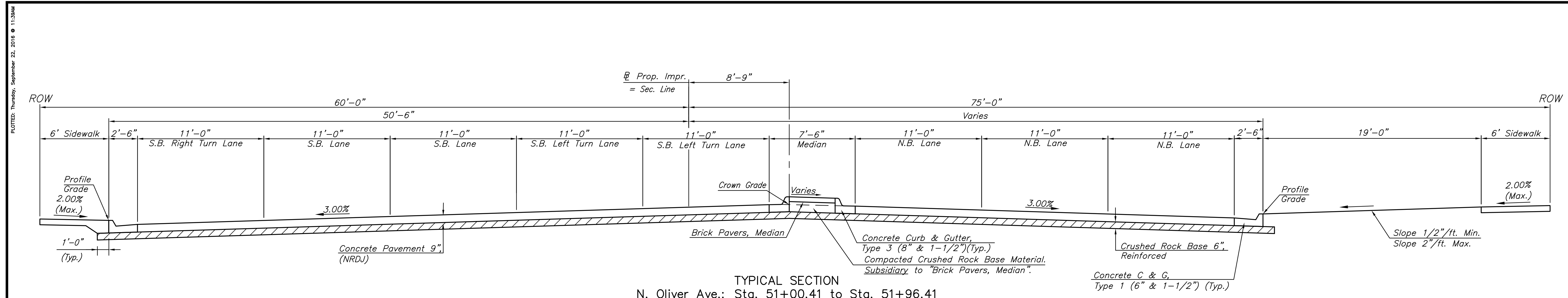

TYPICAL SECTION
N. Oliver Ave.: Sta. 51+00.41 to Sta. 51+96.41

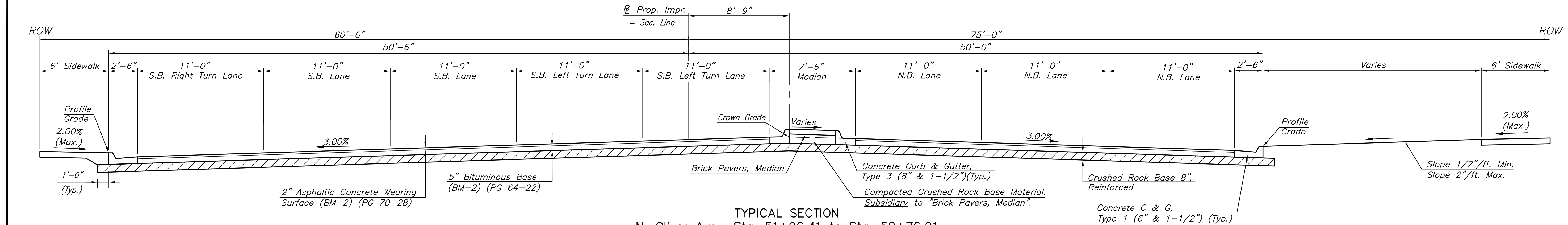

TYPICAL SECTION
N. Oliver Ave.: Sta. 51+96.41 to Sta. 52+76.91

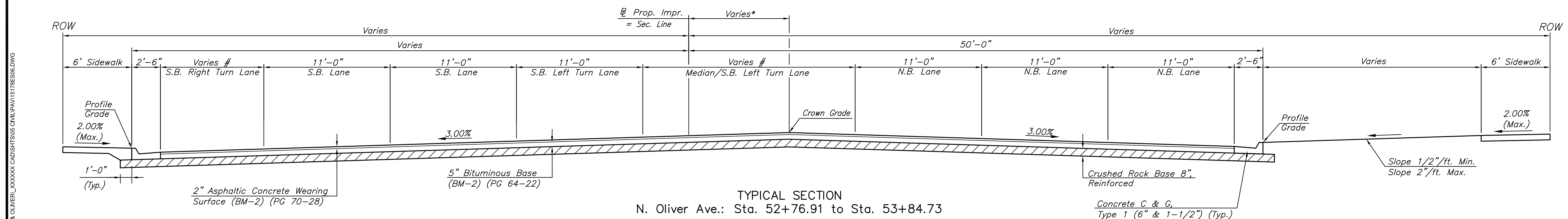

TYPICAL SECTION
N. Oliver Ave.: Sta. 52+76.91 to Sta. 53+84.73

* Crown Offset Varies from 8'-9" Rt. at Sta. 52+76.91 to 7'-6"± Rt. at Sta. 54+84.73
 # S.B. Right Turn Lane Width Varies from 11'-0" at Sta. 52+76.91 to 0'-0" at Sta. 53+84.73
 Median/S.B. Left Turn Lane Width Varies from 18'-6" at Sta. 52+76.91 to 14'-9"± at Sta. 53+84.73

J:\PROJECTS\2016\150104078_COW_21ST & OLIVER_XXXXXX CAD\SHS\505 QW\PAV1517RESK.DWG
 PLOTTED: Thursday, September 22, 2016 @ 11:35AM