

FHWA REGION NO.	STATE	PROJECT NO.	FISCAL YEAR	SHEET NO.	TOTAL SHEETS
7	KANSAS	87-N-0223-01	2002	31	56

BENCHMARK
 BM #1 - City of Wichita Disc Located
 at the SW Corner of the Harry
 Street Bridge at McLean.
 Elev. 394.998 SI Units (1295.93)

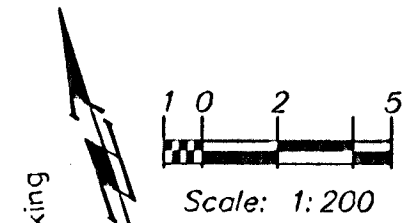

B.L. 'A' Sta. 0+426.0 7.6m Lt.
 Install R2-1 per Detail
 See Marking & Signing Detail

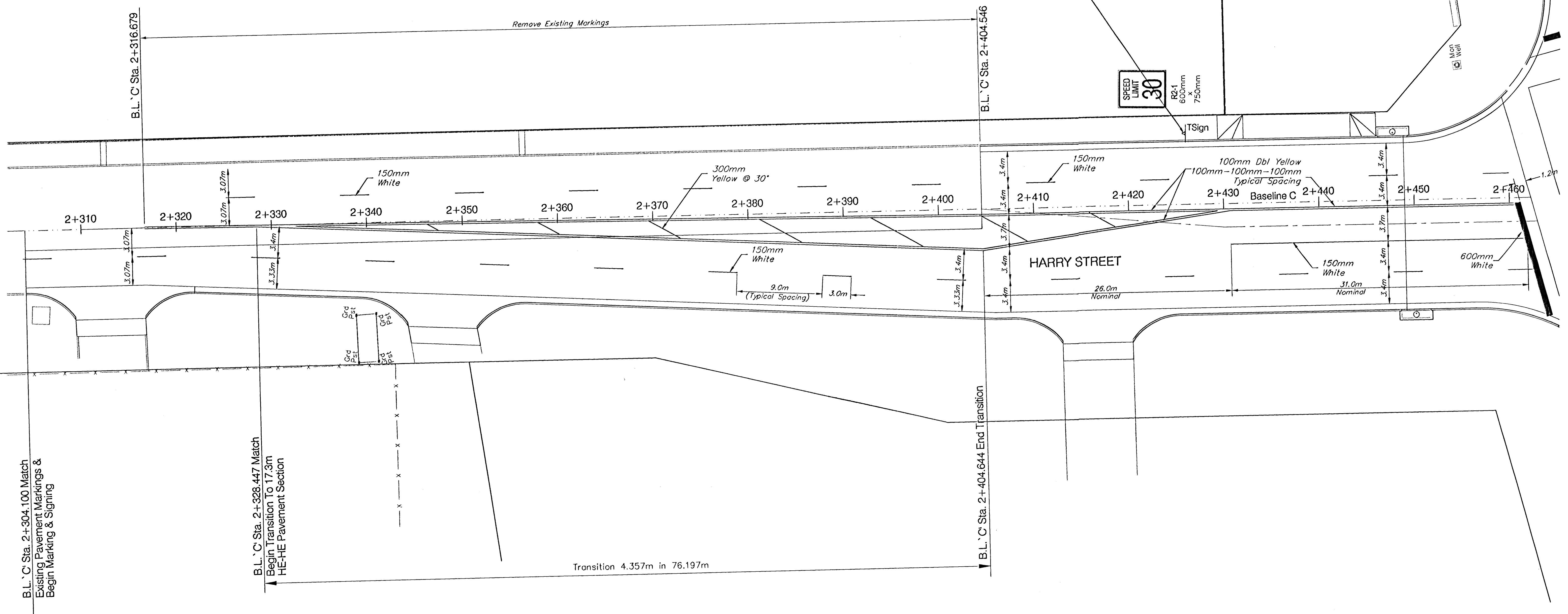
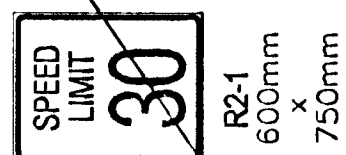

B.L. 'C' Sta. 2+304.100 Match
 Existing Pavement Markings &
 Begin Marking & Signing

B.L. 'C' Sta. 2+328.447 Match
 Begin Transition To 17.3m
 HE-HI Pavement Section

B.L. 'C' Sta. 2+404.644 End Transition

Sedgewick County
 Work Release Facility

	MARKING TOTALS THIS SHEET	UNIT	TOTAL
1	150mm White	m	109.14
2	100mm White	m	0.00
3	600mm White	m	12.57
4	100mm Yellow	m	482.91
5	300mm Yellow	m	28.65
* FOR INFORMATION ONLY			



PROJECT NUMBER 472-83781		SHEET NAME mark03		ENGINEERING DIRECTORY F:\HarryMcLean\Traffic	
DESIGN JFB	DRAWN TA	APPROVED JFB	DATE Aug 2003	SCALE 1:200	BAUGHMAN NO 01-03-E943

MARKING & SIGNING PLAN
 CAPITAL IMPROVEMENT PROJECT
 HARRY & MCLEAN INTERSECTION IMPROVEMENTS

BAUGHMAN COMPANY, P.A. ENGINEERING, SURVEYING, & PLANNING 318-282-7271 • 315 ELLIS • WICHITA, KANSAS 67211	SHEET OF 31 OF 56
---	-------------------------------