



**LEGEND**

- EROSION CONTROL MAT
- RETAINING WALL
- PROPOSED CONTOUR
- EXISTING CONTOUR
- GRADING LIMITS/MATCH LINE
- DRAINAGE RESERVE

CONTOUR INTERVAL: 1 FOOT

SEE SHEET NO. 5 FOR SECTION B-B, SECTION C-C, POND GRADING NOTES AND POND SEALING NOTES.  
SEE SHEET NO. 16 FOR RIPRAP DETAILS.

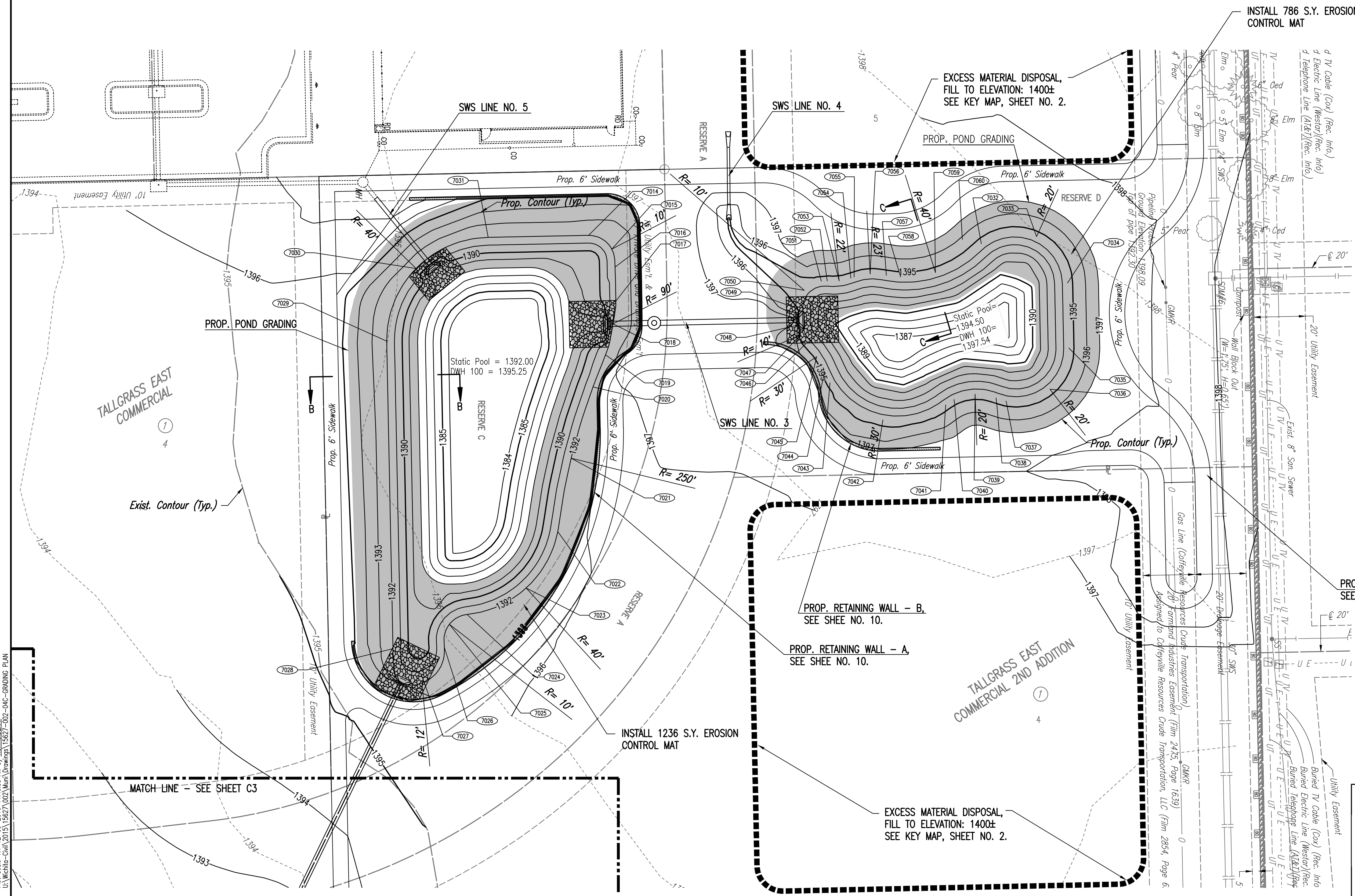

COORDINATE LIST--PT. AT ELV. 1392.00		
POINT	NORTH	EAST
7014	7,718.1196	9,416.8020
7015	7,727.1741	9,422.1537
7016	7,728.4165	9,429.1055
7017	7,728.7159	9,442.2750
7018	7,727.6305	9,451.1209
7019	7,724.7110	9,463.1432
7020	7,719.8539	9,475.6119
7021	7,711.4148	9,503.2791
7022	7,706.2092	9,531.7325
7023	7,693.9017	9,553.6001
7024	7,671.0116	9,563.8818
7025	7,664.1691	9,567.7188
7026	7,662.2843	9,576.9524
7027	7,653.2141	9,586.9136
7028	7,642.2766	9,577.1634
7029	7,639.8355	9,457.8627
7030	7,651.2586	9,429.6683
7031	7,679.1801	9,417.5933

COORDINATE LIST--PT. AT ELV. 1394.50		
POINT	NORTH	EAST
7032	7,870.4994	9,420.0480
7033	7,891.9431	9,417.2907
7034	7,903.9223	9,435.2888
7035	7,904.4457	9,460.5386
7036	7,897.1184	9,476.5259
7037	7,880.1238	9,481.0498
7038	7,876.2974	9,479.9198
7039	7,868.0826	9,478.4307
7040	7,859.9879	9,480.4746
7041	7,856.6723	9,482.5687
7042	7,832.3206	9,488.3777
7043	7,811.8067	9,474.0275
7044	7,809.6666	9,469.6538
7045	7,806.6251	9,463.8683
7046	7,802.4429	9,458.8453
7047	7,800.2363	9,455.5171
7048	7,799.3484	9,451.6238
7049	7,799.2207	9,445.1852
7050	7,801.7910	9,438.1030
7051	7,808.4409	9,434.5613
7052	7,810.7284	9,434.5002
7053	7,815.3555	9,434.4400
7054	7,819.8630	9,433.3931
7055	7,821.1680	9,432.9745
7056	7,827.3586	9,431.7588
7057	7,833.6434	9,432.3084
7058	7,839.1805	9,432.9566
7059	7,852.6796	9,431.2283
7060	7,864.7929	9,425.0249

(7000) = COORDINATE POINT NO.

Scaled 12-05-2016 11:28:57 AM by JAG  
 Plot Scale 1:1 12-05-2016 11:40:55 AM by KURTIS.DENAT  
 U:\Wichita-Civil\2015\15627\002\Main\Drawings\15627-002-04C-GRADING PLAN

No.	Revision	By	Date

TALLGRASS EAST COMMERCIAL 2ND ADDITION  
STORM WATER DRAIN NO. 407

### GRADING PLAN

GARY JANZEN, P.E. - CITY ENGINEER  
CITY OF WICHITA PROJECT NO. 468-85097

PROFESSIONAL ENGINEERING CONSULTANTS, P.A.  
303 SOUTH TOPEKA WICHITA, KS 67202  
316-262-2691 www.pec1.com

Designed by JAG, TBK  
Drawn by BJS

Job No. 31-15627-002  
Date April 2016

SHT. 04 of 23