

Sta. 30+61.32, 36.00' Lt.  
Construct Type I Inlet  
L= 10'-0", W= 3'-0", H= 4'-0"  
Top Elev.= 193.53  
E out 18" (E)= 190.65  
See Sh No. 12

Sta. 32+37.64, 36.00' Lt.  
Construct Type I Inlet  
L= 10'-0", W= 3'-0", H= 4'-0"  
Top Elev.= 194.43  
E out 18" (E)= 191.45  
See Sh No. 12

Sta. 30+59.32, 27.98' Lt.  
Construct Reinf. Concrete MH  
L= 4'-0", W= 4'-0", H= 4'-6", Ht= 9"  
Top Elev.= 193.24 (Top Slab Thickness= 6")  
Connect to Exist. 18" RCP (E)  
Install 8 L.F. 24" RCP (N)  
Connect to Exist. Joint (N)  
Install 8 L.F. 18" RCP (W)  
E in 24" (N)= 189.52  
E in 18" (E)= 190.07  
E in 18" (W)= 190.07  
E out 24" (S)= 189.52  
See Sh. No. 11

Sta. 32+35.14, 27.98' Lt.  
Construct Reinf. Concrete MH  
L= 4'-0", W= 4'-0", H= 4'-6", Ht= 9"  
Top Elev.= 194.34 (Top Slab Thickness= 6")  
Connect to Exist. 18" RCP (E)  
Install 8 L.F. 24" RCP (N)  
Connect to Exist. Joint (N)  
Install 8 L.F. 24" RCP (S)  
Connect to Exist. Joint (N)  
Install 8 L.F. 18" RCP (W)  
E in 24" (N)= 190.64  
E in 18" (E)= 191.04  
E in 18" (W)= 191.04  
E out 24" (S)= 190.64  
See Sh. No. 11

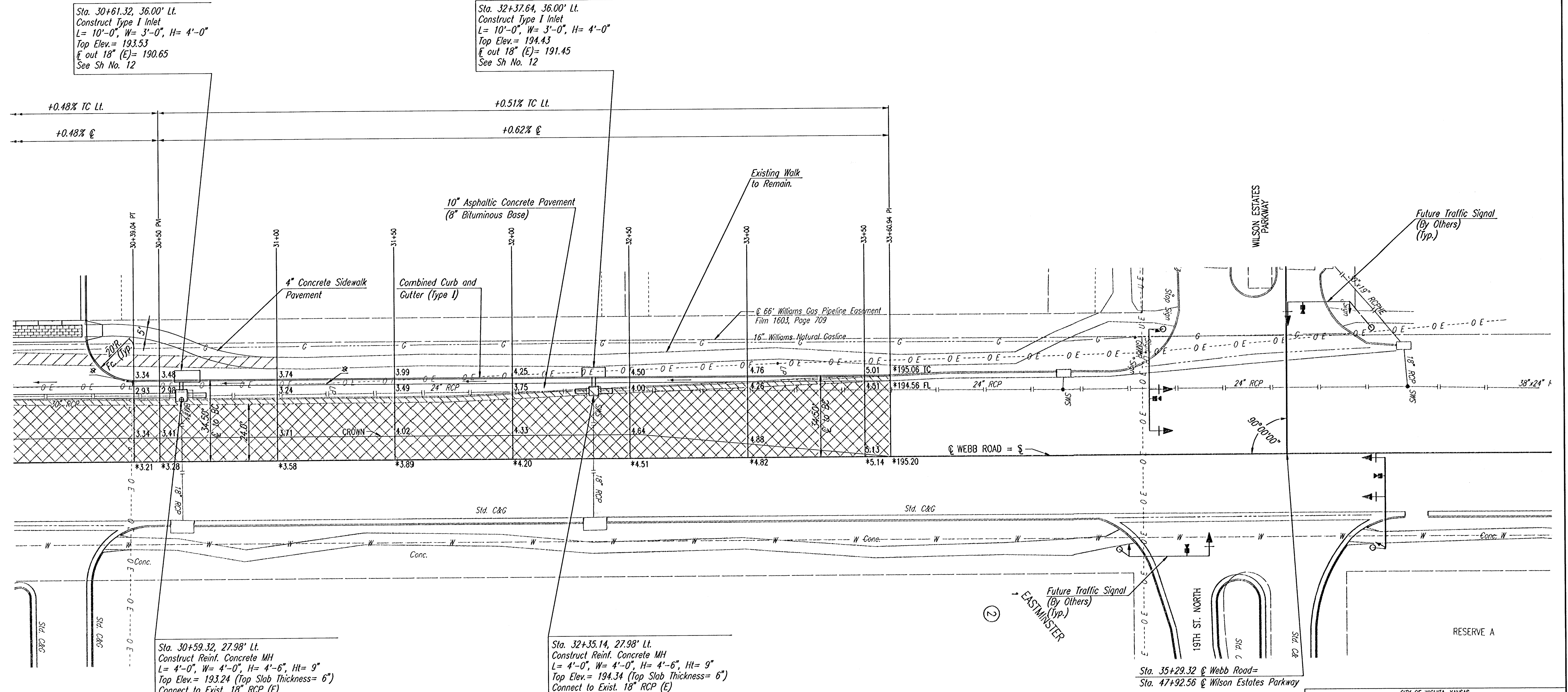

- \* MATCH EXISTING
- ▨ TO BE RELOCATED BY OTHERS
- ▨ 2" MILL WITH OVERLAY
- ▨ SIDEWALK AND PAVEMENT REMOVAL
- ▨ EXISTING CURB AND GUTTER REMOVAL

CITY OF WICHITA, KANSAS

**WEBB ROAD**  
STA. 30+38.57 TO STA. 33+60.94

Professional Engineering Consultants, P.A.  
303 S. TOPEKA - WICHITA, KANSAS 67202  
316-262-2691 • FAX 316-262-3003

Designed by	RHM	Checked by	BER
Drawn by	GJR, SAW	Date	JANUARY 2003
			Job No. 02621

DSNR: SAD OPER: SAD SCALE: 1"=20.00  
 C:\2002\02621\Streets\Webb-Pave2\_01-29-2003\_04:14:02 pm