

SCALE: 1"=10'
6"x12" W4xW4 WIRE FABRIC REINFORCING SHALL BE PLACED SUCH THAT THE WIRES WITH THE 6" SPACING WILL RUN PARALLEL WITH THE LONGITUDINAL JOINT.

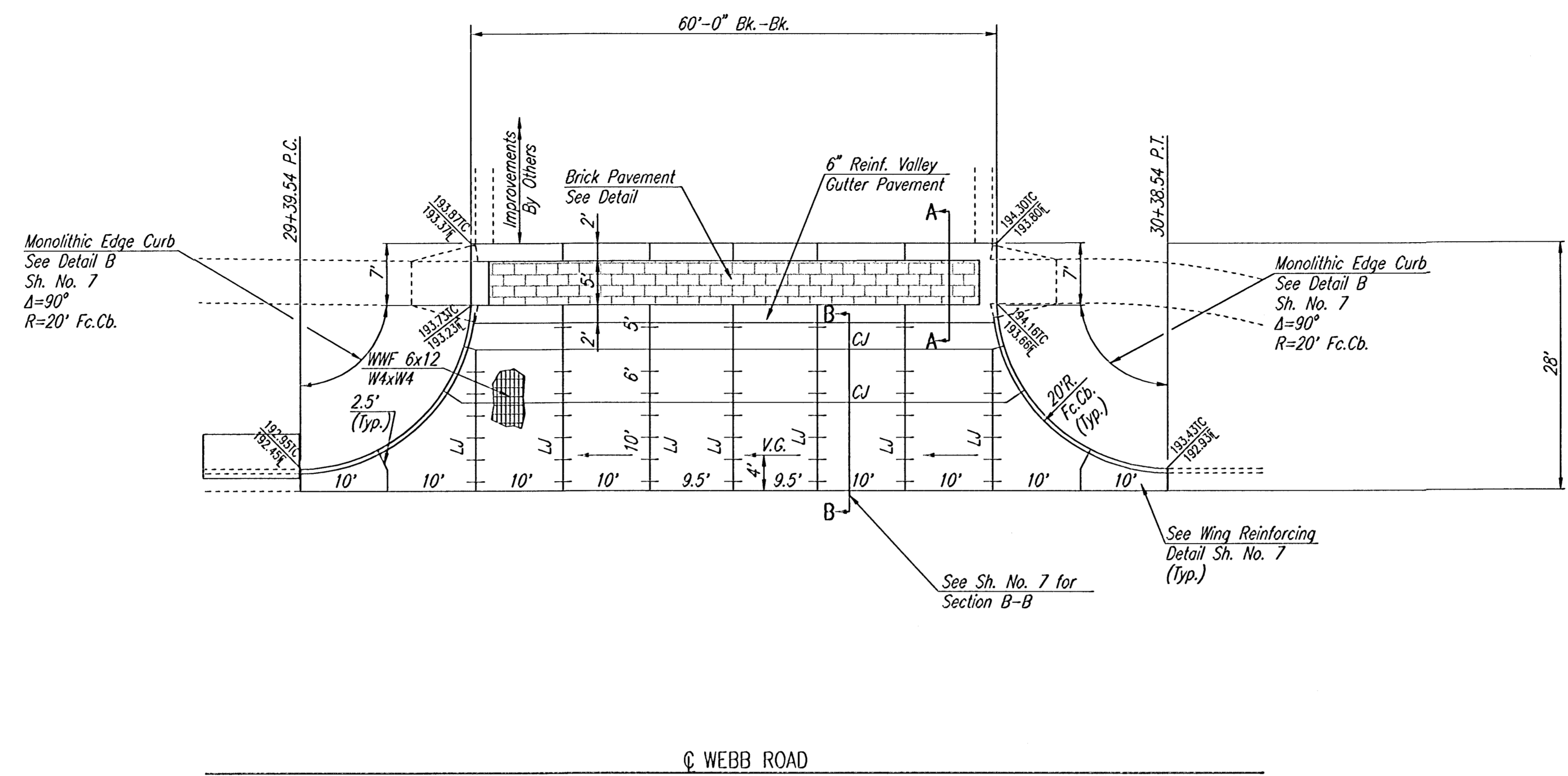

REINFORCED VALLEY GUTTER

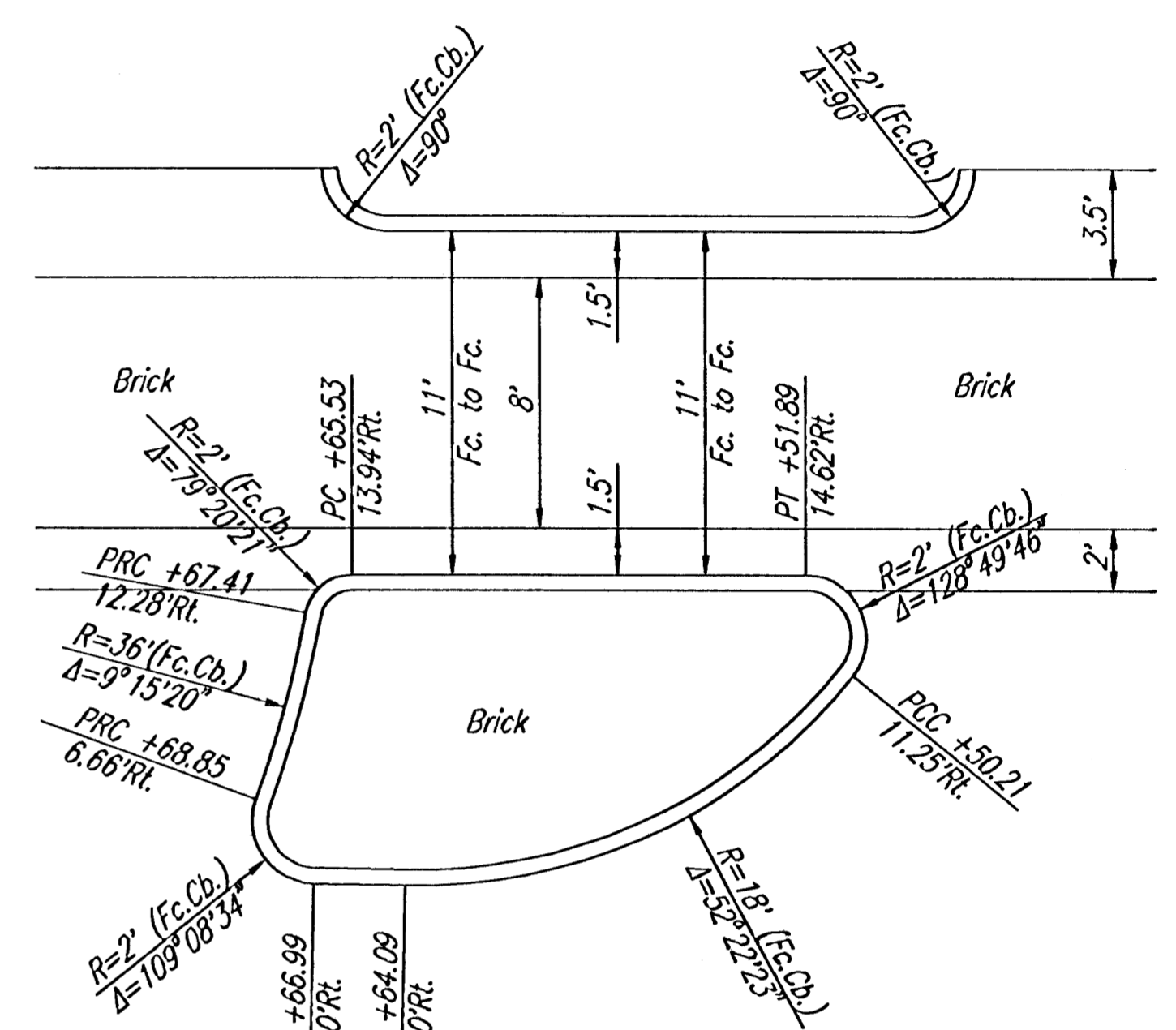

DETAIL E

NOTE: THE CONTRACTOR SHALL LOCATE AND MAINTAIN THE INTEGRITY OF THE SPRINKLER SYSTEM. ANY ADJUSTMENT SHALL BE INCIDENTAL TO OTHER BID ITEMS. ANY REPAIRS REQUIRED DUE TO DAMAGE DURING CONSTRUCTION SHALL BE AT THE CONTRACTOR'S EXPENSE.

CAUTION!!!
Sprinkler System
See Note this Sheet.

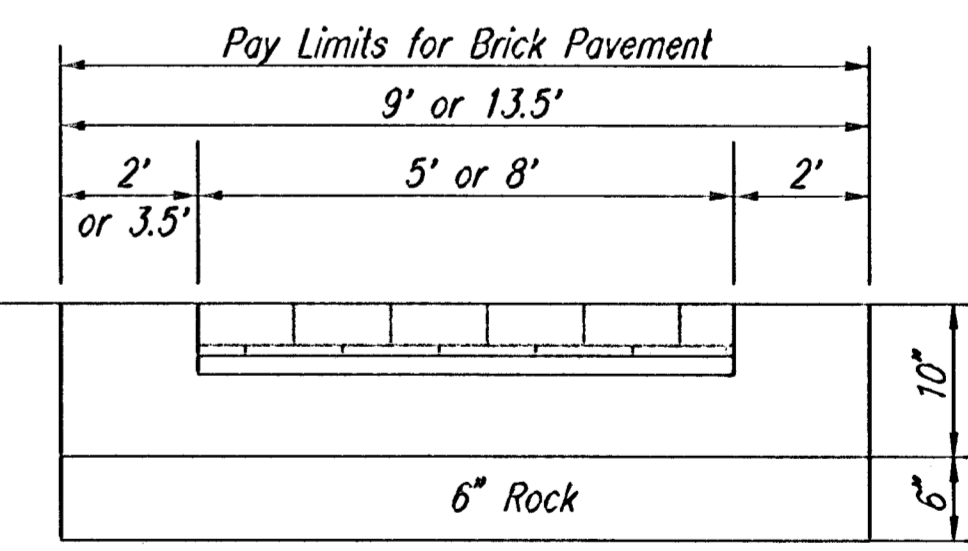

SECTION A-A

φ Standard Wheelchair Ramp
* Match Existing

SCALE: 1"=10'
6"x12" W4xW4 WIRE FABRIC REINFORCING SHALL BE PLACED SUCH THAT THE WIRES WITH THE 6" SPACING WILL RUN PARALLEL WITH THE LONGITUDINAL JOINT.

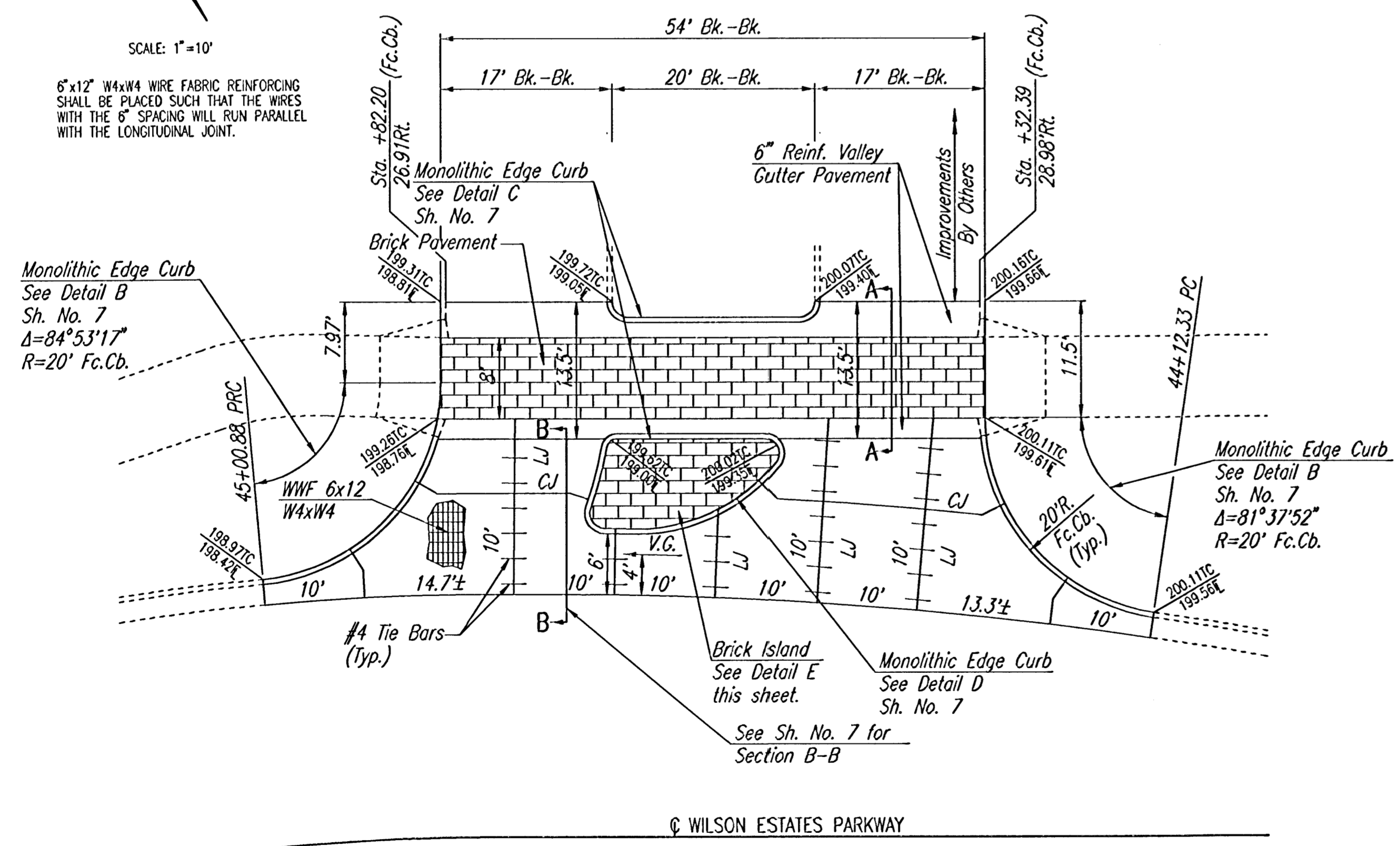

REINFORCED VALLEY GUTTER

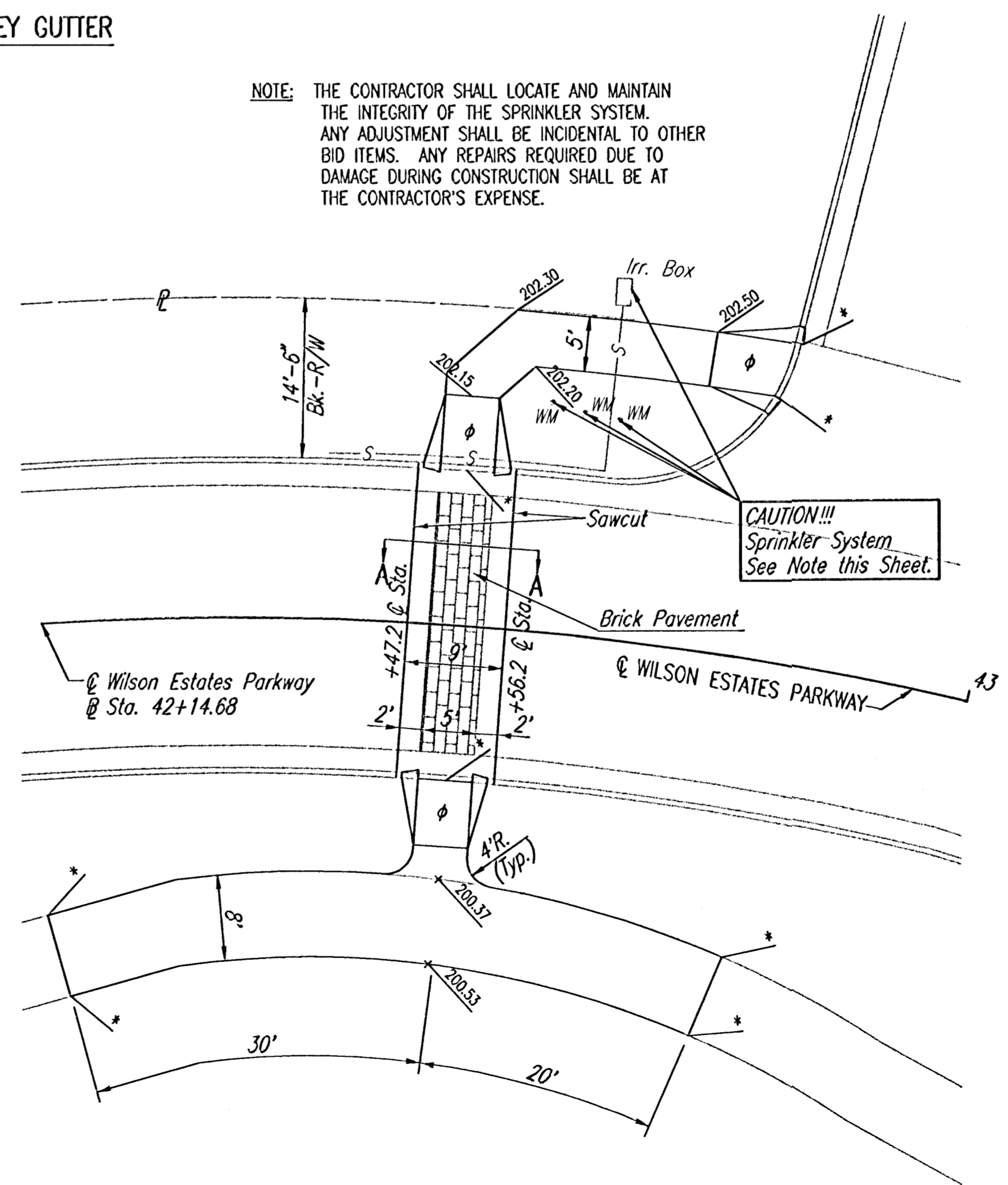

WEBB ROAD SOUTH OF 21ST STREET NORTH

MISCELLANEOUS PAVING DETAILS

Professional Engineering Consultants, P.A.
303 S. TOPEKA • WICHITA, KANSAS 67202
316-262-2691 • FAX 316-262-3003

| | |
|--------------------|-------------------|
| Designed by BER | Checked by |
| Drawn by GJR | Date DEC. 2002 |
| Job No. 02621 | |

DSNR: SAK OPER: DEP SCALE: 1"=10.00
 0:\2002\02621\Streets\standards\MISCDD1L_02-06-2003 04:18:08 pm