

RECAPITULATION OF QUANTITIES		
ITEMS	TOTAL	UNITS
PAVEMENT MARKING (THERMOPLASTIC) (WHITE) (6")	609	LIN. FT.
PAVEMENT MARKING (THERMOPLASTIC) (YELLOW) (4")	1755	LIN. FT.
PAVEMENT MARKING (THERMOPLASTIC) (YELLOW) (12")	75	LIN. FT.
PAVEMENT MARKING SYMBOL (THERMOPLASTIC) (WHITE LEFT ARROWS)	8	EACH
PAVEMENT MARKING (THERMOPLASTIC) (WHITE) (12")	132	LIN. FT.
PAVEMENT MARKING (THERMOPLASTIC) (WHITE) (24")	134	LIN. FT.

NOTE: ALL EXISTING MARKINGS WHICH CONFLICT WITH THE PROPOSED PLAN SHALL BE REMOVED BY GRINDING OR OTHER MECHANICAL MEANS (PAINTING OVER EXISTING MARKING WILL NOT BE ALLOWED). THIS WORK SHALL BE CONSIDERED SUBSIDIARY TO THE BID ITEM "PAVEMENT MARKING".

UNLESS OTHERWISE NOTED, DIMENSIONS ARE FROM & STRIPE TO & STRIPE.

- FOR INFORMATION ONLY - BID ITEM "PAVEMENT MARKING" IS PAID AS LUMP SUM.
- ① THE CONTRACTOR SHALL COORDINATE THE PLACEMENT OF THE 24" WHITE STOP BARS WITH THE TRAFFIC SIGNAL CONTRACTOR. THE 24" WHITE STOP BARS SHALL NOT BE PLACED UNTILL THE TRAFFIC SIGNAL IS INSTALLED AND FUNCTIONING.
- (CITY OF WICHITA JOB NUMBER FOR TRAFFIC SIGNAL IS 472-83677)

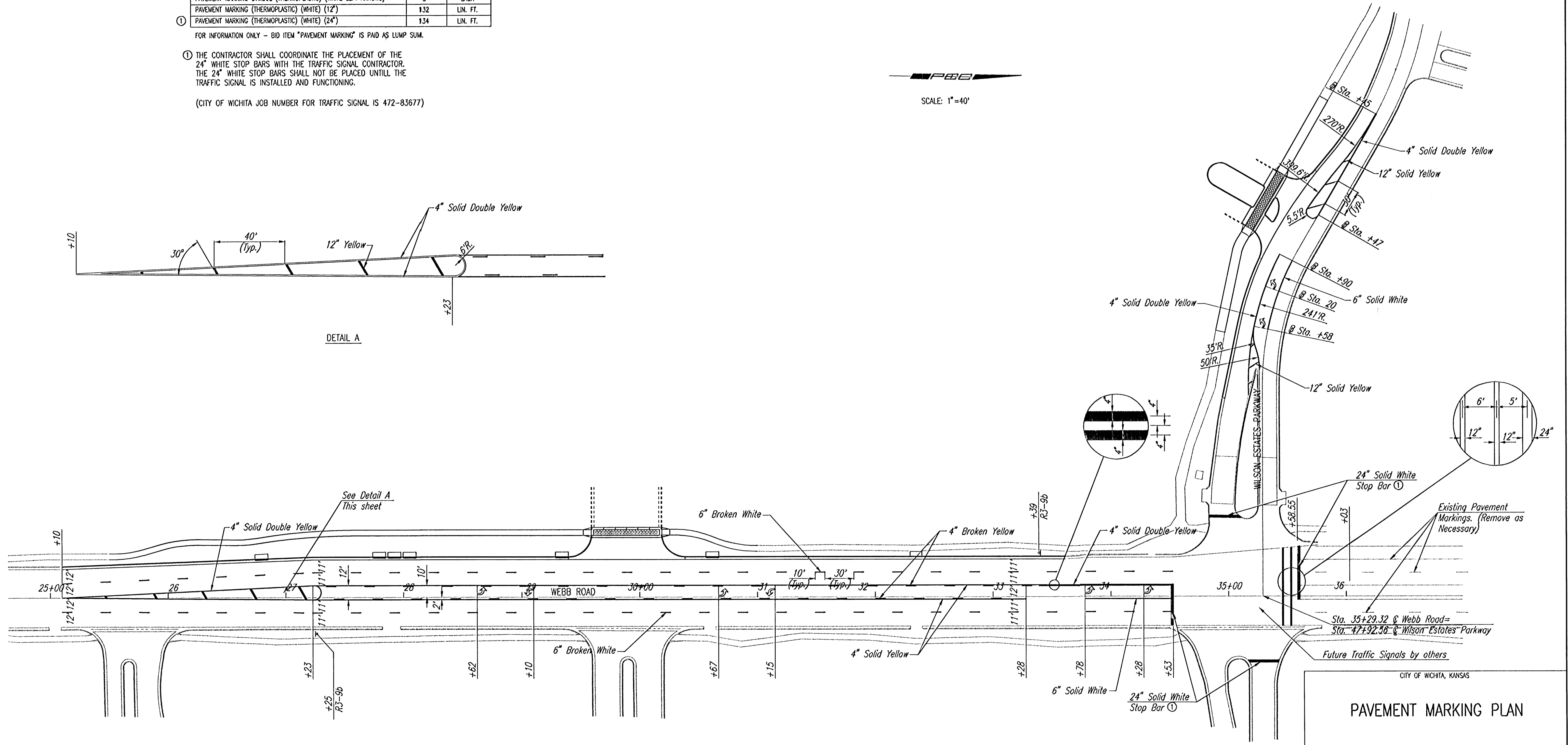
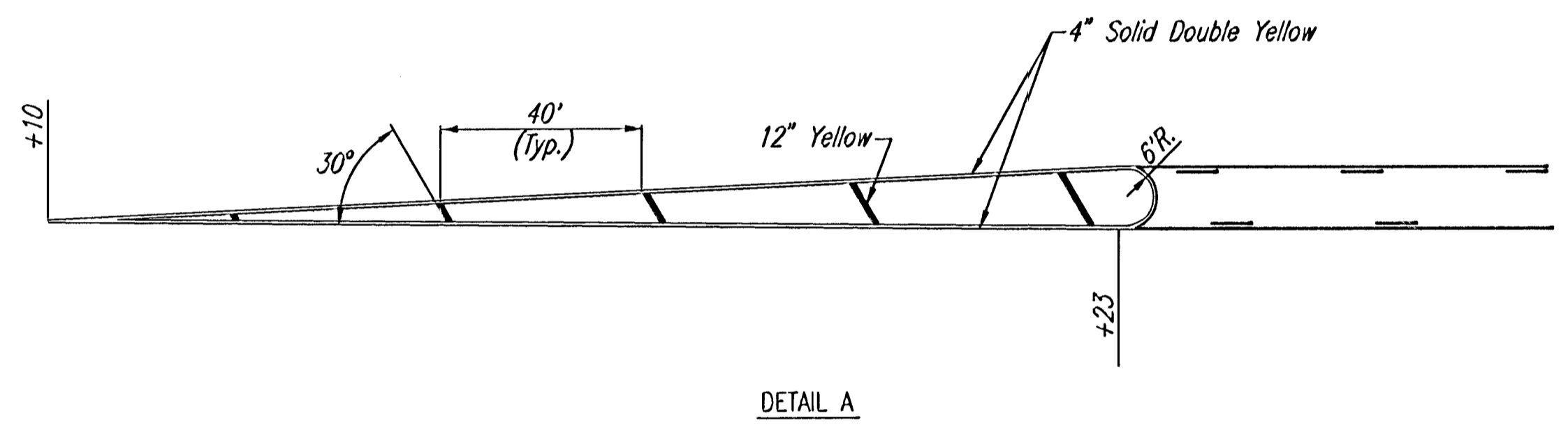
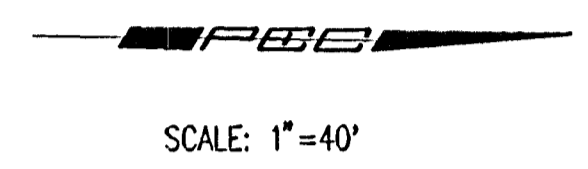

CITY OF WICHITA, KANSAS

### PAVEMENT MARKING PLAN

Professional Engineering Consultants, P.A.  
 303 S. TOPEKA • WICHITA, KANSAS 67202  
 316-262-2691 • FAX 316-262-3003

Designed by	RWM	Checked by	BER
Drawn by	GJR, SAW	Date	JANUARY 2003
		Job No.	02621

DSNR: RWM OPER: DEP SCALE: 1=40.00  
 C:\2002\02621\Streets\MARKINGPLAN 02-06-2003 04:05:18 pm