

Scale: 1" = 40'  
 • = Iron

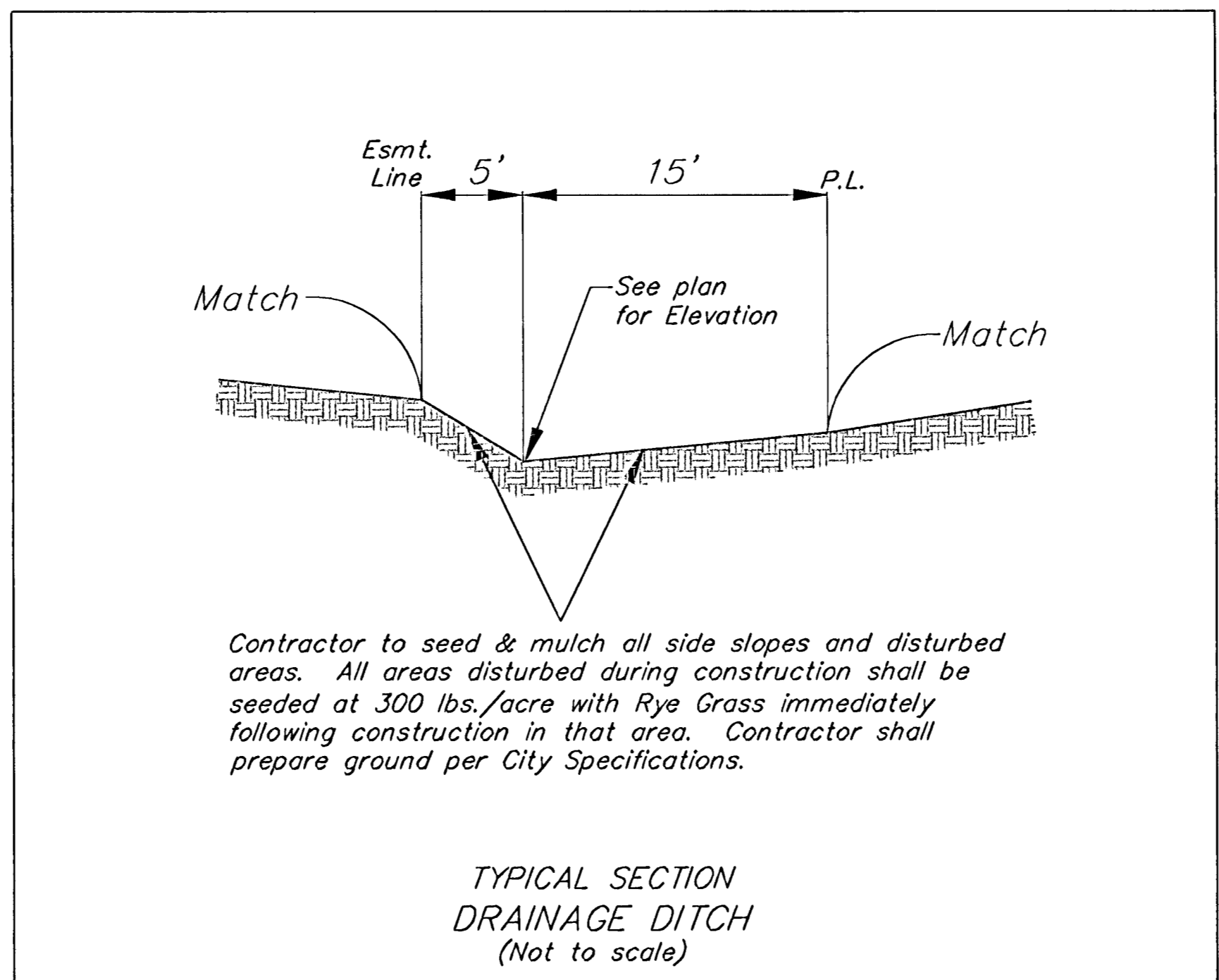

Sta. 0+00, Begin  
 698 L.F. Ditch  
 Construction  
 from Proposed 12"  
 SWS PVC pipe.  
 Flow = 143.00

Install 20 L.F. Silt  
 Fence Ditch Check.  
 See Detail, Sheet 6.

Install 20 L.F. Silt  
 Fence Ditch Check.  
 See Detail, Sheet 6.

Install 20 L.F. Silt  
 Fence Ditch Check.  
 See Detail, Sheet 6.

Construct Ditch as Shown.  
 All costs included in bid  
 item, "Ditching"

Regrade area as  
 necessary to provide  
 for positive drainage.

Sta. 6+98.0, End  
 ditch construction.

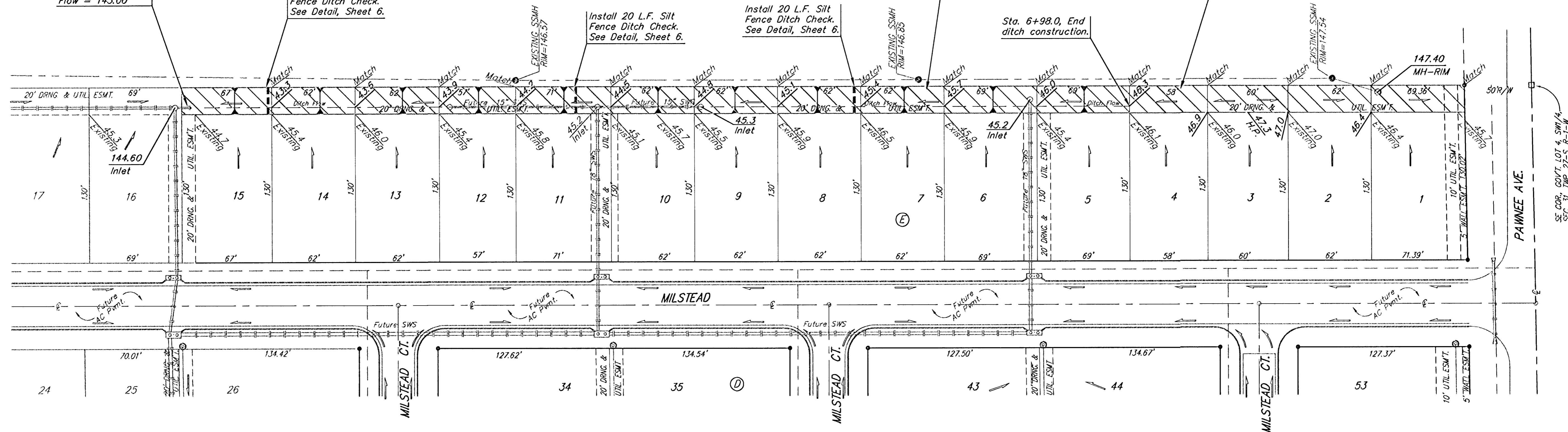

FLAT CREEK ADDITION

FLAT CREEK ADDITION - PHASE II  
**DITCH PLAN**

**BAUGHMAN COMPANY P.A.**  
 ENGINEERING, SURVEYING, & PLANNING  
 316-262-7271 • 315 ELLIS • WICHITA, KANSAS 67211

PROJECT NUMBER  
**472-83384**

DESIGN NBW	DRAWN GNX	APPROVED	DATE 8/21/02	SCALE NOTED	SHEET <b>23</b>
					OF <b>43</b>

Flat Creek Addition Phase II Ditch Plan